

17		16		15		14		13		12		11	
REV. A		SCALE 1/1		DR: ZOE		QTY		FINISH		MATERIAL		UNITS mm	
SHEET 1/1		2006-11-28		CHKD: LISA		.XXX ± 0.05		.XX ± 0.10		.X ± 0.20		.X ± 0.30	
APPD. SUNNY		APPD: SUNNY		PART NO.(INTENDED USE)		.XX ± 1°		.X ± 2°		.X ± 5°		X ± 0.30	
DWG NO.:		TITLE: MTP220-11XXS1		NAME (INTENDED USE)		MTP220-11XXS1		MTP220-11XXS1		MTP220-11XXS1		MTP220-11XXS1	
MINTRON CO., LTD.		MINTRON CO., LTD.		MINTRON CO., LTD.		MINTRON CO., LTD.		MINTRON CO., LTD.		MINTRON CO., LTD.		MINTRON CO., LTD.	

Dimension antitheses list		ITEM		Alternate	
A		B		Standard	
2.80		4.00		2.80	

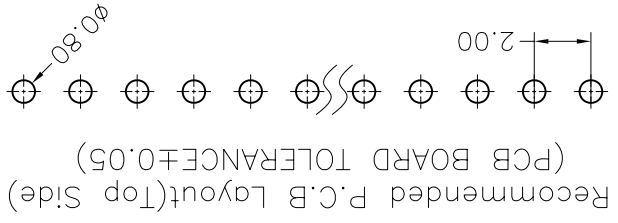
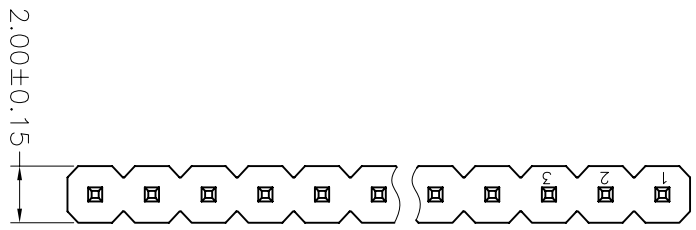
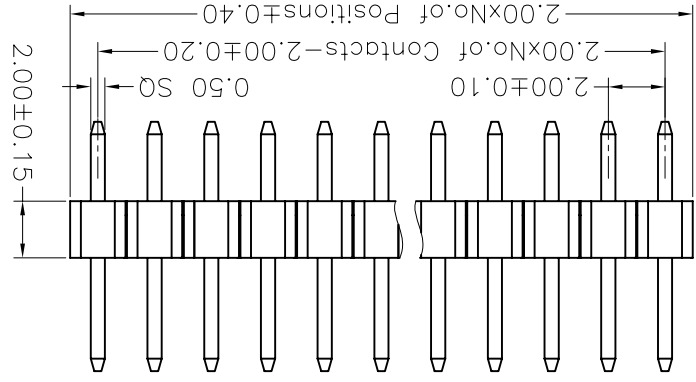
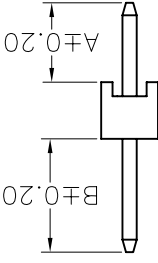

Recommended P.C.B Layout (Top Side)  
(PCB BOARD TOLERANCE ± 0.05)

MTP220-11XXS1  
No. of Pins per Row: 01~40

NOTES:  
 Current Rating: 3.0AMP  
 Contact Resistance: 20mΩ max  
 Withstand Voltage: 500V AC/DC  
 Insulation Resistance: 1000MΩ min  
 Operation Temperature: -40°C to +105°C  
 Contact Material: Brass  
 Contact plating: Au or Sn Over Ni  
 Insulator Material: PBT or PA6T+30%GF (UL94V-0)

17	REV.	ECN. NO.	APPD.
A			

## X-ON Electronics

Largest Supplier of Electrical and Electronic Components

*Click to view similar products for [Headers & Wire Housings](#) category:*

*Click to view products by [MINTRON](#) manufacturer:*

Other Similar products are found below :

[95000-104TRLF](#) [10135584-644402LF](#) [DF62W-EP2022PCA](#) [95000-106TRLF](#) [DF62W-2022SCA](#) [DF62W-EP2022PC](#) [2203348](#) [DF62W-2022SC](#) [1084018](#) [1029039](#) [1084017](#) [802-10-012-10-002000](#) [1112640](#) [1112639](#) [891-007-9SS-BST1T](#) [000-34000](#) [0008550134](#) [0009482033](#) [0009507031](#) [57102-F02-18ULF](#) [57102-S06-03LF](#) [57202-S52-04LF](#) [PCN6-15S-2.5E](#) [0039019024](#) [58102-G61-06LF](#) [582553-1](#) [0009485154](#) [0009508121](#) [0022285053](#) [0050291907](#) [018731A](#) [LY20-4P-DT1-P1E-BR](#) [02.125.8002.8](#) [60101931](#) [60598-1 \(Cut Strip\)](#) [M1625-3R/100](#) [61062-3](#) [61082-181009](#) [CSU011177004](#) [636-1427](#) [638009-1](#) [641938-9](#) [641991-4](#) [644168-1](#) [644827-2](#) [647662-1](#) [65039-019ELF](#) [65692-001LF](#) [65781-018](#) [65781-047](#)