

No OF CCTS.	DIMn. A	DIMn. B
2	(5.08 ± 0.05) / .200 ± 0.002	(9.91 ± 0.15) / .390 ± 0.006
3	(10.16 ± 0.08) / .400 ± 0.003	(14.99 ± 0.15) / .590 ± 0.006
4	(15.24 ± 0.08) / .600 ± 0.003	(20.07 ± 0.18) / .790 ± 0.007
5	(20.32 ± 0.08) / .800 ± 0.003	(25.15 ± 0.20) / .990 ± 0.008
6	(25.40 ± 0.10) / 1.000 ± 0.004	(30.23 ± 0.23) / 1.190 ± 0.009
7	(30.48 ± 0.13) / 1.200 ± 0.005	(35.31 ± 0.25) / 1.390 ± 0.010
8	(35.56 ± 0.20) / 1.400 ± 0.008	(40.39 ± 0.28) / 1.590 ± 0.011
9	(40.64 ± 0.20) / 1.600 ± 0.008	(45.47 ± 0.30) / 1.790 ± 0.012
10	(45.72 ± 0.20) / 1.800 ± 0.008	(50.55 ± 0.30) / 1.990 ± 0.012
11	(50.80 ± 0.20) / 2.000 ± 0.008	(55.63 ± 0.33) / 2.190 ± 0.013
12	(55.88 ± 0.25) / 2.200 ± 0.010	(60.71 ± 0.33) / 2.390 ± 0.013

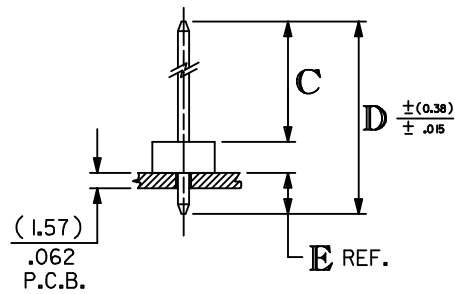
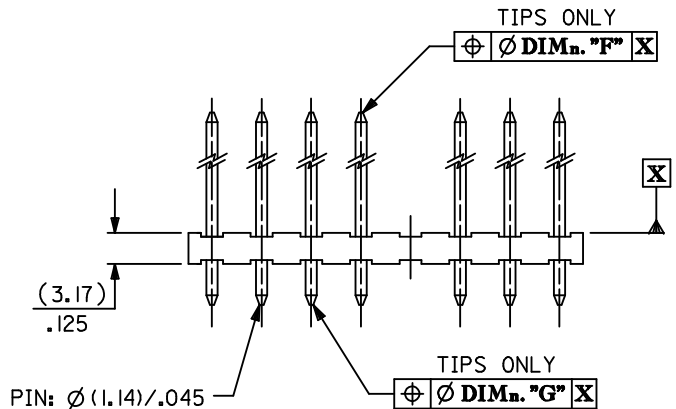

3003-N * - *
 BASE No. | No. OF CCTS. | VERSION | VOID CODE NO. CORRESPONDS TO CIRCUIT NO. VOIDED. MULTIPLE VOIDS START WITH 51.

- NOTES:
 1. MATERIAL: WAFER: NYLON UL94V-2, COLOR: NATURAL
 PINS: BRASS
 2. FINISH: (222) = OVERALL MATTE TIN, (0.00254)/.000100 MIN. OVER (0.00127)/.000050 MIN. NICKEL
 3. PRODUCT SPECIFICATION: PS-99020-0087
 4. PIN PUSH OUT FORCE: (1.36KG)/3LBS MIN.
 5. PIN MUST MEET MOLEX SOLDERABILITY SPEC. ES-152.
 6. MAX. BOW: (0.38)/.015 OVER (25.4)/1.00
 7. FOR DIMENSIONS "C", "D", "E", "F" AND VERSIONS, SEE CHARTS ON SHEET 2 AND SUBSEQUENT SHEETS.
 8. FOR VERSIONS WITH VOIDS, SEE SHEET 4.
 9. CIRCUIT 1 IS USED TO DEFINE VOID LOCATION. CIRCUIT 1 MAY OR MAY NOT LINE UP WITH CIRCUIT 1 ON MATING PART.
 10. THIS PART CONFORMS TO CLASS B REQUIREMENTS OF COSMETIC SPECIFICATION PS-45499-002.

REMOVE AE-3003-NC EEC NO: UCP2013-0223 DRWN:MMSTROH 2012/06/08 CHKD:MKIPPER 2012/07/18 APPR:FSMITH 2012/07/25 BP1	DESCRIPTION REV	QUALITY SYMBOLS ▽=0 ▽=0 ▽=0	GENERAL TOLERANCES (UNLESS SPECIFIED) mm INCH 4 PLACES ± --- ± --- 3 PLACES ± --- ± .010 2 PLACES ± 0.25 ± .014 1 PLACE ± 0.35 ± --- 0 PLACE ± ±	DIMENSION STYLE MM/IN	SCALE 2:1	DESIGN UNITS METRIC	THIRD ANGLE PROJECTION
		DRAWN BY DBYRNES	DATE 02/11/22	TITLE KK (5.08)/.200 VERTICAL HEADER ASSEMBLY ROUND PIN			
		CHECKED BY BMAGUIRE	DATE 02/11/22				
		APPROVED BY FSMITH	DATE 2010/12/06				
ANGULAR ± --- ° DRAFT WHERE APPLICABLE MUST REMAIN WITHIN DIMENSIONS			MATERIAL NO. SEE CHART	DOCUMENT NO. SDAE-3003-N*	SHEET NO. 1 OF 4		
THIS DRAWING CONTAINS INFORMATION THAT IS PROPRIETARY TO MOLEX INCORPORATED AND SHOULD NOT BE USED WITHOUT WRITTEN PERMISSION							

INDEX: FOR FULL DIMENSIONS SEE RELEVANT SHEET.

ENG. No.	PLATING	DIM. C	DIM. D	SHT. No.
AE-3003-NA	(222)	(11.94) / .470	(19.05) / .750	3
AE-3003-NB	(222)	(16.69) / .657	(23.80) / .937	3
AE-3003-NI	(222)	(13.51) / .532	(20.32) / .800	3

FOR VOID VERSIONS SEE SHEET 4.

SEE SHEET 1 EC NO: UCP2013-0223 DRWN:MMSTROH 2012/06/08 CHKD:KKIPPER 2012/07/18 APPR:FSMITH 2012/07/25 BP1	QUALITY SYMBOLS ∇=0 ∇=0 ∇=0	GENERAL TOLERANCES (UNLESS SPECIFIED) 4 PLACES ± --- ± --- 3 PLACES ± --- ± .010 2 PLACES ± 0.25 ± .014 1 PLACE ± 0.35 ± --- 0 PLACE ± ±	DIMENSION STYLE MM/IN DRAWN BY DBYRNES CHECKED BY BMAGUIRE APPROVED BY FSMITH DATE 02/11/22 DATE 02/11/22 DATE 2010/12/06	SCALE 1:1 DESIGN UNITS METRIC THIRD ANGLE PROJECTION	TITLE KK (5.08)/.200 VERTICAL HEADER ASSEMBLY ROUND PIN molex	MATERIAL NO. SEE CHART	DOCUMENT NO. SDAE-3003-N*	SHEET NO. 2 OF 4	
	DESCRIPTION REV	ANGULAR ± --- ° DRAFT WHERE APPLICABLE MUST REMAIN WITHIN DIMENSIONS	SIZE B	THIS DRAWING CONTAINS INFORMATION THAT IS PROPRIETARY TO MOLEX INCORPORATED AND SHOULD NOT BE USED WITHOUT WRITTEN PERMISSION					

ENG. NO.	AE-3003-NA		AE-3003-NB		AE-3003-NI	
DIMN. "C"	(11.94 ±0.51) .470 ±.020		(16.69 ±0.51) .657 ±.020		(13.51 ±0.51) .532 ±.020	
DIMN. "D"	(19.05) / .750		(23.80) / .937		(20.32) / .800	
DIMN. "E"	(3.94) / .155		(3.94) / .155		(3.63) / .143	
DIMN. "F"	(1.02) / .040		(1.02) / .040		(1.02) / .040	
DIMN. "G"	(1.02) / .040		(1.02) / .040		(1.02) / .040	
PLATING	(222)		(222)		(222)	
	PART NO.	ENG NO.	PART NO.	ENG NO.	PART NO.	ENG NO.
NO. OF CIRCUITS	2	10-08-102I	AE-3003-2A	10-08-1022	AE-3003-2B	10-08-1029 AE-3003-2I
	3	▲ -103I	▲ -3A	▲ -1032	▲ -3B	▲ -1039 ▲ -3I
	4	-104I	-4A	-1042	-4B	-1049 -4I
	5	-105I	-5A	-1052	-5B	-1059 -5I
	6	-106I	-6A	-1062	-6B	-1069 -6I
	7	-107I	-7A	-1072	-7B	-1079 -7I
	8	-108I	-8A	-1082	-8B	-1089 -8I
	9	-109I	-9A	-1092	-9B	-1099 -9I
	10	-110I	-10A	-1102	-10B	-1109 -10I
	11	▼ -111I	▼ -11A	▼ -1112	▼ -11B	▼ -1119 ▼ -11I
	12	10-08-112I	AE-3003-12A	10-08-1122	AE-3003-12B	10-08-1129 AE-3003-12I

SEE SHEET 1 EC NO: UCP2013-0223 DRAWN:MMSTROH 2012/06/08 CHKD:MKIPPER 2012/07/18 APPR:FSMITH 2012/07/25 REV BP1	QUALITY SYMBOLS	GENERAL TOLERANCES (UNLESS SPECIFIED)	DIMENSION STYLE	SCALE	DESIGN UNITS	THIRD ANGLE PROJECTION
	▽/0	4 PLACES ± --- ± ---	MM/IN	1:1	METRIC	
	▽/0	3 PLACES ± --- ± .010				
	▽/0	2 PLACES ± 0.25 ± .014				
		1 PLACE ± 0.35 ± ---				
		0 PLACE ± ±				
		ANGULAR ± --- °				
		DRAFT WHERE APPLICABLE MUST REMAIN WITHIN DIMENSIONS	SEE CHART			
			MATERIAL NO.	DOCUMENT NO.		
			SIZE B			
			THIS DRAWING CONTAINS INFORMATION THAT IS PROPRIETARY TO MOLEX INCORPORATED AND SHOULD NOT BE USED WITHOUT WRITTEN PERMISSION			

TITLE
**KK (5.08)/.200 VERTICAL
 HEADER ASSEMBLY
 ROUND PIN**

molex

SDAE-3003-N*

SHEET NO.
3 OF 4

10 9 8 7 6 5 4 3 2 1

WAFERS WITH VOIDS:

No. OF CCTS	ENG. NO.	PART NO.	VOID CCT. LOCATION	FOR DIMns. SEE WAFER No.	PLATING
3	AE-3003-3A-2	38-00-5931	2	↑ AE-3003-NA ↓	↑ 222 ↓
4	AE-3003-4A-2	38-00-6865	2		
4	AE-3003-4A-51	38-00-0205	2,3		
6	AE-3003-6A-51	10-08-1067	2,4,5		
9	AE-3003-9A-2	10-08-1098	2		
10	AE-3003-10A-2	10-08-1108	2		
12	AE-3003-12A-51	10-08-1128	4,7		

SEE SHEET 1 DEC NO: UCP2013-0223 DRW:MMSTROH 2012/06/08 CHKD:HKIPPER 2012/07/18 APPR:FSMITH 2012/07/25	DESCRIPTION REV	QUALITY SYMBOLS	GENERAL TOLERANCES (UNLESS SPECIFIED)	DIMENSION STYLE	SCALE	DESIGN UNITS	THIRD ANGLE PROJECTION
		$\nabla = 0$ $\nabla = 0$ $\nabla = 0$	mm INCH 4 PLACES ± --- ± --- 3 PLACES ± --- ± .010 2 PLACES ± 0.25 ± .014 1 PLACE ± 0.35 ± --- 0 PLACE ± ±	MM/IN	1:1	METRIC	KK (5.08)/.200 VERTICAL HEADER ASSEMBLY ROUND PIN molex
			ANGULAR ± --- ° DRAFT WHERE APPLICABLE MUST REMAIN WITHIN DIMENSIONS	DRAWN BY DATE DBYRNES 02/11/22 CHECKED BY DATE BMAGUIRE 02/11/22 APPROVED BY DATE FSMITH 2010/12/06	TITLE		
				MATERIAL NO. SEE CHART	DOCUMENT NO.		
		SIZE B	SDAE-3003-N* SHEET NO. 4 OF 4				

9 8 7 6 5 4 3 2 1

X-ON Electronics

Largest Supplier of Electrical and Electronic Components

Click to view similar products for [Headers & Wire Housings](#) category:

Click to view products by [Molex](#) manufacturer:

Other Similar products are found below :

[892-18-020-10-001101](#) [58102-G61-06LF](#) [582553-1](#) [0009485154](#) [009176003701906](#) [0050291907](#) [LY20-4P-DT1-P1E-BR](#) [02.125.8002.8](#)
[609-3404](#) [61062-3](#) [622-0430](#) [622-3653LF](#) [63453-116](#) [636-1030](#) [636-1427](#) [636-3427](#) [636-4007](#) [641938-9](#) [641991-4](#) [644827-2](#) [65817-010LF](#)
[65817-015LF](#) [65863-015LF](#) [66207-023LF](#) [67095-007LF](#) [67601157](#) [68648-049](#) [70.362.1628.0](#) [70-4210](#) [70-4226B](#) [70-4853B](#) [707-5020](#) [707-5028](#) [71.350.2428.0](#) [71918-208LF](#) [71961-016LF](#) [733-134](#) [733-162](#) [754199-000](#) [760-3052](#) [787-8014-00](#) [79531-3000](#) [FCN-360C032-B](#) [FCN-367T-T012/H](#) [FCN-723D010/2](#) [80.063.4001.1](#) [800-90-001-10-001000](#) [800-90-010-10-002000](#) [801-43-002-10-013000](#) [801-43-006-10-002000](#)