

- NOTES:
- MATERIAL:  
HOUSING AND CAP: HIGH TEMPERATURE THERMOPLASTIC, UL94V-0, BLACK COLOR  
CONTACT: HIGH STRENGTH COPPER ALLOY  
SOLDER BALL: LEAD FREE SnAg3.0Cu0.5
  - PLATING:  
50u" NICKEL AT PADDLE AND CONTACT AREA.  
GOLD PLATING THICKNESS AT CONTACT AREA REFER TO TABLE.
  - DATE CODE "YMD\*\*" IS DEFINED AS:  
"YEAR/MONTH/DAY/MOLEX INTERNAL".
  - P&P COVER GATE POSITION ONLY, NO DIRECTION REQUIREMENT.
  - PRODUCT SPECIFICATION PS-105142-001 APPLIES.
  - PACKAGING SPECIFICATION PK-105142-001 APPLIES.
  - ALL PART NUMBERS COMPLIANT TO RoHS DIRECTIVE 2002/95/EC AND ELV DIRECTIVE 2000/53/EC.

<b>NEW RELEASE</b> EC NO: S2015-1419 DRW:DBFAN 2015/05/25 CHKD:SKTOH 2015/05/25 APPR:SKTOH 2015/07/29	QUALITY SYMBOLS	GENERAL TOLERANCES (UNLESS SPECIFIED)		DIMENSION STYLE	SCALE	DESIGN UNITS	THIRD ANGLE PROJECTION
	$F_A=0$ $F_C=0$ $F_P=0$	mm	INCH	MM ONLY	2:1	METRIC	
	DESCRIPTION	4 PLACES	± ---	± ---	DRAWN BY	DATE	TITLE
		3 PLACES	± ---	± ---	YXZHENG	2012/02/21	LGA 2011-3 SOCKET(R3)
	2 PLACES	± 0.25	± ---	CHECKED BY	DATE		
	1 PLACE	± 0.25	± ---	AYIN	2012/02/21		
		ANGULAR ± 3 °		APPROVED BY	DATE		
		DRAFT WHERE APPLICABLE MUST REMAIN WITHIN DIMENSIONS		AYIN	2014/09/02		
				MATERIAL NO.		MOLEX INCORPORATED	
				SEE SHEET 4		DOCUMENT NO.	SHEET NO.
				SIZE	THIS DRAWING CONTAINS INFORMATION THAT IS PROPRIETARY TO MOLEX INCORPORATED AND SHOULD NOT BE USED WITHOUT WRITTEN PERMISSION		
				A3	SD-105142-003		
					1 OF 5		

10 9 8 7 6 5 4 3 2 1

F

E

D

C

B

A

F

E

D

C

B

A

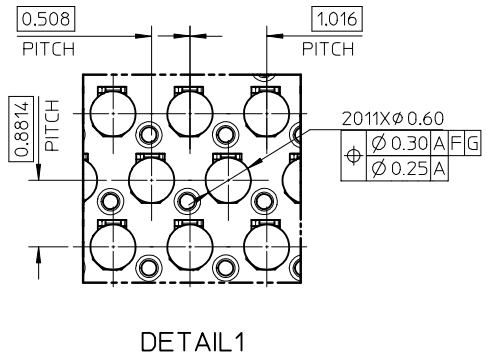
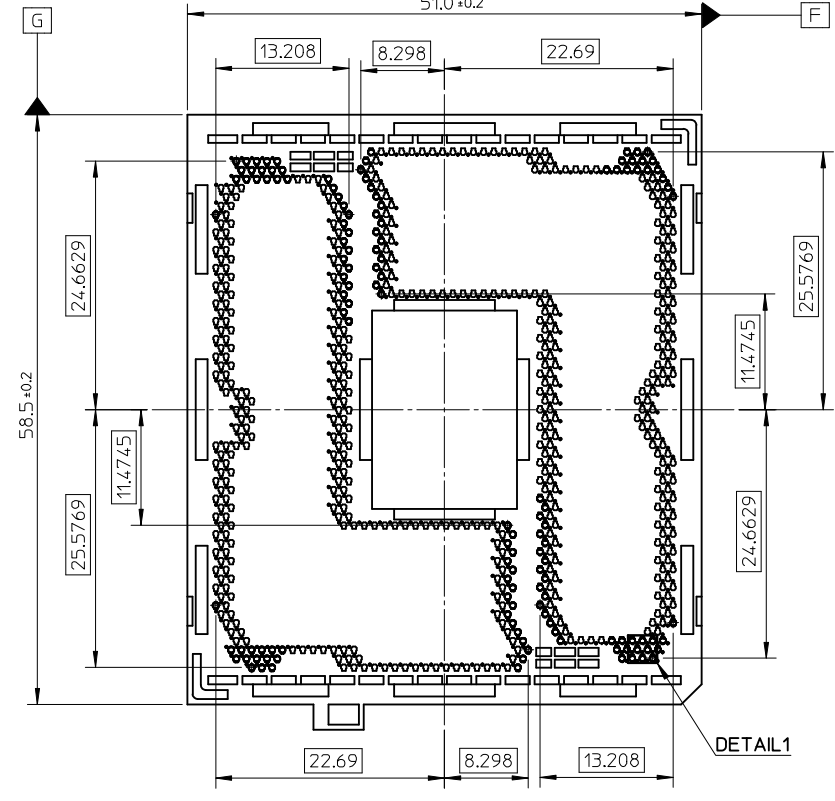
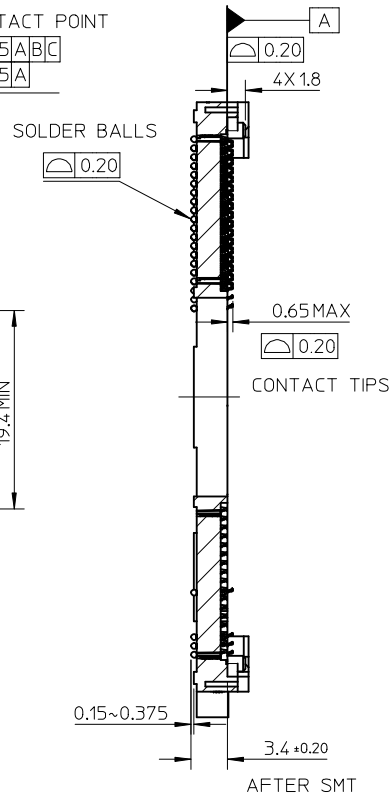
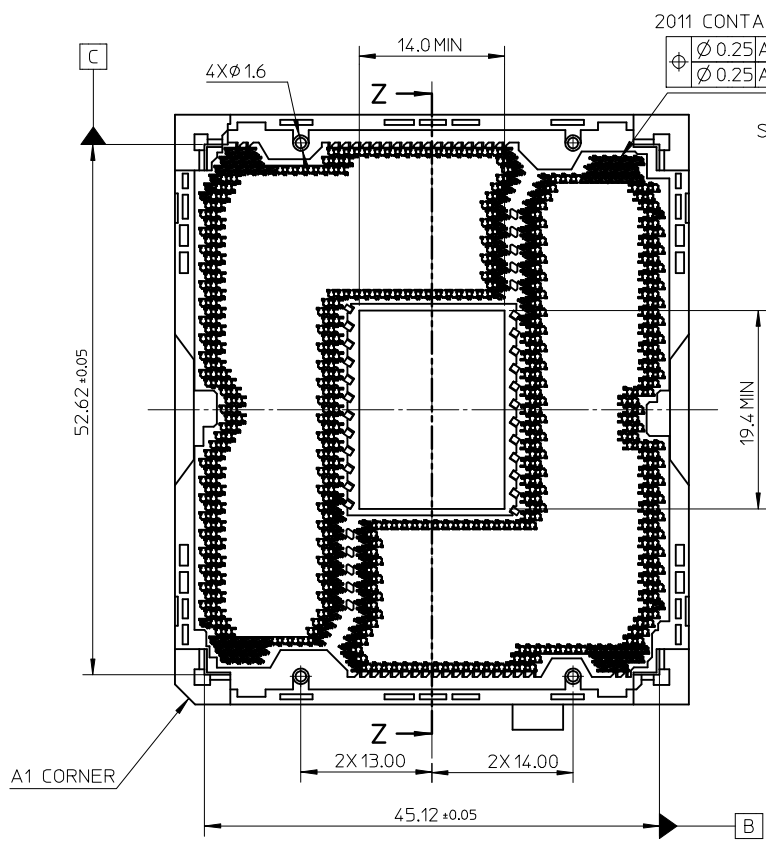

SECTION Z-Z

DETAIL1

<b>NEW RELEASE</b> EC NO: S2015-1419 DRW:DBFAN 2015/05/25 CHKD:SKTOH 2015/05/25 APPR:SKTOH 2015/07/29	DESCRIPTION REV A	QUALITY SYMBOLS $F_A=0$ $F_G=0$ $F_P=0$	GENERAL TOLERANCES (UNLESS SPECIFIED)		DIMENSION STYLE <b>MM ONLY</b>		SCALE <b>2:1</b>	DESIGN UNITS <b>METRIC</b>	THIRD ANGLE PROJECTION			
			mm	INCH	DRAWN BY	DATE	TITLE					
			4 PLACES	± ---	± ---	YXZHENG	2012/02/21	LGA 2011-3 SOCKET(R3)				
			3 PLACES	± ---	± ---	CHECKED BY	DATE	MOLEX INCORPORATED				
	2 PLACES	± 0.25	± ---	AYIN	2012/02/21	DOCUMENT NO.						
	1 PLACE	± 0.25	± ---	APPROVED BY	DATE	SHEET NO.						
		ANGULAR ± 3 °		AYIN	2014/09/02	SD-105142-003						
		DRAFT WHERE APPLICABLE MUST REMAIN WITHIN DIMENSIONS		MATERIAL NO.		SEE SHEET 4		2 OF 5				
				SIZE	THIS DRAWING CONTAINS INFORMATION THAT IS PROPRIETARY TO MOLEX INCORPORATED AND SHOULD NOT BE USED WITHOUT WRITTEN PERMISSION							
				A3								

9 8 7 6 5 4 3 2 1

10 9 8 7 6 5 4 3 2 1

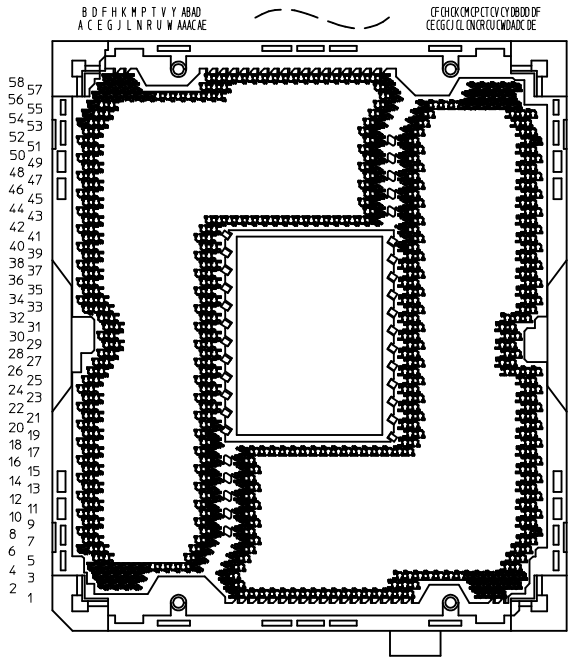

CONTACT NUMBER DEFINITION

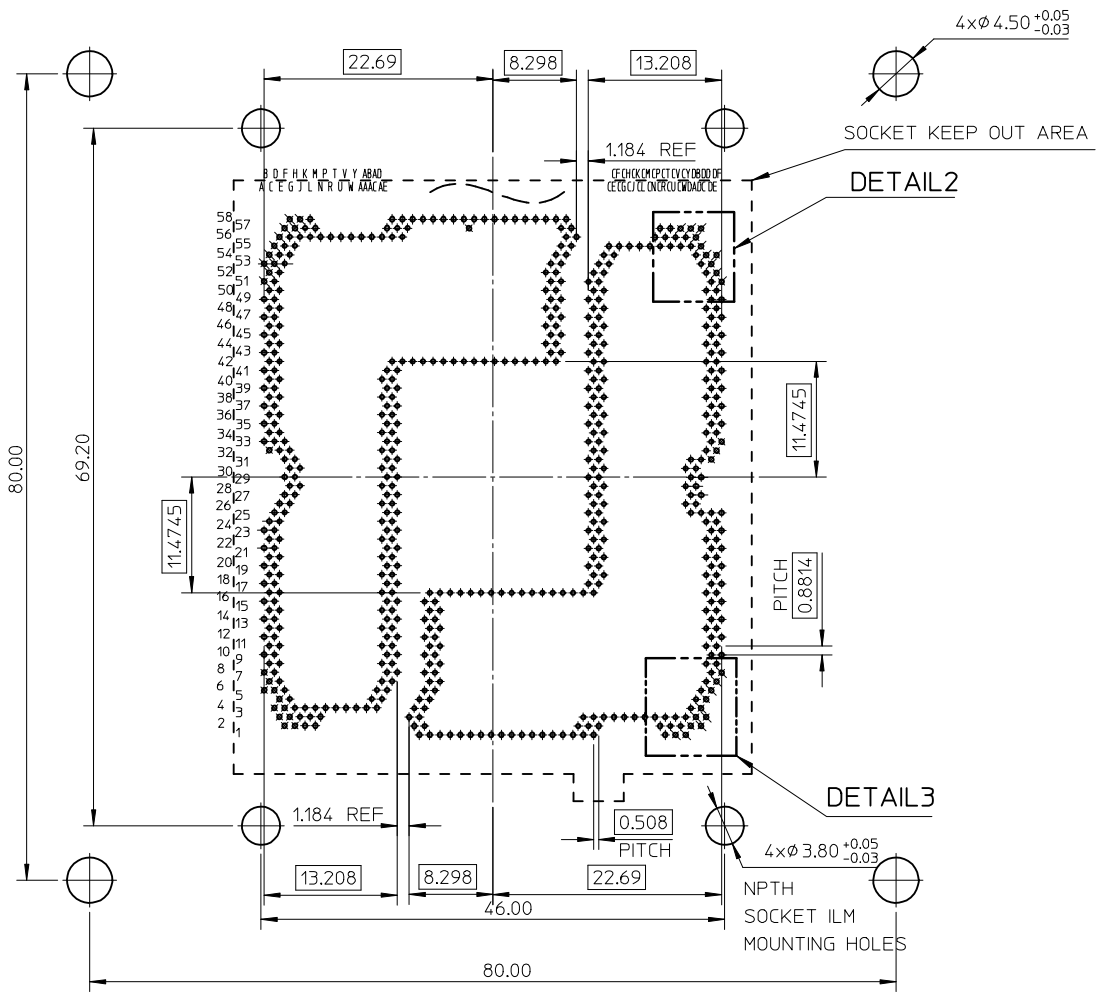

RECOMMENDED PCB LAYOUT FOR NORMAL FRAME

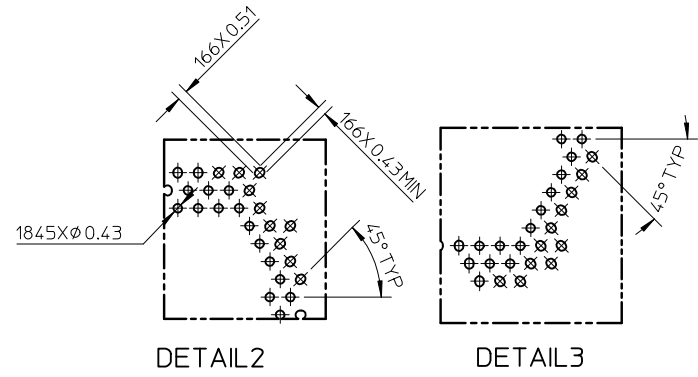

DETAIL2

DETAIL3

<b>NEW RELEASE</b> EC NO: S2015-1419 DRW:DBFAN 2015/05/25 CHKD:SKTOH 2015/05/25 APPR:SKTOH 2015/07/29	DESCRIPTION REV A	QUALITY SYMBOLS $\nabla_A = 0$ $\nabla_C = 0$ $\nabla_P = 0$	GENERAL TOLERANCES (UNLESS SPECIFIED) mm INCH 4 PLACES ± --- ± --- 3 PLACES ± --- ± --- 2 PLACES ± 0.25 ± --- 1 PLACE ± 0.25 ± --- ANGULAR ± 3 °	DIMENSION STYLE MM ONLY DRAWN BY YXZHENG CHECKED BY AYIN APPROVED BY AYIN MATERIAL NO. SEE SHEET 4	SCALE 2:1 DESIGN UNITS METRIC DATE 2012/02/21 DATE 2012/02/21 DATE 2014/09/02	THIRD ANGLE PROJECTION TITLE LGA 2011-3 SOCKET(R3) MOLEX INCORPORATED DOCUMENT NO. SD-105142-003
		DRAFT WHERE APPLICABLE MUST REMAIN WITHIN DIMENSIONS	SIZE A3	SHEET NO. 3 OF 5		
		THIS DRAWING CONTAINS INFORMATION THAT IS PROPRIETARY TO MOLEX INCORPORATED AND SHOULD NOT BE USED WITHOUT WRITTEN PERMISSION				
		REV F				

9 8 7 6 5 4 3 2 1

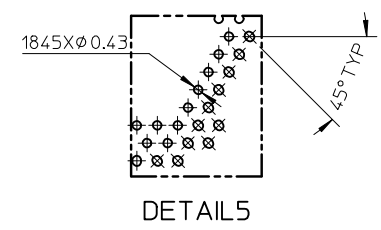
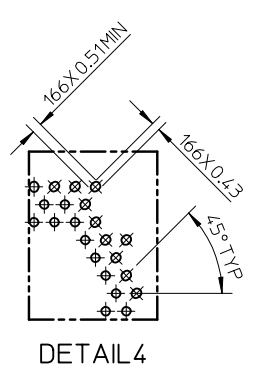
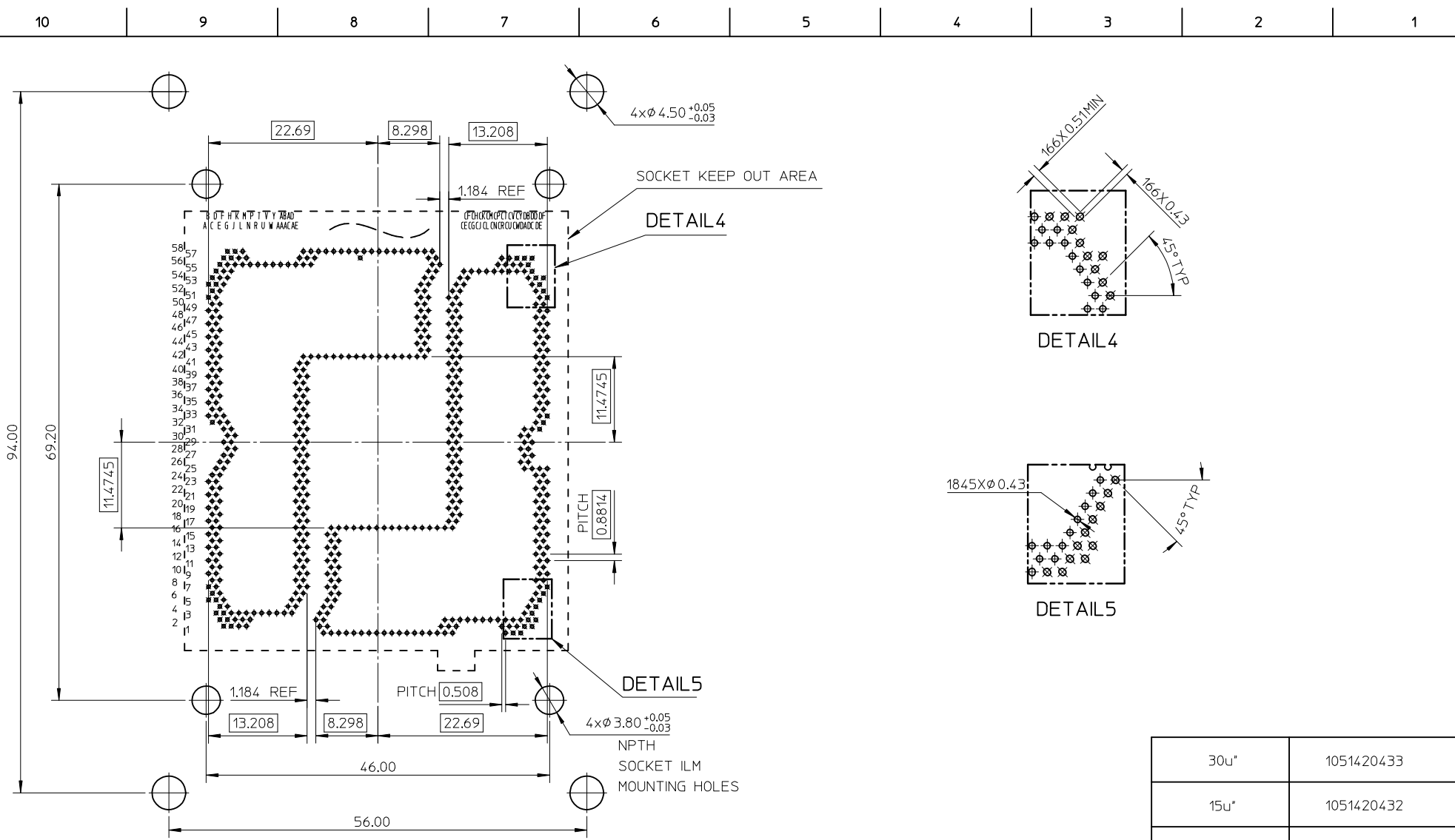

RECOMMENDED PCB LAYOUT  
FOR NARROW FRAME

30U"	1051420433
15U"	1051420432
GOLD THICKNESS	PART NUMBER

<b>NEW RELEASE</b> EC NO: S2015-1419 DRW: DBFAN 2015/05/25 CHKD: SKTOH 2015/05/25 APPR: SKTOH 2015/07/29	DESCRIPTION A	QUALITY SYMBOLS	GENERAL TOLERANCES (UNLESS SPECIFIED)	DIMENSION STYLE	SCALE	DESIGN UNITS	THIRD ANGLE PROJECTION	
		$F_A=0$ $F_G=0$ $F_P=0$	mm    INCH 4 PLACES ± --- ± --- 3 PLACES ± --- ± --- 2 PLACES ± 0.25 ± --- 1 PLACE ± 0.25 ± --- ANGULAR ± 3°	MM ONLY	2:1	METRIC		
			DRAFT WHERE APPLICABLE MUST REMAIN WITHIN DIMENSIONS	DRAWN BY: YXZHENG    DATE: 2012/02/21 CHECKED BY: AYIN    DATE: 2012/02/21 APPROVED BY: AYIN    DATE: 2014/09/02	TITLE: LGA 2011-3 SOCKET(R3)			
				MATERIAL NO. SEE TABLE SIZE: A3 THIS DRAWING CONTAINS INFORMATION THAT IS PROPRIETARY TO MOLEX INCORPORATED AND SHOULD NOT BE USED WITHOUT WRITTEN PERMISSION	MOLEX INCORPORATED DOCUMENT NO. SD-105142-003    SHEET NO. 4 OF 5			

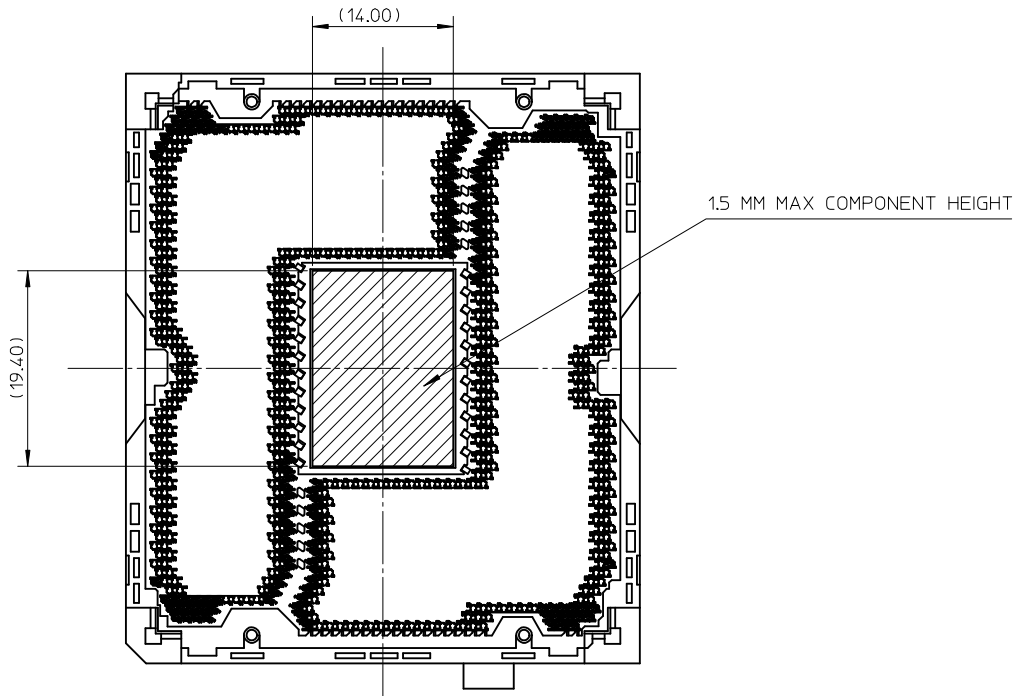

SOCKET R3 , TOP VIEW, REFERENCE KOZ

<b>NEW RELEASE</b> EC NO: S2015-1419 DRWING:DBFAN 2015/05/25 CHKD:SKTOH 2015/05/25 APPR:SKTOH 2015/07/29	QUALITY SYMBOLS	GENERAL TOLERANCES (UNLESS SPECIFIED)		DIMENSION STYLE <b>MM ONLY</b>		SCALE <b>2:1</b>	DESIGN UNITS <b>METRIC</b>	THIRD ANGLE PROJECTION		
	$\nabla_A = 0$ $\nabla_C = 0$ $\nabla_P = 0$	mm	INCH	DRAWN BY YXZHENG	DATE 2012/02/21	TITLE <b>LGA 2011-3 SOCKET(R3)</b>				
		4 PLACES	± ---	± ---	CHECKED BY AYIN	DATE 2012/02/21				
		3 PLACES	± ---	± ---	APPROVED BY AYIN	DATE 2014/09/02				
	2 PLACES	± 0.25	± ---	MATERIAL NO. <b>SEE TABLE</b>		DOCUMENT NO. <b>SD-105142-003</b>		SHEET NO. <b>5 OF 5</b>		
	1 PLACE	± 0.25	± ---	DRAFT WHERE APPLICABLE MUST REMAIN WITHIN DIMENSIONS						
	0 PLACE	± ---	± ---	SIZE <b>A3</b> THIS DRAWING CONTAINS INFORMATION THAT IS PROPRIETARY TO MOLEX INCORPORATED AND SHOULD NOT BE USED WITHOUT WRITTEN PERMISSION						
	ANGULAR ± 3 °									

## X-ON Electronics

Largest Supplier of Electrical and Electronic Components

*Click to view similar products for [IC & Component Sockets](#) category:*

*Click to view products by [Molex](#) manufacturer:*

Other Similar products are found below :

[0066-3-17-15-30-14-02-0](#) [670](#) [672](#) [673](#) [694-13-640-00-672-000](#) [712-93-120-41-001000](#) [714-93-104-31-018000](#) [8059-4G1-LF](#) [807-22-001-10-001101](#) [807-22-001-10-006101](#) [807-22-001-30-011101](#) [807-22-001-30-012101](#) [807-22-001-30-013101](#) [807-22-001-30-014101](#) [8-1437531-4](#) [8150-6P10](#) [833-93-034-10-001000](#) [851-41-006-10-001000](#) [851-43-008-20-001000](#) [851-43-014-20-001000](#) [851-93-006-20-001000](#) [851-93-010-20-001000](#) [853-43-020-10-001000](#) [86.010.0053.0](#) [116-43-308-41-007000](#) [PX-68LCC](#) [121-13-318-41-001000](#) [121-13-320-41-001000](#) [121-13-308-41-001000](#) [123-43-314-41-801000](#) [123-43-420-41-001000](#) [123-87-320-41-001101](#) [122-13-316-41-001000](#) [123-13-624-41-001000](#) [123-43-306-41-001000](#) [12-3513-11](#) [123-91-320-41-001000](#) [126-43-310-41-002000](#) [AKSUN 37V-T](#) [1437503-9](#) [1437504-1](#) [146-44-308-41-013000](#) [APO-320-G-T](#) [146-43-308-41-012000](#) [160-10-308-00-001000](#) [160-40-320-00-001000](#) [214-99-306-01-670800](#) [232-1270-02-0602](#) [2-382761-4](#) [2-5331677-4](#)