

PLEASE CHECK WWW.MOLEX.COM FOR LATEST PART INFORMATION

Part Number: [106501-3000](#)
Status: **Active**
Overview: [Fiber Optic Product Families](#)
Description: Industrial SFP, Receptacle with Panel Nut Assembly, Optical/Electrical

Documents:

[Drawing \(PDF\)](#) [RoHS Certificate of Compliance \(PDF\)](#)

General

Product Family	Fiber Optic Adapters
Series	106501
Component Type	N/A
Mates With	106059 Industrial Cable Assembly
Mode	Multimode, Singlemode
Overview	Fiber Optic Product Families
Product Name	Industrial, SFP
Type	Adapter
UPC	822350373081

Physical

Alignment Sleeve	N/A
Angled Physical Contact (APC)	No
Color - Resin	N/A
Ferrule Material	N/A
Gender	N/A
Material - Housing	Die-Cast
Mounting Style	Panel Nut
Net Weight	80.443/g
Orientation	Straight
Panel Mount	With Flange
Ports	1
Shutter	No

Electrical

Shield Type	EMI Gasket
Shielded	Yes

Material Info

Reference - Drawing Numbers

Sales Drawing	SD-106501-3000
---------------	----------------

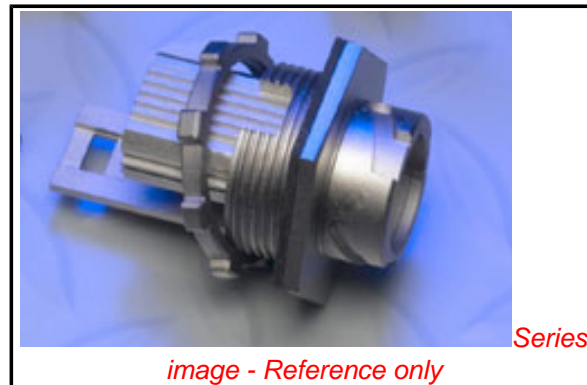

image - Reference only

EU RoHS

**ELV and RoHS
Compliant**
**REACH SVHC
Contains SVHC: No**
**Low-Halogen Status
Not Low-Halogen**

China RoHS



**Need more information on product
environmental compliance?**

Email productcompliance@molex.com
 For a multiple part number RoHS Certificate of
 Compliance, [click here](#)

Please visit the [Contact Us](#) section for any
 non-product compliance questions.

Search Parts in this Series

[106501Series](#)

X-ON Electronics

Largest Supplier of Electrical and Electronic Components

Click to view similar products for [Fibre Optic Connectors](#) category:

Click to view products by [Molex](#) manufacturer:

Other Similar products are found below :

[0004700001](#) [6100-R](#) [6313](#) [F709722200](#) [F709730000](#) [F718183204](#) [F727403500](#) [F727752800](#) [8119](#) [9440F20-27S-190](#) [944-120-6001](#)
[9441F10SL-3S](#) [9444W28-21S](#) [9444W36-10S](#) [9446F10SL-4S](#) [9446W20-16S](#) [953-101-5310-P](#) [954-101-57202B](#) [A0270169](#) [12-9122](#) [12-5702](#)
[AX101713](#) [AX102420](#) [AX103923](#) [AX104024](#) [AX104193](#) [AX104230](#) [AX104562](#) [AX105203-B25](#) [AX105205-S1](#) [EHSC2M](#) [17-300800](#)
[181-011-126](#) [181-011-S](#) [181-057-126](#) [HRFC-R2\(40\)](#) [NKSOPBUY](#) [20500002116](#) [2064996-1](#) [20800001065](#) [2170](#) [9132](#) [2612](#) [2620](#) [9291](#)
[9440F16-10S](#) [9440F20-18S](#) [9446F16-10S-190](#) [953-106-50231](#) [953-120-5003](#)