

3P to 5P



Receptacles

Single Keyway M12

#22 AWG PVC 12 inch leads - DC color code, epoxy potted
 Black anodized aluminum shell
 Used in control panels junction boxes and sensors

| | 3P | 4P | 5P |
|----------------|---------------------------------|---|---|
| MALE FACE VIEW | | | |
| COLOR CODE | 1- brown 3- blue 4- black | 1- brown 2- white 3- blue 4- black | 1 brown 2 white 3 blue 4 black 5 gray |
| VOLTAGE | 250V AC/DC | 250V AC/DC | 250V AC/DC |
| CURRENT | 4A | 4A | 4A |
| CONDUCTOR | #22-3 | #22-4 | #22-5 |

| MALE | FIG | RECEPTACLES WITH #22 AWG PVC LEADS 12 INCHES LONG | | |
|----------------|-----|---|---------------|---------------|
| M14 X 1 THREAD | 1 | 8R3E06A18A120 | 8R4E06A18A120 | 8R5E06A18A120 |
| 1/2" - 14NPT | 2 | 8R3006A18A120 | 8R4006A18A120 | 8R5006A18A120 |
| FEMALE | FIG | RECEPTACLES WITH #22 AWG PVC LEADS 12 INCHES LONG | | |
| 1/4" - 18NPT | 3 | 8R3A00A18A120 | 8R4A00A18A120 | 8R5A00A18A120 |

CATALOG OPTIONS

Use the following chart to modify your part's specifications

8R3E06A18A1201

LEAD TYPE

#18 AWG PVC **A16**

LEAD LENGTH

2 METER **M020**

SHELL

STAINLESS STEEL **.ADD 1**

Specifications

3P to 5P



MECHANICAL

SHELL: BLACK ANODIZED ALUMINUM
 OPTIONAL STAINLESS STEEL TYPE 303
 INSERT: NYLON 6/6
 CONDUCTORS: #22 AWG WITH PVC INSULATION
 OVER 26 X #36 COPPER STRANDING,
 300V, UL STYLE 1061, CSA AWM SR
 NITRILE RUBBER

ELECTRICAL

VOLTAGE RATING: 250V AC/DC
 AMPERAGE: 3P - 4A
 4P - 4A
 5P - 4A

ENVIRONMENTAL

PROTECTION: IP 68, NEMA 6P
 AMBIENT OPERATING TEMP: -4° TO 176° F (-20° TO 80°C)

CERTIFICATIONS

UL: 3P & 4P UL LISTED, FILE NO.
 E152210; 5P UL RECOGNIZED
 CSA: CSA CERTIFIED, FILE NO LR6837

RECEPTACLE DIMENSIONS

MALE RECEPTACLE W/ EXTERNAL THREADS M14 X 1 THREADS

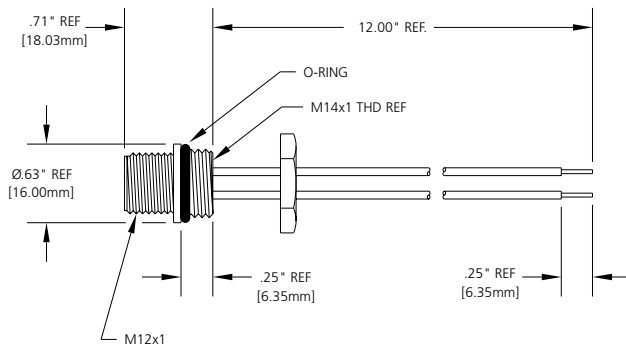

TYPICAL KNOCKOUT

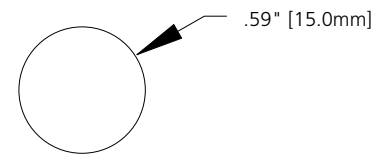
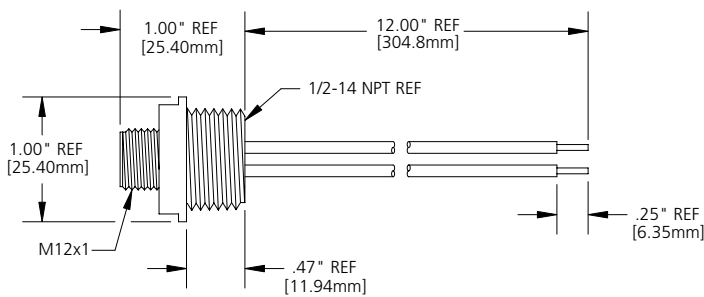

FIG 1

MALE RECEPTACLE W/ EXTERNAL THREADS AND 1/2" - 14NPT THREADS



TYPICAL KNOCKOUT

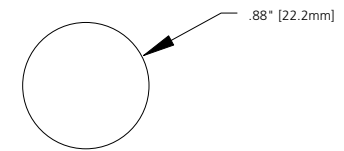
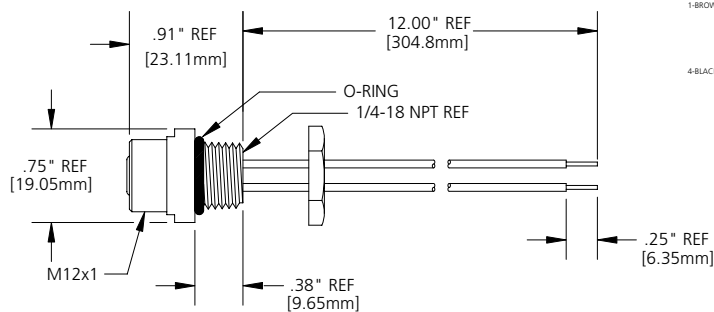
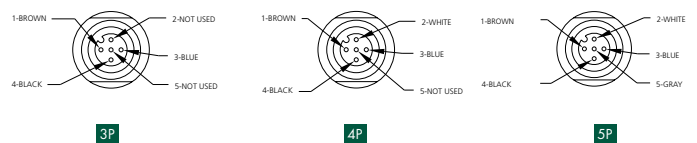

FIG 2

FEMALE RECEPTACLE W/ INTERNAL THREADS AND 1/4" - 18NPT THREADS



FACE VIEW



TYPICAL KNOCKOUT

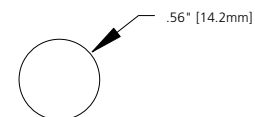

FIG 3

X-ON Electronics

Largest Supplier of Electrical and Electronic Components

Click to view similar products for [Circular Metric Connectors](#) category:

Click to view products by [Molex](#) manufacturer:

Other Similar products are found below :

[1424048](#) [1021212](#) [600X518037X](#) [6STD09SAM99B70X](#) [6STD15PCR99B70A](#) [8R4000A16M020](#) [1200910002](#) [1201150041](#) [1203580030](#)
[1200700064](#) [1200700263](#) [1200700416](#) [1200730102](#) [1200770002](#) [1-2823588-2](#) [130203-0054](#) [1300140026](#) [1300150099](#) [1-3637-600-5205](#)
[1545399](#) [1594331](#) [1600413](#) [1612606](#) [1612618](#) [1614660](#) [1A4000-348](#) [CA06EW24-10P-B-03](#) [21036836414](#) [2823064-1](#) [1610759](#) [A1642LK-](#)
[II-T](#) [1R3006A20M005](#) [41-01016](#) [41-40011](#) [41-40017](#) [42-00006](#) [42-01015](#) [4-22279-4](#) [4-22281-1](#) [4-22284-9](#) [43-00002](#) [43-00113](#) [43-00130](#)
[43-01028](#) [43-01034](#) [43-01088](#) [43-01090](#) [43-01203](#) [43-01209](#) [43-01335](#)