

M8 3POLE MALE

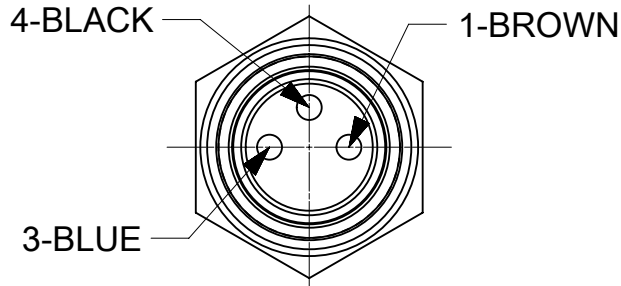

M8 4POLE MALE

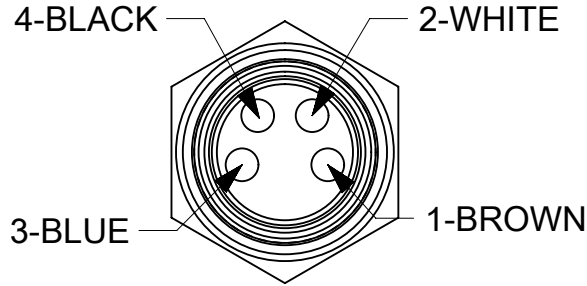

M8 5POLE MALE

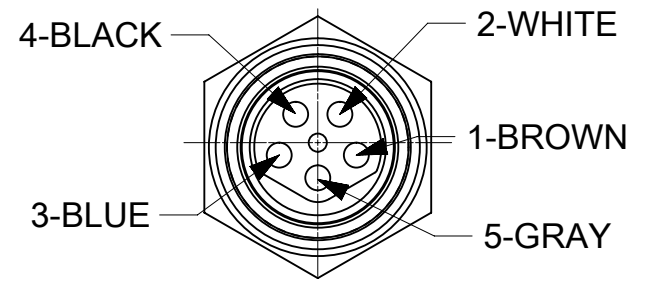

VIEWS FROM THE FRONT SIDE

PART LIST

MOLEX PN	ENGINEERING PN	L+Tol.[mm]
1200900016	4R3P00A27C300	300 + 19
1200900018	4R3P00A27M010	1000 + 55
1200900019	4R3P00A27M020	2000 + 89
1200900029	4R4P00A27C300	300 + 19
1200900031	4R4P00A27M010	1000 + 55
1200900037	4R5P00A27C300	300 + 19
1200900076	4R5P00A27M010	1000 + 55

L + Tol.[mm] - SEE PART LIST

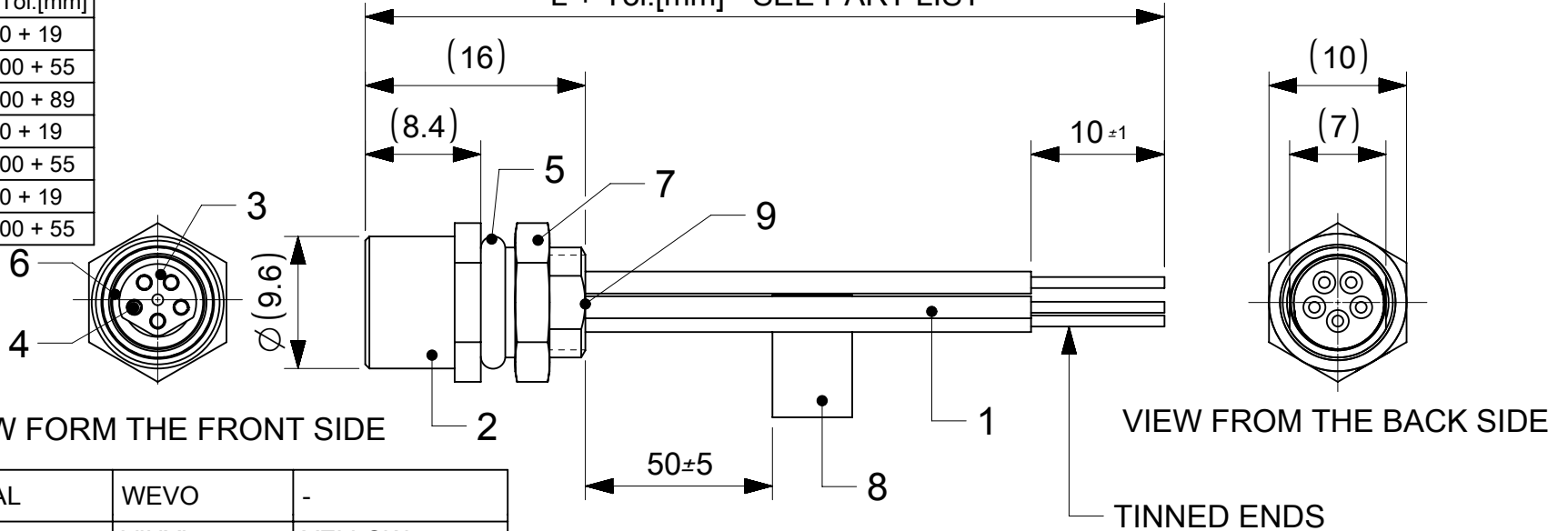

VIEW FORM THE FRONT SIDE

VIEW FROM THE BACK SIDE

TINNED ENDS

BOM

9	-	POTTING MATERIAL	WEVO	-
8	1	LABEL	VINYL	YELLOW
7	1	LOCKNUT M8X0.5	BRASS	NICKEL PLATED
6	1	GASKET	FKM	RED
5	1	O-RING	NBR	BLACK
4	3/4/5	CONTACT 10 FE	BRONZE	GOLD OVER NICKEL PLATED
3	1	INSERT M8 FE XP	ELASTOLLAN	BLACK
2	1	REC SHELL M8(FE)XM8(M)	BRASS	NICKEL PLATED
1	-	WIRES;24AWG;OD=1.43mm	PVC	-
ITEM	QTY	DESCRIPTION	MATERIAL	FINISH/COLOR

SYMBOLS		THIS DRAWING CONTAINS INFORMATION THAT IS PROPRIETARY TO MOLEX ELECTRONIC TECHNOLOGIES, LLC AND SHOULD NOT BE USED WITHOUT WRITTEN PERMISSION	
SYMBOL	VALUE	DIMENSION UNITS	SCALE
∇ = 0	0	mm	2:1
∇ = 0	0	GENERAL TOLERANCES (UNLESS SPECIFIED)	
∇ = 0	0	ANGULAR TOL ± 1.0°	
∇ = 0	0	4 PLACES	±
∇ = 0	0	3 PLACES	±
∇ = 0	0	2 PLACES	± 0.05
∇ = 0	0	1 PLACE	± 0.3
∇ = 0	0	0 PLACES	± 0.5
∇ = 0	0	DRAFT WHERE APPLICABLE MUST REMAIN WITHIN DIMENSIONS	
∇ = 0	0	THIRD ANGLE PROJECTION	DRAWING

CURRENT REV DESC:	
EC NO: 605345	
DRWN: MKOWALCZYK01	2018/10/02
CHK'D: MIWASIECZKO	2018/10/03
APPR: MIWASIECZKO	2018/10/03
INITIAL REVISION:	
DRWN: MKOWALCZYK01	2018/10/02
APPR: MIWASIECZKO	2018/10/03

molex	
NC XP F/FR XM M8 X 0.5	
PRODUCT CUSTOMER DRAWING	
DOCUMENT NUMBER	DOC TYPE DOC PART REVISION
1200908076	PSD 000 A
MATERIAL NUMBER	CUSTOMER
SEE PART LIST	GENERAL MARKET
SHEET NUMBER	1 OF 1

DOCUMENT STATUS	P1	RELEASE DATE	2018/10/03	13:41:36
-----------------	----	--------------	------------	----------

MATERIAL NUMBER	OLD PART NUMBER	FINISHED LENGTH
120090-0016	4R3P00A27C300	11.81" +.75" -0 [1.3M +19.1 -0]
120090-0018	4R3P00A27M010	3.28' +2.19" -0 [1.0M +55.6 -0]
120090-0029	4R4P00A27C300	11.81" +.75" -0 [1.3M +19.1 -0]
120090-0031	4R4P00A27M010	3.28' +2.19" -0 [1.0M +55.6 -0]
120090-0037	4R5P00A27C300	11.81" +.75" -0 [1.3M +19.1 -0]

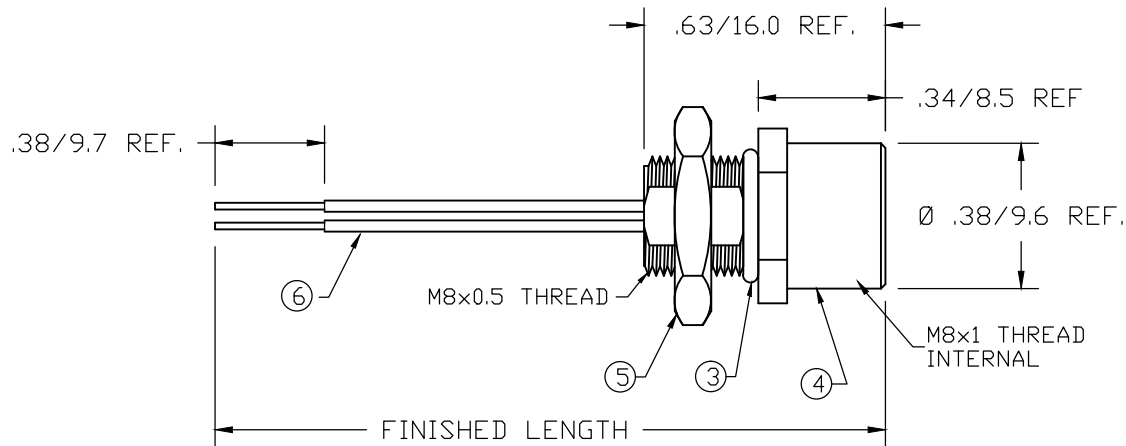

3 POLE FEMALE FACE VIEW

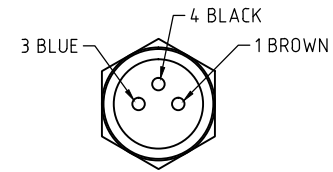

4 POLE FEMALE FACE VIEW

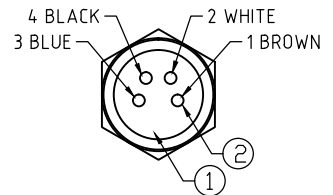

5 POLE FEMALE FACE VIEW

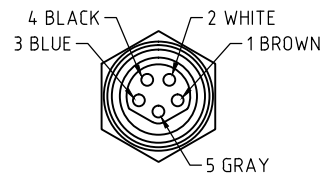

VOLTAGE RATING FOR 3 AND 4 POLE	60 VAC/ 75 VDC
VOLTAGE RATING FOR 5 POLE	30 VAC/VDC
AMPERAGE RATING FOR 3 AND 4 POLE	3 AMPS
AMPERAGE RATING FOR 5 POLE	3 AMPS
PROTECTION	IP67
OPERATING TEMPERATURE	-20°C TO 105°C
UL CERTIFICATIONS	UL LISTED, FILE NO. E152210
CSA CERTIFICATIONS	CSA CERTIFIED, FILE NO. LR6837

ITEM	COMPONENT	MATERIAL	FINISH
1	INSERT	POLYURETHANE	BLACK
2	CONTACT PIN	COPPER ALLOY	GOLD OVER NICKEL
3	O-RING	NITRILE	BLACK
4	RECEPTACLE SHELL	BRASS	NICKEL PLATED
5	LOCKNUT	BRASS	NICKEL PLATED
6	CONDUCTOR- 24 AWG, (.22mm) COPPER STRANDING) 3 CONDUCTOR	PVC	SEE WIRING DIAGRAM

RLSO DRAWING EC NO: WEU2012-0155 DRWN: VOU CHKD: KJOZWIK APPR: JFMURPHY 2009/08/28 11/10/11	QUALITY SYMBOLS ▽=0 ▽C=0
--	--------------------------------

	GENERAL TOLERANCES (UNLESS SPECIFIED)	
	mm	INCH
4 PLACES	±--	±---
3 PLACES	±--	±.005
2 PLACES	±.15	±.01
1 PLACE	±0.3	±0.020
ANGULAR ±1/2°		
DRAFT WHERE APPLICABLE MUST REMAIN WITHIN DIMENSIONS		

DIMENSION STYLE	SCALE	DESIGN UNITS	THIRD ANGLE PROJECTION
IN/MM	2:1	METRIC	
DRAWN BY	DATE	TITLE	
BW	2009/08/26	M8 FEMALE RECEPTACLE 3-5P M8X0.5 MOUNTING THD	
CHECKED BY	DATE	MOLEX INCORPORATED	
LH	2009/08/26	SD-120090-009	
APPROVED BY	DATE	SHEET NO.	
JFMURPHY	2009/08/28	1 OF 1	
MATERIAL NO.	DOCUMENT NO.	THIS DRAWING CONTAINS INFORMATION THAT IS PROPRIETARY TO MOLEX INCORPORATED AND SHOULD NOT BE USED WITHOUT WRITTEN PERMISSION	
SEE CHART			

6

5

4

3

2

1

## X-ON Electronics

Largest Supplier of Electrical and Electronic Components

*Click to view similar products for [D-Sub Micro-D Connectors](#) category:*

*Click to view products by [Molex](#) manufacturer:*

Other Similar products are found below :

[M243082311F](#) [M2430834F](#) [M24308/4-6F](#) [65-1920-15](#) [M83513/01-HN](#) [M83513/03-A10N](#) [M83513/03-B14C](#) [M83513/03-D09C](#) [M83513/03-D11N](#) [M83513/03-G02N](#) [M83513/03-G05N](#) [M83513/03-G08C](#) [M83513/03-G09N](#) [M83513/03-G12N](#) [M83513/03-H13N](#) [M83513/04-E15N](#) [M83513/04-G04C](#) [M83513/10-E01NP](#) [M83513/13-B01NP](#) [M83513/13-C01NN](#) [M83513/16-A01CP](#) [M83513/22-D01NP](#) [M83513/25-B01NP](#) [6R2004A30F015](#) [6R4006A28A120](#) [703006A13F060](#) [704002A03F200](#) [705001A13F120](#) [7-1532020-5](#) [748567-1-P](#) [MDB1-31SH003](#) [MDM-15PBS-L58](#) [MDM-15PCBRM7T](#) [MDM-15PH003B-A174](#) [75-068624-59S](#) [MDM-15PH034B](#) [MDM-15SH001L](#) [MDM-15SH004B](#) [MDM-21PH003K](#) [MDM-25PH003B-A174](#) [MDM-25PHW01F-A174](#) [MDM-37PH006L-A174](#) [MDM-37PH048M5-A174](#) [MDM-37SCBRP-A174](#) [MDM-51PBS-L56](#) [MDM-51PSF](#) [MDM-51SH003M7](#) [MDM-51SSM7-A174](#) [MDM-9PBSP-L58](#) [MDM-9PH003M7](#)