

**PLEASE CHECK WWW.MOLEX.COM FOR LATEST PART INFORMATION**

**Part Number:** [1730410001](#)  
**Status:** **Active**  
**Overview:** [ValuSeal Wire-to-Wire Connector System](#)  
**Description:** [ValuSeal Crimp Terminal, Male, 16-18 AWG, Tin \(Sn\)](#)

**Documents:**

<a href="#">Drawing (PDF)</a>	<a href="#">Packaging Specification PK-173041-0001-000 (PDF)</a>
<a href="#">Product Specification 1728770001-PS-000 (PDF)</a>	<a href="#">Test Summary 1728770001-TS-000 (PDF)</a>
<a href="#">Application Specification 1728770001-AS-000 (PDF)</a>	<a href="#">RoHS Certificate of Compliance (PDF)</a>

**General**

Product Family	Crimp Terminals
Series	<a href="#">173041</a>
Application	Power, Wire-to-Wire
Comments	See Product Specification for maximum current rating by circuit size and wire AWG, See Product Specification for maximum current rating by circuit size and wire AWG
Crimp Quality Equipment	Yes
Overview	<a href="#">ValuSeal Wire-to-Wire Connector System</a>
Product Name	ValuSeal
UPC	889056306539

**Physical**

Durability (mating cycles max)	25
Gender	Male
Material - Metal	Copper Alloy
Material - Plating Mating	Tin
Material - Plating Termination	Tin
Net Weight	0.139/g
Packaging Type	Reel
Plating min - Mating	1.524µm
Termination Interface: Style	Crimp or Compression
Wire Insulation Diameter	1.90-2.03mm
Wire Size AWG	16, 18
Wire Size mm <sup>2</sup>	0.82-1.31

**Electrical**

Current - Maximum per Contact	11.0A
Voltage - Maximum	250V AC

**Solder Process Data**

Lead-free Process Capability	N/A
------------------------------	-----

**Material Info**

**Reference - Drawing Numbers**

Application Specification	1728770001-AS-000
Packaging Specification	PK-173041-0001-000
Product Specification	1728770001-PS-000
Sales Drawing	SD-173041-0001-000
Test Summary	1728770001-TS-000

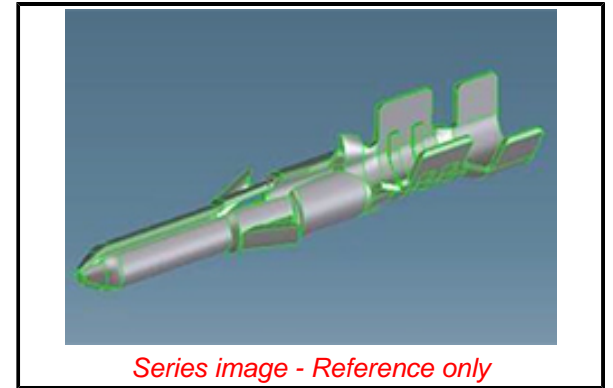

Series image - Reference only

**EU ELV**

**Not Relevant**

**EU RoHS**

**Compliant**

**REACH SVHC**

Not Contained Per  
-ED/88/2018 (15  
January 2019)

**Halogen-Free**

**Status**

**Low-Halogen**

For more information, please visit [Contact US](#)

China ROHS

ELV

RoHS Phthalates

**China RoHS**

Green Image

Not Relevant

Not Contained

**Search Parts in this Series**

[173041](#) Series

**Use With**

ValuSeal Plug Housing [172877](#)

**Application Tooling | FAQ**

*Tooling specifications and manuals are found by selecting the products below. Crimp Height Specifications are then contained in the Application Tooling Specification document.*

**Global**

**Description**

**Product #**

Hand Crimp Tool for	<a href="#">638278200</a>
ValuSeal Terminals,	
16 AWG UL1061, 18	
AWG UL1007 and 18	
AWG UL1095 Wires	
FineAdjust Applicator	<a href="#">639038900</a>
for ValuSeal	
Terminals, 16 AWG	
UL1061, 18 AWG	
UL1007 and 18 AWG	
UL1095 wires	

This document was generated on 04/23/2019

**PLEASE CHECK [WWW.MOLEX.COM](http://WWW.MOLEX.COM) FOR LATEST PART INFORMATION**

## X-ON Electronics

Largest Supplier of Electrical and Electronic Components

*Click to view similar products for [Heavy Duty Power Connectors](#) category:*

*Click to view products by [Molex](#) manufacturer:*

Other Similar products are found below :

[647757-1](#) [6643411-1](#) [6646058-2](#) [6646137-1](#) [6646138-1](#) [6646479-1](#) [6646608-1](#) [6646786-1](#) [6646940-1](#) [6651091-1](#) [6651525-1](#) [6651529-1](#)  
[6651788-1](#) [696475-1](#) [702-32-01109](#) [703-25-02205](#) [73000005059](#) [73000005642](#) [765-15-0080A](#) [765-16-0080B](#) [765-18-0080D](#) [829992-1](#)  
[902-77-02113](#) [PS00/A0620/6300](#) [129-1J](#) [1409400](#) [AN0024023](#) [E6374G1](#) [e6389g2](#) [157-43GW8](#) [MS3117-14AC](#) [1643543-1](#) [1650540-1](#)  
[1651811-2](#) [1766260-1](#) [1766282-1](#) [1766966-1](#) [1791340000](#) [NLDFT-3-BL-L-S120-M40A](#) [NLDFT-N-W-L-C240-M40B](#) [NLS-2-R-C240-](#)  
[M40B](#) [NLS-N-W-C240-M40B](#) [NPS-3-BL-T6](#) [1986615-1](#) [2-1589900-8](#) [2199314-1](#) [KA8102](#) [9300480317](#) [SBS50BRN#6](#) [29131](#)