

PLEASE CHECK WWW.MOLEX.COM FOR LATEST PART INFORMATION

Part Number: [1731120307](#)
Status: **Active**
Overview: [FCT D-Sub Connectors](#)
Description: FCT Locking Plate for Spring Lock, for Size 1-4 D-sub, with Mounting Screws, Stainless Steel

Documents:

[Packaging Specification 1731120005-PK-000 \(PDF\)](#) [RoHS Certificate of Compliance \(PDF\)](#)
[Brochure \(PDF\)](#)

General

Product Family	D-Sub Products
Series	173112
Accessory Type	Locking Plate
IP Rating	N/A
Overview	FCT D-Sub Connectors
Product Category	Accessories
Product Name	FCT Products
Taxonomy	D-Sub Accessories
UPC	889056817097

Physical

Material - Body	Stainless Steel
Material - Screw	Stainless Steel
Net Weight	1.500/g
Packaging Type	Bag
Thread Size	4-40 UNC
Thread Type	Standard

Material Info

Engineering Number	F1044-1
--------------------	---------

Reference - Drawing Numbers

Packaging Specification	1731120005-PK-000
-------------------------	-------------------

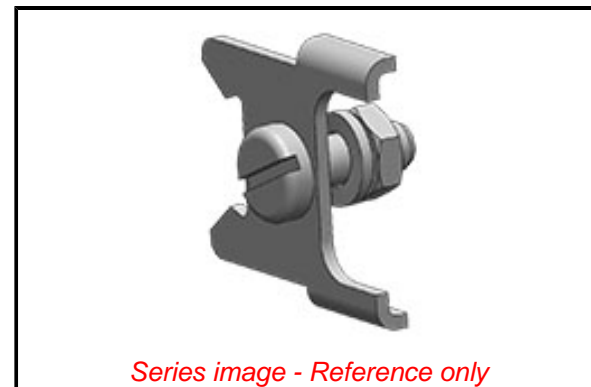

EU ELV

Not Relevant

EU RoHS

Compliant

REACH SVHC

Not Contained Per -
D(2022)4187-DC (10
June 2022)

Halogen-Free

Status

Not Reviewed

For more information, please visit [Contact US](#)

China ROHS

ELV

RoHS Phthalates

China RoHS

Green Image

Not Relevant

Not Contained

Search Parts in this Series

[173112](#) Series

Use With

FCT D-Sub, Sizes 1-4

X-ON Electronics

Largest Supplier of Electrical and Electronic Components

Click to view similar products for [Other Tools](#) category:

Click to view products by [Molex](#) manufacturer:

Other Similar products are found below :

[899-2-KT46](#) [568681-1](#) [CR-12FP4--260R](#) [5800-0090](#) [58061-1](#) [59085](#) [00-8273-RDPP](#) [593033](#) [593072](#) [593564100](#) [593575](#) [593593](#) [011349-000](#) [CRCW08052740FRT1](#) [LUC-012S070DSM](#) [LUC-018S070DSP](#) [LUC-024S105DSP](#) [599-2021-3-NME](#) [599-JJ-2021-03](#) [00-5080-YWPP](#) [00-9089-RDPP](#) [00-9300-RDPP](#) [CRCW2010331JR02](#) [601-JJ-06](#) [601-SPB](#) [601YSY](#) [602-JJ-03](#) [602SPB](#) [603-JJ-07-FP](#) [603-JJY-04](#) [CRTN1013](#) [CS16](#) [6-1579014-0](#) [6203](#) [6240-1](#) [M43435 TY 2 SZ 3 FIN B BLK](#) [M43435 TY 5 SZ 3 FIN C NAT](#) [M-5Z](#) [M6816](#) [660-29ABT1](#) [662508-1](#) [CVHD-950X-93.333](#) [CW104-01X](#) [671-GP-04-KT39-73207](#) [CW307-01A](#) [CW30901A](#) [CW6211201A](#) [679793-1](#) [690124-7](#) [690191-](#)