

PLEASE CHECK WWW.MOLEX.COM FOR LATEST PART INFORMATION

Part Number:

1731120406

Status:

Active

Overview:

FCT D-Sub Connectors

Description:

FCT Slide Lock Post, M3 Thread, Tin-plated Steel

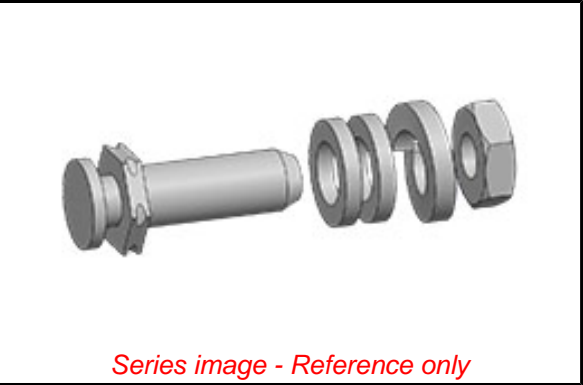

Documents:	
Brochure (PDF)	RoHS Certificate of Compliance (PDF)
General	
Product Family	D-Sub Products
Series	173112
Accessory Type	Slide Lock Post
IP Rating	N/A
Overview	FCT D-Sub Connectors
Product Category	Accessories
Product Name	FCT Products
UPC	191128209656
Physical	
Material - Body	Steel
Net Weight	0.800/g
Packaging Type	Bag
Thread Size	M3
Thread Type	Standard
Material Info	
Engineering Number	F-SGV1/5-K140SN

EU ELV	
Not Relevant	
EU RoHS	China RoHS
Compliant with Exemption 6(a)-I	
REACH SVHC	
Not Reviewed	
Halogen-Free	
Status	
Not Reviewed	
For more information, please visit Contact US	
China ROHS	50 Image
ELV	Not Relevant
RoHS Phthalates	Not Contained

Search Parts in this Series

173112 Series

PLEASE CHECK WWW.MOLEX.COM FOR LATEST PART INFORMATION

X-ON Electronics

Largest Supplier of Electrical and Electronic Components

Click to view similar products for [D-Sub Tools & Hardware](#) category:

Click to view products by [Molex](#) manufacturer:

Other Similar products are found below :

[000-01-09-132](#) [000-01-21-132](#) [000-01-31-162](#) [572019-00105-70](#) [000-01-37-162](#) [621-250-113-115](#) [D110550-2](#) [D20418-137](#) [780-518-50SG6-](#)
[WS](#) [86552009](#) [86553115TLF](#) [86553117TLF](#) [1230032-1](#) [1-5021101-2](#) [15-000050](#) [1589283-4](#) [160-000-005R031](#) [16-000230](#) [160-025-](#)
[004R031](#) [160-020-209R000](#) [160X10909X](#) [164C03939A](#) [177-505-A-2-2](#) [1-966830-8](#) [21018-6](#) [2-1393560-9](#) [JS-1000](#) [L17D204182M3E](#)
[L17D53018](#) [300X10779X](#) [160X10189X](#) [160X10419X](#) [162-000-050R000](#) [21018-5](#) [212561-3](#) [248C21550X](#) [CF15P](#) [QLOCKPOST-2](#)
[D110277](#) [500-008NF1K-01](#) [500-008NF3R3KS-01](#) [500-017M09FN](#) [500-017M15MHN](#) [500-024M1](#) [500-068M3](#) [5-1393561-5](#) [C115373-0001](#)
[C115373-0002](#) [3342-4-KIT](#) [K1003](#)