

PLEASE CHECK WWW.MOLEX.COM FOR LATEST PART INFORMATION

Part Number: **0190100031**
Status: **Active**
Overview: Standard Quick-Disconnect Terminals
Description: Krimptite Piggyback Quick Disconnect, Tab 6.35 x 0.81mm, 18-22 AWG

Documents:

[3D Model](#) [Product Specification PS-19902-011-001 \(PDF\)](#)
[Drawing \(PDF\)](#) [Product Specification PS-19902-015-001 \(PDF\)](#)
[3D Model \(PDF\)](#) [RoHS Certificate of Compliance \(PDF\)](#)

General

Product Family Quick Disconnects
Series 19010
Crimp Quality Equipment Yes
Insulated No
Overview Standard Quick-Disconnect Terminals
Product Name Krimptite
Type Quick Disconnect
UPC 822350947800

Physical

Barrel Type Closed
Gender Female
Glow-Wire Capable No
Insulation None
Lock to Mating Part No
Material - Metal Brass
Material - Plating Mating Tin
Material - Plating Termination Tin
Net Weight 0.897/g
Orientation Straight
Packaging Type Adhesive Tape on Reel
Polarized to Mating Part Yes
Tab Thickness 0.81mm
Tab Width 6.35mm
Temperature Range - Operating 149°C
Wire Insulation Diameter 2.79mm max.
Wire Size AWG 18, 20, 22

Electrical

Voltage - Maximum N/A

Solder Process Data

Lead-freeProcess Capability N/A

Material Info

Engineering Number AA-1301T

Reference - Drawing Numbers

Product Specification PS-19902-011-001, PS-19902-015-001
Sales Drawing SD-19010-001

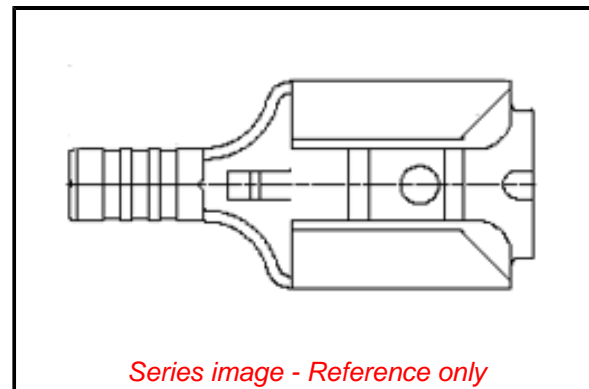

Series image - Reference only

EU ELV

Not Relevant

EU RoHS

Compliant

REACH SVHC

Not Contained Per -
D(2020)9139-DC (19
Jan 2021)

Halogen-Free

Status

Low-Halogen

For more information, please visit [Contact US](#)

China ROHS

ELV

RoHS Phthalates

China RoHS

Green Image

Not Relevant

Not Contained

Search Parts in this Series

19010 Series

Application Tooling | [FAQ](#)

Tooling specifications and manuals are found by selecting the products below. Crimp Height Specifications are then contained in the Application Tooling Specification document.

Global

Description

Product #

ATP Crimp Dies 198002090
for the Tape Crimp
Module and ATP-101
& 301 Press

X-ON Electronics

Largest Supplier of Electrical and Electronic Components

Click to view similar products for [Terminals](#) category:

Click to view products by [Molex](#) manufacturer:

Other Similar products are found below :

[0-0031894-0](#) [0-0035108-0](#) [0-0036150-0](#) [00051128587317](#) [00051128588178](#) [00051128588642](#) [00-054007-01074-6](#) [00-054007-49560-4](#) [00-054007-70206-1](#) [00-054007-70209-2](#) [00-054007-70210-8](#) [00-054007-70217-7](#) [00-054007-70225-2](#) [00-054007-70226-9](#) [00-054007-70227-6](#) [00-054007-70228-3](#) [00-054007-70231-3](#) [00-054007-70241-2](#) [00-054007-70242-9](#) [00-054007-70244-3](#) [00-054007-70246-7](#) [00-054007-70248-1](#) [00-054007-70256-6](#) [00-054007-70263-4](#) [00-054007-70288-7](#) [00-054007-70290-0](#) [00-054007-70300-6](#) [00-054007-70301-3](#) [00-054007-70304-4](#) [00-054007-70316-7](#) [0-0130008-0](#) [0-0130171-0](#) [0-0130532-0](#) [0-0131330-0](#) [0-0160298-0](#) [0-0165034-0](#) [0-0165536-1](#) [0-0320562-0](#) [0-0321045-0](#) [00581P0075](#) [010996B](#) [01-1103-1-0212](#) [01-1103-1-0219](#) [01-2010-1-0212](#) [01-2065-1-0216](#) [0124300000](#) [0124400000](#) [0124700000](#) [0124800000](#) [01-2900-1-04410](#)