

LOOSE PIECE		TAPE MOUNTED		SPECIFICATIONS						
MATERIAL NUMBER	ENGINEERING NUMBER	MATERIAL NUMBER	ENGINEERING NUMBER	STUD SIZE	"S" ±.005 [0.13]	"W" ±.010 [0.25]	"C" MIN.	"L" MAX.	"H"	STOCK ±.001 [0.025] THICKNESS
190570037	B-501-12HD	---	---	12	.515 [13.08]	.750 [19.05]	.611 [15.52]	1.700 [43.18]	---	.050 [1.27]
190570041	B-501-76HD	---	---	76	.453 [11.51]					
190570067	B-528-08HD	---	---	8	.173 [4.39]	.375 [9.53]	.303 [7.70]	1.205 [30.61]	---	.050 [1.27]
190570069	B-528-10HD	---	---	10	.198 [5.03]					
190570073	B-530-14HD	---	---	14	.265 [6.73]	.530 [13.46]	.393 [9.98]	1.372 [34.85]	---	.050 [1.27]
190570075	B-530-56HD	---	---	56	.328 [8.33]					
190570082	B-536-06HD	---	---	6	.146 [3.71]	.282 [7.16]	.306 [7.77]	1.161 [29.49]	---	.050 [1.27]
190570084	B-536-08HD	---	---	8	.173 [4.39]					
190570109	B-540-38HD	190570110	B-540-38HDT	38	.390 [9.91]	.592 [15.04]	.466 [11.84]	1.476 [37.49]	1.172 [29.77]	.050 [1.27]
190570111	B-540-56HD	---	---	56	.328 [8.33]					

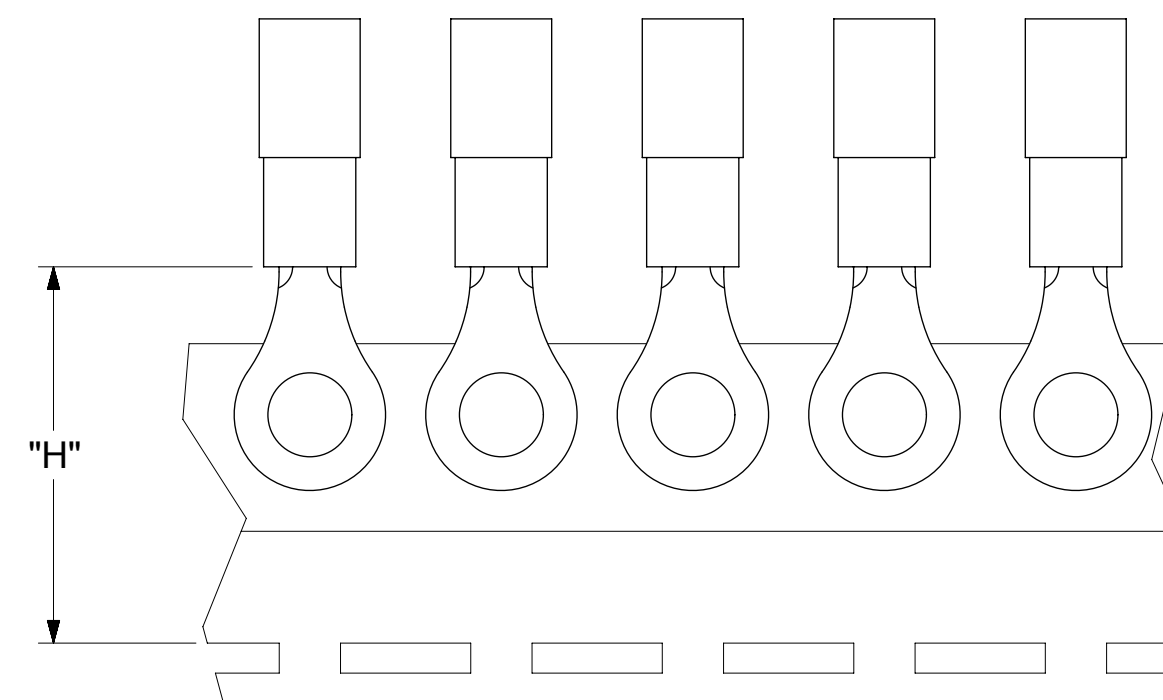
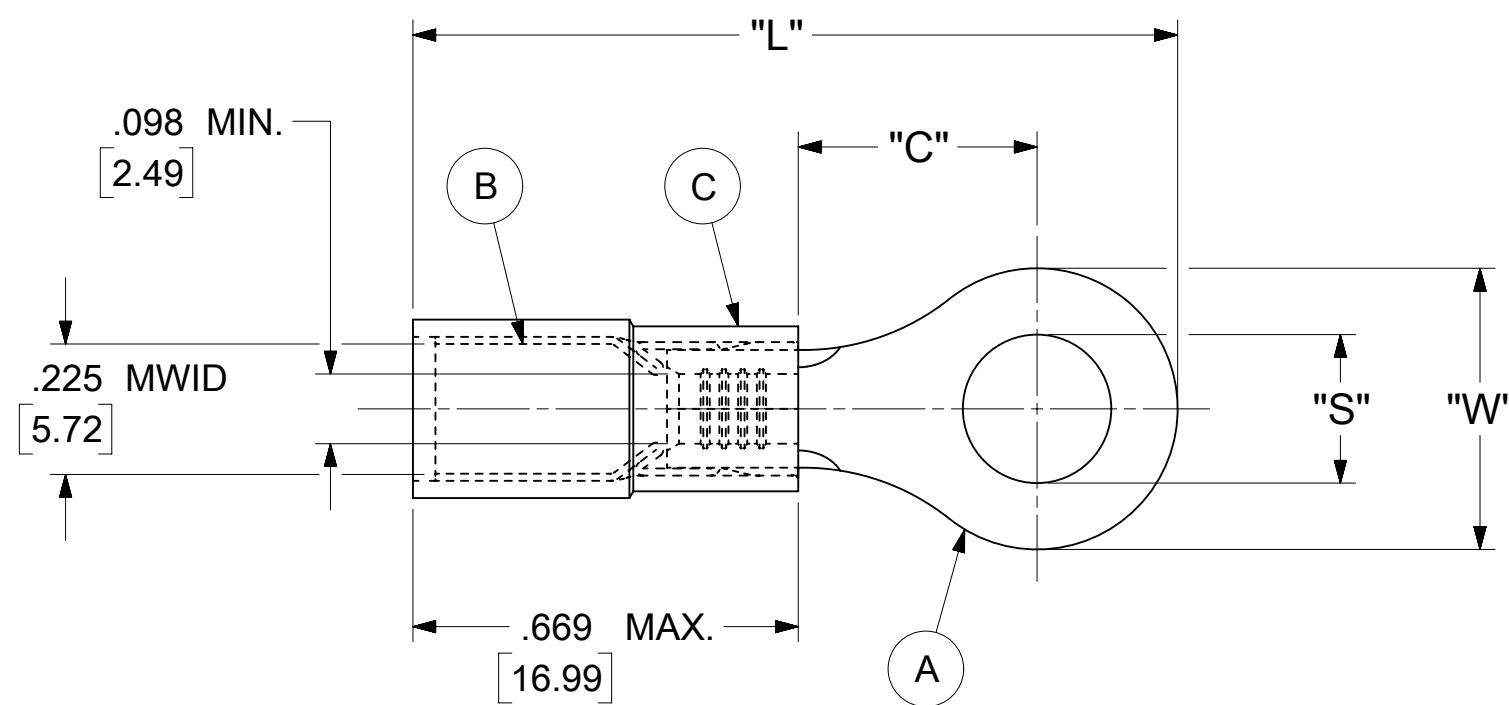

PARTS ON TAPE

NOTES:

- MATERIAL:
  - (A). RING TONGUE TERMINAL: COPPER  
PLATING: ELECTRO-TIN (.0003 MIN.)
  - (B). TIN-PLATED BRASS FUNNEL FERRULE
  - (C). INSULATION: NYLON (YELLOW)
- MWID: MAXIMUM WIRE INSULATION DIAMETER
- WIRE SIZE: 16 -14 AWG  
1.0 -2.5 MM<sup>2</sup>
- "UL" LISTING #E32244  
"CSA" LISTING #18689
- ALL DIMENSIONS IN INCHES/[MM].
- PARTS ARE ROHS COMPLIANT.
- DIMS. SHOWN ARE FOR REFERENCE ONLY.

SYMBOLS	THIS DRAWING CONTAINS INFORMATION THAT IS PROPRIETARY TO MOLEX ELECTRONIC TECHNOLOGIES, LLC AND SHOULD NOT BE USED WITHOUT WRITTEN PERMISSION										
	DIMENSION UNITS		SCALE		CURRENT REV DESC:						
▽ = 0	INCH/MM	NTS		EC NO: 625846 DRWN: ABENJAMINLW 2019/08/28 CHK'D: GROJAS01 2019/10/17 APPR: JMACNEIL 2019/10/18 INITIAL REVISION: DRWN: JJ 1984/11/29 APPR:							
▽ = 0	GENERAL TOLERANCES (UNLESS SPECIFIED)										
▽ = 0		MM	INCH								
▽ = 0	4 PLACES	± ---	± ---								
▽ = 0	3 PLACES	± ---	± 0.005								
▽ = 0	2 PLACES	± 0.13	± 0.01								
▽ = 0	1 PLACE	± 0.25	± ---								
▽ = 0	0 PLACES	± ---	± ---								
▽ = 0	ANGULAR TOL	± 0.5 °		THIRD ANGLE PROJECTION							
▽ = 0	DRAFT WHERE APPLICABLE MUST REMAIN WITHIN DIMENSIONS			DRAWING		SERIES		MATERIAL NUMBER		CUSTOMER	SHEET NUMBER
▽ = 0				C-SIZE		19057		SEE TABLE		GENERAL MARKET	1 OF 1

**molex**

RING TONGUE HEAVY DUTY  
TERMINAL AVIKRIMP 500-SERIES

PRODUCT CUSTOMER DRAWING

DOCUMENT NUMBER	DOC TYPE	DOC PART	REVISION
BHDCD50101	PSD	001	A

## X-ON Electronics

Largest Supplier of Electrical and Electronic Components

*Click to view similar products for [Terminals](#) category:*

*Click to view products by [Molex](#) manufacturer:*

Other Similar products are found below :

[00-054007-01074-6](#) [00-054007-70206-1](#) [00-054007-70210-8](#) [00-054007-70217-7](#) [00-054007-70226-9](#) [00-054007-70228-3](#) [00-054007-70248-1](#) [00-054007-70256-6](#) [00-054007-70301-3](#) [00-054007-70316-7](#) [0-0320562-0](#) [00-054007-49560-4](#) [00-054007-70209-2](#) [00-054007-70225-2](#) [00-054007-70227-6](#) [00-054007-70231-3](#) [00-054007-70241-2](#) [00-054007-70242-9](#) [00-054007-70244-3](#) [00-054007-70246-7](#) [00-054007-70263-4](#) [00-054007-70288-7](#) [00-054007-70290-0](#) [00-054007-70300-6](#) [00-054007-70304-4](#) [01-2065-1-0216](#) [01-2900-1-04412](#) [00581P0075](#) [600TS-10](#) [60205-1](#) [604200-1](#) [605601-1](#) [60598-1-CUT-TAPE](#) [61314-6-C](#) [61810-3](#) [61-S](#) [61-SN](#) [626-0194](#) [62-NBM-A](#) [62-SN](#) [62-SP](#) [640179-1](#) [M55155/059I03](#) [M55155/079C01](#) [M55155/099H02](#) [M55155/109H01](#) [M55155/109H02](#) [M55155/12XH05](#) [M55155/16XH02](#) [M55155/29-5S](#)