

PLEASE CHECK WWW.MOLEX.COM FOR LATEST PART INFORMATION

Part Number: [0190690101](#)
Status: **Active**
Overview: Solderless Terminals
Description: Krimptite Ring Tongue Terminal for 14-16 AWG Wire

Documents:

| | |
|--------------------------------|--|
| 3D Model | Product Specification PS-19902-011-001 (PDF) |
| Drawing (PDF) | Product Specification PS-19902-013-001 (PDF) |
| 3D Model (PDF) | RoHS Certificate of Compliance (PDF) |

Agency Certification

| | |
|-----|---------|
| CSA | LR18689 |
| UL | E32244 |

General

| | |
|-------------------------|--------------------------------------|
| Product Family | Ring and Spade Terminals |
| Series | 19069 |
| Crimp Quality Equipment | Yes |
| Overview | Solderless Terminals |
| Product Name | Krimptite |
| Type | Ring |
| UPC | 800753067905 |

Physical

| | |
|--------------------------------|----------------------|
| Barrel Type | Closed |
| Insulation | None |
| Material - Plating Mating | Tin |
| Material - Plating Termination | Tin |
| Net Weight | 0.508/g |
| Packaging Type | Bag |
| Plating min - Mating | 2.540µm |
| Plating min - Termination | 2.540µm |
| Stud Size | 5-6 (M3-3.5) |
| Termination Interface: Style | Crimp or Compression |
| Wire Size AWG | 14, 16 |
| Wire Size mm ² | 1.30-2.00 |

Solder Process Data

| | |
|-----------------------------|-----|
| Lead-freeProcess Capability | N/A |
|-----------------------------|-----|

Material Info

| | |
|--------------------|-----------|
| Engineering Number | BB-123-06 |
|--------------------|-----------|

Reference - Drawing Numbers

| | |
|-----------------------|------------------------------------|
| Product Specification | PS-19902-011-001, PS-19902-013-001 |
| Sales Drawing | SD-19069-013-001 |

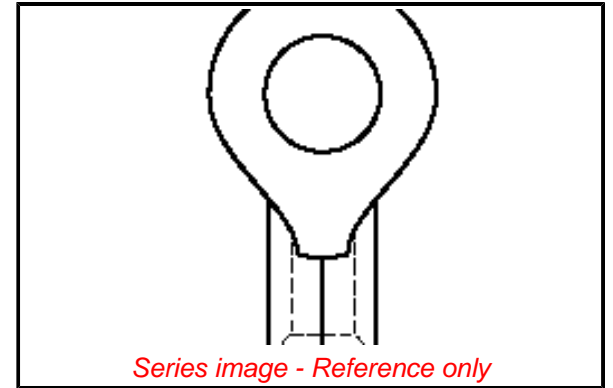

EU ELV

Not Relevant

EU RoHS

Compliant

REACH SVHC

Not Contained Per -
D(2021)4569-DC (8
July 2021)

Halogen-Free

Status

Low-Halogen

For more information, please visit [Contact US](#)

China ROHS

ELV

RoHS Phthalates

China RoHS

Green Image

Not Relevant

Not Contained

Search Parts in this Series

[19069 Series](#)

Application Tooling | FAQ

Tooling specifications and manuals are found by selecting the products below. Crimp Height Specifications are then contained in the Application Tooling Specification document.

Global

Description

Product #

| | |
|--------------|---------------------------|
| PremiumGrade | 640030100 |
|--------------|---------------------------|

Hand Crimp Tool for
Krimptite/Versakrimp
Terminals and
Splices, 10-22
AWG and 6.0mm² -
0.5mm²

| | |
|--------------------|---------------------------|
| Crimp Head for the | 640070100 |
|--------------------|---------------------------|

AT-200 Pneumatic
Hand Tool

| | |
|-------------------|---------------------------|
| ServiceGrade Hand | 640160038 |
|-------------------|---------------------------|

Crimp Tool - Ratchet

This document was generated on 09/14/2021

PLEASE CHECK WWW.MOLEX.COM FOR LATEST PART INFORMATION

X-ON Electronics

Largest Supplier of Electrical and Electronic Components

Click to view similar products for [Terminals](#) category:

Click to view products by [Molex](#) manufacturer:

Other Similar products are found below :

[00-054007-01074-6](#) [00-054007-70206-1](#) [00-054007-70210-8](#) [00-054007-70217-7](#) [00-054007-70226-9](#) [00-054007-70228-3](#) [00-054007-70248-1](#) [00-054007-70256-6](#) [00-054007-70301-3](#) [00-054007-70316-7](#) [0-0320562-0](#) [00-054007-49560-4](#) [00-054007-70209-2](#) [00-054007-70225-2](#) [00-054007-70227-6](#) [00-054007-70231-3](#) [00-054007-70241-2](#) [00-054007-70242-9](#) [00-054007-70244-3](#) [00-054007-70246-7](#) [00-054007-70263-4](#) [00-054007-70288-7](#) [00-054007-70290-0](#) [00-054007-70300-6](#) [00-054007-70304-4](#) [01-2065-1-0216](#) [01-2900-1-04412](#) [00581P0075](#) [600TS-10](#) [60205-1](#) [604200-1](#) [605601-1](#) [60598-1-CUT-TAPE](#) [61314-6-C](#) [61810-3](#) [61-S](#) [62149-1](#) [626-0194](#) [62-NBM-A](#) [62-SN](#) [62-SP](#) [640179-1](#) [M55155/059I03](#) [M55155/079C01](#) [M55155/099H02](#) [M55155/109H01](#) [M55155/109H02](#) [M55155/12XH05](#) [M55155/16XH02](#) [M55155/29-5S](#)