

PLEASE CHECK WWW.MOLEX.COM FOR LATEST PART INFORMATION

Part Number: [2064621100](#)
Status: **Active**
Overview: [Micro-Fit+ Connector System](#)
Description: Micro-Fit+ Terminal Position Assurance (TPA) Retainer, 11 Circuits, 3.00mm Pitch, UL 94V-0, Glow-Wire Capable, Natural

Documents:

3D Model	Packaging Specification 2064620000-PK-000 (PDF)
3D Model (PDF)	Test Summary 2064600000-TS-000 (PDF)
Drawing (PDF)	Datasheet (PDF)
Product Specification 2064600000-PS-000 (PDF)	RoHS Certificate of Compliance (PDF)

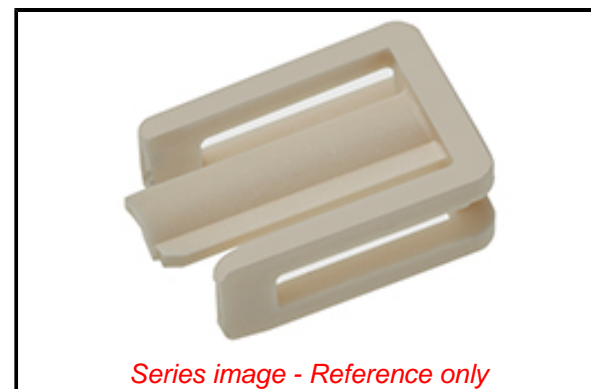

Agency Certification

UL E29179

General

Product Family	Accessories
Series	206462
Component Type	Terminal Position Assurance
Overview	Micro-Fit+ Connector System
Product Name	Micro-Fit+
UPC	191130009152

Physical

Circuits (Loaded)	11
Circuits (maximum)	11
Color - Resin	Natural
Lock to Mating Part	Yes
Material - Resin	Nylon
Net Weight	0.202/g
Number of Rows	1
Packaging Type	Bag
Temperature Range - Operating	-40° to +105°C

Material Info

Reference - Drawing Numbers

Packaging Specification	2064620000-PK-000
Product Specification	2064600000-PS-000
Sales Drawing	2064620000-SD-000
Test Summary	2064600000-TS-000

EU ELV

Not Relevant

EU RoHS

Compliant
REACH SVHC

Not Contained Per -
D(2021)4569-DC (8
July 2021)

Halogen-Free

Status

Not Low-Halogen

For more information, please visit [Contact US](#)

China ROHS

ELV

RoHS Phthalates

China RoHS

Green Image

Not Relevant

Not Contained

Search Parts in this Series

[206462](#) Series

Use With

Micro-Fit+ Receptacle Housing [206461](#)

X-ON Electronics

Largest Supplier of Electrical and Electronic Components

Click to view similar products for [Headers & Wire Housings](#) category:

Click to view products by [Molex](#) manufacturer:

Other Similar products are found below :

[892-18-020-10-001101](#) [58102-G61-06LF](#) [582553-1](#) [0009485154](#) [009176003701906](#) [0050291907](#) [LY20-4P-DT1-P1E-BR](#) [02.125.8002.8](#)
[609-3404](#) [61062-3](#) [622-0430](#) [622-3653LF](#) [63453-116](#) [636-1030](#) [636-1427](#) [636-3427](#) [636-4007](#) [641938-9](#) [641991-4](#) [644827-2](#) [65817-010LF](#)
[65817-015LF](#) [65863-015LF](#) [66207-023LF](#) [67095-007LF](#) [67601157](#) [68648-049](#) [70.362.1628.0](#) [70-4210](#) [70-4226B](#) [70-4853B](#) [707-5020](#) [707-5028](#) [71.350.2428.0](#) [71918-208LF](#) [71961-016LF](#) [733-134](#) [733-162](#) [754199-000](#) [760-3052](#) [787-8014-00](#) [79531-3000](#) [FCN-360C032-B](#) [FCN-367T-T012/H](#) [FCN-723D010/2](#) [80.063.4001.1](#) [800-90-001-10-001000](#) [800-90-010-10-002000](#) [801-43-002-10-013000](#) [801-43-006-10-002000](#)