

公差非累積
NON-ACCUMULATIVE

基板取付穴推奨寸法
RECOMMENDED P.C. BOARD HOLE DIM.

NOTES

- MATERIAL
 WAFER : 66NYLON, UL94V-0 (COLOR : IVORY)
 PIN : 黄銅 BLASS, □0.635
 PLATING : 錫めっき (5µm以上)、銅下地 (2.5µm以上)
 TIN PLATING (5µm MIN.), COPPER UNDER PLATING (2.5µm MIN.)
- 6極以上に適用。
 TO BE APPLIED FOR 6CKT. AND MORE THAN 6CKT.
- 5極以下はロック部スリットなし。
 NO SLIT IS PROVIDED FOR 5CKT. AND LESS THAN 5CKT.

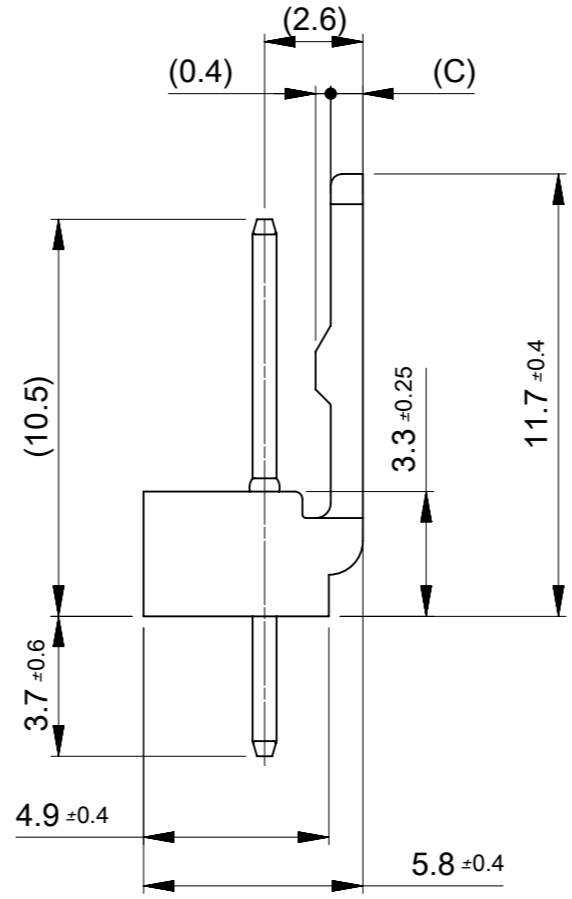
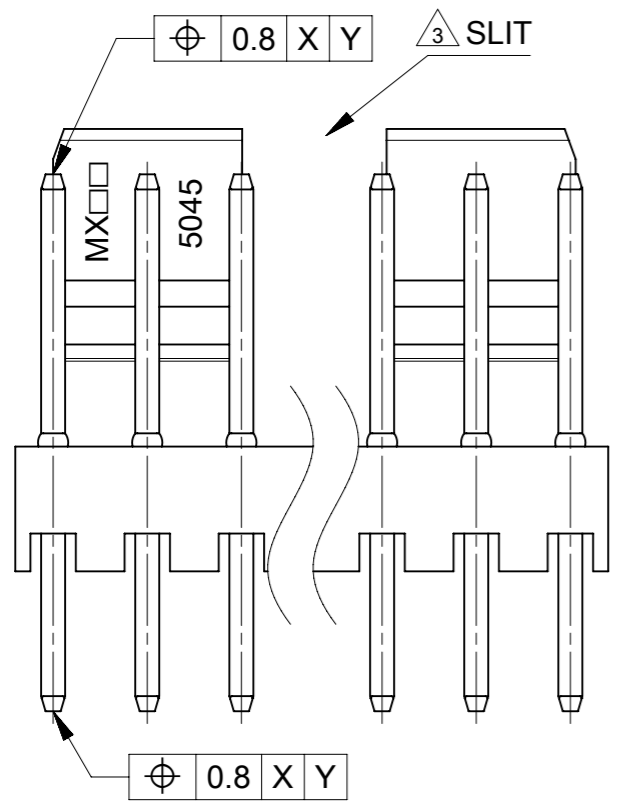

0.85	7.5	7.5	22044045	5045-04F	4
1	2.5	2.5	22044025	5045-02F	2
(C)	B	(A)	ORDER No.	PARTS No.	CKT.

THIS DRAWING CONTAINS INFORMATION THAT IS PROPRIETARY TO MOLEX ELECTRONIC TECHNOLOGIES, LLC AND SHOULD NOT BE USED WITHOUT WRITTEN PERMISSION

DIMENSION UNITS mm	SCALE 5:1	CURRENT REV DESC: OBSOLETE PART NUMBERS			
GENERAL TOLERANCES (UNLESS SPECIFIED)		<p>molex</p> <p>MINI-LATCH 2.5 HEADER ASSY FLANGE PIN TYPE TIN PLATING</p> <p>PRODUCT CUSTOMER DRAWING</p>			
ANGULAR TOL	± 3.0 °				
4 PLACES	±				
3 PLACES	±				
2 PLACES	± 0.2				
1 PLACE	± 0.2	EC NO: 650267	2020/10/27		
0 PLACES	± 0.2	DRWN: SKANDB	2020/12/10		
DRAFT WHERE APPLICABLE MUST REMAIN WITHIN DIMENSIONS		THIRD ANGLE PROJECTION	DRAWING	SERIES	MATERIAL NUMBER
			A3-SIZE	5045	SEE TABLE
DOCUMENT STATUS		DOC TYPE	DOC PART	REVISION	
P1	RELEASE DATE	PSD	000	A1	
2020/12/10	08:28:38	GENERAL			1 OF 1

X-ON Electronics

Largest Supplier of Electrical and Electronic Components

Click to view similar products for [Headers & Wire Housings](#) category:

Click to view products by [Molex](#) manufacturer:

Other Similar products are found below :

[892-18-020-10-001101](#) [58102-G61-06LF](#) [582553-1](#) [0009485154](#) [009176003701906](#) [0050291907](#) [LY20-4P-DT1-P1E-BR](#) [02.125.8002.8](#)
[609-3404](#) [61062-3](#) [622-0430](#) [622-3653LF](#) [63453-116](#) [636-1030](#) [636-1427](#) [636-3427](#) [636-4007](#) [641938-9](#) [641991-4](#) [644827-2](#) [65817-010LF](#)
[65817-015LF](#) [65863-015LF](#) [66207-023LF](#) [67095-007LF](#) [67601157](#) [68648-049](#) [70.362.1628.0](#) [70-4210](#) [70-4226B](#) [70-4853B](#) [707-5020](#) [707-5028](#) [71.350.2428.0](#) [71918-208LF](#) [71961-016LF](#) [733-134](#) [733-162](#) [754199-000](#) [760-3052](#) [787-8014-00](#) [79531-3000](#) [FCN-360C032-B](#) [FCN-367T-T012/H](#) [FCN-723D010/2](#) [80.063.4001.1](#) [800-90-001-10-001000](#) [800-90-010-10-002000](#) [801-43-002-10-013000](#) [801-43-006-10-002000](#)