

SQUARE CORNER IS CKT I IDENTIFIER

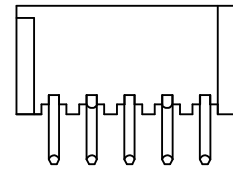

OPTIONAL VOIDED CIRCUIT  
SEE CHART FOR LOCATION  
SEE NOTE 5

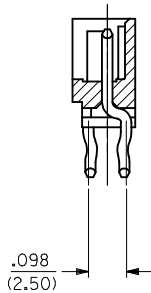
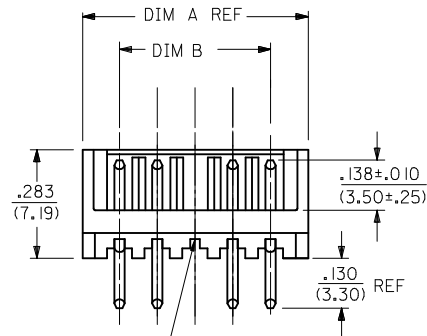
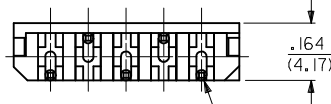

CIRCUIT I

NOTES:

- 1) MATERIAL: HEADER : GLASS-FILLED POLYESTER, UL94V-0, COLOR: WHITE  
PIN : BRASS.
- 2) FINISH:  
(154) --.000100/(0.00254) MIN. TIN OVER  
.000050/(0.00127) MIN. NICKEL UNDERPLATE.
- 3) PRODUCT SPECS: PS-42219-0001.
- 4) PACKAGING SPECIFICATION: PK-42249-0001.
- 5) ANY VOID COMBINATION LEAVING PINS IN ONE ROW ONLY IS NOT AN AVAILABLE OPTION. THE RESULTS WOULD BE MINIMAL BOARD RETENTION.
- 6) THIS PART CONFORMS TO CLASS B REQUIREMENTS OF COSMETIC SPECIFICATION PS-45499-002.

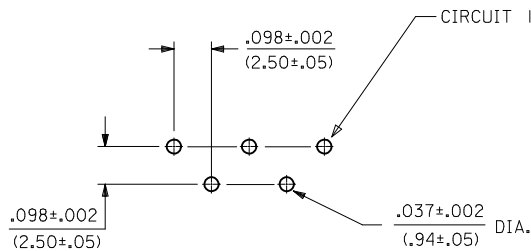

PCB HOLE LAYOUT: COMPONENT SIDE  
RECOMMENDED PCB THICKNESS: .062 (1.57)

A-42249-N\*-\*-\*

NO. OF CKTS. PART  
COLOR BLANK = STANDARD  
A = WHITE SP = SPECIAL  
VOID LOCATION

NO. OF CKTS.	KINK LOC.	DIM A IN/(MM)	DIM B IN/(MM)
2	ALL PINS	.292/(7.42)	.098/(2.50)
3	ALL PINS	.391/(9.92)	.197/(5.00)
4	ALL PINS	.489/(12.42)	.295/(7.50)
5	ALL PINS	.587/(14.92)	.394/(10.00)
6	ALL PINS	.685/(17.40)	.492/(12.50)
7	ALL PINS	.783/(19.90)	.591/(15.00)
8	ALL PINS	.882/(22.40)	.689/(17.50)
9	ALL PINS	.980/(24.90)	.787/(20.00)
10	ALL PINS	1.079/(27.40)	.886/(22.50)
11	ALL PINS	1.177/(29.90)	.984/(25.00)
12	ALL PINS	1.276/(32.40)	1.083/(27.50)
13	ALL PINS	1.374/(34.90)	1.181/(30.00)
14	ALL PINS	1.472/(37.40)	1.280/(32.50)
15	ALL PINS	1.571/(39.90)	1.378/(35.00)

REMOVE COLOR OPT. EC NO: UCP2014-2718 DRW:MKIPPER 2014/01/06 CHKD:JBELL 2014/01/07 APPR:FSMITH 2014/01/13	QUALITY SYMBOLS ▽=0 ▽=0 ▽=0	GENERAL TOLERANCES (UNLESS SPECIFIED)		DIMENSION STYLE <b>IN/MM</b>	SCALE <b>4:1</b>	DESIGN UNITS <b>METRIC</b>	THIRD ANGLE PROJECTION	
		4 PLACES ± --- ± --- 3 PLACES ± --- ± .010 2 PLACES ± 0.25 ± .015 1 PLACE ± 0.38 ± --- 0 PLACE ± ±		DRAWN BY RE	DATE 12/17/88	TITLE <b>2.5 MM HEADER ASSEMBLY (STAGGERED PINS)</b>		
		ANGULAR ±1/2° DRAFT WHERE APPLICABLE MUST REMAIN WITHIN DIMENSIONS		APPROVED BY LENZ	DATE 12/17/88	<b>molex</b>		
		MATERIAL NO. <b>SEE CHART</b>		DOCUMENT NO. <b>SDA-42249-*</b>		SHEET NO. <b>1 OF *</b>		

THIS DRAWING CONTAINS INFORMATION THAT IS PROPRIETARY TO MOLEX INCORPORATED AND SHOULD NOT BE USED WITHOUT WRITTEN PERMISSION

A-42249-NA-*				A-422649-NA-*							
OPTIONS	HOUSING	42249-N		OPTIONS	HOUSING	42249-N		OPTIONS	HOUSING		
	COLOR	WHITE			COLOR	WHITE			COLOR		
	PIN NO	45613-0001			PIN NO	45613-0001			PIN NO		
	PLATING	154			PLATING	154			PLATING		
Ckt	Material No	Engineering No	Void Ckts	Ckt	Material No	Engineering No	Void Ckts	Ckt	Material No	Engineering No	Void Ckts
2	22-43-6020	A-42249-2A		3	22-43-6032	A-42249-3A-3	3	2			
3	22-43-6030	A-42249-3A		4	22-43-6041	A-42249-4A-2	2	3			
4	22-43-6040	A-42249-4A		4	22-43-6042	A-42249-4A-3	3	4			
5	22-43-6050	A-42249-5A		6	022-43-6065	A-42249-06A-2	2	5			
6	22-43-6060	A-42249-6A		6	022-43-6061	A-42249-06A-5	5	6			
7	22-43-6070	A-42249-7A		6	22-43-6063	A-42249-6A-51	3,5	7			
8	22-43-6080	A-42249-8A		6	22-43-6064	A-42249-6A-52	2,4	8			
9	22-43-6090	A-42249-9A		7	022-43-6072	A-42249-07A-3	3	9			
10	22-43-6100	A-42264910A		7	022-43-6074	A-42249-07A-5	5	10			
11	22-43-6110	A-42249-11A		7	022-43-6073	A-42249-07A-51	2,5	11			
12	22-43-6120	A-42249-12A		7	022-43-6075	A-42249-07A-52	3,6	12			
13	22-43-6130	A-42249-13A						13			
14	22-43-6140	A-42249-14A						14			
15	22-43-6150	A-42249-15A						15			

REV: <b>S3</b>	ECR/ECN INFORMATION EC NO: UCP2014-2718 DATE: 1/15/2014	TITLE: <b>2.5 MM HEADER ASSEMBLY (STAGGERED PINS)</b>	SHEET No. <b>- 2 -</b>
DOCUMENT NUMBER: <b>SDA-42249-*</b>		CREATED / REVISED BY: <b>MKIPPER</b>	CHECKED BY: <b>JBELL</b>
		APPROVED BY: <b>FSMITH</b>	

## X-ON Electronics

Largest Supplier of Electrical and Electronic Components

*Click to view similar products for [Headers & Wire Housings](#) category:*

*Click to view products by [Molex](#) manufacturer:*

Other Similar products are found below :

[892-18-020-10-001101](#) [58102-G61-06LF](#) [582553-1](#) [0009485154](#) [009176003701906](#) [0050291907](#) [LY20-4P-DT1-P1E-BR](#) [02.125.8002.8](#)  
[609-3404](#) [61062-3](#) [622-0430](#) [622-3653LF](#) [63453-116](#) [636-1030](#) [636-1427](#) [636-3427](#) [636-4007](#) [641938-9](#) [641991-4](#) [644827-2](#) [65817-010LF](#)  
[65817-015LF](#) [65863-015LF](#) [66207-023LF](#) [67095-007LF](#) [67601157](#) [68648-049](#) [70.362.1628.0](#) [70-4210](#) [70-4226B](#) [70-4853B](#) [707-5020](#) [707-](#)  
[5028](#) [71.350.2428.0](#) [71918-208LF](#) [71961-016LF](#) [733-134](#) [733-162](#) [754199-000](#) [760-3052](#) [787-8014-00](#) [79531-3000](#) [FCN-360C032-B](#) [FCN-](#)  
[367T-T012/H](#) [FCN-723D010/2](#) [80.063.4001.1](#) [800-90-001-10-001000](#) [800-90-010-10-002000](#) [801-43-002-10-013000](#) [801-43-006-10-002000](#)