

CIRCUITS	ENGINEERING NUMBER	PART NUMBER	COLOR
2	MX-CBF020RT-0V	397700005	GREEN
2	MX-CBF020RT-0N	397700001	BLACK
4	MX-CBF040RT-0V	TBD	GREEN
4	MX-CBF040RT-0N	397700002	BLACK
6	MX-CBF060RT-0V	TBD	GREEN
6	MX-CBF060RT-0N	397700003	BLACK
8	MX-CBF080RT-0V	TBD	GREEN
8	MX-CBF080RT-0N	397700004	BLACK

(A1)

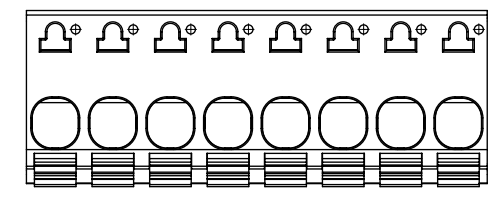

$L = A + .150$
 $[L = A + 3.81]$

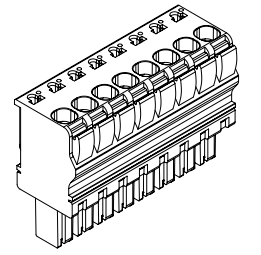
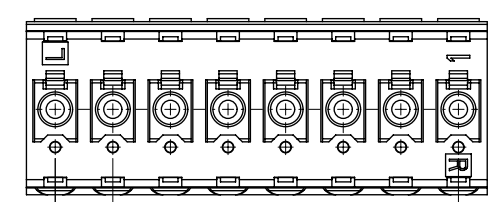
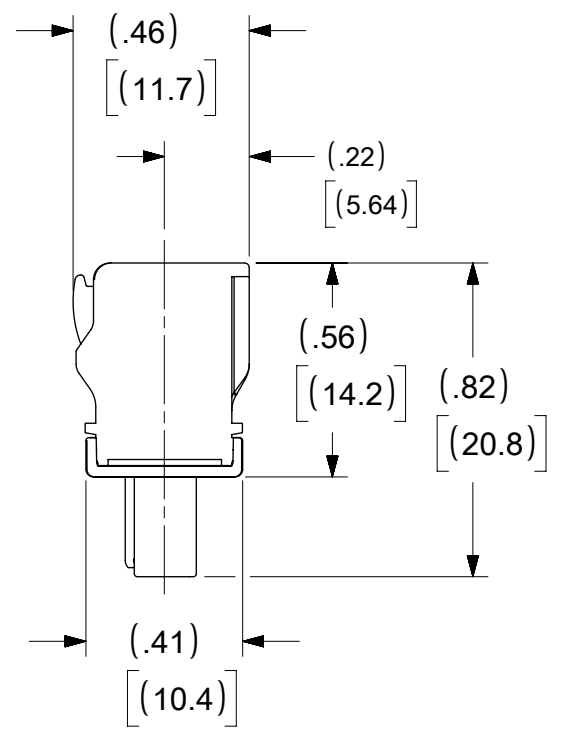
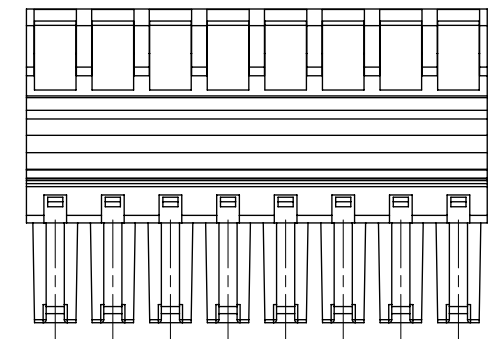

.150 PITCH
 $[3.81]$

$A = .150 \times (\text{POLES} - 1)$
 $[A = 3.81 \times (\text{POLES} - 1)]$

NOTES:

- MATERIAL:
 - BODY: PA66 V-0
 - SCREW: BRASS
 - CLAMP: BRASS
 - SPRING/PIN: BRASS
- RATING: 300V (UL)
- WIRE: 14-30AWG STRANDED 11A
14-30AWG SOLID 9A
- OPERATING TEMPERATURE RANGE: -40°C TO +110°C
- CONTACT RESISTANCE: <15mΩ
- WIRE STRIP LENGTH: 105 - 11.5 MM (.41-.45IN)
- ROHS COMPLIANT
- UL FILE: E48521

THIS DRAWING CONTAINS INFORMATION THAT IS PROPRIETARY TO MOLEX ELECTRONIC TECHNOLOGIES, LLC AND SHOULD NOT BE USED WITHOUT WRITTEN PERMISSION									
SYMBOLS		DIMENSION UNITS		SCALE		CURRENT REV DESC: ADDED P/N 397700005			
= 0		INCH[MM]		2:1					
= 0		GENERAL TOLERANCES (UNLESS SPECIFIED)							
= 0		MM		INCH					
= 0		4 PLACES ±		±		EC NO: 607092			
= 0		3 PLACES ±		± .010		DRWN: ABENJAMINLW 2018/11/02			
= 0		2 PLACES ±		± .25		CHK'D: MBRZOZOWSKI 2018/11/02			
= 0		1 PLACE ±		±		APPR: JFMURPHY 2019/01/07			
= 0		0 PLACES ±		±		INITIAL REVISION:			
= 0		ANGULAR TOL ±		± .5°		DRWN: BRUPERT 2016/09/09		2016/10/07	
= 0		DRAFT WHERE APPLICABLE		THIRD ANGLE PROJECTION		DRAWING		SERIES	
= 0		MUST REMAIN WITHIN DIMENSIONS		B-SIZE		39770		MATERIAL NUMBER	
								CUSTOMER	
								SEE CHART	
								GENERAL MARKET	
								1 OF 1	

DOCUMENT STATUS	P1	RELEASE DATE	2019/01/07	20:27:42
-----------------	----	--------------	------------	----------

X-ON Electronics

Largest Supplier of Electrical and Electronic Components

Click to view similar products for [Pluggable Terminal Blocks](#) category:

Click to view products by [Molex](#) manufacturer:

Other Similar products are found below :

[57.510.0053](#) [MC 1.5/ 6-ST-3.5 GY AU](#) [734-104](#) [734-302](#) [8-141-P](#) [8426620000](#) [860505](#) [860810](#) [GBPACX-12](#) [93.731.4953.0](#) [PV05-5,08-K](#)
[PVP02-5,00](#) [PVP03-3,50](#) [PVP04-3,50](#) [PVS02-5,00](#) [1-1986160-3](#) [1377680000](#) [1531000000](#) [1546228-5](#) [ELFH16150](#) [ELFP03110](#)
[ELFP10210](#) [ELFT06250](#) [ELVP03100](#) [1700101](#) [1700410](#) [1700425](#) [1702246](#) [1705229](#) [1710175](#) [1714537](#) [1717806](#) [1719600](#) [1728941](#)
[1734692](#) [1734795](#) [1736036](#) [1740194](#) [1740291](#) [1740628](#) [1740990](#) [1746952](#) [1750207](#) [1752441](#) [1752865](#) [1754115](#) [1754144](#) [1756913](#)
[1760051](#) [1760336](#)