

CIRCUIT SIZE	DIM. "A"	DIM. "B"
6	.33 (8.4)	.54 (13.8)
8	.50 (12.6)	.71 (18.0)
10	.66 (16.8)	.87 (22.2)
12	.83 (21.0)	1.04 (26.4)
14	.99 (25.2)	1.20 (30.6)
16	1.16 (29.4)	1.37 (34.8)
18	1.32 (33.6)	1.54 (39.0)
20	1.49 (37.8)	1.70 (43.2)
22	1.65 (42.0)	1.87 (47.4)
24	1.82 (46.2)	2.03 (51.6)

NOTES:

- HOUSING MATERIAL:
1 = NYLON 6/6, U.L. 94V-2, COLOR: BLACK
TERMINAL MATERIAL: BRASS ALLOY
- TERMINAL PLATING:
1 = .000100/(.00254) MIN. MATTE TIN OVER .000050/(.00127) MIN. NICKEL.
2 = .000030/(.00076) MIN. SELECT GOLD AND .000100/(.00254) MIN. SELECT MATTE TIN OVER .000050/(.00127) MIN. NICKEL OVERALL.
- PRODUCT SPECIFICATIONS: SEE PS-5556-001 EXCEPT FOR ITEM NO'S, 4-2-6 AND 4-2-7 UNDER MECHANICAL PERFORMANCE.
- PACKAGING SPECIFICATION:
PACKED PER PK-5569-002
- PART MATES WITH MINI-FIT JR. RECEPTACLE #5557.
- ITEM NO'S. PRECEDED BY AN "X" IN THE CHART ARE NOT AVAILABLE.
- DISCOLORATION IN THE BANDOLIER CARRIER AREA OF THE PIN IS INHERENT TO THE PLATING PROCESS AND IS DUE TO THE MASKING EFFECT OF THE CARRIER. THIS DISCOLORATION IS IN A NON-FUNCTIONAL AREA OF THE PIN AND WILL NOT AFFECT THE PERFORMANCE OF THE HEADER ASSEMBLY.
- PART CONFORMS TO CLASS "B" REQUIREMENTS OF COSMETIC SPECIFICATION PS-45499-002.
- CONNECTORS ARE NOT TO BE MATED AND UNMATED WHILE CIRCUITS ARE LIVE.
- PARTS ARE NOT DESIGNED FOR CURRENT SHARING.
- FORMING MARKS ON PINS ARE ACCEPTABLE

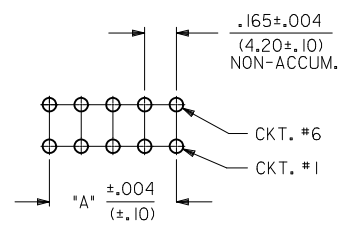
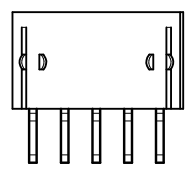
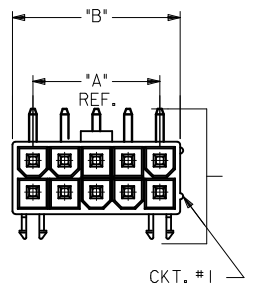

RECOMMENDED HOLE LAYOUT FOR .070/(1.78) MAX. THICK P.C. BOARD (FROM UNDER-SIDE OF BOARD)

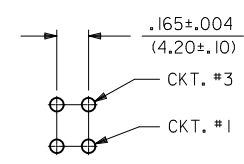
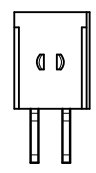
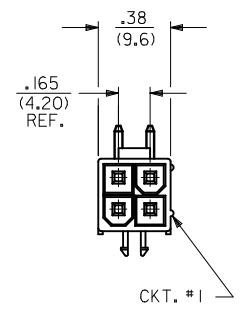

RECOMMENDED HOLE LAYOUT FOR .070/(1.78) MAX. THICK P.C. BOARD (FROM UNDER-SIDE OF BOARD)

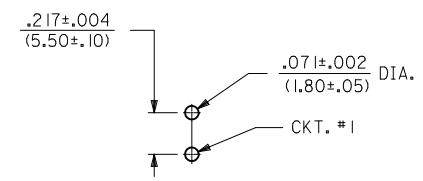
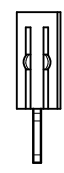
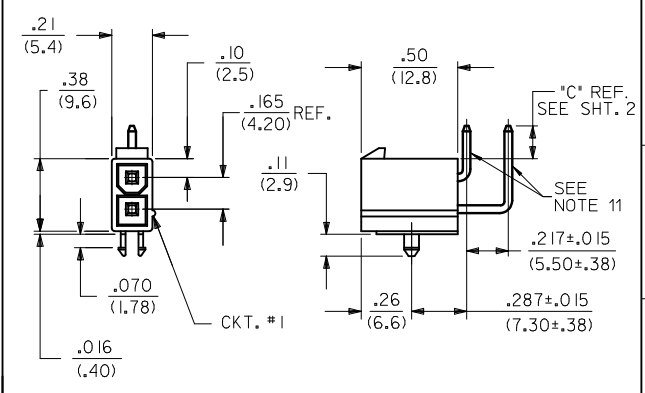

RECOMMENDED HOLE LAYOUT FOR .070/(1.78) MAX. THICK P.C. BOARD (FROM UNDER-SIDE OF BOARD)

CHANGE PLATING EC NO: UCP2012-1560 DRW: NGUYEN 2012/01/18 CHKD: BELL 2012/01/18 APPR: FSMITH 2012/02/02	QUALITY SYMBOLS ▽=0 ▽=0 ▽=0	GENERAL TOLERANCES (UNLESS SPECIFIED)		DIMENSION STYLE IN/MM	SCALE 2:1	DESIGN UNITS INCH	THIRD ANGLE PROJECTION
		4 PLACES ± --- ± --- 3 PLACES ± --- ± .010 2 PLACES ± .25 ± .015 1 PLACE ± .38 ± ---	mm INCH DRAWN BY NGUYEN DATE 2011/10/17 CHECKED BY RJF DATE 1993/05/04 APPROVED BY FSMITH DATE 2011/10/28	TITLE MINIFIT JR RA HDR ASSY W/MOUNTING PEGS PINS ROTATE 180			
		ANGULAR ±1/2°		MOLEX MOLEX INCORPORATED			
		DRAFT WHERE APPLICABLE MUST REMAIN WITHIN DIMENSIONS		MATERIAL NO. SEE CHART DOCUMENT NO. SDA-43270-* SHEET NO. 1 OF 2			

ITEM NUMBER	CKT. SIZE	TERMINAL PLATING	HOUSING MATERIAL	DIM 'C' REF
X 43270-0001	2	TIN OVER NICKEL	94V-2 BLACK	$\frac{.12}{(3.1)}$
X 43270-0002	4			
43270-0003	6			
X 43270-0004	8			
X 43270-0005	10			
X 43270-0006	12			
X 43270-0007	14			
X 43270-0008	16			
X 43270-0009	18			
X 43270-0010	20			
X 43270-0011	22			
X 43270-0012	24	TIN OVER NICKEL	94V-2 BLACK	$\frac{.12}{(3.1)}$

SEE SHEET 1 EC NO: UCP2012-1560 DRAWN: NGUYEN 2012/01/18 CHKD: BELL 2012/01/18 APPR: FSMITH 2012/02/02	QUALITY SYMBOLS 	GENERAL TOLERANCES (UNLESS SPECIFIED)		DIMENSION STYLE IN/MM		SCALE 1:1	DESIGN UNITS INCH	THIRD ANGLE PROJECTION	
									MINIFIT JR RA HDR ASSY W/MOUNTING PEGS PINS ROTATE 180
								MOLEX INCORPORATED	
DRAFT WHERE APPLICABLE MUST REMAIN WITHIN DIMENSIONS				SIZE C THIS DRAWING CONTAINS INFORMATION THAT IS PROPRIETARY TO MOLEX INCORPORATED AND SHOULD NOT BE USED WITHOUT WRITTEN PERMISSION					

X-ON Electronics

Largest Supplier of Electrical and Electronic Components

Click to view similar products for [Headers & Wire Housings](#) category:

Click to view products by [Molex](#) manufacturer:

Other Similar products are found below :

[892-18-020-10-001101](#) [58102-G61-06LF](#) [582553-1](#) [0009485154](#) [009176003701906](#) [0050291907](#) [LY20-4P-DT1-P1E-BR](#) [02.125.8002.8](#)
[609-3404](#) [61062-3](#) [622-0430](#) [622-3653LF](#) [63453-116](#) [636-1030](#) [636-1427](#) [636-3427](#) [636-4007](#) [641938-9](#) [641991-4](#) [644827-2](#) [65817-010LF](#)
[65817-015LF](#) [65863-015LF](#) [66207-023LF](#) [67095-007LF](#) [67601157](#) [68648-049](#) [70.362.1628.0](#) [70-4210](#) [70-4226B](#) [70-4853B](#) [707-5020](#) [707-5028](#) [71.350.2428.0](#) [71918-208LF](#) [71961-016LF](#) [733-134](#) [733-162](#) [754199-000](#) [760-3052](#) [787-8014-00](#) [79531-3000](#) [FCN-360C032-B](#) [FCN-367T-T012/H](#) [FCN-723D010/2](#) [80.063.4001.1](#) [800-90-001-10-001000](#) [800-90-010-10-002000](#) [801-43-002-10-013000](#) [801-43-006-10-002000](#)