

DWG. NO.
SD-49511-001

SIMILAR ITEM

PROJECT NO.

B

DO NOT SCALE DRAWING
DIMENSION IN METRIC

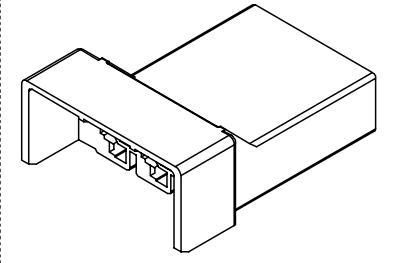
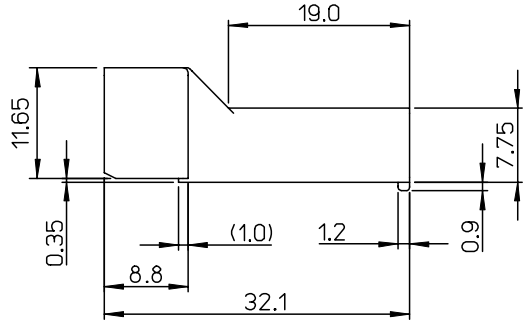
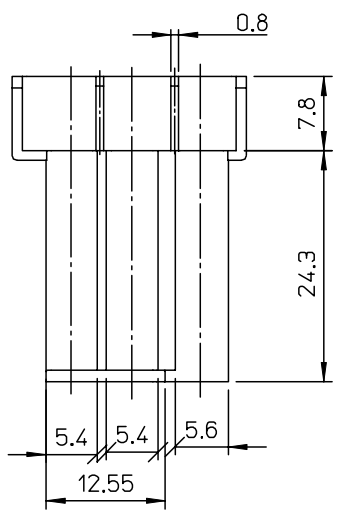
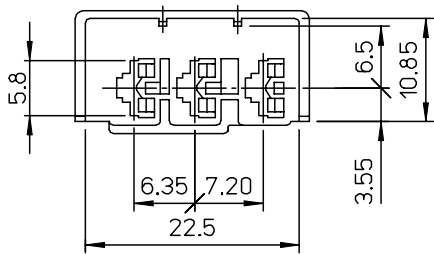
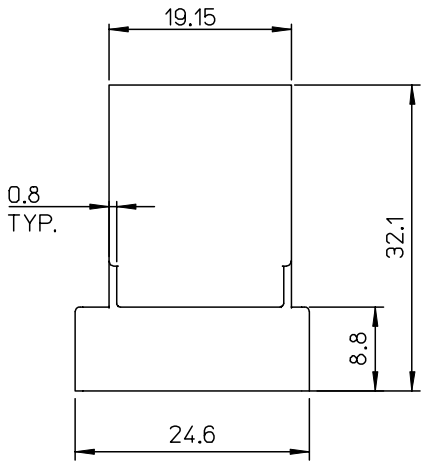

ISOMETRIC VIEW

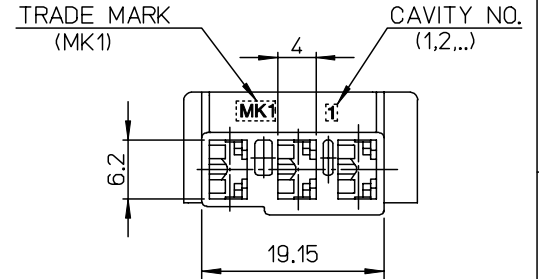

NOTES

- MATERIAL : POLYAMIDE6(UL94V-0, UNFILLED G/F)
BLACK COLOR,
(GLOW WIRE CAPABLE HAVING AN IEC GWIT & GWFI RATING OF 960 DEGREES C
AT 0.75mm WALL THICKNESS)
- APPLICABLE TERMINAL : 35068-9**2

NEW RELEASED ECN NO. KOR2005-0062 DRWN: JB.JIN 04/10/01 CHK: W.Y.YANG APPR: CW.LEE	QUALITY SYMBOLS MAJOR $\blacktriangledown = 0$ CRITICAL $\nabla C = 0$	GENERAL TOLERANCES: (UNLESS SPECIFIED)		SCALE 1:1	DESIGN UNITS <input checked="" type="checkbox"/> mm <input type="checkbox"/> INCH	THIRD ANGLE PROJECTION	DIMENSIONS: <input type="checkbox"/> mm <input type="checkbox"/> INCH <input checked="" type="checkbox"/> mm ONLY		SHT REV	
		4 PLACES	$\pm 0.$	$\pm -$	DRAWN BY & DATE C.B.CHIN 04/07/02		TITLE: .187 MP-LCOK HOUSING-3P (FOR DOOR S/W)			
		3 PLACES	$\pm 0.$	$\pm -$	CHECKED BY & DATE W.Y.YANG 04/07/02					
		2 PLACES	± 0.25	$\pm -$	APPROVED BY & DATE C.W.LEE 04/07/02		MOLEX INCORPORATED			
1 PLACE	± 0.30	$\pm -$	ANGULAR: $\pm 1^\circ$		CAD FILENAME E495000301.MO	MATERIAL NO. 495110301	DRAWING NO. SD-49511-001	SHEET NO. 1 OF 1		
A	REV	DRAFT WHERE APPLICABLE MUST REMAIN WITHIN DIMENSIONS				THIS DRAWING CONTAINS INFORMATION THAT IS PROPRIETARY TO MOLEX INCORPORATED AND SHOULD NOT BE USED WITHOUT WRITTEN PERMISSION.				SIZE B

X-ON Electronics

Largest Supplier of Electrical and Electronic Components

Click to view similar products for [Automotive Connectors](#) category:

Click to view products by [Molex](#) manufacturer:

Other Similar products are found below :

[003-018-000](#) [60403001](#) [60993906-B](#) [M902-2131](#) [M902-2161](#) [72.330.1035.1](#) [73.353.4028.0](#) [F119300-B](#) [F166900](#) [F258300-B](#) [F358300-B](#)
[F407400](#) [F444110](#) [F487000](#) [F509500B-B](#) [827153-1](#) [8N1515-32-24P](#) [9-1326729-8](#) [925474-1](#) [928905-1](#) [964562-4](#) [968782-1](#) [GT17SA-8DS-](#)
[HU](#) [98891-1012](#) [98947-1016](#) [12004147](#) [12004475-L](#) [12010290](#) [12010309-B](#) [12015454](#) [12020219-B](#) [12020308](#) [12041318-B](#) [12052225-L](#)
[12052466](#) [12059125](#) [12064869](#) [12004327-B](#) [12010503-B](#) [12015308](#) [12015384](#) [12015909](#) [1-21030-1](#) [12041254](#) [12041318](#) [12047946-B](#)
[12047957](#) [12047957-L](#) [12059473](#) [12066261](#)