

PLEASE CHECK WWW.MOLEX.COM FOR LATEST PART INFORMATION

Part Number: [0622018671](#)
Status: **Active**
Overview: [Application Tooling](#)
Description: Vertical Receptacle Press-In Tool

Documents:

[RoHS Certificate of Compliance \(PDF\)](#)

General

Product Family	Application Tooling
Series	207122
Comments	See Tooling Specification (PDF) Above, Press-In Tool
Function	Insertion
Geographic Area	Global
Level of Automation	Manual
More Detailed Tech Information	applicationtooling@molex.com
Overview	Application Tooling
Product Name	PremiumGrade
Tool Type	Press-Fit Insertion Tool
UPC	883906174811
Warranty Disclaimer	CAUTION: Molex tooling crimp specifications are valid only when used with Molex terminals and tooling manufactured by Molex and sold by Molex or authorized distributors ("Molex Tooling"). When using tooling other than Molex Tooling with Molex specific connector systems listed in our ATS documents, the Molex tooling qualification does not apply and the responsibility for full qualification of the connector system is that of the customer. Molex accepts no liability for connector performance or tooling support where tooling other than Molex Tooling is used or where Molex Tooling is modified.

Material Info

Reference - Drawing Numbers

Application Tooling Documents [ATS-622018671-001](#)

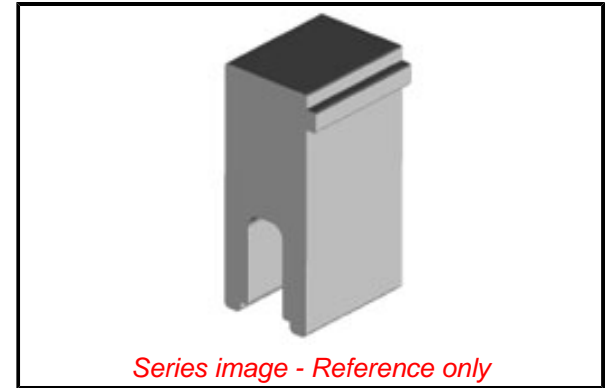

EU ELV

Not Reviewed

EU RoHS

Not Reviewed

REACH SVHC

Not Reviewed

Halogen-Free

Status

Not Reviewed

For more information, please visit [Contact US](#)

China ROHS

Not Reviewed

ELV

Not Reviewed

RoHS Phthalates

Not Reviewed

Search Parts in this Series

[207122 Series](#)

Use With

LPH Vertical Receptacle [46114 Series](#)

Application Tooling | [FAQ](#)

Description	Product #
-------------	-----------

1.27mm, 12.00mm Pitch, EXTreme LPHPower Receptacle Header, Vertical, 10 Power Contacts, 20 Signal Contacts, Select Gold (Au) Plating, with BMI Guides	461141020
---	---------------------------

1.27mm, 12.00mm Pitch, EXTreme LPHPower Receptacle Header, Vertical, 10 Power Contacts, 20 Signal Contacts, Select Gold (Au) Plating, without BMI Guides	461141021
--	---------------------------

1.27mm, 12.00mm 461141024
Pitch, EXTreme
LPHPower
Receptacle Header,
Vertical, 10 Power
Contacts, 24 Signal
Contacts, Select
Gold (Au) Plating,
with BMI Guides

1.27mm, 12.00mm 461141025
Pitch, EXTreme
LPHPower
Receptacle Header,
Vertical, 10 Power
Contacts, 24 Signal
Contacts, Select
Gold (Au) Plating,
without BMI Guides

1.27mm, 12.00mm 461141028
Pitch, EXTreme
LPHPower
Receptacle Header,
Vertical, 10 Power
Contacts, 28 Signal
Contacts, Select
Gold (Au) Plating,
with BMI Guides

1.27mm, 12.00mm 461141029
Pitch, EXTreme
LPHPower
Receptacle Header,
Vertical, 10 Power
Contacts, 28 Signal
Contacts, Select
Gold (Au) Plating,
without BMI Guides

1.27mm, 12.00mm 461141040
Pitch, EXTreme
LPHPower
Receptacle Header,
Vertical, 10 Power
Contacts, 40 Signal
Contacts, Select
Gold (Au) Plating,
with BMI Guides

1.27mm, 12.00mm 461141041
Pitch, EXTreme
LPHPower
Receptacle Header,
Vertical, 10 Power
Contacts, 40 Signal
Contacts, Select
Gold (Au) Plating,
without BMI Guides

1.27mm, 12.00mm 461141220
Pitch, EXTreme
LPHPower
Receptacle Header,
Vertical, Compliant
Pin, 12 Power
Contacts, 20 Signal
Contacts, Select
Gold (Au) Plating,
with BMI Guides

1.27mm, 12.00mm 461141221
Pitch, EXTreme
LPHPower
Receptacle Header,
Vertical, Compliant
Pin, 12 Power
Contacts, 20 Signal
Contacts, Select
Gold (Au) Plating,
without BMI Guides

1.27mm, 12.00mm 461141224
Pitch, EXTreme
LPHPower
Receptacle Header,
Vertical, Compliant
Pin, 12 Power
Contacts, 24 Signal
Contacts, Select
Gold (Au) Plating,
with BMI Guides

1.27mm, 12.00mm 461141225
Pitch, EXTreme
LPHPower
Receptacle Header,
Vertical, Compliant
Pin, 12 Power
Contacts, 24 Signal
Contacts, Select
Gold (Au) Plating,
without BMI Guides

1.27mm, 12.00mm 461141228
Pitch, EXTreme
LPHPower
Receptacle Header,
Vertical, Compliant
Pin, 12 Power
Contacts, 28 Signal
Contacts, Select
Gold (Au) Plating,
with BMI Guides

1.27mm, 12.00mm 461141229
Pitch, EXTreme
LPHPower
Receptacle Header,
Vertical, Compliant
Pin, 12 Power
Contacts, 28 Signal
Contacts, Select
Gold (Au) Plating,
without BMI Guides

1.27mm, 12.00mm 461141240
Pitch, EXTreme
LPHPower
Receptacle Header,
Vertical, Compliant
Pin, 12 Power
Contacts, 40 Signal
Contacts, Select
Gold (Au) Plating,
with BMI Guides

1.27mm, 12.00mm 461141241
Pitch, EXTreme
LPHPower
Receptacle Header,
Vertical, Compliant

Pin, 12 Power
Contacts, 40 Signal
Contacts, Select
Gold (Au) Plating,
without BMI Guides
1.27mm, 12.00mm 461141420
Pitch, EXTreme
LPHPower
Receptacle Header,
Vertical, Compliant
Pin, 14 Power
Contacts, 20 Signal
Contacts, Select
Gold (Au) Plating,
with BMI Guides
1.27mm, 12.00mm 461141421
Pitch, EXTreme
LPHPower
Receptacle Header,
Vertical, Compliant
Pin, 14 Power
Contacts, 20 Signal
Contacts, Select
Gold (Au) Plating,
without BMI Guides
1.27mm, 12.00mm 461141424
Pitch, EXTreme
LPHPower
Receptacle Header,
Vertical, Compliant
Pin, 14 Power
Contacts, 24 Signal
Contacts, Select
Gold (Au) Plating,
with BMI Guides
1.27mm, 12.00mm 461141425
Pitch, EXTreme
LPHPower
Receptacle Header,
Vertical, Compliant
Pin, 14 Power
Contacts, 24 Signal
Contacts, Select
Gold (Au) Plating,
without BMI Guides
1.27mm, 12.00mm 461141428
Pitch, EXTreme
LPHPower
Receptacle Header,
Vertical, Compliant
Pin, 14 Power
Contacts, 28 Signal
Contacts, Select
Gold (Au) Plating,
with BMI Guides
1.27mm, 12.00mm 461141429
Pitch, EXTreme
LPHPower
Receptacle Header,
Vertical, Compliant
Pin, 14 Power
Contacts, 28 Signal
Contacts, Select
Gold (Au) Plating,
without BMI Guides

1.27mm, 12.00mm 461141440
Pitch, EXTreme
LPHPower
Receptacle Header,
Vertical, Compliant
Pin, 14 Power
Contacts, 40 Signal
Contacts, Select
Gold (Au) Plating,
with BMI Guides

1.27mm, 12.00mm 461141441
Pitch, EXTreme
LPHPower
Receptacle Header,
Vertical, Compliant
Pin, 14 Power
Contacts, 40 Signal
Contacts, Select
Gold (Au) Plating,
without BMI Guides

1.27mm, 12.00mm 461142200
Pitch, EXTreme
LPHPower
Receptacle Header,
Vertical, 2 Power
Contacts, 20 Signal
Contacts, Select
Gold (Au) Plating,
with BMI Guides

1.27mm, 12.00mm 461142201
Pitch, EXTreme
LPHPower
Receptacle Header,
Vertical, 2 Power
Contacts, 20 Signal
Contacts, Select
Gold (Au) Plating,
without BMI Guides

1.27mm, 12.00mm 461142240
Pitch, EXTreme
LPHPower
Receptacle Header,
Vertical, 2 Power
Contacts, 24 Signal
Contacts, Select
Gold (Au) Plating,
with BMI Guides

1.27mm, 12.00mm 461142241
Pitch, EXTreme
LPHPower
Receptacle Header,
Vertical, 2 Power
Contacts, 24 Signal
Contacts, Select
Gold (Au) Plating,
without BMI Guides

1.27mm, 12.00mm 461142280
Pitch, EXTreme
LPHPower
Receptacle Header,
Vertical, 2 Power
Contacts, 28 Signal
Contacts, Select
Gold (Au) Plating,
with BMI Guides

1.27mm, 12.00mm 461142281
Pitch, EXTreme
LPHPower
Receptacle Header,
Vertical, 2 Power
Contacts, 28 Signal
Contacts, Select
Gold (Au) Plating,
without BMI Guides

1.27mm, 12.00mm 461142400
Pitch, EXTreme
LPHPower
Receptacle Header,
Vertical, 2 Power
Contacts, 40 Signal
Contacts, Select
Gold (Au) Plating,
with BMI Guides

1.27mm, 12.00mm 461142401
Pitch, EXTreme
LPHPower
Receptacle Header,
Vertical, 2 Power
Contacts, 40 Signal
Contacts, Select
Gold (Au) Plating,
without BMI Guides

1.27mm, 12.00mm 461144200
Pitch, EXTreme
LPHPower
Receptacle Header,
Vertical, 4 Power
Contacts, 20 Signal
Contacts, Select
Gold (Au) Plating,
with BMI Guides

1.27mm, 12.00mm 461144201
Pitch, EXTreme
LPHPower
Receptacle Header,
Vertical, 4 Power
Contacts, 20 Signal
Contacts, Select
Gold (Au) Plating,
without BMI Guides

1.27mm, 12.00mm 461144240
Pitch, EXTreme
LPHPower
Receptacle Header,
Vertical, 4 Power
Contacts, 24 Signal
Contacts, Select
Gold (Au) Plating,
with BMI Guides

1.27mm, 12.00mm 461144241
Pitch, EXTreme
LPHPower
Receptacle Header,
Vertical, 4 Power
Contacts, 24 Signal
Contacts, Select
Gold (Au) Plating,
without BMI Guides

1.27mm, 12.00mm 461144280
Pitch, EXTreme

LPHPower
Receptacle Header,
Vertical, 4 Power
Contacts, 28 Signal
Contacts, Select
Gold (Au) Plating,
with BMI Guides
1.27mm, 12.00mm 461144281
Pitch, EXTreme

LPHPower
Receptacle Header,
Vertical, 4 Power
Contacts, 28 Signal
Contacts, Select
Gold (Au) Plating,
without BMI Guides
1.27mm, 12.00mm 461144400
Pitch, EXTreme

LPHPower
Receptacle Header,
Vertical, 4 Power
Contacts, 40 Signal
Contacts, Select
Gold (Au) Plating,
with BMI Guides
1.27mm, 12.00mm 461144401
Pitch, EXTreme

LPHPower
Receptacle Header,
Vertical, 4 Power
Contacts, 40 Signal
Contacts, Select
Gold (Au) Plating,
without BMI Guides
1.27mm, 12.00mm 461146200
Pitch, EXTreme

LPHPower
Receptacle Header,
Vertical, 6 Power
Contacts, 20 Signal
Contacts, Select
Gold (Au) Plating,
with BMI Guides
1.27mm, 12.00mm 461146201
Pitch, EXTreme

LPHPower
Receptacle Header,
Vertical, 6 Power
Contacts, 20 Signal
Contacts, Select
Gold (Au) Plating,
without BMI Guides
1.27mm, 12.00mm 461146240
Pitch, EXTreme

LPHPower
Receptacle Header,
Vertical, 6 Power
Contacts, 24 Signal
Contacts, Select
Gold (Au) Plating,
with BMI Guides
1.27mm, 12.00mm 461146241
Pitch, EXTreme

LPHPower
Receptacle Header,

Vertical, 6 Power
Contacts, 24 Signal
Contacts, Select
Gold (Au) Plating,
without BMI Guides
1.27mm, 12.00mm 461146280
Pitch, EXTreme
LPHPower
Receptacle Header,
Vertical, 6 Power
Contacts, 28 Signal
Contacts, Select
Gold (Au) Plating,
with BMI Guides
1.27mm, 12.00mm 461146281
Pitch, EXTreme
LPHPower
Receptacle Header,
Vertical, 6 Power
Contacts, 28 Signal
Contacts, Select
Gold (Au) Plating,
without BMI Guides
1.27mm, 12.00mm 461146400
Pitch, EXTreme
LPHPower
Receptacle Header,
Vertical, 6 Power
Contacts, 40 Signal
Contacts, Select
Gold (Au) Plating,
with BMI Guides
1.27mm, 12.00mm 461146401
Pitch, EXTreme
LPHPower
Receptacle Header,
Vertical, 6 Power
Contacts, 40 Signal
Contacts, Select
Gold (Au) Plating,
without BMI Guides
1.27mm, 12.00mm 461148200
Pitch, EXTreme
LPHPower
Receptacle Header,
Vertical, Compliant
Pin, 8 Power
Contacts, 20 Signal
Contacts, Select
Gold (Au) Plating,
with BMI Guides
1.27mm, 12.00mm 461148201
Pitch, EXTreme
LPHPower
Receptacle Header,
Vertical, Compliant
Pin, 8 Power
Contacts, 20 Signal
Contacts, Select
Gold (Au) Plating,
without BMI Guides
1.27mm, 12.00mm 461148240
Pitch, EXTreme
LPHPower
Receptacle Header,

Vertical, Compliant Pin, 8 Power Contacts, 24 Signal Contacts, Select Gold (Au) Plating, with BMI Guides 1.27mm, 12.00mm Pitch, EXTreme LPHPower	<u>461148241</u>
Receptacle Header, Vertical, Compliant Pin, 8 Power Contacts, 24 Signal Contacts, Select Gold (Au) Plating, without BMI Guides 1.27mm, 12.00mm Pitch, EXTreme LPHPower	<u>461148280</u>
Receptacle Header, Vertical, Compliant Pin, 8 Power Contacts, 28 Signal Contacts, Select Gold (Au) Plating, with BMI Guides 1.27mm, 12.00mm Pitch, EXTreme LPHPower	<u>461148281</u>
Receptacle Header, Vertical, Compliant Pin, 8 Power Contacts, 28 Signal Contacts, Select Gold (Au) Plating, without BMI Guides 1.27mm, 12.00mm Pitch, EXTreme LPHPower	<u>461148400</u>
Receptacle Header, Vertical, Compliant Pin, 8 Power Contacts, 40 Signal Contacts, Select Gold (Au) Plating, with BMI Guides 1.27mm, 12.00mm Pitch, EXTreme LPHPower	<u>461148401</u>
Receptacle Header, Vertical, Compliant Pin, 8 Power Contacts, 40 Signal Contacts, Select Gold (Au) Plating, without BMI Guides	

This document was generated on 11/02/2021

PLEASE CHECK WWW.MOLEX.COM FOR LATEST PART INFORMATION

X-ON Electronics

Largest Supplier of Electrical and Electronic Components

Click to view similar products for [Bench Top Tools](#) category:

Click to view products by [Molex](#) manufacturer:

Other Similar products are found below :

[0027](#) [6-1372442-6](#) [63801-4462](#) [63801-4561](#) [63801-7269](#) [679527-1](#) [691667-1](#) [7-21000-9](#) [768539-1](#) [854130-1](#) [854946-2](#) [856203-1](#) [904449-1](#)
[9-22280-9](#) [986096-2](#) [992438-3](#) [1-21000-3](#) [1-21000-1](#) [1-25022-4](#) [1302263353](#) [1302263355](#) [1302261057](#) [1302261101](#) [1302261206](#)
[1302261560](#) [1302263123](#) [1302264036](#) [1424264-1](#) [1424267-1](#) [1428211-1](#) [1428287-1](#) [1-455755-6](#) [1752744-1](#) [18023-9](#) [189763-1](#) [1901726-1](#)
[2079747-1](#) [21001-2](#) [2119083-1](#) [2119085-1](#) [2119371-1](#) [2161930-1](#) [2217088-2](#) [2217339-1](#) [2217347-1](#) [22281-9](#) [22374-7](#) [284565-000](#) [F1](#)
[Handle Spring](#) [19228-0213](#)