

**PLEASE CHECK WWW.MOLEX.COM FOR LATEST PART INFORMATION**

**Part Number:** [0622018672](#)  
**Status:** **Active**  
**Overview:** [Application Tooling](#)  
**Description:** Vertical Receptacle Press-In Tool

**Documents:**

[RoHS Certificate of Compliance \(PDF\)](#)

**General**

Product Family	Application Tooling
Series	<a href="#">207122</a>
Comments	See Tooling Specification (PDF) Above, Press-In Tool
Function	Insertion
Geographic Area	Global
Level of Automation	Manual
More Detailed Tech Information	<a href="mailto:applicationtooling@molex.com">applicationtooling@molex.com</a>
Overview	<a href="#">Application Tooling</a>
Product Name	PremiumGrade
Tool Type	Press-Fit Insertion Tool
UPC	883906174828
Warranty Disclaimer	CAUTION: Molex tooling crimp specifications are valid only when used with Molex terminals and tooling manufactured by Molex and sold by Molex or authorized distributors ("Molex Tooling"). When using tooling other than Molex Tooling with Molex specific connector systems listed in our ATS documents, the Molex tooling qualification does not apply and the responsibility for full qualification of the connector system is that of the customer. Molex accepts no liability for connector performance or tooling support where tooling other than Molex Tooling is used or where Molex Tooling is modified.

**Physical**

Net Weight 38.900/g

**Material Info**

**Reference - Drawing Numbers**

Application Tooling Documents [ATS-622018672-001](#)

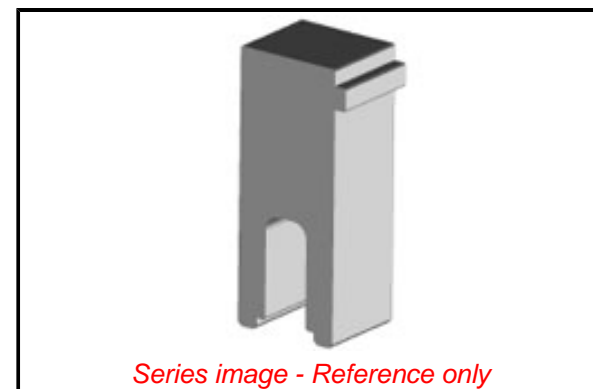

**EU ELV**

**Not Relevant**

**EU RoHS**

**Not Reviewed**

**REACH SVHC**

Not Reviewed

**Halogen-Free**

**Status**

**Not Relevant**

For more information, please visit [Contact US](#)

China ROHS

Not Relevant

ELV

Not Relevant

RoHS Phthalates

Not Reviewed

**Search Parts in this Series**

[207122 Series](#)

**Use With**

LPH Vertical Receptacle [46114 Series](#)

**Application Tooling** | [FAQ](#)

Description	Product #
-------------	-----------

1.27mm, 12.00mm Pitch, EXTreme LPHPower Receptacle Header, Vertical, 10 Power Contacts, 12 Signal Contacts, Select Gold (Au) Plating, with BMI Guides	<a href="#">461141012</a>
---	---------------------------

1.27mm, 12.00mm Pitch, EXTreme LPHPower Receptacle Header, Vertical, 10 Power Contacts, 12 Signal Contacts, Select Gold (Au) Plating, without BMI Guides	<a href="#">461141013</a>
--	---------------------------

1.27mm, 12.00mm 461141016  
Pitch, EXTreme  
LPHPower  
Receptacle Header,  
Vertical, 10 Power  
Contacts, 16 Signal  
Contacts, Select  
Gold (Au) Plating,  
with BMI Guides

1.27mm, 12.00mm 461141017  
Pitch, EXTreme  
LPHPower  
Receptacle Header,  
Vertical, 10 Power  
Contacts, 16 Signal  
Contacts, Select  
Gold (Au) Plating,  
without BMI Guides

1.27mm, 12.00mm 461141032  
Pitch, EXTreme  
LPHPower  
Receptacle Header,  
Vertical, 10 Power  
Contacts, 32 Signal  
Contacts, Select  
Gold (Au) Plating,  
with BMI Guides

1.27mm, 12.00mm 461141033  
Pitch, EXTreme  
LPHPower  
Receptacle Header,  
Vertical, 10 Power  
Contacts, 32 Signal  
Contacts, Select  
Gold (Au) Plating,  
without BMI Guides

1.27mm, 12.00mm 461141036  
Pitch, EXTreme  
LPHPower  
Receptacle Header,  
Vertical, 10 Power  
Contacts, 36 Signal  
Contacts, Select  
Gold (Au) Plating,  
with BMI Guides

1.27mm, 12.00mm 461141037  
Pitch, EXTreme  
LPHPower  
Receptacle Header,  
Vertical, 10 Power  
Contacts, 36 Signal  
Contacts, Select  
Gold (Au) Plating,  
without BMI Guides

1.27mm, 12.00mm 461141212  
Pitch, EXTreme  
LPHPower  
Receptacle Header,  
Vertical, Compliant  
Pin, 12 Power  
Contacts, 12 Signal  
Contacts, Select  
Gold (Au) Plating,  
with BMI Guides

1.27mm, 12.00mm [461141213](#)  
Pitch, EXTreme  
LPHPower  
Receptacle Header,  
Vertical, Compliant  
Pin, 12 Power  
Contacts, 12 Signal  
Contacts, Select  
Gold (Au) Plating,  
without BMI Guides

1.27mm, 12.00mm [461141216](#)  
Pitch, EXTreme  
LPHPower  
Receptacle Header,  
Vertical, Compliant  
Pin, 12 Power  
Contacts, 16 Signal  
Contacts, Select  
Gold (Au) Plating,  
with BMI Guides

1.27mm, 12.00mm [461141217](#)  
Pitch, EXTreme  
LPHPower  
Receptacle Header,  
Vertical, Compliant  
Pin, 12 Power  
Contacts, 16 Signal  
Contacts, Select  
Gold (Au) Plating,  
without BMI Guides

1.27mm, 12.00mm [461141232](#)  
Pitch, EXTreme  
LPHPower  
Receptacle Header,  
Vertical, Compliant  
Pin, 12 Power  
Contacts, 32 Signal  
Contacts, Select  
Gold (Au) Plating,  
with BMI Guides

1.27mm, 12.00mm [461141233](#)  
Pitch, EXTreme  
LPHPower  
Receptacle Header,  
Vertical, Compliant  
Pin, 12 Power  
Contacts, 32 Signal  
Contacts, Select  
Gold (Au) Plating,  
without BMI Guides

1.27mm, 12.00mm [461141236](#)  
Pitch, EXTreme  
LPHPower  
Receptacle Header,  
Vertical, Compliant  
Pin, 12 Power  
Contacts, 36 Signal  
Contacts, Select  
Gold (Au) Plating,  
with BMI Guides

1.27mm, 12.00mm [461141237](#)  
Pitch, EXTreme  
LPHPower  
Receptacle Header,  
Vertical, Compliant

Pin, 12 Power  
Contacts, 36 Signal  
Contacts, Select  
Gold (Au) Plating,  
without BMI Guides  
1.27mm, 12.00mm 461141412  
Pitch, EXTreme  
LPHPower  
Receptacle Header,  
Vertical, Compliant  
Pin, 14 Power  
Contacts, 12 Signal  
Contacts, Select  
Gold (Au) Plating,  
with BMI Guides  
1.27mm, 12.00mm 461141413  
Pitch, EXTreme  
LPHPower  
Receptacle Header,  
Vertical, Compliant  
Pin, 14 Power  
Contacts, 12 Signal  
Contacts, Select  
Gold (Au) Plating,  
without BMI Guides  
1.27mm, 12.00mm 461141416  
Pitch, EXTreme  
LPHPower  
Receptacle Header,  
Vertical, Compliant  
Pin, 14 Power  
Contacts, 16 Signal  
Contacts, Select  
Gold (Au) Plating,  
with BMI Guides  
1.27mm, 12.00mm 461141417  
Pitch, EXTreme  
LPHPower  
Receptacle Header,  
Vertical, Compliant  
Pin, 14 Power  
Contacts, 16 Signal  
Contacts, Select  
Gold (Au) Plating,  
without BMI Guides  
1.27mm, 12.00mm 461141432  
Pitch, EXTreme  
LPHPower  
Receptacle Header,  
Vertical, Compliant  
Pin, 14 Power  
Contacts, 32 Signal  
Contacts, Select  
Gold (Au) Plating,  
with BMI Guides  
1.27mm, 12.00mm 461141433  
Pitch, EXTreme  
LPHPower  
Receptacle Header,  
Vertical, Compliant  
Pin, 14 Power  
Contacts, 32 Signal  
Contacts, Select  
Gold (Au) Plating,  
without BMI Guides

1.27mm, 12.00mm [461141436](#)  
Pitch, EXTreme  
LPHPower  
Receptacle Header,  
Vertical, Compliant  
Pin, 14 Power  
Contacts, 36 Signal  
Contacts, Select  
Gold (Au) Plating,  
with BMI Guides

1.27mm, 12.00mm [461141437](#)  
Pitch, EXTreme  
LPHPower  
Receptacle Header,  
Vertical, Compliant  
Pin, 14 Power  
Contacts, 36 Signal  
Contacts, Select  
Gold (Au) Plating,  
without BMI Guides

1.27mm, 12.00mm [461142120](#)  
Pitch, EXTreme  
LPHPower  
Receptacle Header,  
Vertical, 2 Power  
Contacts, 12 Signal  
Contacts, Select  
Gold (Au) Plating,  
with BMI Guides

1.27mm, 12.00mm [461142121](#)  
Pitch, EXTreme  
LPHPower  
Receptacle Header,  
Vertical, 2 Power  
Contacts, 12 Signal  
Contacts, Select  
Gold (Au) Plating,  
without BMI Guides

1.27mm, 12.00mm [461142160](#)  
Pitch, EXTreme  
LPHPower  
Receptacle Header,  
Vertical, 2 Power  
Contacts, 16 Signal  
Contacts, Select  
Gold (Au) Plating,  
with BMI Guides

1.27mm, 12.00mm [461142161](#)  
Pitch, EXTreme  
LPHPower  
Receptacle Header,  
Vertical, 2 Power  
Contacts, 16 Signal  
Contacts, Select  
Gold (Au) Plating,  
without BMI Guides

1.27mm, 12.00mm [461142320](#)  
Pitch, EXTreme  
LPHPower  
Receptacle Header,  
Vertical, 2 Power  
Contacts, 32 Signal  
Contacts, Select  
Gold (Au) Plating,  
with BMI Guides

1.27mm, 12.00mm	<u>461142321</u>
Pitch, EXTreme	
LPHPower	
Receptacle Header,	
Vertical, 2 Power	
Contacts, 32 Signal	
Contacts, Select	
Gold (Au) Plating,	
without BMI Guides	
1.27mm, 12.00mm	<u>461142360</u>
Pitch, EXTreme	
LPHPower	
Receptacle Header,	
Vertical, 2 Power	
Contacts, 36 Signal	
Contacts, Select	
Gold (Au) Plating,	
with BMI Guides	
1.27mm, 12.00mm	<u>461142361</u>
Pitch, EXTreme	
LPHPower	
Receptacle Header,	
Vertical, 2 Power	
Contacts, 36 Signal	
Contacts, Select	
Gold (Au) Plating,	
without BMI Guides	
1.27mm, 12.00mm	<u>461144120</u>
Pitch, EXTreme	
LPHPower	
Receptacle Header,	
Vertical, 4 Power	
Contacts, 12 Signal	
Contacts, Select	
Gold (Au) Plating,	
with BMI Guides	
1.27mm, 12.00mm	<u>461144121</u>
Pitch, EXTreme	
LPHPower	
Receptacle Header,	
Vertical, 4 Power	
Contacts, 12 Signal	
Contacts, Select	
Gold (Au) Plating,	
without BMI Guides	
1.27mm, 12.00mm	<u>461144160</u>
Pitch, EXTreme	
LPHPower	
Receptacle Header,	
Vertical, 4 Power	
Contacts, 16 Signal	
Contacts, Select	
Gold (Au) Plating,	
with BMI Guides	
1.27mm, 12.00mm	<u>461144161</u>
Pitch, EXTreme	
LPHPower	
Receptacle Header,	
Vertical, 4 Power	
Contacts, 16 Signal	
Contacts, Select	
Gold (Au) Plating,	
without BMI Guides	
1.27mm, 12.00mm	<u>461144320</u>
Pitch, EXTreme	

LPHPower  
Receptacle Header,  
Vertical, 4 Power  
Contacts, 32 Signal  
Contacts, Select  
Gold (Au) Plating,  
with BMI Guides  
1.27mm, 12.00mm 461144321  
Pitch, EXTreme

LPHPower  
Receptacle Header,  
Vertical, 4 Power  
Contacts, 32 Signal  
Contacts, Select  
Gold (Au) Plating,  
without BMI Guides  
1.27mm, 12.00mm 461144360  
Pitch, EXTreme

LPHPower  
Receptacle Header,  
Vertical, 4 Power  
Contacts, 36 Signal  
Contacts, Select  
Gold (Au) Plating,  
with BMI Guides  
1.27mm, 12.00mm 461144361  
Pitch, EXTreme

LPHPower  
Receptacle Header,  
Vertical, 4 Power  
Contacts, 36 Signal  
Contacts, Select  
Gold (Au) Plating,  
without BMI Guides  
1.27mm, 12.00mm 461146120  
Pitch, EXTreme

LPHPower  
Receptacle Header,  
Vertical, 6 Power  
Contacts, 12 Signal  
Contacts, Select  
Gold (Au) Plating,  
with BMI Guides  
1.27mm, 12.00mm 461146121  
Pitch, EXTreme

LPHPower  
Receptacle Header,  
Vertical, 6 Power  
Contacts, 12 Signal  
Contacts, Select  
Gold (Au) Plating,  
without BMI Guides  
1.27mm, 12.00mm 461146160  
Pitch, EXTreme

LPHPower  
Receptacle Header,  
Vertical, 6 Power  
Contacts, 16 Signal  
Contacts, Select  
Gold (Au) Plating,  
with BMI Guides  
1.27mm, 12.00mm 461146161  
Pitch, EXTreme

LPHPower  
Receptacle Header,

Vertical, 6 Power  
Contacts, 16 Signal  
Contacts, Select  
Gold (Au) Plating,  
without BMI Guides  
1.27mm, 12.00mm 461146320  
Pitch, EXTreme  
LPHPower  
Receptacle Header,  
Vertical, 6 Power  
Contacts, 32 Signal  
Contacts, Select  
Gold (Au) Plating,  
with BMI Guides  
1.27mm, 12.00mm 461146321  
Pitch, EXTreme  
LPHPower  
Receptacle Header,  
Vertical, 6 Power  
Contacts, 32 Signal  
Contacts, Select  
Gold (Au) Plating,  
without BMI Guides  
1.27mm, 12.00mm 461146360  
Pitch, EXTreme  
LPHPower  
Receptacle Header,  
Vertical, 6 Power  
Contacts, 36 Signal  
Contacts, Select  
Gold (Au) Plating,  
with BMI Guides  
1.27mm, 12.00mm 461146361  
Pitch, EXTreme  
LPHPower  
Receptacle Header,  
Vertical, 6 Power  
Contacts, 36 Signal  
Contacts, Select  
Gold (Au) Plating,  
without BMI Guides  
1.27mm, 12.00mm 461148120  
Pitch, EXTreme  
LPHPower  
Receptacle Header,  
Vertical, Compliant  
Pin, 8 Power  
Contacts, 12 Signal  
Contacts, Select  
Gold (Au) Plating,  
with BMI Guides  
1.27mm, 12.00mm 461148121  
Pitch, EXTreme  
LPHPower  
Receptacle Header,  
Vertical, Compliant  
Pin, 8 Power  
Contacts, 12 Signal  
Contacts, Select  
Gold (Au) Plating,  
without BMI Guides  
1.27mm, 12.00mm 461148160  
Pitch, EXTreme  
LPHPower  
Receptacle Header,



Vertical, Compliant Pin, 8 Power Contacts, 16 Signal Contacts, Select Gold (Au) Plating, with BMI Guides 1.27mm, 12.00mm Pitch, EXTreme LPHPower	<u>461148161</u>
Receptacle Header, Vertical, Compliant Pin, 8 Power Contacts, 16 Signal Contacts, Select Gold (Au) Plating, without BMI Guides 1.27mm, 12.00mm Pitch, EXTreme LPHPower	<u>461148320</u>
Receptacle Header, Vertical, Compliant Pin, 8 Power Contacts, 32 Signal Contacts, Select Gold (Au) Plating, with BMI Guides 1.27mm, 12.00mm Pitch, EXTreme LPHPower	<u>461148321</u>
Receptacle Header, Vertical, Compliant Pin, 8 Power Contacts, 32 Signal Contacts, Select Gold (Au) Plating, without BMI Guides 1.27mm, 12.00mm Pitch, EXTreme LPHPower	<u>461148360</u>
Receptacle Header, Vertical, Compliant Pin, 8 Power Contacts, 36 Signal Contacts, Select Gold (Au) Plating, with BMI Guides 1.27mm, 12.00mm Pitch, EXTreme LPHPower	<u>461148361</u>
Receptacle Header, Vertical, Compliant Pin, 8 Power Contacts, 36 Signal Contacts, Select Gold (Au) Plating, without BMI Guides	

This document was generated on 11/02/2021

**PLEASE CHECK [WWW.MOLEX.COM](http://WWW.MOLEX.COM) FOR LATEST PART INFORMATION**

## X-ON Electronics

Largest Supplier of Electrical and Electronic Components

*Click to view similar products for [Bench Top Tools](#) category:*

*Click to view products by [Molex](#) manufacturer:*

Other Similar products are found below :

[0027](#) [6-1372442-6](#) [63801-4462](#) [63801-4561](#) [63801-7269](#) [679527-1](#) [691667-1](#) [7-21000-9](#) [768539-1](#) [854130-1](#) [854946-2](#) [856203-1](#) [904449-1](#)  
[9-22280-9](#) [986096-2](#) [992438-3](#) [1-21000-3](#) [1-21000-1](#) [1-25022-4](#) [1302263353](#) [1302263355](#) [1302261057](#) [1302261101](#) [1302261206](#)  
[1302261560](#) [1302263123](#) [1302264036](#) [1424264-1](#) [1424267-1](#) [1428211-1](#) [1428287-1](#) [1-455755-6](#) [1752744-1](#) [18023-9](#) [189763-1](#) [1901726-1](#)  
[2079747-1](#) [21001-2](#) [2119083-1](#) [2119085-1](#) [2119371-1](#) [2161930-1](#) [2217088-2](#) [2217339-1](#) [2217347-1](#) [22281-9](#) [22374-7](#) [284565-000](#) [F1](#)  
[Handle Spring](#) [19228-0213](#)