

**PLEASE CHECK WWW.MOLEX.COM FOR LATEST PART INFORMATION**

**Part Number:** [0638241200](#)  
**Status:** **Active**  
**Overview:** [Application Tooling](#)  
**Description:** Unlocking Tool for CMC and CMX Receptacle Connector

**Documents:**

[RoHS Certificate of Compliance \(PDF\)](#)

**General**

Product Family	Application Tooling
Series	<a href="#">207121</a>
Comments	See Tooling Specification (PDF) Above
Function	Extraction
Geographic Area	Global
Level of Automation	Manual
More Detailed Tech Information	<a href="mailto:applicationtooling@molex.com">applicationtooling@molex.com</a>
Overview	<a href="#">Application Tooling</a>
Product Name	N/A
Tool Type	Extraction Hand Tool
UPC	884982688070
Warranty Disclaimer	CAUTION: Molex tooling crimp specifications are valid only when used with Molex terminals and tooling manufactured by Molex and sold by Molex or authorized distributors ("Molex Tooling"). When using tooling other than Molex Tooling with Molex specific connector systems listed in our ATS documents, the Molex tooling qualification does not apply and the responsibility for full qualification of the connector system is that of the customer. Molex accepts no liability for connector performance or tooling support where tooling other than Molex Tooling is used or where Molex Tooling is modified.

**Material Info**

**Reference - Drawing Numbers**

Application Tooling Documents [ATS-638241200-001](#)

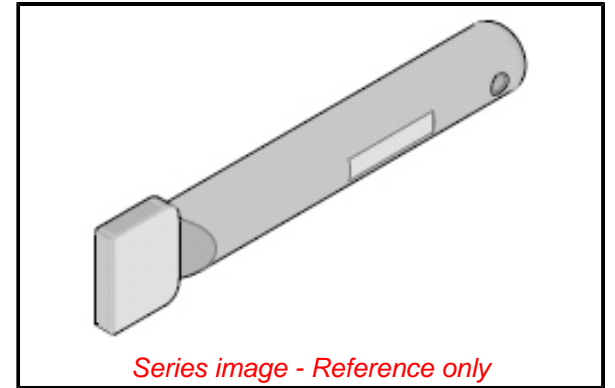

*Series image - Reference only*

**EU ELV**

**Not Reviewed**

**EU RoHS**

**Not Reviewed**

**REACH SVHC**

Not Reviewed

**Halogen-Free**

**Status**

**Not Reviewed**

For more information, please visit [Contact US](#)

China ROHS

Not Reviewed

ELV

Not Reviewed

RoHS Phthalates

Not Reviewed

**Search Parts in this Series**

[207121 Series](#)

**Use With**

CMC-CMX Receptacle Connector Assemblies, 22 to 53 Way.

**Application Tooling | FAQ**

<b>Description</b>	<b>Product #</b>
--------------------	------------------

.635mm, 1.50mm, 2.80mm, Power CMC Receptacle, 28 Circuits, Left Wire Output, Black Coding, Mat Sealed	<a href="#">643181011</a>
---	---------------------------

.635mm, 1.50mm, 2.80mm, Power CMC Connector, 28 Circuits, Left Wire Output, Gray Coding, Mat Sealed	<a href="#">643181018</a>
---	---------------------------

.635mm, 1.50mm, 2.80mm, Power CMC Connector, 28 Circuits, Left Wire Output, Brown Coding, Mat Sealed	<a href="#">643181019</a>
--	---------------------------

.635mm, 1.50mm, 2.80mm, Power CMC Connector, 28 Circuits, Left Wire Output, Gray Coding, Mat Sealed	<a href="#">643181018</a>
---	---------------------------

.635mm, 1.50mm, 2.80mm, Power CMC Connector, 28 Circuits, Left Wire Output, Brown Coding, Mat Sealed	<a href="#">643181019</a>
--	---------------------------

.635mm, 1.50mm, 2.80mm, Power CMC Connector, 28 Circuits, Left Wire Output, Gray Coding, Mat Sealed	<a href="#">643181018</a>
---	---------------------------

.635mm, 1.50mm, 2.80mm, Power CMC Connector, 28 Circuits, Left Wire Output, Brown Coding, Mat Sealed	<a href="#">643181019</a>
--	---------------------------

.635mm, 1.50mm, 2.80mm, Power CMC Connector, 28 Circuits, Left Wire Output, Gray Coding, Mat Sealed	<a href="#">643181018</a>
---	---------------------------

.635mm, 1.50mm, 2.80mm, Power CMC Connector, 28 Circuits, Left Wire Output, Brown Coding, Mat Sealed	<a href="#">643181019</a>
--	---------------------------

.635mm, 1.50mm, 2.80mm, Power CMC Connector, 28 Circuits, Left Wire Output, Gray Coding, Mat Sealed	<a href="#">643181018</a>
---	---------------------------

.635mm, 1.50mm, 2.80mm, Power CMC Connector, 28 Circuits, Left Wire Output, Brown Coding, Mat Sealed	<a href="#">643181019</a>
--	---------------------------

.635mm, 1.50mm, 2.80mm, Power CMC Connector, 28 Circuits, Left Wire Output, Gray Coding, Mat Sealed	<a href="#">643181018</a>
---	---------------------------

.635mm, 1.50mm, 2.80mm, Power CMC Connector, 28 Circuits, Left Wire Output, Brown Coding, Mat Sealed	<a href="#">643181019</a>
--	---------------------------

.635mm, 1.50mm, 2.80mm, Power CMC Connector, 28 Circuits, Left Wire Output, Gray Coding, Mat Sealed	<a href="#">643181018</a>
---	---------------------------

.635mm, 1.50mm, 2.80mm, Power CMC Connector, 28 Circuits, Left Wire Output, Brown Coding, Mat Sealed	<a href="#">643181019</a>
--	---------------------------

.635mm, 1.50mm, 2.80mm, Power CMC Connector, 28 Circuits, Left Wire Output, Gray Coding, Mat Sealed	<a href="#">643181018</a>
---	---------------------------

.635mm, 1.50mm, 2.80mm, Power CMC Connector, 28 Circuits, Left Wire Output, Brown Coding, Mat Sealed	<a href="#">643181019</a>
--	---------------------------

.635mm, 1.50mm, 643183011  
2.80mm, Power  
CMC Connector,  
28 Circuits, Right  
Wire Output, Black  
Coding, Mat Sealed

.635mm, 1.50mm, 643183018  
2.80mm, Power  
CMC Connector, 28  
Circuits, Right Wire  
Output, Gray Coding,  
Mat Sealed

.635mm, 1.50mm, 643183019  
2.80mm, Power  
CMC Connector,  
28 Circuits, Right  
Wire Output, Brown  
Coding, Mat Sealed

CMC Wire Cap for 643191201  
32 Circuits, CMC  
Receptacle Mat  
Sealed

.635mm, 1.50mm, 643191211  
CMC Receptacle,  
32 Circuits, Left  
Wire Output, Black  
Coding, Mat Sealed

.635mm, 1.50mm, 643191216  
CMC Receptacle, 32  
Circuits, Left Wire  
Output, Blue Coding,  
Mat Sealed

.635mm, 1.50mm, 643191218  
CMC Receptacle, 32  
Circuits, Left Wire  
Output, Gray Coding,  
Mat Sealed

.635mm, 1.50mm, 643191219  
CMC Receptacle,  
32 Circuits, Left  
Wire Output, Brown  
Coding, Mat Sealed

.635mm, 1.50mm, 643192211  
CMC Receptacle,  
24 Circuits, Left  
Wire Output, Black  
Coding, Mat Sealed,  
Row 1 Closed

.635mm, 1.50mm, 643193211  
CMC Receptacle,  
32 Circuits, Right  
Wire Output, Black  
Coding, Mat Sealed

.635mm, 1.50mm, 643193216  
CMC Receptacle, 32  
Circuits, Right Wire  
Output, Blue Coding,  
Mat Sealed

.635mm, 1.50mm, 643193218  
CMC Receptacle, 32  
Circuits, Right Wire  
Output, Gray Coding,  
Mat Sealed

.635mm, 1.50mm, 643193219  
CMC Receptacle,

32 Circuits, Right Wire Output, Brown Coding, Mat Sealed .635mm, 1.50mm,	<u>643194211</u>
CMC Receptacle, 24 Circuits, Right Wire Output, Black Coding, Mat Sealed, Row 1 Closed CMC Wire Cap	<u>643201301</u>
for 48 Circuits and 28 Circuits, CMC Receptacle Mat Sealed .635mm, 1.50mm,	<u>643201311</u>
CMC Receptacle, 48 Circuits, Left Wire Output, Black Coding, Mat Sealed .635mm, 1.50mm,	<u>643201315</u>
CMC Receptacle, 48 Circuits, Left Wire Output, Green Coding, Mat Sealed .635mm, 1.50mm,	<u>643201318</u>
CMC Receptacle, 48 Circuits, Left Wire Output, Gray Coding, Mat Sealed .635mm, 1.50mm,	<u>643201319</u>
CMC Receptacle, 48 Circuits, Left Wire Output, Brown Coding, Mat Sealed .635mm, 1.50mm,	<u>643202311</u>
CMC Receptacle, 36 Circuits, Left Wire Output, Black Coding, Mat Sealed, Row 1 Closed .635mm, 1.50mm,	<u>643202319</u>
CMC Receptacle, 36 Circuits, Left Wire Output, Brown Coding, Mat Sealed, Row 1 Closed .635mm, 1.50mm,	<u>643203311</u>
CMC Receptacle, 48 Circuits, Right Wire Output, Black Coding, Mat Sealed .635mm, 1.50mm,	<u>643203315</u>
CMC Receptacle, 48 Circuits, Right Wire Output, Green Coding, Mat Sealed .635mm, 1.50mm,	<u>643203318</u>
CMC Receptacle, 48 Circuits, Right Wire Output, Gray Coding, Mat Sealed .635mm, 1.50mm,	<u>643203319</u>
CMC Receptacle, 48 Circuits, Right	

Wire Output, Brown Coding, Mat Sealed .635mm, 1.50mm,	<u>643204311</u>
CMC Receptacle, 36 Circuits, Right Wire Output, Black Coding, Mat Sealed, Row 1 closed .635mm, 1.50mm,	<u>643204319</u>
CMC Receptacle, 36 Circuits, Right Wire Output, Brown Coding, Mat Sealed, Row 1 closed .635mm, 1.50mm,	<u>643211011</u>
2.80mm, CMC Receptacle, 53 Circuits, Left Wire Output, Black Coding, Mat Sealed Pwr CMC Rcpt 53Ckt	<u>643211015</u>
L grn mat seal .635mm, 1.50mm,	<u>643211018</u>
2.80mm, CMC Receptacle, 53 Circuits, Left Wire Output, Gray Coding, Mat Sealed .635mm, 1.50mm,	<u>643211019</u>
2.80mm, CMC Receptacle, 53 Circuits, Left Wire Output, Brown Coding, Mat Sealed CMC Wire Cap for	<u>643211101</u>
53 Circuits, CMC Receptacle Mat Sealed .635mm, 1.50mm,	<u>643212011</u>
2.80mm, CMC Receptacle, 53 Circuits, Right Wire Output, Black Coding, Mat Sealed Pwr CMC Rcpt 53Ckt	<u>643212015</u>
R grn mat seal .635mm, 1.50mm,	<u>643212018</u>
2.80mm, CMC Receptacle, 53 Circuits, Right Wire Output, Gray Coding, Mat Sealed .635mm, 1.50mm,	<u>643212019</u>
2.80mm, CMC Receptacle, 53 Circuits, Right Wire Output, Brown Coding, Mat Sealed	

This document was generated on 10/07/2021

**PLEASE CHECK WWW.MOLEX.COM FOR LATEST PART INFORMATION**

## X-ON Electronics

Largest Supplier of Electrical and Electronic Components

*Click to view similar products for [Extraction, Removal & Insertion Tools](#) category:*

*Click to view products by [Molex](#) manufacturer:*

Other Similar products are found below :

[M8196914-08](#) [768211-2](#) [809-131](#) [844751-2](#) [8-59558-2](#) [91018-1](#) [12014013](#) [12093647](#) [1-21048-0](#) [R282867020](#) [12093078](#) [12180559](#) [1-21048-6](#) [12121897](#) [DCF.91.405.5LT](#) [1322](#) [15314260](#) [15313892](#) [15350698](#) [15350707](#) [15430130](#) [1643916-1](#) [1-679532-0](#) [1976593-3](#)  
[OUTEXT-0321](#) [2-1579008-3](#) [2-1579008-4](#) [229694-7](#) [231106-1](#) [241469](#) [91040-3](#) [91040-7](#) [965004-000](#) [965069-000](#) [1738219-1](#) [ET-JL05-16](#)  
[FG 0300 146 3000](#) [FIT-6](#) [210S048](#) [2-1579007-9](#) [231879-1](#) [CF-008025-000](#) [312138-3](#) [RJ11FODE](#) [356-162](#) [M8196914-10](#) [4-1579018-0](#)  
[483249-1](#) [5-1579007-2](#) [5-1579007-9](#)