

FEATURES AND SPECIFICATIONS

Features and Benefits

- Wire-to-wire panel mount connector for blind mate applications
- Positive lock for secure mating retention
- Allows for discrete or multiple circuit sizes into the back of the connector via discrete wire, ribbon cable or FFC
- Polarized side-to-side and 180°
- Hot stamped with week/year 4-digit date code

Reference Information

Product Specification: PS-73099-9999
 Packaging: Bag
 UL File No.: E29179
 CSA File No.: LR 19980
 Mates with: Front — 73099
 Back — 70066G, 70400G, 70430G
 Designed in: Inches

Electrical

Voltage: 30V MS AC/DC
 Current: 2.0A
 Contact Resistance: 30mΩ max.
 Dielectric Withstanding Voltage: 1060V
 Insulation Resistance: 10,000 MΩ min.

Mechanical

Insertion force to Panel: 111.20N (25 lbs.) max.
 Retention Force to Panel: 22.2N (5 lbs.) min.
 Durability: 6000 cycles

Physical

Housing: Black glass-filled polyester, UL 94V-0
 Contact: Beryllium Copper
 Plating: Cantilever Area—50μ" Gold
 Select Male Pin Area—50μ" Gold
 Underplating—Nickel
 Operating Temperature: -40 to +105°C

molex® 2.54mm (.100") Pitch
SL™

**Wire-to-Wire
 Drawer Connector**

73099

**Blind Mating,
 Hermaphroditic**

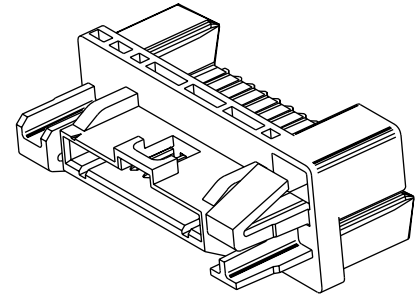

2.54mm (.100") Pitch

CATALOG DRAWING (FOR REFERENCE ONLY)

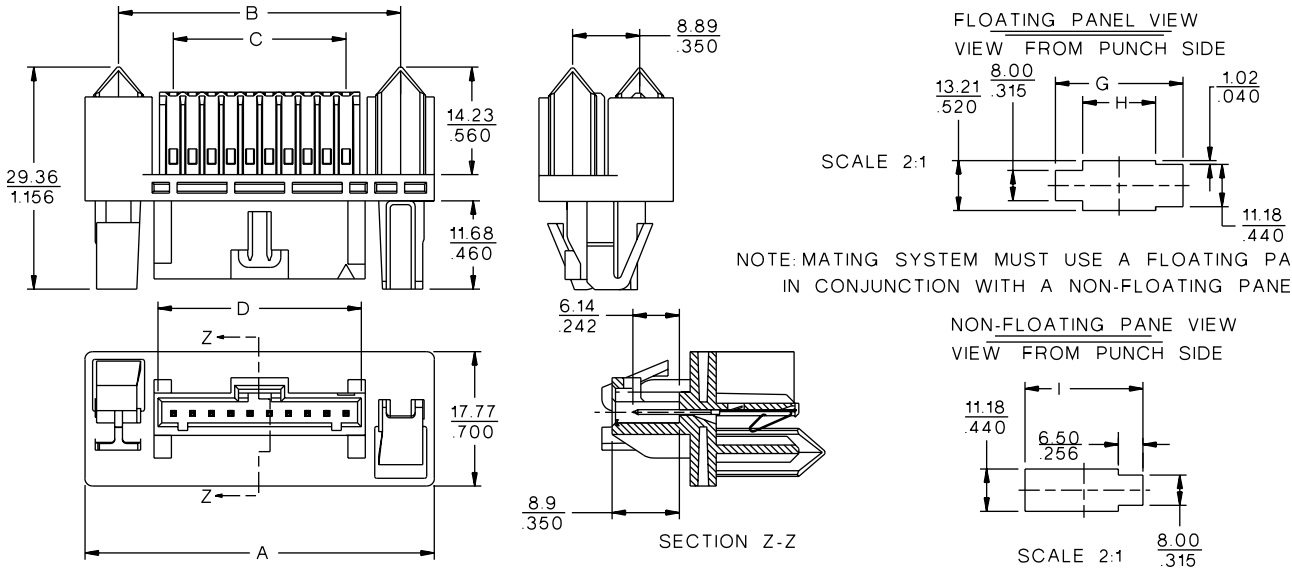

ORDERING INFORMATION AND DIMENSIONS

Circuits	Standard Configuration		Custom Configuration [†]		Dimension						
	Option A*	Option B	Option A*	Option B	A	B	C	D	G	H	I
4	†	†	†	†	30.99 (1.220)	22.10 (1.870)	7.62 (.300)	10.67 (.420)	31.24 (1.230)	16.76 (.660)	28.65 (1.128)
6	†	†	†	†	35.56 (1.420)	27.18 (1.070)	12.70 (.500)	15.75 (.620)	36.32 (1.430)	21.84 (.860)	33.73 (1.328)
8	†	†	†	†	41.15 (1.620)	32.26 (1.270)	17.78 (.700)	20.83 (.820)	41.40 (1.630)	26.92 (1.060)	38.81 (1.528)
10	†	†	73099-0001	73099-0002	46.23 (1.820)	37.74 (1.470)	22.86 (.900)	25.91 (1.020)	46.48 (1.830)	32.00 (1.260)	43.89 (1.728)
12	73099-0221	†	†	†	51.31 (2.020)	42.42 (1.670)	27.94 (1.100)	30.99 (1.220)	51.56 (2.030)	37.08 (1.460)	48.97 (1.928)

* Option A: When mated to another option A — Will orient one SL latch up (as pictured) and orient the other mating SL latch down.
 When mated to option B — Will orient both SL Connector latches up. Contact Molex for details.

† Custom configurations allow a predetermined combination of SL connectors with varying circuit sizes to be used when the total of the combinations equals the drawer connector circuit size.
 For example, a 10-circuit drawer connector custom configuration could accept two 2-circuit connectors and one 6-circuit SL connector. Contact Molex for details.

‡ Please contact Molex for Order Numbers.

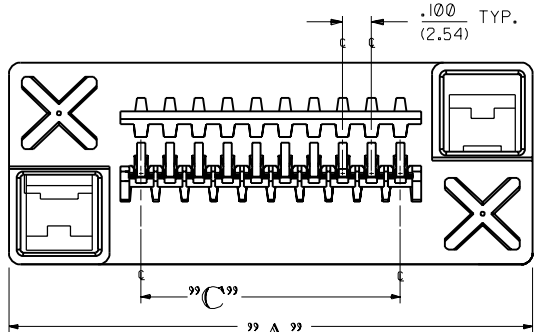

**STANDARD SL
OPTION (TYPE "A")
73099-02XX**

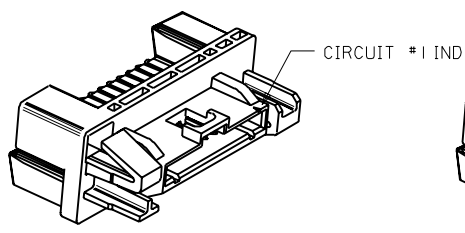

OPTION TYPE "A"

OPTION "A" VS

OPTION "A" MATED TO OPTION "A"
OPTION "A" MATED TO OPTION "B"
(BOTH OPTIONS "A" AND "B" P
STANDARD DRAWER VARI

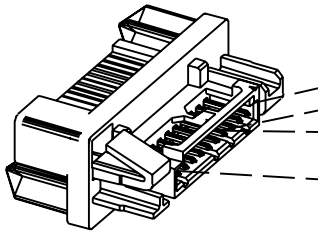
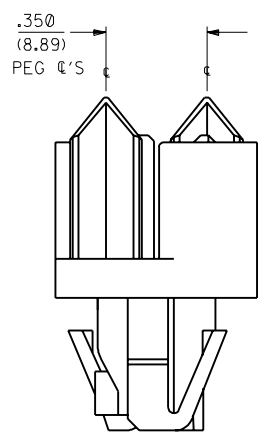
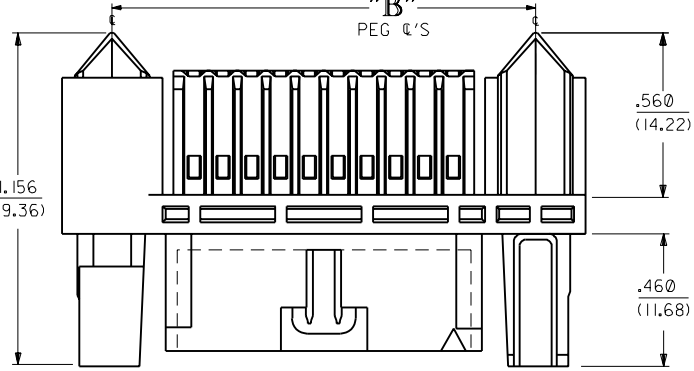

STANDARD VS

SEE NOTE 8. AND 9. (CUSTOM

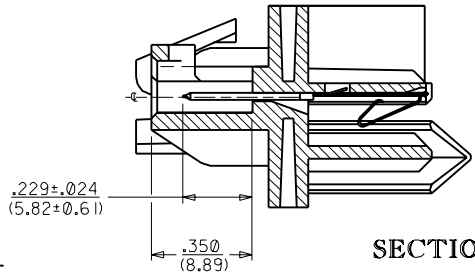
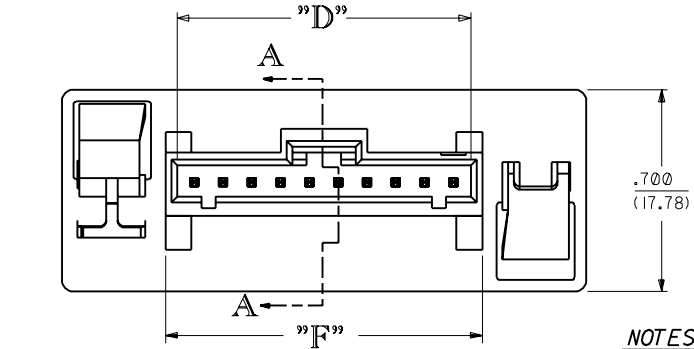

SECTION A-A

NOTES:

1. MATERIAL:
HOUSING: GLASS FILLED POLYESTER UL 94V-0, COLOR BLACK.
TERMINAL: BERYLLIUM COPPER
2. PLATING:
.000050 u" (1.27 MICRON) MIN. GOLD PLATE ON CANTILEVER AREA, .000015 MIN. GOLD PLATE ON SELECT SL TAIL AREA, NICKEL PLATE OVER-ALL.
3. SEE SHEET 4 FOR PART NUMBERS AND TABULATED DIMENSIONS.
4. PRODUCT CONFORMS TO PS-73099-****.
5. HOT STAMP DATE CODE IS WEEK, YEAR.
6. RECYCLING LOGO TO APPEAR WHERE ROOM IS AVAILABLE.
7. SEE SHEET 3 FOR PANEL MOUNTING AND MATING DETAILS.
8. 73099-**** CONNECTOR ALSO MATES WITH "SL" SERIES 70066, 70400, AND 70430.
9. PRODUCT DESCRIBED AS "STANDARD" MATES ONLY WITH EQUIVALENT CKT. SIZE CONNECTOR (10 CKT. DRAWER CONNECTOR TO 10 CKT. SL). PRODUCT DESCRIBED AS "CUSTOM" ALLOWS A PREDETERMINED COMBINATION OF SL CONNECTORS WITH VARYING CIRCUIT SIZES TO BE USED WHEN THE COMBINATION'S TOTAL CIRCUITS ADD UP TO THE DRAWER CONNECTOR'S CIRCUIT SIZE (10 CKT. DRAWER CONNECTOR TO TWO 2 CKT. & ONE 6 CKT. SL).

DATE CODE
SEE NOTE 5

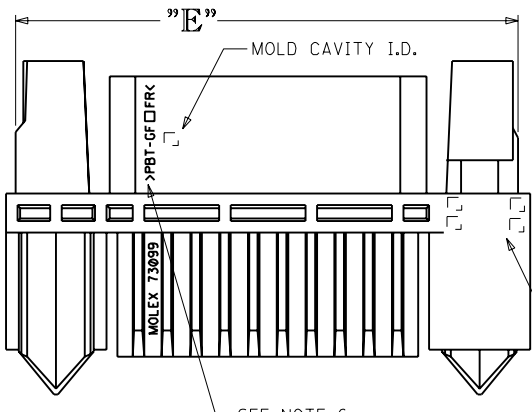

SEE NOTE 6.

DIMENSIONS SHOWN (METRIC) INCH			
UNLESS OTHERWISE SPECIFIED TOLERANCES ANGULAR ± 1/2°			
	INCH	METRIC	
3 PLACE	± .010	---	---
2 PLACE	± .014	± 0.25	---
1 PLACE	---	± 0.38	---
DRAFT WHERE APPLICABLE MUST REMAIN WITHIN DIMENSIONS			
DWG. BY	PAR	CHK'D. BY	PA
APP'D. BY	JWN	SCALE	3:

73099

SECTION A1-A1

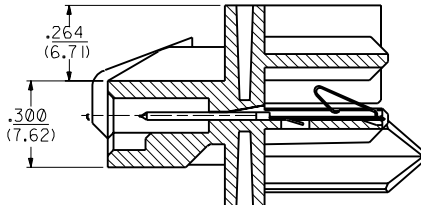

73099-0002

OPTION TYPE "B"

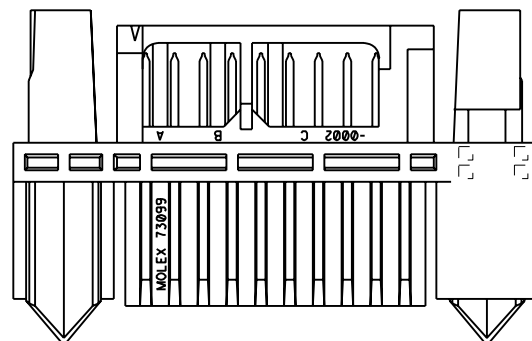
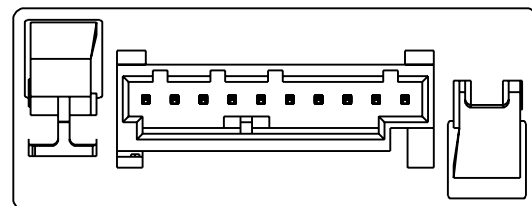
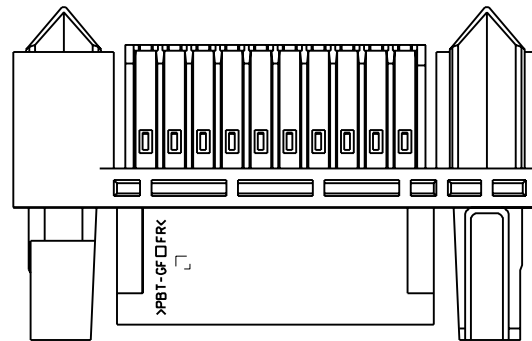
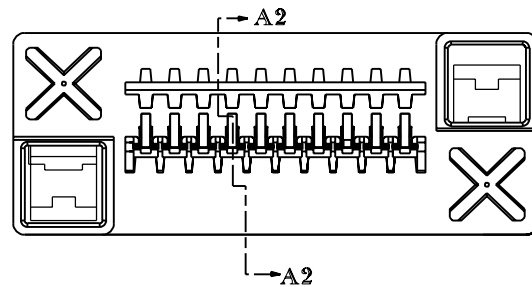

73099-0001

OPTION TYPE "A"

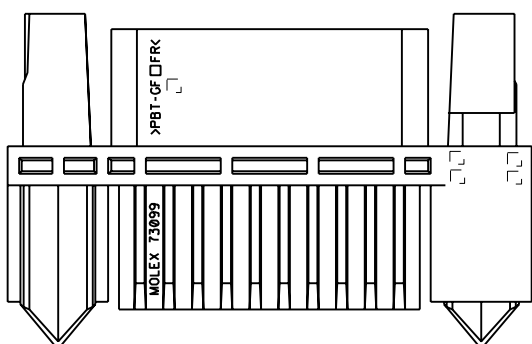
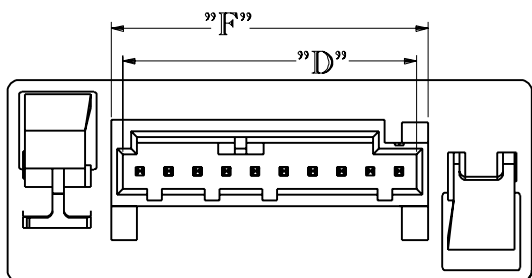
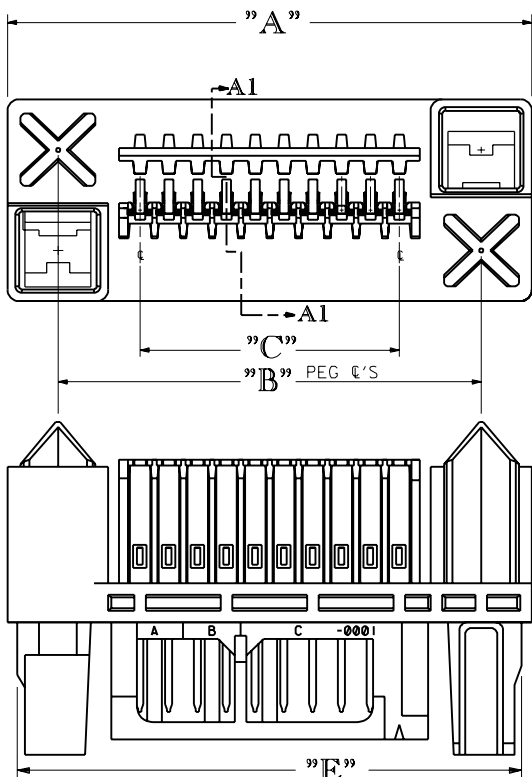

CUSTOM 10 CKT (OPTION "A" AND "B")

CUSTOM 10 MATES WITH THE FOLLOWING "SL" CIRCUIT SIZE COMBINATIONS:

- 1) 2 CKT., 2CKT., AND 6 CKT.
- 2) 4 CKT. AND 6 CKT.
- 3) 2 CKT. AND 8 CKT.
- 4) 10 CKT.

DIMENSIONS SHOWN (METRIC) INCH			
UNLESS OTHERWISE SPECIFIED TOLERANCES ANGULAR 1/2°			
	INCH	METRIC	
3 PLACE	± .010	---	---
2 PLACE	± .014	± 0.25	---
1 PLACE	---	± 0.36	---

DRAFT WHERE APPLICABLE MUST REMAIN WITHIN DIMENSIONS

DRAWN BY	PAR	CHECK'D BY	PA
APP'D BY	JWN	SCALE	3:

73099

PANEL DIMENSIONS

CKT. SIZE	DIM. "G" ± 0.10 (± 0.25)		DIM. "H" ± 0.10 (± 0.25)		DIM. "I" ± 0.10 (± 0.25)	
	INCH	(MM)	INCH	(MM)	INCH	(MM)
04	1.230	(31.24)	.660	(16.76)	1.128	(28.65)
06	1.430	(36.32)	.860	(21.84)	1.328	(33.73)
08	1.630	(41.40)	1.060	(26.92)	1.528	(38.81)
10	1.830	(46.48)	1.260	(32.00)	1.728	(43.89)
12	2.030	(51.56)	1.460	(37.08)	1.928	(48.97)

FLOATING PANEL VIEW

VIEW FROM PUNCH SIDE
(SCALE 2:1)

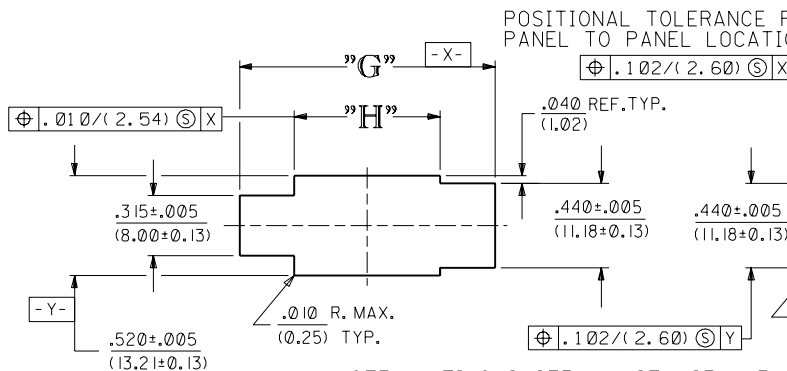

NOTE: MATING SYSTEM MUST USE A FLOATING PANEL IN CONJUNCTION WITH A NON-FLOATING PANEL

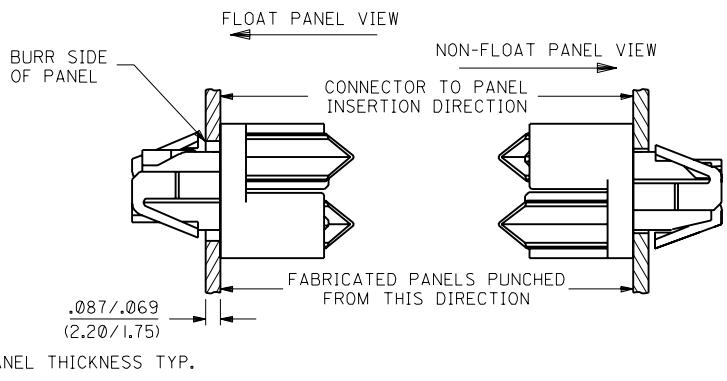

PANEL OFFSET VIEW

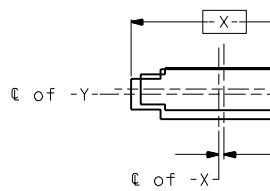
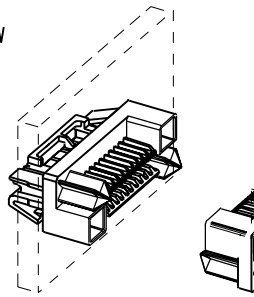

PANEL OFFSET ± .010
PANEL OFFSET ± .010

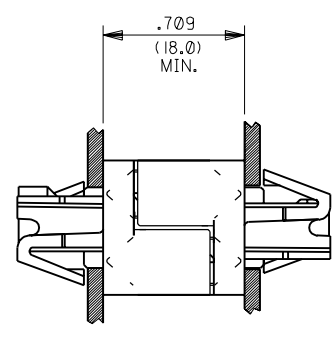
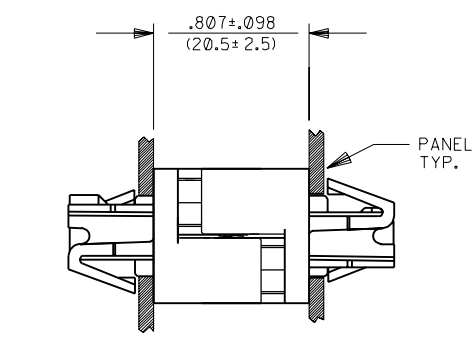

OPERATING PANEL CLOSURE DIMENSIONS

FULLY CLOSED CONNECTOR

DIMENSIONS SHOWN (METRIC) IN INCHES UNLESS OTHERWISE SPECIFIED TOLERANCES ANGULAR ±

	INCH	METRIC
3 PLACE	± .010	---
2 PLACE	± .014	± 0.25
1 PLACE	---	± 0.36

DRAFT WHERE APPLICABLE MUST REMAIN WITHIN DIMENSIONS

DRAWN BY: PAR
CHECKED BY: PA
APP'D BY: JWN
SCALE: :

13 12 11 10 9 8 7 6 73099 4

"STANDARD" DRAWER PART NUMBERS	ASSEMBLY PART NUMBERS AND DIMENSIONS BY CIRCUIT SIZE	"CUSTOM" PART N (SEE NOTE 9)
-----------------------------------	---	------------------------------------

S T A T	PART NUMBER	CKT. SIZE	OPTION TYPE (SEE SHEET 1)	DIM. "A"		DIM. "B"		DIM. "C"		DIM. "D"		DIM. "E"		DIM. "F"		S T A T	PART NUMBER	CKT. SIZE
				INCH	(MM)	INCH	(MM)	INCH	(MM)	INCH	(MM)	INCH	(MM)	INCH	(MM)			
X	SAME AS CUSTOM 04	04	A	1.220	(30.99)	.870	(22.10)	.300	(7.62)	.420	(10.67)	1.113	(28.27)	.500	(12.70)	X	73099-0003	04
X		04	B	1.220	(30.99)	.870	(22.10)	.300	(7.62)	.420	(10.67)	1.113	(28.27)	.500	(12.70)	X	73099-0004	04
X	73099-0209	06	A	1.420	(35.56)	1.070	(27.18)	.500	(12.70)	.620	(15.75)	1.313	(33.35)	.700	(17.78)	X		06
X	73099-0210	06	B	1.420	(35.56)	1.070	(27.18)	.500	(12.70)	.620	(15.75)	1.313	(33.35)	.700	(17.78)	X		06
X	73099-0213	08	A	1.620	(41.15)	1.270	(32.26)	.700	(17.78)	.820	(20.83)	1.513	(38.43)	.900	(22.86)	X		08
X	73099-0214	08	B	1.620	(41.15)	1.270	(32.26)	.700	(17.78)	.820	(20.83)	1.513	(38.43)	.900	(22.86)	X		08
X	73099-0217	10	A	1.820	(46.23)	1.470	(37.74)	.900	(22.86)	1.020	(25.91)	1.713	(43.51)	1.100	(27.94)	X	73099-0001	10
X	73099-0218	10	B	1.820	(46.23)	1.470	(37.74)	.900	(22.86)	1.020	(25.91)	1.713	(43.51)	1.100	(27.94)	X	73099-0002	10
X	73099-0221	12	A	2.020	(51.31)	1.670	(42.42)	1.100	(27.94)	1.220	(30.99)	1.913	(48.59)	1.300	(33.02)	X		12
X	73099-0222	12	B	2.020	(51.31)	1.670	(42.42)	1.100	(27.94)	1.220	(30.99)	1.913	(48.59)	1.300	(33.02)	X		12

X STATUS: PART NUMBERS WITH AN *X* IN THE STATUS COLUMN OR CIRCUIT SIZES WITH NO ASSOCIATED PART NUMBER DO NOT HAVE EXISTING TOOLING OR PRODUCTION CAPACITY.

* PREDETERMINED *SL* MATING ASSEMBLIES FOR *CUSTOM* 10 ARE LISTED ON SHEET 2. COMBINATIONS OF *SL* MATING CIRCUIT SIZES FOR OTHER *CUSTOM* DRAWER ASSEMBLIES HAVE TO BE DETERMINED.

DIMENSIONS SHOWN (METRIC) INCH			
UNLESS OTHERWISE SPECIFIED			
TOLERANCES ANGULAR ± .000			
	INCH	METRIC	
3 PLACE	± .010	---	
2 PLACE	± .014	± 0.25	
1 PLACE	---	± 0.36	
DRAFT WHERE APPLICABLE MUST REMAIN WITHIN DIMENSIONS			
DWG. BY	PAR	CHK'D. BY	PA
APP'D. BY	JWN	SCALE	:

13 12 11 10 9 8 7 6 5 4

13 12 11 10 9 8 7 6 73099 4 3 2

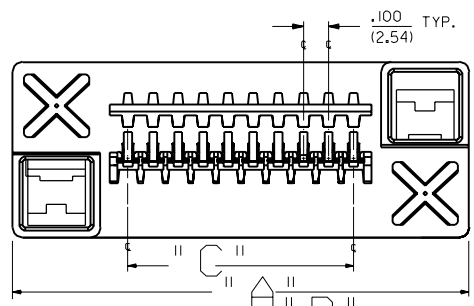

STANDARD SL
OPTION (TYPE "A")
73099-02XX

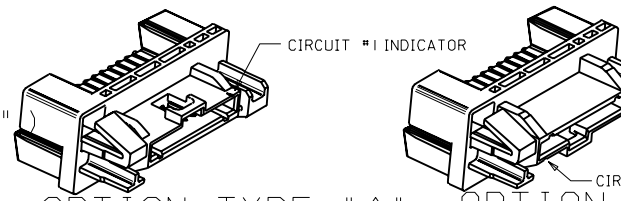

OPTION "A" MATED TO OPTION "A": CKT. 1 MATCHES WITH CKT. 1
OPTION "A" MATED TO OPTION "B": CKT. 1 MATCHES WITH CKT. 1
(BOTH OPTIONS "A" AND "B" PICTURED ABOVE ARE OF STANDARD DRAWER VARIATION - SEE NOTE 9.)

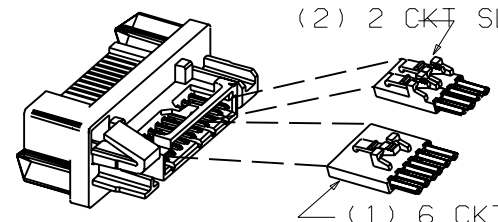

SEE NOTE 8. AND 9. (CUSTOM 10 CKT. PICTURED)

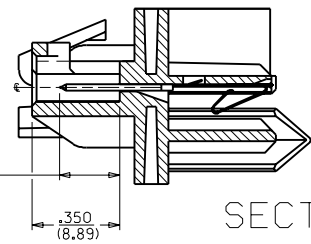
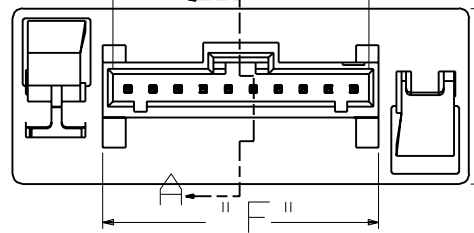
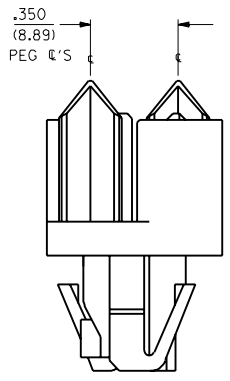
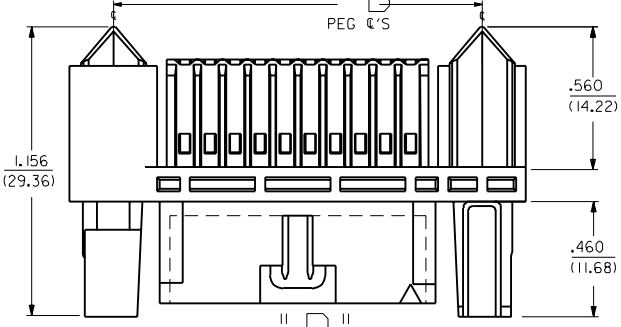

SECTION A-A

NOTES:

1. MATERIAL:
HOUSING: GLASS FILLED POLYESTER UL 94V-0, COLOR BLACK.
TERMINAL: BERYLLIUM COPPER
2. PLATING:
.000050 U" (.127 MICRON) MIN. GOLD PLATE ON CANTILEVER AREA, .000015 MIN. GOLD PLATE ON SELECT SL TAIL AREA, NICKEL PLATE OVER-ALL.
3. SEE SHEET 4 FOR PART NUMBERS AND TABULATED DIMENSIONS.
4. PRODUCT CONFORMS TO PS-73099-*****.
5. HOT STAMP DATE CODE IS WEEK, YEAR.
6. RECYCLING LOGO TO APPEAR WHERE ROOM IS AVAILABLE.
7. SEE SHEET 3 FOR PANEL MOUNTING AND MATING DETAILS.
8. 73099-***** CONNECTOR ALSO MATES WITH 'SL' SERIES 70066, 70400, AND 70430.
9. PRODUCT DESCRIBED AS "STANDARD" MATES ONLY WITH EQUIVALENT CKT. SIZE CONNECTOR (10 CKT. DRAWER CONNECTOR TO 10 CKT. SL). PRODUCT DESCRIBED AS "CUSTOM" ALLOWS A PREDETERMINED COMBINATION OF SL CONNECTORS WITH VARYING CIRCUIT SIZES TO BE USED WHEN THE COMBINATION'S TOTAL CIRCUITS ADD UP TO THE DRAWER CONNECTOR'S CIRCUIT SIZE (10 CKT. DRAWER CONNECTOR TO TWO 2 CKT. & ONE 6 CKT. SL).

DATE CODE
SEE NOTE 5

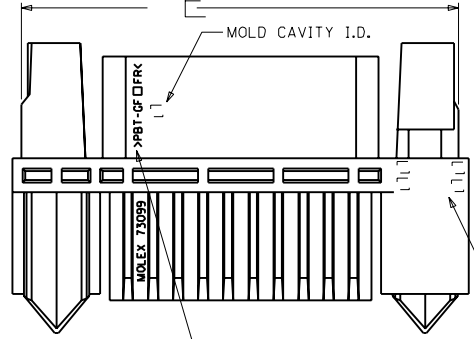

4	C
3	C
2	CI
1	CI

DIMENSIONS SHOWN (METRIC) INCH		UNLESS OTHERWISE SPECIFIED TOLERANCES: ANGULAR ± 1/2°	
	INCH		METRIC
3 PLACE	± .010	---	---
2 PLACE	± .014	±	0.25
1 PLACE	---	±	0.36
DRAFT WHERE APPLICABLE MUST REMAIN WITHIN DIMENSIONS			
DRWG. BY: PAR	CHKD. BY: PAR	FILE NAME: 73099	THIS DRAWING CONTAINS INFORMATION MOLEX INC. AND SHOULD NOT BE USED
APP'D. BY: JWN	SCALE: 3:1	REV. 521	

MOLEX INCORPORATED	
LITTLE ROCK, AR 72611	
PART NO. 73099	DRWG. NO. 60532
SEE CHART	
HERMAPHRODITE DRAWER CONNECTOR SALES ASSOCIATES	

13 12 11 10 9 8 7 6 5 4 3 2

PANEL DIMENSIONS						
CKT. SIZE	DIM. "G" ± 0.10 (± 0.25)		DIM. "H" ± 0.10 (± 0.25)		DIM. "I" ± 0.10 (± 0.25)	
	INCH	(MM)	INCH	(MM)	INCH	(MM)
04	1.230	(31.24)	.660	(16.76)	1.128	(28.65)
06	1.430	(36.32)	.860	(21.84)	1.328	(33.73)
08	1.630	(41.40)	1.060	(26.92)	1.528	(38.81)
10	1.830	(46.48)	1.260	(32.00)	1.728	(43.89)
12	2.030	(51.56)	1.460	(37.08)	1.928	(48.97)

FLOATING PANEL VIEW

VIEW FROM PUNCH SIDE
(SCALE 2:1)

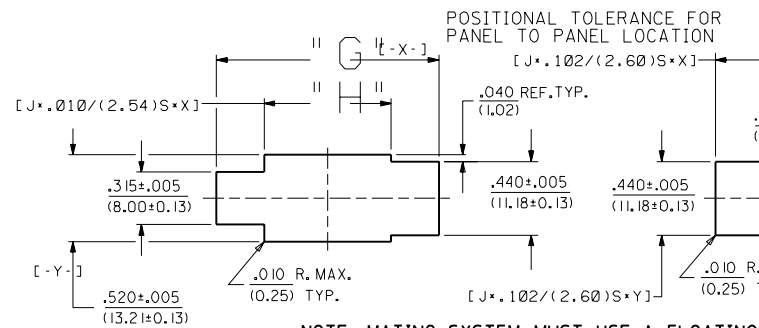

NON-FLOATING PANEL VIEW

VIEW FROM PUNCH SIDE
(SCALE 2:1)

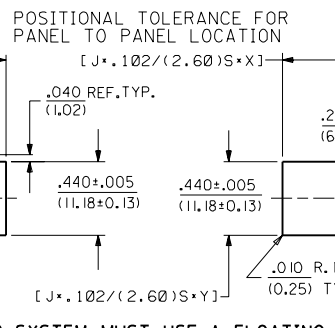

NOTE: MATING SYSTEM MUST USE A FLOATING PANEL IN CONJUNCTION WITH A NON-FLOATING PANEL

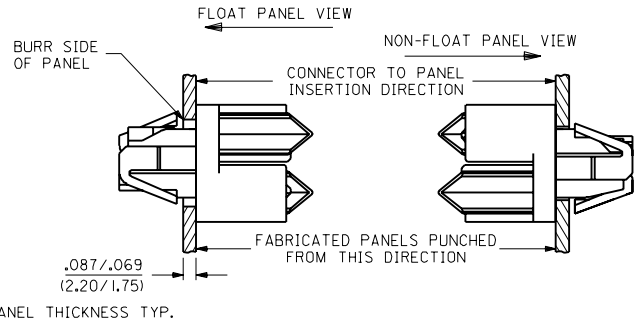

PANEL OFFSET VIEW

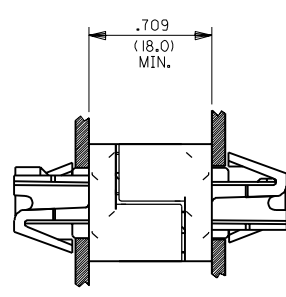
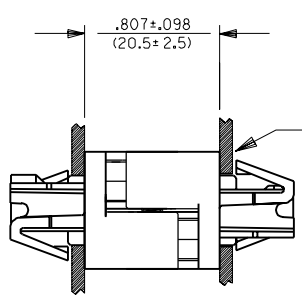
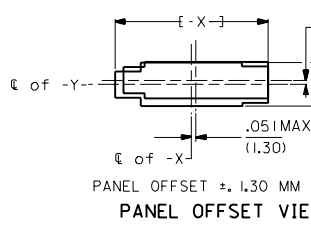
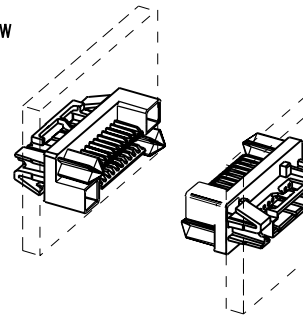

OPERATING PANEL FULLY CLOSED CONNECTOR CLOSURE DIMENSIONS

DIMENSIONS SHOWN (METRIC) INCH		TITLE	
UNLESS OTHERWISE SPECIFIED TOLERANCES: ANGLES .015			
PLACE	± .010	---	
PLACE	± .015	± 0.25	
PLACE	± .030	± 0.36	
DRAFT WHERE APPLICABLE MUST REMAIN WITHIN DIMENSIONS			
DRG. BY	PAR	CHK. BY	PAR
APP'D. BY	JWN	SCALE	:
FILE NAME	73099	PART NO.	SEE
DATE	824	REV.	MO

		13	12	11	10	9	8	7	6	73099		4	3						
		"STANDARD" DRAWER PART NUMBERS				ASSEMBLY PART NUMBERS AND DIMENSIONS BY CIRCUIT SIZE								"CUSTOM" DRAWER PART NUMBERS (SEE NOTE 9., SHEET 2)					
S T A T	PART NUMBER	CKT. SIZE	OPTION TYPE (SEE SHEET 1)	DIM. *A*		DIM. *B*		DIM. *C*		DIM. *D*		DIM. *E*		DIM. *F*		S T A T	PART NUMBER	CKT. SIZE	OP. (SEE SHEET 2)
				INCH	(MM)	INCH	(MM)	INCH	(MM)	INCH	(MM)	INCH	(MM)	INCH	(MM)				
X	SAME AS CUSTOM 04	04	A	1.220	(30.99)	.870	(22.10)	.300	(7.62)	.420	(10.67)	1.113	(28.27)	.500	(12.70)	X	73099-0003	04	
X	SAME AS CUSTOM 04	04	B	1.220	(30.99)	.870	(22.10)	.300	(7.62)	.420	(10.67)	1.113	(28.27)	.500	(12.70)	X	73099-0004	04	
X	73099-0209	06	A	1.420	(35.56)	1.070	(27.18)	.500	(12.70)	.620	(15.75)	1.313	(33.35)	.700	(17.78)	X		06	
X	73099-0210	06	B	1.420	(35.56)	1.070	(27.18)	.500	(12.70)	.620	(15.75)	1.313	(33.35)	.700	(17.78)	X		06	
X	73099-0213	08	A	1.620	(41.15)	1.270	(32.26)	.700	(17.78)	.820	(20.83)	1.513	(38.43)	.900	(22.86)	X		08	
X	73099-0214	08	B	1.620	(41.15)	1.270	(32.26)	.700	(17.78)	.820	(20.83)	1.513	(38.43)	.900	(22.86)	X		08	
X	73099-0217	10	A	1.820	(46.23)	1.470	(37.74)	.900	(22.86)	1.020	(25.91)	1.713	(43.51)	1.100	(27.94)	X	73099-0001	10	
X	73099-0218	10	B	1.820	(46.23)	1.470	(37.74)	.900	(22.86)	1.020	(25.91)	1.713	(43.51)	1.100	(27.94)	X	73099-0002	10	
X	73099-0221	12	A	2.020	(51.31)	1.670	(42.42)	1.100	(27.94)	1.220	(30.99)	1.913	(48.59)	1.300	(33.02)	X		12	
X	73099-0222	12	B	2.020	(51.31)	1.670	(42.42)	1.100	(27.94)	1.220	(30.99)	1.913	(48.59)	1.300	(33.02)	X		12	

X STATUS: PART NUMBERS WITH AN *X* IN THE STATUS COLUMN OR CIRCUIT SIZES WITH NO ASSOCIATED PART NUMBER DO NOT HAVE EXISTING TOOLING OR PRODUCTION CAPACITY.

* PREDETERMINED *SL* MATING ASSEMBLIES FOR *CUSTOM* 10 ARE LISTED ON SHEET 2. COMBINATIONS OF *SL* MATING CIRCUIT SIZES FOR OTHER *CUSTOM* DRAWER ASSEMBLIES HAVE TO BE DETERMINED.

DIMENSIONS SHOWN (METRIC/INCH)
UNLESS OTHERWISE SPECIFIED
TOLERANCES: ANGLES .01°

	INCH	METRIC
3 PLACE	± .010	---
2 PLACE	± .014	± 0.25
1 PLACE	---	± 0.36

DRAFT WHERE APPLICABLE MUST REMAIN WITHIN DIMENSIONS

DRWG. BY: PAR DWG. BY: PAR
APP'D. BY: JWN SCALE: :

TITLE: SEE
PART NO.: 73099
FILE NAME: 324

X-ON Electronics

Largest Supplier of Electrical and Electronic Components

Click to view similar products for [Headers & Wire Housings](#) category:

Click to view products by [Molex](#) manufacturer:

Other Similar products are found below :

[892-18-020-10-001101](#) [58102-G61-06LF](#) [582553-1](#) [0009485154](#) [009176003701906](#) [0050291907](#) [LY20-4P-DT1-P1E-BR](#) [02.125.8002.8](#)
[609-3404](#) [61062-3](#) [622-0430](#) [622-3653LF](#) [63453-116](#) [636-1030](#) [636-1427](#) [636-3427](#) [636-4007](#) [641938-9](#) [641991-4](#) [644827-2](#) [65817-010LF](#)
[65817-015LF](#) [65863-015LF](#) [66207-023LF](#) [67095-007LF](#) [67601157](#) [68648-049](#) [70.362.1628.0](#) [70-4210](#) [70-4226B](#) [70-4853B](#) [707-5020](#) [707-5028](#) [71.350.2428.0](#) [71918-208LF](#) [71961-016LF](#) [733-134](#) [733-162](#) [754199-000](#) [760-3052](#) [787-8014-00](#) [79531-3000](#) [FCN-360C032-B](#) [FCN-367T-T012/H](#) [FCN-723D010/2](#) [80.063.4001.1](#) [800-90-001-10-001000](#) [800-90-010-10-002000](#) [801-43-002-10-013000](#) [801-43-006-10-002000](#)