

MATERIALS AND FINISHES

BODY ZINC ALLOY  
PLATED NICKEL

HOUSING POLYESTER BUTYLENE TEREPHTHALATE(WHITE)

CENTER CONTACT PHOSPHOR BRONZE  
PLATED GOLD

INSULATOR TEFLON

MOUNTING POST BRASS  
PLATED TIN

SOLDER TAIL BRASS WIRE  
PLATED TIN

WASHER PHOSPHOR BRONZE  
PLATED NICKEL

NUT BRASS  
PLATED NICKEL

MECHANICAL & ELECTRICAL CHARACTERISTICS:  
PER PRODUCT SPECIFICATION PS-73598-0060

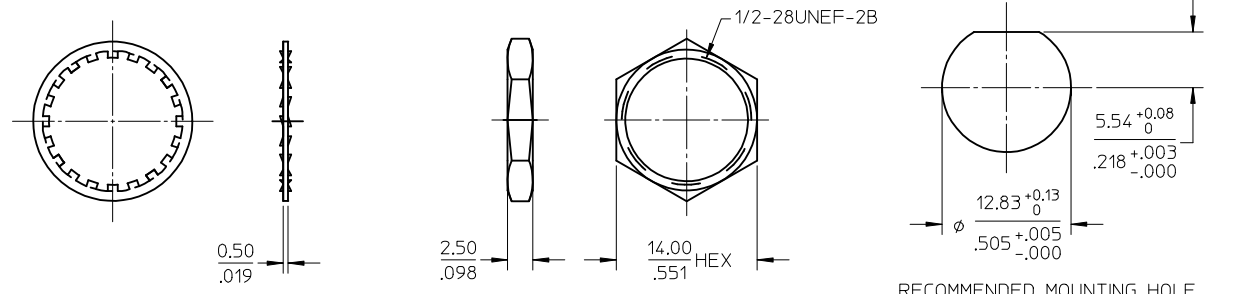
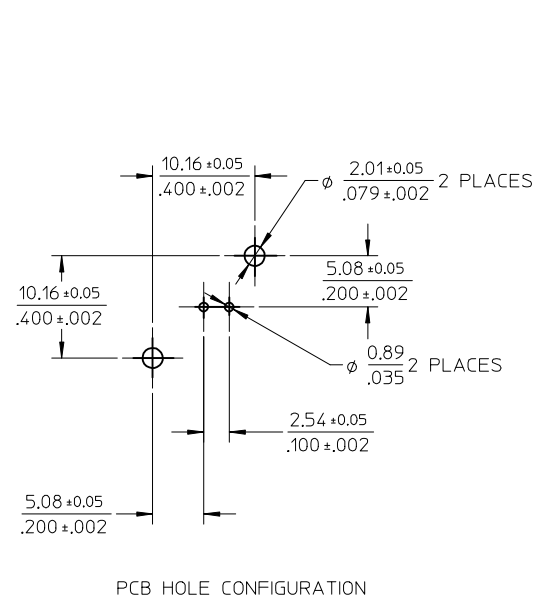
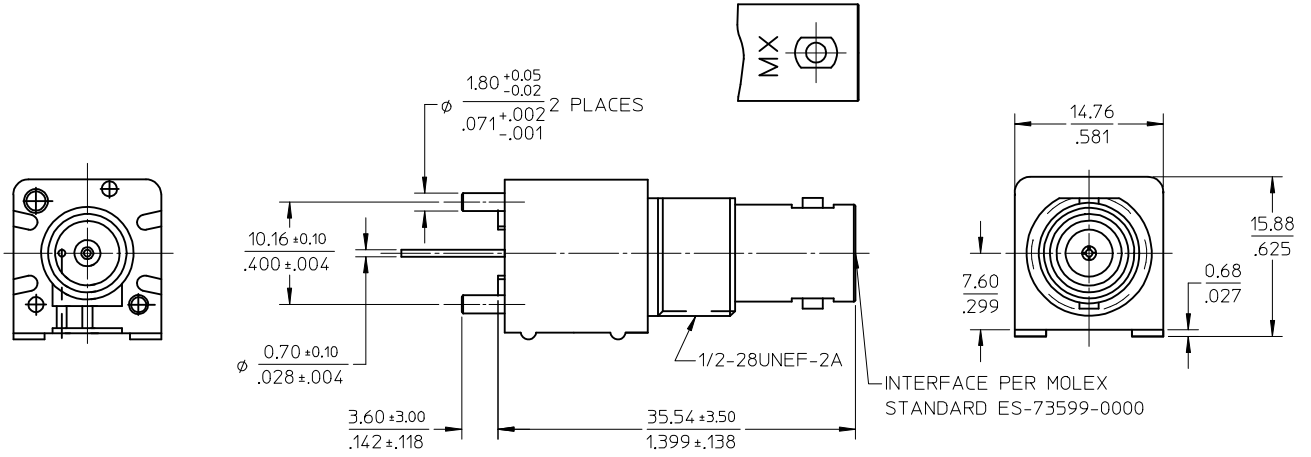

RECOMMENDED MOUNTING HOLE  
MAXIMUM PANEL THICKNESS:5.50MM  
RECOMMENDED MOUNTING TORQUE  
12 inch-pounds MAX.

<b>ENTER DESCRIPTION</b> EC NO: URF2005-0553 DRW:CLL1 CHKD: APPR:MHUANG 2005/06/28 2005/06/29 2005/06/29	<b>QUALITY SYMBOLS</b> ▽=0 ◻=0	<b>GENERAL TOLERANCES (UNLESS SPECIFIED)</b>		<b>DIMENSION STYLE</b> MM/IN		SCALE ---	DESIGN UNITS METRIC	THIRD ANGLE PROJECTION		
		4 PLACES	± ---	± ---	DRAWN BY	DATE	TITLE			
		3 PLACES	± ---	± ---	CHECKED BY	DATE	BNC 75 OHM VERTICAL PCB RECEPTACLE BNC-J/PCB			
		2 PLACES	± 0.13	± ---	APPROVED BY	DATE	MOLEX INCORPORATED			
1 PLACE	± 0.25	± ---	ANGULAR ± 2 °		MATERIAL NO.	DOCUMENT NO.	SHEET NO.			
DRAFT WHERE APPLICABLE MUST REMAIN WITHIN DIMENSIONS		73101-0680		SD-73101-068		1 OF 1				
THIS DRAWING CONTAINS INFORMATION THAT IS PROPRIETARY TO MOLEX INCORPORATED AND SHOULD NOT BE USED WITHOUT WRITTEN PERMISSION										

## X-ON Electronics

Largest Supplier of Electrical and Electronic Components

*Click to view similar products for [RF Connectors / Coaxial Connectors](#) category:*

*Click to view products by [Molex](#) manufacturer:*

Other Similar products are found below :

[R125315120](#) [8915-1511-000](#) [89674-0827](#) [5916-1103-603](#) [0106-001-000](#) [6-0001-3](#) [6001-7071-019](#) [6002-7051-003](#) [6002-7551-202](#) [6059674-1](#) [619550-1](#) [630059-000](#) [M39012/25-0021](#) [M39012/79-3008](#) [M39030/3-01N](#) [M39030/3-03N](#) [M3933/25-29N](#) [M3933/25-36N](#) [6500-7071-046](#) [6501-1071-002](#) [M83723/72W24576](#) [M83723/72W2457N](#) [6769](#) [CX050L2AQ](#) [7002-1541-010](#) [7002-1572-002](#) [7003-1572-002](#) [7004-1512-000](#) [7009-1511-004](#) [7010-1511-000](#) [7029-1511-060](#) [7101-1541-010](#) [7101-1571-002](#) [7105-1521-002](#) [7145-1521-002](#) [7209-1511-011](#) [7210-1511-012](#) [7210-1511-015](#) [7210-1511-019](#) [7210-1511-040](#) [7225-1512-050](#) [7242-1511-000](#) [73137-5015](#) [73251-0111](#) [73251-0672](#) [73276-1501](#) [73366-0013](#) [73404-2300](#) [73413-6080](#) [734151610](#)