

10 9 8 7 6 5 4 3 2 1

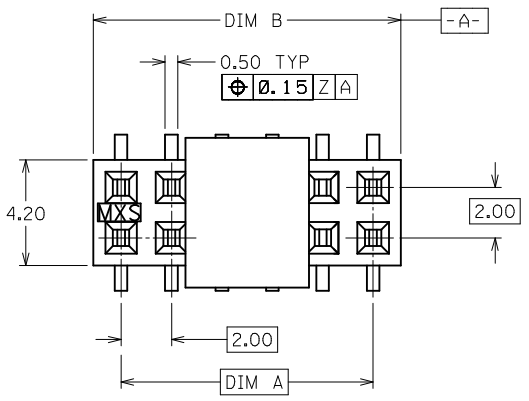

PART NO. LEGEND
 87381 - * * * *
 CIRCUIT SIZE
 PLATING
 3
 4 (SEE NOTE 1)
 8 COVER
 9 NO COVER

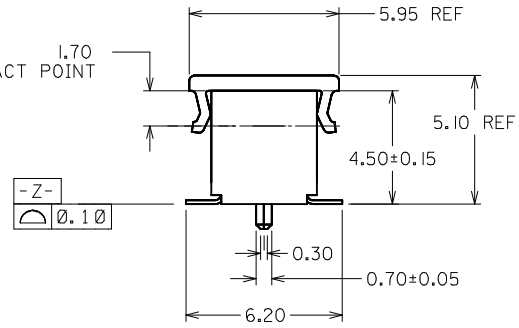
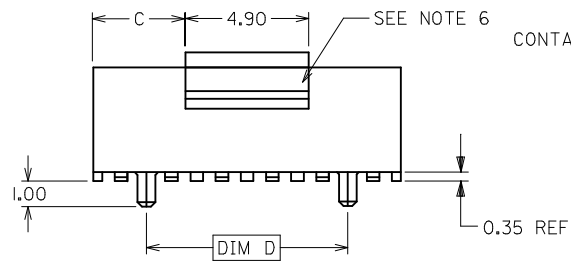

| PART NUMBER (W/ CAP IN TUBE) | CKT. SIZE | DIM A | DIM B | DIM C | DIM D |
|------------------------------|-----------|-------|-------|-------|-------|
| 87381-08** | 8 | 6.00 | 8.00 | 1.55 | 4.00 |
| 87381-10** | 10 | 8.00 | 10.00 | 2.55 | 6.00 |
| 87381-12** | 12 | 10.00 | 12.00 | 3.55 | 8.00 |
| 87381-14** | 14 | 12.00 | 14.00 | 4.55 | 10.00 |
| 87381-16** | 16 | 14.00 | 16.00 | 5.55 | 12.00 |
| 87381-18** | 18 | 16.00 | 18.00 | 6.55 | 14.00 |
| 87381-20** | 20 | 18.00 | 20.00 | 7.55 | 16.00 |
| 87381-22** | 22 | 20.00 | 22.00 | 8.55 | 18.00 |
| 87381-24** | 24 | 22.00 | 24.00 | 9.55 | 20.00 |
| 87381-26** | 26 | 24.00 | 26.00 | 10.55 | 22.00 |
| 87381-28** | 28 | 26.00 | 28.00 | 11.55 | 24.00 |
| 87381-30** | 30 | 28.00 | 30.00 | 12.55 | 26.00 |
| 87381-32** | 32 | 30.00 | 32.00 | 13.55 | 28.00 |
| 87381-34** | 34 | 32.00 | 34.00 | 14.55 | 30.00 |
| 87381-36** | 36 | 34.00 | 36.00 | 15.55 | 32.00 |
| 87381-38** | 38 | 36.00 | 38.00 | 16.55 | 34.00 |
| 87381-40** | 40 | 38.00 | 40.00 | 17.55 | 36.00 |
| 87381-42** | 42 | 40.00 | 42.00 | 18.55 | 38.00 |
| 87381-44** | 44 | 42.00 | 44.00 | 19.55 | 40.00 |
| 87381-46** | 46 | 44.00 | 46.00 | 20.55 | 42.00 |
| 87381-48** | 48 | 46.00 | 48.00 | 21.55 | 44.00 |
| 87381-50** | 50 | 48.00 | 50.00 | 22.55 | 46.00 |

- NOTES:
- PLATING FINISH :
 3 - 0.76um MIN. GOLD IN CONTACT AREA, 1.27um MIN. TIN
 IN SOLDER TAIL AREA BOTH OVER 1.27um MIN NBICKEL OVEALL
 4 - 0.38um MIN. GOLD IN CONTACT AREA 1.27um MIN. TIN
 IN SOLDER TAIL AREA BOTH OVER 1.27um MIN NBICKEL OVEALL
 - 12 CKT SIZE SHOWN FOR ILLUSTRATION ONLY. SEE CHART FOR ALL AVAILABLE PART SIZES
 - PRODUCT SPECIFICATION PS-87380 APPLIES
 - COPLANARITY OF SOLDER TAILS ARE TO BE MEASURED BY RESTING THE PART ON A FLAT GAUGE SURFACE
 - TUBE PACKAGING STANDARD
 - COVER IS OPTIONAL, SEE LEGEND.
 - PARTS SHALL BE PACKED IN MOISTURE BARRIER BAG.

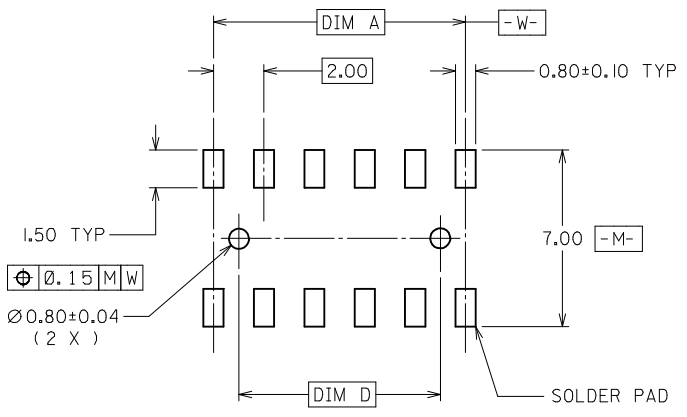

RECOMMENDED PCB LAYOUT

| | | | | | | |
|--|-----------------|--|-----------------|---|---------------------------------------|------------------------|
| ADD NOTE 7. EC NO: S2015-0813 DRW:ATSEE CHKD:CGOH APPR:KHLIM 2015/01/16 2015/01/22 2015/01/22 | QUALITY SYMBOLS | GENERAL TOLERANCES (UNLESS SPECIFIED) | DIMENSION STYLE | SCALE | DESIGN UNITS | THIRD ANGLE PROJECTION |
| | ▽=0 ∇=0 | mm INCH 4 PLACES ± --- ± --- 3 PLACES ± --- ± --- 2 PLACES ± 0.20 ± --- 1 PLACE ± --- ± --- ANGULAR ± 3 ° | MM ONLY | NTS | METRIC | |
| | | | DRAWN BY | DATE | TITLE | |
| | | | RSHAN | 1998/03/10 | MGRID 2MM RECEPTACLE 4.50MM HT. | |
| | | CHECKED BY | DATE | | | |
| | | SQUEK | 1998/03/28 | | | |
| | | APPROVED BY | DATE | | | |
| | | KHLIM | 2015/01/22 | | | |
| | | MATERIAL NO. | | DOCUMENT NO. | | |
| | | SEE TABLE | | SD-87381-**8* | | |
| | | DRAFT WHERE APPLICABLE MUST REMAIN WITHIN DIMENSIONS | SIZE | THIS DRAWING CONTAINS INFORMATION THAT IS PROPRIETARY TO MOLEX INCORPORATED AND SHOULD NOT BE USED WITHOUT WRITTEN PERMISSION | | |
| | | | A3 | | | |

9 8 7 6 5 4 3 2 1

F

E

D

C

B

A

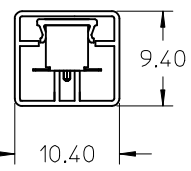
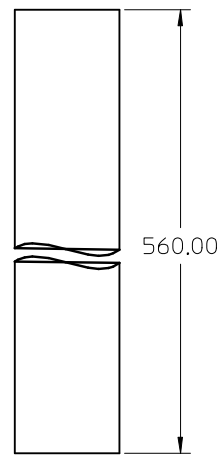

TUBE PACKAGING ORIENTATION
(SEE SHT 1 FOR PART NUMBER)

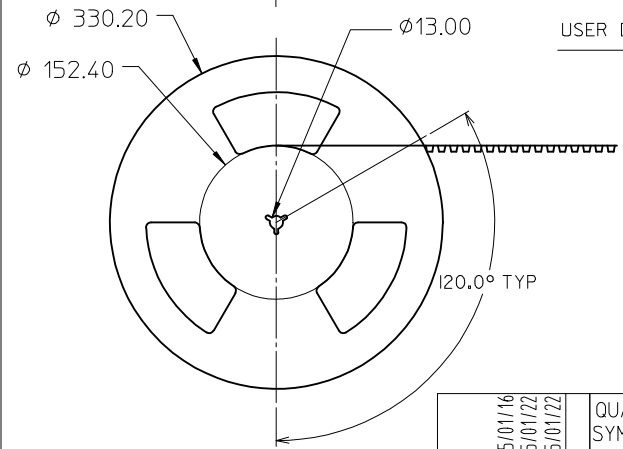
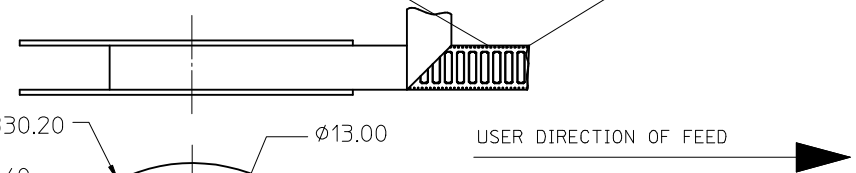
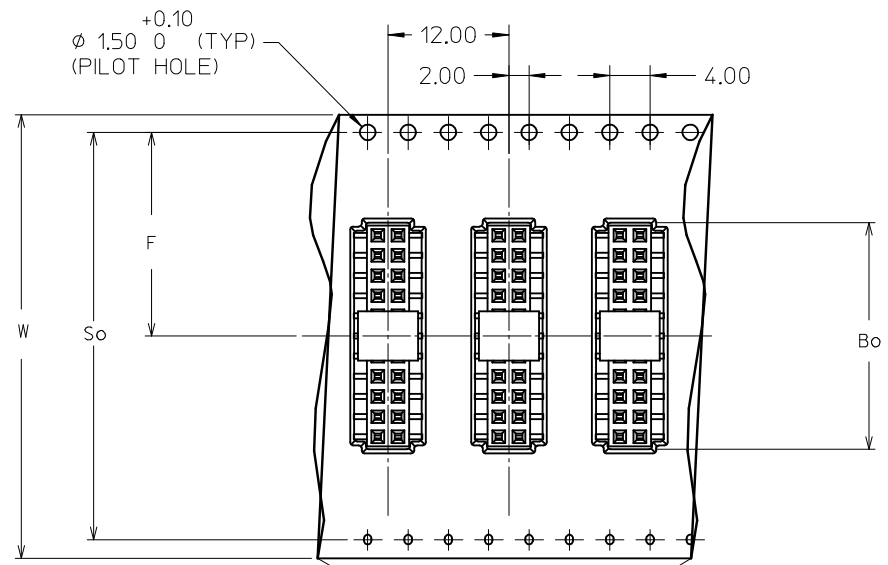

TAPE AND REEL ORIENTATION

NOTES:

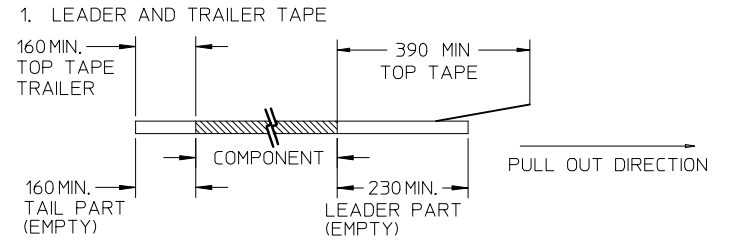

2. PEELING OFF FORCE OF THE TOP TAPE: 20-80gf.
(PEELING DIRECTION AS SHOWN IN FOLLOWING FIGURE)

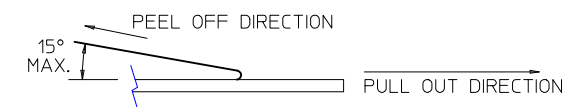

- 3. PACKAGING STANDARD IS AS PER EIA-481.
- 4. TAPE & REEL QUANTITY = 800 PCS/REEL

| | | | | | | | | | | | |
|--|-------------------------------|--|----------------------|-----------------------------------|---------------------|----------------------|------------------------|--|--------------------------------|---------------------|--|
| ADD NOTE 7. EC NO: S2015-0813 DRW:ATSEE 2015/01/16 CHKD:CGOH 2015/01/22 APPR:KHLIM 2015/01/22 | QUALITY SYMBOLS ▽=0 ◻=0 | GENERAL TOLERANCES (UNLESS SPECIFIED) | | DIMENSION STYLE MM ONLY | | SCALE NTS | DESIGN UNITS METRIC | THIRD ANGLE PROJECTION | | | |
| | | 4 PLACES ± --- ± --- | 3 PLACES ± --- ± --- | 2 PLACES ± 0.20 ± --- | 1 PLACE ± --- ± --- | DRAWN BY RSHAN | DATE 1998/03/10 | TITLE MGRID 2MM RECEPTACLE 4.50MM HT. | | | |
| | | ANGULAR ± 3 ° | | | | CHECKED BY SQUEK | DATE 1998/03/28 | MOLEX INCORPORATED | | | |
| | | DRAFT WHERE APPLICABLE MUST REMAIN WITHIN DIMENSIONS | | | | APPROVED BY KHLIM | DATE 2015/01/22 | MATERIAL NO. SEE TABLE | DOCUMENT NO. SD-87381-***8* | SHEET NO. 2 OF 3 | |

10 | 9 | 8 | 7 | 6 | 5 | 4 | 3 | 2 | 1

| PART NUMBER (W/CAP IN TUBE) | MOISTURE BARRIER BAG P/N FOR TUBE | PART NUMBER (W/ CAP IN T&R) | MOISTURE BARRIER BAG P/N FOR T&R | CKT. SIZE | W | So | F | Bo |
|--------------------------------|--------------------------------------|--------------------------------|-------------------------------------|--------------|-------|-------|-------|-------|
| 87381-2284 | 89990-0201 | 87381-8252 | 89990-0200 | 22 | 44.00 | 40.40 | 20.20 | 22.50 |
| 87381-3084 | | 87381-8231 | | 30 | 56.00 | 52.40 | 26.20 | 30.50 |

| | | | | | | | | | | |
|---|-------------------------------|--|----------------------------------|--|------------|--------------|--|---------------------------|--|--|
| ADD NOTE 7. EC NO: S2015-0813 DRWN:ATSEE 2015/01/16 CHKD:CGOH 2015/01/22 APPR:KHLIM 2015/01/22 | QUALITY SYMBOLS = 0 = 0 | GENERAL TOLERANCES (UNLESS SPECIFIED) | | DIMENSION STYLE MM ONLY | | SCALE NTS | DESIGN UNITS METRIC | THIRD ANGLE PROJECTION | | |
| | | | mm | INCH | DRAWN BY | DATE | MGRID 2MM RECEPTACLE 4.50MM HT. MOLEX INCORPORATED DOCUMENT NO. SD-87381-***8* SHEET NO. 3 OF 3 | | | |
| | | 4 PLACES | ± --- | ± --- | RSHAN | 1998/03/10 | | | | |
| | | 3 PLACES | ± --- | ± --- | CHECKED BY | DATE | | | | |
| | | 2 PLACES | ± 0.20 | ± --- | SQUEK | 1998/03/28 | | | | |
| 1 PLACE | ± --- | ± --- | APPROVED BY | DATE | | | | | | |
| | ANGULAR ± 3 ° | | KHLIM | 2015/01/22 | | | | | | |
| DRAFT WHERE APPLICABLE MUST REMAIN WITHIN DIMENSIONS | | | MATERIAL NO. SEE TABLE | | | | | | | |
| | | | SIZE A3 | THIS DRAWING CONTAINS INFORMATION THAT IS PROPRIETARY TO MOLEX INCORPORATED AND SHOULD NOT BE USED WITHOUT WRITTEN PERMISSION | | | | | | |

9 | 8 | 7 | 6 | 5 | 4 | 3 | 2 | 1

X-ON Electronics

Largest Supplier of Electrical and Electronic Components

Click to view similar products for [Headers & Wire Housings](#) category:

Click to view products by [Molex](#) manufacturer:

Other Similar products are found below :

[892-18-020-10-001101](#) [58102-G61-06LF](#) [582553-1](#) [0009485154](#) [009176003701906](#) [0050291907](#) [LY20-4P-DT1-P1E-BR](#) [02.125.8002.8](#)
[609-3404](#) [61062-3](#) [61082-181009](#) [622-3653LF](#) [63453-116](#) [636-1030](#) [636-1427](#) [636-3427](#) [636-4007](#) [641938-9](#) [641991-4](#) [644827-2](#) [65817-](#)
[010LF](#) [65817-015LF](#) [65863-015LF](#) [66207-023LF](#) [67095-007LF](#) [67601157](#) [68648-049](#) [70.362.1628.0](#) [70-4210](#) [70-4226B](#) [70-4853B](#) [707-](#)
[5020](#) [707-5028](#) [71.350.2428.0](#) [71918-208LF](#) [71961-016LF](#) [733-134](#) [733-162](#) [754199-000](#) [760-3052](#) [787-8014-00](#) [79531-3000](#) [FCN-](#)
[360C032-B](#) [FCN-367T-T012/H](#) [FCN-723D010/2](#) [80.063.4001.1](#) [800-90-001-10-001000](#) [800-90-010-10-002000](#) [801-43-002-10-013000](#)
[801-43-006-10-002000](#)