

PLEASE CHECK WWW.MOLEX.COM FOR LATEST PART INFORMATION

Part Number: [0987861019](#)
Status: **Active**
Overview: MOX Products
Description: 2.54mm Pitch MOX Receptacle Housing, 6 Circuits, Dual Row, Brown

Documents:

[Drawing \(PDF\)](#) [Packaging Specification PK-98786-001-001 \(PDF\)](#)
[Application Specification AS-98787-001-001 \(PDF\)](#) [RoHS Certificate of Compliance \(PDF\)](#)

Application tooling part link

Application Tooling Part Link 63813-8500

General

Product Family Crimp Housings
Series [98786](#)
Application Power, Wire-to-Board, Wire-to-Wire
Comments 2x3 Circuits, Contact Retention Force without secondary locking: 40N, with secondary locking: 60N
Overview [MOX Products](#)
Product Name MOX
UPC 822348761326

Physical

Circuits (maximum) 6
Color - Resin Brown
Gender Receptacle
Glow-Wire Capable No
Keying to Mating Part None
Lock to Mating Part Yes
Material - Resin Nylon
Net Weight 1.060/g
Number of Rows 2
Packaging Type Bag
Panel Mount No
Pitch - Mating Interface 2.54mm
Pitch - Termination Interface 2.54mm
Polarized to Mating Part Yes
Stackable No
Temperature Range - Operating -40° to +100°C

Electrical

Current - Maximum per Contact 7.5A

Solder Process Data

Lead-freeProcess Capability N/A

Material Info

Engineering Number 499212211

Reference - Drawing Numbers

Application Specification AS-98787-001-001
Packaging Specification PK-98786-001-001
Sales Drawing SD-98786-001-001

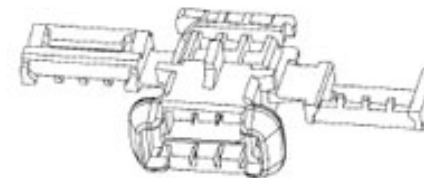

Series image - Reference only

EU ELV

Compliant

EU RoHS

Compliant

REACH SVHC

Not Contained Per -
D(2021)4569-DC (8
July 2021)

Halogen-Free

Status

Not Relevant

For more information, please visit [Contact US](#)

China ROHS

Not Relevant

ELV

Compliant

RoHS Phthalates

Not Contained

Search Parts in this Series

[98786](#) Series

Mates With

[98780](#) Male Header, [98787](#) MOX Plug Housing

Use With

[98658](#) MOX Crimp Terminal

Application Tooling | [FAQ](#)

Tooling specifications and manuals are found by selecting the products below. Crimp Height Specifications are then contained in the Application Tooling Specification document.

Global

Description	Product #
Extractor Tool for MOX 0.635mm Receptacle Crimp Terminals	638138500

This document was generated on 09/23/2021

PLEASE CHECK WWW.MOLEX.COM FOR LATEST PART INFORMATION

X-ON Electronics

Largest Supplier of Electrical and Electronic Components

Click to view similar products for [Automotive Connectors](#) category:

Click to view products by [Molex](#) manufacturer:

Other Similar products are found below :

[003-018-000](#) [60403001](#) [60993906-B](#) [M902-2131](#) [M902-2161](#) [72.330.1035.1](#) [73.353.4028.0](#) [F119300-B](#) [F166900](#) [F258300-B](#) [F358300-B](#)
[F407400](#) [F444110](#) [F487000](#) [F509500B-B](#) [827153-1](#) [8N1515-32-24P](#) [9-1326729-8](#) [925474-1](#) [928905-1](#) [964562-4](#) [968782-1](#) [GT17SA-8DS-](#)
[HU](#) [98891-1012](#) [98947-1016](#) [12004147](#) [12004475-L](#) [12010290](#) [12010309-B](#) [12015454](#) [12020219-B](#) [12020308](#) [12041318-B](#) [12052225-L](#)
[12052466](#) [12059125](#) [12064869](#) [12004327-B](#) [12010503-B](#) [12015308](#) [12015384](#) [12015909](#) [1-21030-1](#) [12041254](#) [12041318](#) [12047946-B](#)
[12047957](#) [12047957-L](#) [12059473](#) [12066261](#)