

D-Sub Accessories

Single Piece Spring Latch & Lock

for Panel Mount Applications

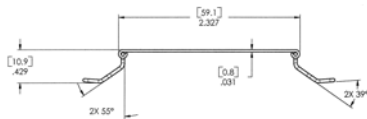

Lock Plate

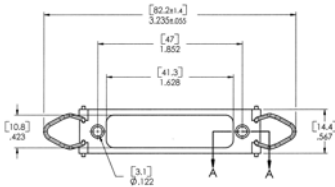

Size 3 Example

Shell Size	Spring Latch	Lock Plate
1	A1277-1000	F65M032E000+S
2	A1277-2000	F65M032E000+S
3	A1277-3000	F65M032E000+S
4	A1277-4000	F65M032E000+S
5	A1277-5000	F65M130E000+S

FCT Electronics has expanded its D-Sub Accessory product offering with the introduction of new Single Piece Spring Latches. These can be front panel mounted allowing D-Sub Connectors to be rear mounted.

No sex distinction or specific orientation is required as the cut out is of sufficient size and fully symmetrical so reducing the possibility of installation errors. Mating orientation is accomplished by the D-Sub's own trapezoid features.

The parts thumb spring also possesses an angled feature to facilitate reduced opportunity for mating interference when closed. FCT's product is fully RoHS Compliant. All materials are Steel and the standard finish is Passivated.

FCT Electronics, is a leading manufacturer of D-Sub Connectors and Accessories for Major Communications Infrastructure and Industrial applications.

Most recently, FCT's high quality products and extensive development capability have brought the company in to the Aerospace market and this product introduction is just one of the companies initiatives to support the specific needs of customer applications.



X-ON Electronics

Largest Supplier of Electrical and Electronic Components

Click to view similar products for [D-Sub Tools & Hardware](#) category:

Click to view products by [Molex](#) manufacturer:

Other Similar products are found below :

[000-01-09-132](#) [000-01-21-132](#) [000-01-31-162](#) [572019-00105-70](#) [000-01-37-162](#) [621-250-113-115](#) [D110550-2](#) [D20418-137](#) [780-518-50SG6-WS](#) [86552009](#) [86553115TLF](#) [86553117TLF](#) [1230032-1](#) [1-5021101-2](#) [15-000050](#) [1589283-4](#) [160-000-005R031](#) [16-000230](#) [160-025-004R031](#) [160-020-209R000](#) [160X10909X](#) [164C03939A](#) [177-505-A-2-2](#) [1-966830-8](#) [21018-6](#) [2-1393560-9](#) [JS-1000](#) [L17D204182M3E](#) [L17D53018](#) [300X10779X](#) [160X10189X](#) [160X10419X](#) [162-000-050R000](#) [21018-5](#) [212561-3](#) [248C21550X](#) [CF15P](#) [QLOCKPOST-2](#) [D110277](#) [500-008NF1K-01](#) [500-008NF3R3KS-01](#) [500-017M09FN](#) [500-017M15MHN](#) [500-024M1](#) [500-068M3](#) [5-1393561-5](#) [C115373-0001](#) [C115373-0002](#) [3342-4-KIT](#) [K1003](#)