

ALL RIGHTS RESERVED. NO PORTION OF THIS PUBLICATION, WHETHER IN WHOLE OR IN PART CAN BE REPRODUCED WITHOUT THE EXPRESS WRITTEN CONSENT OF SPC TECHNOLOGY.

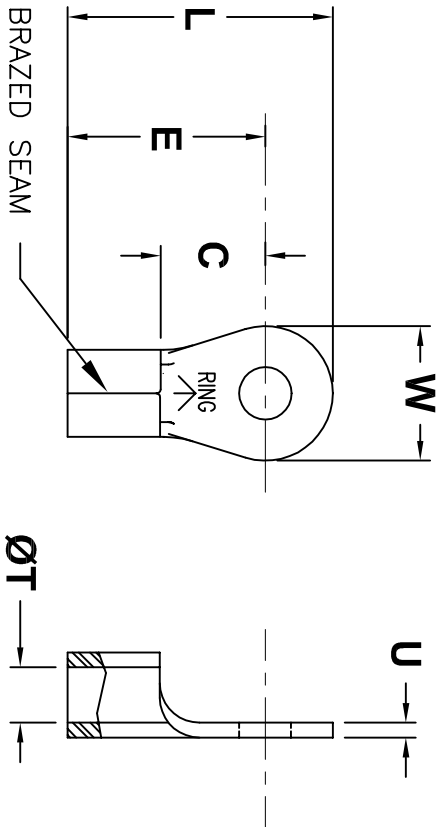

| SPC Type No. | Wire Size (AWG) | Stud Size | L | W | E | C | T | U | Pkg QTY |
|--------------|-----------------|--------------|------|-----|------|-----|------|------|---------|
| CRS-ZO-0425 | 4 | 1/4" (.250) | 1.34 | .68 | 1.00 | .53 | | | 10 |
| SPC3753 | 4 | 1/4" (.250) | 1.34 | .68 | 1.00 | .53 | | | 100 |
| CRS-ZO-0437 | 4 | 3/8" (.375) | 1.34 | .68 | 1.00 | .53 | .280 | .075 | 10 |
| SPC3754 | 4 | 3/8" (.375) | 1.34 | .68 | 1.00 | .53 | | | 100 |
| CRS-ZO-0610 | 6 | #10 (.196) | 1.14 | .47 | .91 | .52 | | | 20 |
| SPC3750 | 6 | #10 (.196) | 1.14 | .47 | .91 | .52 | | | 200 |
| CRS-ZO-0625 | 6 | 1/4" (.250) | 1.14 | .47 | .91 | .52 | .250 | | 20 |
| SPC3751 | 6 | 1/4" (.250) | 1.14 | .47 | .91 | .52 | | | 200 |
| CRS-ZO-0631 | 6 | 5/16" (.312) | 1.22 | .63 | .91 | .52 | | | 20 |
| SPC3752 | 6 | 5/16" (.312) | 1.22 | .63 | .91 | .52 | | | 200 |
| CRS-ZO-0810 | 8 | #10 (.196) | .95 | .47 | .72 | .40 | | | 25 |
| SPC3746 | 8 | #10 (.196) | .95 | .47 | .72 | .40 | .050 | | 250 |
| CRS-ZO-0825 | 8 | 1/4" (.250) | .95 | .47 | .72 | .40 | | | 25 |
| SPC3747 | 8 | 1/4" (.250) | .95 | .47 | .72 | .40 | | | 250 |
| CRS-ZO-0831 | 8 | 5/16" (.312) | 1.06 | .59 | .77 | .45 | .175 | | 25 |
| SPC3748 | 8 | 5/16" (.312) | 1.06 | .59 | .77 | .45 | | | 250 |
| CRS-ZO-0837 | 8 | 3/8" (.375) | 1.06 | .59 | .77 | .45 | | | 25 |
| SPC3749 | 8 | 3/8" (.375) | 1.06 | .59 | .77 | .45 | | | 250 |

| REVISONS | | DOC. NO. SPC-F005 | Effective: 12/21/98 | DCP No. 680 | | | | |
|----------|-----|---------------------------------|---------------------|-------------|--------|--------|-------|--------|
| DCP # | REV | DESCRIPTION | DRAWN | DATE | CHECKD | DATE | APPRD | DATE |
| 217 | B | Removed Discontinued Part | DJC | 6/26/97 | JC | 7/3/97 | JC | 7/3/97 |
| 1116 | C | Add Bulk Items; was CRS-ZO-**** | JWM | 3/6/01 | JC | 3/6/01 | JC | 3/6/01 |

- NOTES:
MATERIAL:
1. ELECTRO-TIN PLATED COPPER
2. TO BE FREE OF BURRS.
3. CAN BE CRIMPED ANYWHERE ON BARREL SURFACE.
4. VOLTAGE RATING AND TEMPERATURE RANGE:
600 V AND 347°F (175°C)
5. USE CRIMPING TOOL GROUP A: 8403-001

| SPC Type No. | Wire Size (AWG) | Stud Size | L | W | E | C | T | U | Pkg QTY |
|--------------|-----------------|-------------|-----|-----|-----|-----|------|------|---------|
| CRS-ZO-1008 | 12 ~ 10 | #8 (.174) | .68 | .28 | .54 | .29 | | | 50 |
| SPC3743 | 12 ~ 10 | #8 (.174) | .68 | .28 | .54 | .29 | | | 500 |
| CRS-ZO-1010 | 12 ~ 10 | #10 (.196) | .73 | .38 | .54 | .29 | .135 | .040 | 50 |
| SPC3744 | 12 ~ 10 | #10 (.196) | .73 | .38 | .54 | .29 | | | 500 |
| CRS-ZO-1025 | 12 ~ 10 | 1/4" (.250) | .96 | .54 | .69 | .44 | | | 50 |
| SPC3745 | 12 ~ 10 | 1/4" (.250) | .96 | .54 | .69 | .44 | | | 500 |
| CRS-ZO-1406 | 16 ~ 14 | #6 (.143) | .60 | .25 | .47 | .22 | | | 100 |
| SPC3739 | 16 ~ 14 | #6 (.143) | .60 | .25 | .47 | .22 | | | 1000 |
| CRS-ZO-1408 | 16 ~ 14 | #8 (.174) | .74 | .31 | .58 | .33 | | | 100 |
| SPC3740 | 16 ~ 14 | #8 (.174) | .74 | .31 | .58 | .33 | .090 | | 1000 |
| CRS-ZO-1410 | 16 ~ 14 | #10 (.196) | .74 | .31 | .58 | .33 | | | 100 |
| SPC3741 | 16 ~ 14 | #10 (.196) | .74 | .31 | .58 | .33 | | | 1000 |
| CRS-ZO-1425 | 16 ~ 14 | 1/4" (.250) | .89 | .47 | .65 | .40 | .030 | | 100 |
| SPC3742 | 16 ~ 14 | 1/4" (.250) | .89 | .47 | .65 | .40 | | | 1000 |
| CRS-ZO-1806 | 22 ~ 18 | #6 (.143) | .60 | .25 | .47 | .22 | | | 100 |
| SPC3737 | 22 ~ 18 | #6 (.143) | .60 | .25 | .47 | .22 | .070 | | 1000 |
| CRS-ZO-1808 | 22 ~ 18 | #8 (.174) | .74 | .31 | .58 | .33 | | | 100 |
| SPC3738 | 22 ~ 18 | #8 (.174) | .74 | .31 | .58 | .33 | | | 1000 |



LISTED
E58918



OSHA
Acceptible

LR22190M6

SPC-F005.DWG

DISCLAIMER:
ALL STATEMENTS AND TECHNICAL INFORMATION CONTAINED HEREIN ARE BASED UPON INFORMATION AND/OR TESTS WE BELIEVE TO BE ACCURATE AND RELIABLE. SINCE CONDITIONS OF USE ARE, BY THEIR NATURE, UNPREDICTABLE, THE USER SHALL BE RESPONSIBLE FOR THE PROPER SELECTION OF THE PRODUCT AND FOR THE PROPER USE AND ASSUME ALL RISK AND LIABILITY WHATSOEVER IN CONNECTION THEREWITH.



SPC TECHNOLOGY

UNLESS OTHERWISE SPECIFIED, DIMENSIONS ARE FOR REFERENCE PURPOSES ONLY.

DRAWN BY: JC

CHECKED BY: JC

APPROVED BY: JL

DATE: 2/6/91

DATE: 11/21/91

DATE: 11/21/91

DRAWING TITLE: Uninsulated Ring Terminals

SIZE: A

DWG. NO.: TA-295

ELECTRONIC FILE: TA-295.dwg

SCALE: NTS

U.O.M.: INCHES [mm]

SHEET: 1 OF 1

X-ON Electronics

Largest Supplier of Electrical and Electronic Components

Click to view similar products for [Multicomp](#) manufacturer:

Other Similar products are found below :

[MCWW25XR220FTL](#) [SPC19952](#) [CR-MS-4](#) [MC23303](#) [1710467](#) [LB324P](#) [SPC19794-RH](#) [MCRF0008](#) [RBH3-16RBVB](#) [MC001599](#)
[OEM203N-240A](#) [MC19678](#) [SPC15268](#) [SPC20045](#) [SPC20494](#) [154-0140](#) [MCPIN-T30L-001](#) [MCPIP-T30L-001](#) [105-0020](#) [MCPIP-T5S-001](#)
[MC001616](#) [082-0323F](#) [MC011473](#) [MC002698](#) [MCFRBTN2400](#) [MCFRBTN2401](#) [RA01A12BSFMSOX](#) [MCVT600](#) [146-0043](#) [082-0043](#)
[LBDI633P](#) [12.99.1150](#) [MC000894](#) [MC21063](#) [MC14665](#) [146-0023](#) [187-0017](#) [MC23725](#) [082-0028F3](#) [082-0002F4](#) [NSYPPA4G](#) [SPC24553](#)
[SPC21178](#) [MC001625](#) [082-0322F](#) [MC011465](#) [MCWF08R2940BTL](#) [15T7C-130V](#) [MC0063W06031215R](#) [069-0002](#)