



## Reference Specification

Leaded MLCC for Automotive with AEC-Q200  
RCE Series

Product specifications in this catalog are as of Mar. 2018, and are subject to change or obsolescence without notice.

Please consult the approval sheet before ordering. Please read rating and Cautions first.

## Reference only

### ⚠ CAUTION

#### 1. OPERATING VOLTAGE

When DC-rated capacitors are to be used in AC or ripple current circuits, be sure to maintain the  $V_{p-p}$  value of the applied voltage or the  $V_{o-p}$  which contains DC bias within the rated voltage range. When the voltage is started to apply to the circuit or it is stopped applying, the irregular voltage may be generated for a transit period because of resonance or switching. Be sure to use a capacitor within rated voltage containing these irregular voltage.

When DC-rated capacitors are to be used in input circuits from commercial power source (AC filter), be sure to use Safety Recognized Capacitors because various regulations on withstand voltage or impulse withstand established for each equipment should be taken into considerations.

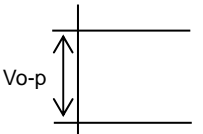
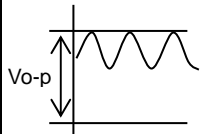
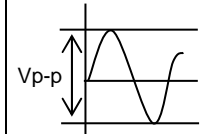
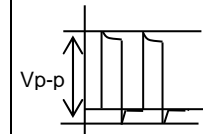
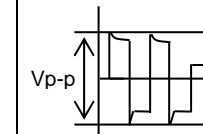
| Voltage                | DC Voltage  | DC+AC Voltage   | AC Voltage   | Pulse Voltage(1)  | Pulse Voltage(2)  |
|------------------------|---|---|--|---|---|
| Positional Measurement |  |  |  |  |  |

#### 2. OPERATING TEMPERATURE AND SELF-GENERATED HEAT

Keep the surface temperature of a capacitor below the upper limit of its rated operating temperature range. Be sure to take into account the heat generated by the capacitor itself.

When the capacitor is used in a high-frequency current, pulse current or the like, it may have the self-generated heat due to dielectric-loss. In case of Class 2 capacitors (Temp.Char. : X7R,X7S,X8L, etc.), applied voltage should be the load such as self-generated heat is within 20 °C on the condition of atmosphere temperature 25 °C. Please contact us if self-generated heat is occurred with Class 1 capacitors (Temp.Char. : C0G,U2J,X8G, etc.). When measuring, use a thermocouple of small thermal capacity-K of  $\phi 0.1$ mm and be in the condition where capacitor is not affected by radiant heat of other components and wind of surroundings. Excessive heat may lead to deterioration of the capacitor's characteristics and reliability.

#### 3. Fail-safe

Be sure to provide an appropriate fail-safe function on your product to prevent a second damage that may be caused by the abnormal function or the failure of our product.

#### 4. OPERATING AND STORAGE ENVIRONMENT

The insulating coating of capacitors does not form a perfect seal; therefore, do not use or store capacitors in a corrosive atmosphere, especially where chloride gas, sulfide gas, acid, alkali, salt or the like are present. And avoid exposure to moisture. Before cleaning, bonding, or molding this product, verify that these processes do not affect product quality by testing the performance of a cleaned, bonded or molded product in the intended equipment. Store the capacitors where the temperature and relative humidity do not exceed 5 to 40 °C and 20 to 70%. Use capacitors within 6 months.

#### 5. VIBRATION AND IMPACT

Do not expose a capacitor or its leads to excessive shock or vibration during use.

#### 6. SOLDERING

When soldering this product to a PCB/PWB, do not exceed the solder heat resistance specification of the capacitor. Subjecting this product to excessive heating could melt the internal junction solder and may result in thermal shocks that can crack the ceramic element.

#### 7. BONDING AND RESIN MOLDING, RESIN COAT

In case of bonding, molding or coating this product, verify that these processes do not affect the quality of capacitor by testing the performance of a bonded or molded product in the intended equipment.

In case of the amount of applications, dryness / hardening conditions of adhesives and molding resins containing organic solvents (ethyl acetate, methyl ethyl ketone, toluene, etc.) are unsuitable, the outer coating resin of a capacitor is damaged by the organic solvents and it may result, worst case, in a short circuit.

The variation in thickness of adhesive or molding resin may cause a outer coating resin cracking and/or ceramic element cracking of a capacitor in a temperature cycling.

#### 8. TREATMENT AFTER BONDING AND RESIN MOLDING, RESIN COAT

When the outer coating is hot (over 100 °C) after soldering, it becomes soft and fragile.

So please be careful not to give it mechanical stress.

## Reference only

Failure to follow the above cautions may result, worst case, in a short circuit and cause fuming or partial dispersion when the product is used.

### 9. LIMITATION OF APPLICATIONS

Please contact us before using our products for the applications listed below which require especially high reliability for the prevention of defects which might directly cause damage to the third party's life, body or property.

- |  |   |
|--|---|
| 1. Aircraft equipment  | 2. Aerospace equipment                                      |
| 3. Undersea equipment  | 4. Power plant control equipment                            |
| 5. Medical equipment   | 6. Transportation equipment (vehicles, trains, ships, etc.) |
| 7. Traffic signal equipment  | 8. Disaster prevention / crime prevention equipment         |
| 9. Data-processing equipment exerting influence on public  |   |
| 10. Application of similar complexity and/or reliability requirements to the applications listed in the above. |   |

### NOTICE

#### 1. CLEANING (ULTRASONIC CLEANING)

To perform ultrasonic cleaning, observe the following conditions.

Rinse bath capacity : Output of 20 watts per liter or less.

Rinsing time : 5 min maximum.

Do not vibrate the PCB/PWB directly.

Excessive ultrasonic cleaning may lead to fatigue destruction of the lead wires.

#### 2. Soldering and Mounting

Insertion of the Lead Wire

- When soldering, insert the lead wire into the PCB without mechanically stressing the lead wire.
- Insert the lead wire into the PCB with a distance appropriate to the lead space.

#### 3. CAPACITANCE CHANGE OF CAPACITORS

- Class 2 capacitors (Temp.Char. : X7R,X7S,X8L, etc.)

Class 2 capacitors an aging characteristic, whereby the capacitor continually decreases its capacitance slightly if the capacitor leaves for a long time. Moreover, capacitance might change greatly depending on a surrounding temperature or an applied voltage. So, it is not likely to be able to use for the time constant circuit.

Please contact us if you need a detail information.



### NOTE

1. Please make sure that your product has been evaluated in view of your specifications with our product being mounted to your product.
2. You are requested not to use our product deviating from this specification.

## Reference only

### 1. Application

This specification is applied to Leaded MLCC RCE series in accordance with AEC-Q200 requirements used for Automotive Electronic equipment.

### 2. Rating

- Part number configuration

|      |        |                               |                  |             |                          |                   |              |                                     |                          |
|------|--------|-------------------------------|------------------|-------------|--------------------------|-------------------|--------------|-------------------------------------|--------------------------|
| ex.) | RCE    | 5C                            | 1H               | 102         | J                        | 0                 | K1           | H03                                 | B                        |
|      | Series | Temperature<br>Characteristic | Rated<br>voltage | Capacitance | Capacitance<br>tolerance | Dimension<br>code | Lead<br>code | Individual<br>specification<br>code | Packing<br>style<br>code |

- Temperature characteristic

| Code | Temp. Char. | Temp. Range | Temp. coeff.(ppm/°C) | Standard Temp. | Operating Temp. Range |
|------|-------------|-------------|----------------------|----------------|-----------------------|
| 5C   | C0G         | 25~125°C    | 0+/-30               | 25°C           | -55~125°C             |
|      |             | -55~25°C    | 0+30/-72             |                |                       |

- Rated voltage

| Code | Rated voltage |
|------|---------------|
| 1H   | DC50V         |
| 2A   | DC100V        |

- Capacitance

The first two digits denote significant figures ; the last digit denotes the multiplier of 10 in pF. If there is a decimal point, it is expressed by the capital letter "R". In this case, all figures are significant digits.

ex.) In case of 102.

$$10 \times 10^2 = 1000\text{pF}$$

In case of 5R0.

$$5.0\text{pF}$$

- Capacitance tolerance

| Code | Capacitance Tolerance |
|------|-----------------------|
| C    | +/-0.25pF             |
| D    | +/-0.5pF              |
| J    | +/-5%                 |

- Dimension code

| Code | Dimensions (LxW) mm max. |
|------|--------------------------|
| 0    | 3.6 x 3.5                |
| 1    | 4.0 x 3.5                |
| 2    | 5.5 x 4.0                |

## Reference only

- Lead code

| Code | Lead style               | Lead spacing (mm) |
|------|--------------------------|-------------------|
| A2   | Straight type            | 2.5+/-0.8         |
| DB   | Straight taping type     | 2.5+0.4/-0.2      |
| K1   | Inside crimp type        | 5.0+/-0.8         |
| M1   | Inside crimp taping type | 5.0+0.6/-0.2      |

Lead wire is solder coated CP wire.

- Individual specification code

Murata's control code

Please refer to [ Part number list ].

- Packing style code

| Code | Packing style       |
|------|---------------------|
| A    | Taping type of Ammo |
| B    | Bulk type           |

### 3. Marking

Temp. char. : Letter code : A(C0G Char.)



Capacitance : Actual numbers (Less than 100pF)  
3 digit numbers (100pF and over)

Capacitance tolerance : Code

Rated voltage : Letter code : 5 (DC50V only. Except dimension code : 0,1)  
Letter code : 1 (DC100V only. Except dimension code : 0,1)

Company name code : Abbreviation :  (Except dimension code : 0,1)

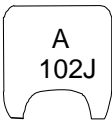
(Ex.)

| Dimension code \ Rated voltage | 50V   | 100V   |
|--------------------------------|---|--|
|                                | 0,1   |   |
| 2                              |  |  |

## Reference only

### 4. Part number list

• Straight Long  
(Lead Code: A2)

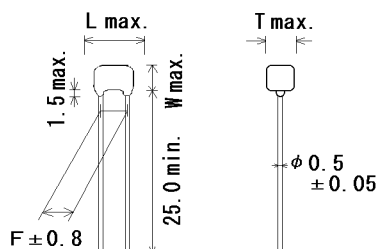

Unit : mm

| Customer Part Number | Murata Part Number | T.C. | DC Rated Volt. (V) | Cap.   | Cap. tol. | Dimension (mm) |     |    |     |     | Size Lead Code | Pack qty. (pcs) |
|----------------------|--------------------|------|--------------------|--------|-----------|----------------|-----|----|-----|-----|----------------|-----------------|
|                      |                    |      |                    |        |           | L              | W   | W1 | F   | T   |                |                 |
|                      | RCE5C1H1R0C0A2H03B | C0G  | 50                 | 1pF    | ±0.25pF   | 3.6            | 3.5 | -  | 2.5 | 2.5 | 0A2            | 500             |
|                      | RCE5C1H2R0C0A2H03B | C0G  | 50                 | 2pF    | ±0.25pF   | 3.6            | 3.5 | -  | 2.5 | 2.5 | 0A2            | 500             |
|                      | RCE5C1H3R0C0A2H03B | C0G  | 50                 | 3pF    | ±0.25pF   | 3.6            | 3.5 | -  | 2.5 | 2.5 | 0A2            | 500             |
|                      | RCE5C1H4R0C0A2H03B | C0G  | 50                 | 4pF    | ±0.25pF   | 3.6            | 3.5 | -  | 2.5 | 2.5 | 0A2            | 500             |
|                      | RCE5C1H5R0C0A2H03B | C0G  | 50                 | 5pF    | ±0.25pF   | 3.6            | 3.5 | -  | 2.5 | 2.5 | 0A2            | 500             |
|                      | RCE5C1H6R0D0A2H03B | C0G  | 50                 | 6pF    | ±0.5pF    | 3.6            | 3.5 | -  | 2.5 | 2.5 | 0A2            | 500             |
|                      | RCE5C1H7R0D0A2H03B | C0G  | 50                 | 7pF    | ±0.5pF    | 3.6            | 3.5 | -  | 2.5 | 2.5 | 0A2            | 500             |
|                      | RCE5C1H8R0D0A2H03B | C0G  | 50                 | 8pF    | ±0.5pF    | 3.6            | 3.5 | -  | 2.5 | 2.5 | 0A2            | 500             |
|                      | RCE5C1H9R0D0A2H03B | C0G  | 50                 | 9pF    | ±0.5pF    | 3.6            | 3.5 | -  | 2.5 | 2.5 | 0A2            | 500             |
|                      | RCE5C1H100J0A2H03B | C0G  | 50                 | 10pF   | ±5%       | 3.6            | 3.5 | -  | 2.5 | 2.5 | 0A2            | 500             |
|                      | RCE5C1H120J0A2H03B | C0G  | 50                 | 12pF   | ±5%       | 3.6            | 3.5 | -  | 2.5 | 2.5 | 0A2            | 500             |
|                      | RCE5C1H150J0A2H03B | C0G  | 50                 | 15pF   | ±5%       | 3.6            | 3.5 | -  | 2.5 | 2.5 | 0A2            | 500             |
|                      | RCE5C1H180J0A2H03B | C0G  | 50                 | 18pF   | ±5%       | 3.6            | 3.5 | -  | 2.5 | 2.5 | 0A2            | 500             |
|                      | RCE5C1H220J0A2H03B | C0G  | 50                 | 22pF   | ±5%       | 3.6            | 3.5 | -  | 2.5 | 2.5 | 0A2            | 500             |
|                      | RCE5C1H270J0A2H03B | C0G  | 50                 | 27pF   | ±5%       | 3.6            | 3.5 | -  | 2.5 | 2.5 | 0A2            | 500             |
|                      | RCE5C1H330J0A2H03B | C0G  | 50                 | 33pF   | ±5%       | 3.6            | 3.5 | -  | 2.5 | 2.5 | 0A2            | 500             |
|                      | RCE5C1H390J0A2H03B | C0G  | 50                 | 39pF   | ±5%       | 3.6            | 3.5 | -  | 2.5 | 2.5 | 0A2            | 500             |
|                      | RCE5C1H470J0A2H03B | C0G  | 50                 | 47pF   | ±5%       | 3.6            | 3.5 | -  | 2.5 | 2.5 | 0A2            | 500             |
|                      | RCE5C1H560J0A2H03B | C0G  | 50                 | 56pF   | ±5%       | 3.6            | 3.5 | -  | 2.5 | 2.5 | 0A2            | 500             |
|                      | RCE5C1H680J0A2H03B | C0G  | 50                 | 68pF   | ±5%       | 3.6            | 3.5 | -  | 2.5 | 2.5 | 0A2            | 500             |
|                      | RCE5C1H820J0A2H03B | C0G  | 50                 | 82pF   | ±5%       | 3.6            | 3.5 | -  | 2.5 | 2.5 | 0A2            | 500             |
|                      | RCE5C1H101J0A2H03B | C0G  | 50                 | 100pF  | ±5%       | 3.6            | 3.5 | -  | 2.5 | 2.5 | 0A2            | 500             |
|                      | RCE5C1H121J0A2H03B | C0G  | 50                 | 120pF  | ±5%       | 3.6            | 3.5 | -  | 2.5 | 2.5 | 0A2            | 500             |
|                      | RCE5C1H151J0A2H03B | C0G  | 50                 | 150pF  | ±5%       | 3.6            | 3.5 | -  | 2.5 | 2.5 | 0A2            | 500             |
|                      | RCE5C1H181J0A2H03B | C0G  | 50                 | 180pF  | ±5%       | 3.6            | 3.5 | -  | 2.5 | 2.5 | 0A2            | 500             |
|                      | RCE5C1H221J0A2H03B | C0G  | 50                 | 220pF  | ±5%       | 3.6            | 3.5 | -  | 2.5 | 2.5 | 0A2            | 500             |
|                      | RCE5C1H271J0A2H03B | C0G  | 50                 | 270pF  | ±5%       | 3.6            | 3.5 | -  | 2.5 | 2.5 | 0A2            | 500             |
|                      | RCE5C1H331J0A2H03B | C0G  | 50                 | 330pF  | ±5%       | 3.6            | 3.5 | -  | 2.5 | 2.5 | 0A2            | 500             |
|                      | RCE5C1H391J0A2H03B | C0G  | 50                 | 390pF  | ±5%       | 3.6            | 3.5 | -  | 2.5 | 2.5 | 0A2            | 500             |
|                      | RCE5C1H471J0A2H03B | C0G  | 50                 | 470pF  | ±5%       | 3.6            | 3.5 | -  | 2.5 | 2.5 | 0A2            | 500             |
|                      | RCE5C1H561J0A2H03B | C0G  | 50                 | 560pF  | ±5%       | 3.6            | 3.5 | -  | 2.5 | 2.5 | 0A2            | 500             |
|                      | RCE5C1H681J0A2H03B | C0G  | 50                 | 680pF  | ±5%       | 3.6            | 3.5 | -  | 2.5 | 2.5 | 0A2            | 500             |
|                      | RCE5C1H821J0A2H03B | C0G  | 50                 | 820pF  | ±5%       | 3.6            | 3.5 | -  | 2.5 | 2.5 | 0A2            | 500             |
|                      | RCE5C1H102J0A2H03B | C0G  | 50                 | 1000pF | ±5%       | 3.6            | 3.5 | -  | 2.5 | 2.5 | 0A2            | 500             |
|                      | RCE5C1H122J0A2H03B | C0G  | 50                 | 1200pF | ±5%       | 3.6            | 3.5 | -  | 2.5 | 2.5 | 0A2            | 500             |
|                      | RCE5C1H152J0A2H03B | C0G  | 50                 | 1500pF | ±5%       | 3.6            | 3.5 | -  | 2.5 | 2.5 | 0A2            | 500             |
|                      | RCE5C1H182J0A2H03B | C0G  | 50                 | 1800pF | ±5%       | 3.6            | 3.5 | -  | 2.5 | 2.5 | 0A2            | 500             |
|                      | RCE5C1H222J0A2H03B | C0G  | 50                 | 2200pF | ±5%       | 3.6            | 3.5 | -  | 2.5 | 2.5 | 0A2            | 500             |
|                      | RCE5C1H272J0A2H03B | C0G  | 50                 | 2700pF | ±5%       | 3.6            | 3.5 | -  | 2.5 | 2.5 | 0A2            | 500             |
|                      | RCE5C1H332J0A2H03B | C0G  | 50                 | 3300pF | ±5%       | 3.6            | 3.5 | -  | 2.5 | 2.5 | 0A2            | 500             |

Reference only

• Straight Long  
(Lead Code:A2)

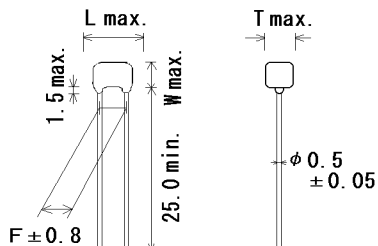

Unit : mm

| Customer Part Number | Murata Part Number | T.C. | DC Rated Volt. (V) | Cap.    | Cap. tol. | Dimension (mm) |     |    |     |      | Size Lead Code | Pack qty. (pcs) |
|----------------------|--------------------|------|--------------------|---------|-----------|----------------|-----|----|-----|------|----------------|-----------------|
|                      |                    |      |                    |         |           | L              | W   | W1 | F   | T    |                |                 |
|                      | RCE5C1H392J0A2H03B | C0G  | 50                 | 3900pF  | ±5%       | 3.6            | 3.5 | -  | 2.5 | 2.5  | 0A2            | 500             |
|                      | RCE5C1H472J1A2H03B | C0G  | 50                 | 4700pF  | ±5%       | 4.0            | 3.5 | -  | 2.5 | 2.5  | 1A2            | 500             |
|                      | RCE5C1H562J1A2H03B | C0G  | 50                 | 5600pF  | ±5%       | 4.0            | 3.5 | -  | 2.5 | 2.5  | 1A2            | 500             |
|                      | RCE5C1H682J1A2H03B | C0G  | 50                 | 6800pF  | ±5%       | 4.0            | 3.5 | -  | 2.5 | 2.5  | 1A2            | 500             |
|                      | RCE5C1H822J1A2H03B | C0G  | 50                 | 8200pF  | ±5%       | 4.0            | 3.5 | -  | 2.5 | 2.5  | 1A2            | 500             |
|                      | RCE5C1H103J1A2H03B | C0G  | 50                 | 10000pF | ±5%       | 4.0            | 3.5 | -  | 2.5 | 2.5  | 1A2            | 500             |
|                      | RCE5C1H123J1A2H03B | C0G  | 50                 | 12000pF | ±5%       | 4.0            | 3.5 | -  | 2.5 | 2.5  | 1A2            | 500             |
|                      | RCE5C1H153J1A2H03B | C0G  | 50                 | 15000pF | ±5%       | 4.0            | 3.5 | -  | 2.5 | 2.5  | 1A2            | 500             |
|                      | RCE5C1H183J1A2H03B | C0G  | 50                 | 18000pF | ±5%       | 4.0            | 3.5 | -  | 2.5 | 2.5  | 1A2            | 500             |
|                      | RCE5C1H223J1A2H03B | C0G  | 50                 | 22000pF | ±5%       | 4.0            | 3.5 | -  | 2.5 | 2.5  | 1A2            | 500             |
|                      | RCE5C1H273J2A2H03B | C0G  | 50                 | 27000pF | ±5%       | 5.5            | 4.0 | -  | 2.5 | 3.15 | 2A2            | 500             |
|                      | RCE5C1H333J2A2H03B | C0G  | 50                 | 33000pF | ±5%       | 5.5            | 4.0 | -  | 2.5 | 3.15 | 2A2            | 500             |
|                      | RCE5C1H393J2A2H03B | C0G  | 50                 | 39000pF | ±5%       | 5.5            | 4.0 | -  | 2.5 | 3.15 | 2A2            | 500             |
|                      | RCE5C1H473J2A2H03B | C0G  | 50                 | 47000pF | ±5%       | 5.5            | 4.0 | -  | 2.5 | 3.15 | 2A2            | 500             |
|                      | RCE5C1H563J2A2H03B | C0G  | 50                 | 56000pF | ±5%       | 5.5            | 4.0 | -  | 2.5 | 3.15 | 2A2            | 500             |
|                      | RCE5C1H683J2A2H03B | C0G  | 50                 | 68000pF | ±5%       | 5.5            | 4.0 | -  | 2.5 | 3.15 | 2A2            | 500             |
|                      | RCE5C1H823J2A2H03B | C0G  | 50                 | 82000pF | ±5%       | 5.5            | 4.0 | -  | 2.5 | 3.15 | 2A2            | 500             |
|                      | RCE5C1H104J2A2H03B | C0G  | 50                 | 0.1μF   | ±5%       | 5.5            | 4.0 | -  | 2.5 | 3.15 | 2A2            | 500             |
|                      | RCE5C2A1R0C0A2H03B | C0G  | 100                | 1pF     | ±0.25pF   | 3.6            | 3.5 | -  | 2.5 | 2.5  | 0A2            | 500             |
|                      | RCE5C2A2R0C0A2H03B | C0G  | 100                | 2pF     | ±0.25pF   | 3.6            | 3.5 | -  | 2.5 | 2.5  | 0A2            | 500             |
|                      | RCE5C2A3R0C0A2H03B | C0G  | 100                | 3pF     | ±0.25pF   | 3.6            | 3.5 | -  | 2.5 | 2.5  | 0A2            | 500             |
|                      | RCE5C2A4R0C0A2H03B | C0G  | 100                | 4pF     | ±0.25pF   | 3.6            | 3.5 | -  | 2.5 | 2.5  | 0A2            | 500             |
|                      | RCE5C2A5R0C0A2H03B | C0G  | 100                | 5pF     | ±0.25pF   | 3.6            | 3.5 | -  | 2.5 | 2.5  | 0A2            | 500             |
|                      | RCE5C2A6R0D0A2H03B | C0G  | 100                | 6pF     | ±0.5pF    | 3.6            | 3.5 | -  | 2.5 | 2.5  | 0A2            | 500             |
|                      | RCE5C2A7R0D0A2H03B | C0G  | 100                | 7pF     | ±0.5pF    | 3.6            | 3.5 | -  | 2.5 | 2.5  | 0A2            | 500             |
|                      | RCE5C2A8R0D0A2H03B | C0G  | 100                | 8pF     | ±0.5pF    | 3.6            | 3.5 | -  | 2.5 | 2.5  | 0A2            | 500             |
|                      | RCE5C2A9R0D0A2H03B | C0G  | 100                | 9pF     | ±0.5pF    | 3.6            | 3.5 | -  | 2.5 | 2.5  | 0A2            | 500             |
|                      | RCE5C2A100J0A2H03B | C0G  | 100                | 10pF    | ±5%       | 3.6            | 3.5 | -  | 2.5 | 2.5  | 0A2            | 500             |
|                      | RCE5C2A120J0A2H03B | C0G  | 100                | 12pF    | ±5%       | 3.6            | 3.5 | -  | 2.5 | 2.5  | 0A2            | 500             |
|                      | RCE5C2A150J0A2H03B | C0G  | 100                | 15pF    | ±5%       | 3.6            | 3.5 | -  | 2.5 | 2.5  | 0A2            | 500             |
|                      | RCE5C2A180J0A2H03B | C0G  | 100                | 18pF    | ±5%       | 3.6            | 3.5 | -  | 2.5 | 2.5  | 0A2            | 500             |
|                      | RCE5C2A220J0A2H03B | C0G  | 100                | 22pF    | ±5%       | 3.6            | 3.5 | -  | 2.5 | 2.5  | 0A2            | 500             |
|                      | RCE5C2A270J0A2H03B | C0G  | 100                | 27pF    | ±5%       | 3.6            | 3.5 | -  | 2.5 | 2.5  | 0A2            | 500             |
|                      | RCE5C2A330J0A2H03B | C0G  | 100                | 33pF    | ±5%       | 3.6            | 3.5 | -  | 2.5 | 2.5  | 0A2            | 500             |
|                      | RCE5C2A390J0A2H03B | C0G  | 100                | 39pF    | ±5%       | 3.6            | 3.5 | -  | 2.5 | 2.5  | 0A2            | 500             |
|                      | RCE5C2A470J0A2H03B | C0G  | 100                | 47pF    | ±5%       | 3.6            | 3.5 | -  | 2.5 | 2.5  | 0A2            | 500             |
|                      | RCE5C2A560J0A2H03B | C0G  | 100                | 56pF    | ±5%       | 3.6            | 3.5 | -  | 2.5 | 2.5  | 0A2            | 500             |
|                      | RCE5C2A680J0A2H03B | C0G  | 100                | 68pF    | ±5%       | 3.6            | 3.5 | -  | 2.5 | 2.5  | 0A2            | 500             |
|                      | RCE5C2A820J0A2H03B | C0G  | 100                | 82pF    | ±5%       | 3.6            | 3.5 | -  | 2.5 | 2.5  | 0A2            | 500             |
|                      | RCE5C2A101J0A2H03B | C0G  | 100                | 100pF   | ±5%       | 3.6            | 3.5 | -  | 2.5 | 2.5  | 0A2            | 500             |

Reference only

• Straight Long  
(Lead Code:A2)

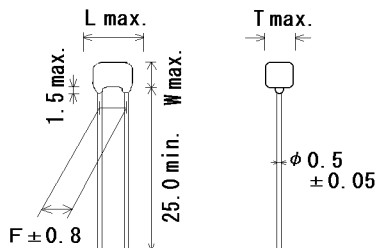

• Inside Crimp  
(Lead Code:K1)

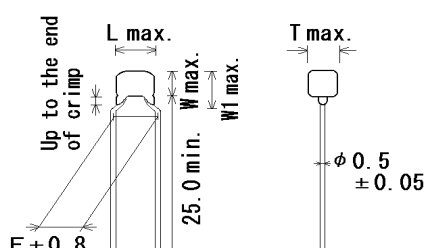

Unit : mm

| Customer Part Number | Murata Part Number | T.C. | DC Rated Volt. (V) | Cap.    | Cap. tol. | Dimension (mm) |     |     |     |      | Size Lead Code | Pack qty. (pcs) |
|----------------------|--------------------|------|--------------------|---------|-----------|----------------|-----|-----|-----|------|----------------|-----------------|
|                      |                    |      |                    |         |           | L              | W   | W1  | F   | T    |                |                 |
|                      | RCE5C2A121J0A2H03B | C0G  | 100                | 120pF   | ±5%       | 3.6            | 3.5 | -   | 2.5 | 2.5  | 0A2            | 500             |
|                      | RCE5C2A151J0A2H03B | C0G  | 100                | 150pF   | ±5%       | 3.6            | 3.5 | -   | 2.5 | 2.5  | 0A2            | 500             |
|                      | RCE5C2A181J0A2H03B | C0G  | 100                | 180pF   | ±5%       | 3.6            | 3.5 | -   | 2.5 | 2.5  | 0A2            | 500             |
|                      | RCE5C2A221J0A2H03B | C0G  | 100                | 220pF   | ±5%       | 3.6            | 3.5 | -   | 2.5 | 2.5  | 0A2            | 500             |
|                      | RCE5C2A271J0A2H03B | C0G  | 100                | 270pF   | ±5%       | 3.6            | 3.5 | -   | 2.5 | 2.5  | 0A2            | 500             |
|                      | RCE5C2A331J0A2H03B | C0G  | 100                | 330pF   | ±5%       | 3.6            | 3.5 | -   | 2.5 | 2.5  | 0A2            | 500             |
|                      | RCE5C2A391J0A2H03B | C0G  | 100                | 390pF   | ±5%       | 3.6            | 3.5 | -   | 2.5 | 2.5  | 0A2            | 500             |
|                      | RCE5C2A471J0A2H03B | C0G  | 100                | 470pF   | ±5%       | 3.6            | 3.5 | -   | 2.5 | 2.5  | 0A2            | 500             |
|                      | RCE5C2A561J0A2H03B | C0G  | 100                | 560pF   | ±5%       | 3.6            | 3.5 | -   | 2.5 | 2.5  | 0A2            | 500             |
|                      | RCE5C2A681J0A2H03B | C0G  | 100                | 680pF   | ±5%       | 3.6            | 3.5 | -   | 2.5 | 2.5  | 0A2            | 500             |
|                      | RCE5C2A821J0A2H03B | C0G  | 100                | 820pF   | ±5%       | 3.6            | 3.5 | -   | 2.5 | 2.5  | 0A2            | 500             |
|                      | RCE5C2A102J0A2H03B | C0G  | 100                | 1000pF  | ±5%       | 3.6            | 3.5 | -   | 2.5 | 2.5  | 0A2            | 500             |
|                      | RCE5C2A122J0A2H03B | C0G  | 100                | 1200pF  | ±5%       | 3.6            | 3.5 | -   | 2.5 | 2.5  | 0A2            | 500             |
|                      | RCE5C2A152J0A2H03B | C0G  | 100                | 1500pF  | ±5%       | 3.6            | 3.5 | -   | 2.5 | 2.5  | 0A2            | 500             |
|                      | RCE5C2A182J1A2H03B | C0G  | 100                | 1800pF  | ±5%       | 4.0            | 3.5 | -   | 2.5 | 2.5  | 1A2            | 500             |
|                      | RCE5C2A222J1A2H03B | C0G  | 100                | 2200pF  | ±5%       | 4.0            | 3.5 | -   | 2.5 | 2.5  | 1A2            | 500             |
|                      | RCE5C2A272J1A2H03B | C0G  | 100                | 2700pF  | ±5%       | 4.0            | 3.5 | -   | 2.5 | 2.5  | 1A2            | 500             |
|                      | RCE5C2A332J1A2H03B | C0G  | 100                | 3300pF  | ±5%       | 4.0            | 3.5 | -   | 2.5 | 2.5  | 1A2            | 500             |
|                      | RCE5C2A392J2A2H03B | C0G  | 100                | 3900pF  | ±5%       | 5.5            | 4.0 | -   | 2.5 | 3.15 | 2A2            | 500             |
|                      | RCE5C2A472J2A2H03B | C0G  | 100                | 4700pF  | ±5%       | 5.5            | 4.0 | -   | 2.5 | 3.15 | 2A2            | 500             |
|                      | RCE5C2A562J2A2H03B | C0G  | 100                | 5600pF  | ±5%       | 5.5            | 4.0 | -   | 2.5 | 3.15 | 2A2            | 500             |
|                      | RCE5C2A682J2A2H03B | C0G  | 100                | 6800pF  | ±5%       | 5.5            | 4.0 | -   | 2.5 | 3.15 | 2A2            | 500             |
|                      | RCE5C2A822J2A2H03B | C0G  | 100                | 8200pF  | ±5%       | 5.5            | 4.0 | -   | 2.5 | 3.15 | 2A2            | 500             |
|                      | RCE5C2A103J2A2H03B | C0G  | 100                | 10000pF | ±5%       | 5.5            | 4.0 | -   | 2.5 | 3.15 | 2A2            | 500             |
|                      | RCE5C1H1R0C0K1H03B | C0G  | 50                 | 1pF     | ±0.25pF   | 3.6            | 3.5 | 6.0 | 5.0 | 2.5  | 0K1            | 500             |
|                      | RCE5C1H2R0C0K1H03B | C0G  | 50                 | 2pF     | ±0.25pF   | 3.6            | 3.5 | 6.0 | 5.0 | 2.5  | 0K1            | 500             |
|                      | RCE5C1H3R0C0K1H03B | C0G  | 50                 | 3pF     | ±0.25pF   | 3.6            | 3.5 | 6.0 | 5.0 | 2.5  | 0K1            | 500             |
|                      | RCE5C1H4R0C0K1H03B | C0G  | 50                 | 4pF     | ±0.25pF   | 3.6            | 3.5 | 6.0 | 5.0 | 2.5  | 0K1            | 500             |
|                      | RCE5C1H5R0C0K1H03B | C0G  | 50                 | 5pF     | ±0.25pF   | 3.6            | 3.5 | 6.0 | 5.0 | 2.5  | 0K1            | 500             |
|                      | RCE5C1H6R0D0K1H03B | C0G  | 50                 | 6pF     | ±0.5pF    | 3.6            | 3.5 | 6.0 | 5.0 | 2.5  | 0K1            | 500             |
|                      | RCE5C1H7R0D0K1H03B | C0G  | 50                 | 7pF     | ±0.5pF    | 3.6            | 3.5 | 6.0 | 5.0 | 2.5  | 0K1            | 500             |
|                      | RCE5C1H8R0D0K1H03B | C0G  | 50                 | 8pF     | ±0.5pF    | 3.6            | 3.5 | 6.0 | 5.0 | 2.5  | 0K1            | 500             |
|                      | RCE5C1H9R0D0K1H03B | C0G  | 50                 | 9pF     | ±0.5pF    | 3.6            | 3.5 | 6.0 | 5.0 | 2.5  | 0K1            | 500             |
|                      | RCE5C1H100J0K1H03B | C0G  | 50                 | 10pF    | ±5%       | 3.6            | 3.5 | 6.0 | 5.0 | 2.5  | 0K1            | 500             |
|                      | RCE5C1H120J0K1H03B | C0G  | 50                 | 12pF    | ±5%       | 3.6            | 3.5 | 6.0 | 5.0 | 2.5  | 0K1            | 500             |
|                      | RCE5C1H150J0K1H03B | C0G  | 50                 | 15pF    | ±5%       | 3.6            | 3.5 | 6.0 | 5.0 | 2.5  | 0K1            | 500             |
|                      | RCE5C1H180J0K1H03B | C0G  | 50                 | 18pF    | ±5%       | 3.6            | 3.5 | 6.0 | 5.0 | 2.5  | 0K1            | 500             |
|                      | RCE5C1H220J0K1H03B | C0G  | 50                 | 22pF    | ±5%       | 3.6            | 3.5 | 6.0 | 5.0 | 2.5  | 0K1            | 500             |
|                      | RCE5C1H270J0K1H03B | C0G  | 50                 | 27pF    | ±5%       | 3.6            | 3.5 | 6.0 | 5.0 | 2.5  | 0K1            | 500             |
|                      | RCE5C1H330J0K1H03B | C0G  | 50                 | 33pF    | ±5%       | 3.6            | 3.5 | 6.0 | 5.0 | 2.5  | 0K1            | 500             |



## Reference only

• Inside Crimp  
(Lead Code:K1)

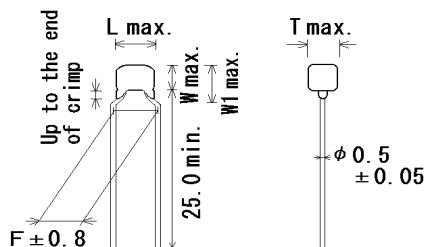

Unit : mm

| Customer Part Number | Murata Part Number | T.C. | DC Rated Volt. (V) | Cap.    | Cap. tol. | Dimension (mm) |     |     |     |      | Size Lead Code | Pack qty. (pcs) |
|----------------------|--------------------|------|--------------------|---------|-----------|----------------|-----|-----|-----|------|----------------|-----------------|
|                      |                    |      |                    |         |           | L              | W   | W1  | F   | T    |                |                 |
|                      | RCE5C1H390J0K1H03B | C0G  | 50                 | 39pF    | ±5%       | 3.6            | 3.5 | 6.0 | 5.0 | 2.5  | 0K1            | 500             |
|                      | RCE5C1H470J0K1H03B | C0G  | 50                 | 47pF    | ±5%       | 3.6            | 3.5 | 6.0 | 5.0 | 2.5  | 0K1            | 500             |
|                      | RCE5C1H560J0K1H03B | C0G  | 50                 | 56pF    | ±5%       | 3.6            | 3.5 | 6.0 | 5.0 | 2.5  | 0K1            | 500             |
|                      | RCE5C1H680J0K1H03B | C0G  | 50                 | 68pF    | ±5%       | 3.6            | 3.5 | 6.0 | 5.0 | 2.5  | 0K1            | 500             |
|                      | RCE5C1H820J0K1H03B | C0G  | 50                 | 82pF    | ±5%       | 3.6            | 3.5 | 6.0 | 5.0 | 2.5  | 0K1            | 500             |
|                      | RCE5C1H101J0K1H03B | C0G  | 50                 | 100pF   | ±5%       | 3.6            | 3.5 | 6.0 | 5.0 | 2.5  | 0K1            | 500             |
|                      | RCE5C1H121J0K1H03B | C0G  | 50                 | 120pF   | ±5%       | 3.6            | 3.5 | 6.0 | 5.0 | 2.5  | 0K1            | 500             |
|                      | RCE5C1H151J0K1H03B | C0G  | 50                 | 150pF   | ±5%       | 3.6            | 3.5 | 6.0 | 5.0 | 2.5  | 0K1            | 500             |
|                      | RCE5C1H181J0K1H03B | C0G  | 50                 | 180pF   | ±5%       | 3.6            | 3.5 | 6.0 | 5.0 | 2.5  | 0K1            | 500             |
|                      | RCE5C1H221J0K1H03B | C0G  | 50                 | 220pF   | ±5%       | 3.6            | 3.5 | 6.0 | 5.0 | 2.5  | 0K1            | 500             |
|                      | RCE5C1H271J0K1H03B | C0G  | 50                 | 270pF   | ±5%       | 3.6            | 3.5 | 6.0 | 5.0 | 2.5  | 0K1            | 500             |
|                      | RCE5C1H331J0K1H03B | C0G  | 50                 | 330pF   | ±5%       | 3.6            | 3.5 | 6.0 | 5.0 | 2.5  | 0K1            | 500             |
|                      | RCE5C1H391J0K1H03B | C0G  | 50                 | 390pF   | ±5%       | 3.6            | 3.5 | 6.0 | 5.0 | 2.5  | 0K1            | 500             |
|                      | RCE5C1H471J0K1H03B | C0G  | 50                 | 470pF   | ±5%       | 3.6            | 3.5 | 6.0 | 5.0 | 2.5  | 0K1            | 500             |
|                      | RCE5C1H561J0K1H03B | C0G  | 50                 | 560pF   | ±5%       | 3.6            | 3.5 | 6.0 | 5.0 | 2.5  | 0K1            | 500             |
|                      | RCE5C1H681J0K1H03B | C0G  | 50                 | 680pF   | ±5%       | 3.6            | 3.5 | 6.0 | 5.0 | 2.5  | 0K1            | 500             |
|                      | RCE5C1H821J0K1H03B | C0G  | 50                 | 820pF   | ±5%       | 3.6            | 3.5 | 6.0 | 5.0 | 2.5  | 0K1            | 500             |
|                      | RCE5C1H102J0K1H03B | C0G  | 50                 | 1000pF  | ±5%       | 3.6            | 3.5 | 6.0 | 5.0 | 2.5  | 0K1            | 500             |
|                      | RCE5C1H122J0K1H03B | C0G  | 50                 | 1200pF  | ±5%       | 3.6            | 3.5 | 6.0 | 5.0 | 2.5  | 0K1            | 500             |
|                      | RCE5C1H152J0K1H03B | C0G  | 50                 | 1500pF  | ±5%       | 3.6            | 3.5 | 6.0 | 5.0 | 2.5  | 0K1            | 500             |
|                      | RCE5C1H182J0K1H03B | C0G  | 50                 | 1800pF  | ±5%       | 3.6            | 3.5 | 6.0 | 5.0 | 2.5  | 0K1            | 500             |
|                      | RCE5C1H222J0K1H03B | C0G  | 50                 | 2200pF  | ±5%       | 3.6            | 3.5 | 6.0 | 5.0 | 2.5  | 0K1            | 500             |
|                      | RCE5C1H272J0K1H03B | C0G  | 50                 | 2700pF  | ±5%       | 3.6            | 3.5 | 6.0 | 5.0 | 2.5  | 0K1            | 500             |
|                      | RCE5C1H332J0K1H03B | C0G  | 50                 | 3300pF  | ±5%       | 3.6            | 3.5 | 6.0 | 5.0 | 2.5  | 0K1            | 500             |
|                      | RCE5C1H392J0K1H03B | C0G  | 50                 | 3900pF  | ±5%       | 3.6            | 3.5 | 6.0 | 5.0 | 2.5  | 0K1            | 500             |
|                      | RCE5C1H472J1K1H03B | C0G  | 50                 | 4700pF  | ±5%       | 4.0            | 3.5 | 5.0 | 5.0 | 2.5  | 1K1            | 500             |
|                      | RCE5C1H562J1K1H03B | C0G  | 50                 | 5600pF  | ±5%       | 4.0            | 3.5 | 5.0 | 5.0 | 2.5  | 1K1            | 500             |
|                      | RCE5C1H682J1K1H03B | C0G  | 50                 | 6800pF  | ±5%       | 4.0            | 3.5 | 5.0 | 5.0 | 2.5  | 1K1            | 500             |
|                      | RCE5C1H822J1K1H03B | C0G  | 50                 | 8200pF  | ±5%       | 4.0            | 3.5 | 5.0 | 5.0 | 2.5  | 1K1            | 500             |
|                      | RCE5C1H103J1K1H03B | C0G  | 50                 | 10000pF | ±5%       | 4.0            | 3.5 | 5.0 | 5.0 | 2.5  | 1K1            | 500             |
|                      | RCE5C1H123J1K1H03B | C0G  | 50                 | 12000pF | ±5%       | 4.0            | 3.5 | 5.0 | 5.0 | 2.5  | 1K1            | 500             |
|                      | RCE5C1H153J1K1H03B | C0G  | 50                 | 15000pF | ±5%       | 4.0            | 3.5 | 5.0 | 5.0 | 2.5  | 1K1            | 500             |
|                      | RCE5C1H183J1K1H03B | C0G  | 50                 | 18000pF | ±5%       | 4.0            | 3.5 | 5.0 | 5.0 | 2.5  | 1K1            | 500             |
|                      | RCE5C1H223J1K1H03B | C0G  | 50                 | 22000pF | ±5%       | 4.0            | 3.5 | 5.0 | 5.0 | 2.5  | 1K1            | 500             |
|                      | RCE5C1H273J2K1H03B | C0G  | 50                 | 27000pF | ±5%       | 5.5            | 4.0 | 6.0 | 5.0 | 3.15 | 2K1            | 500             |
|                      | RCE5C1H333J2K1H03B | C0G  | 50                 | 33000pF | ±5%       | 5.5            | 4.0 | 6.0 | 5.0 | 3.15 | 2K1            | 500             |
|                      | RCE5C1H393J2K1H03B | C0G  | 50                 | 39000pF | ±5%       | 5.5            | 4.0 | 6.0 | 5.0 | 3.15 | 2K1            | 500             |
|                      | RCE5C1H473J2K1H03B | C0G  | 50                 | 47000pF | ±5%       | 5.5            | 4.0 | 6.0 | 5.0 | 3.15 | 2K1            | 500             |
|                      | RCE5C1H563J2K1H03B | C0G  | 50                 | 56000pF | ±5%       | 5.5            | 4.0 | 6.0 | 5.0 | 3.15 | 2K1            | 500             |
|                      | RCE5C1H683J2K1H03B | C0G  | 50                 | 68000pF | ±5%       | 5.5            | 4.0 | 6.0 | 5.0 | 3.15 | 2K1            | 500             |

Reference only

- Inside Crimp  
(Lead Code:K1)

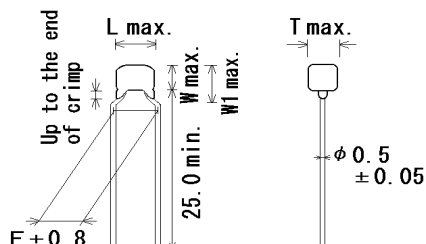

Unit : mm

| Customer Part Number | Murata Part Number | T.C. | DC Rated Volt. (V) | Cap.    | Cap. tol. | Dimension (mm) |     |     |     |      | Size Lead Code | Pack qty. (pcs) |
|----------------------|--------------------|------|--------------------|---------|-----------|----------------|-----|-----|-----|------|----------------|-----------------|
|                      |                    |      |                    |         |           | L              | W   | W1  | F   | T    |                |                 |
|                      | RCE5C1H823J2K1H03B | C0G  | 50                 | 82000pF | ±5%       | 5.5            | 4.0 | 6.0 | 5.0 | 3.15 | 2K1            | 500             |
|                      | RCE5C1H104J2K1H03B | C0G  | 50                 | 0.1μF   | ±5%       | 5.5            | 4.0 | 6.0 | 5.0 | 3.15 | 2K1            | 500             |
|                      | RCE5C2A1R0C0K1H03B | C0G  | 100                | 1pF     | ±0.25pF   | 3.6            | 3.5 | 6.0 | 5.0 | 2.5  | 0K1            | 500             |
|                      | RCE5C2A2R0C0K1H03B | C0G  | 100                | 2pF     | ±0.25pF   | 3.6            | 3.5 | 6.0 | 5.0 | 2.5  | 0K1            | 500             |
|                      | RCE5C2A3R0C0K1H03B | C0G  | 100                | 3pF     | ±0.25pF   | 3.6            | 3.5 | 6.0 | 5.0 | 2.5  | 0K1            | 500             |
|                      | RCE5C2A4R0C0K1H03B | C0G  | 100                | 4pF     | ±0.25pF   | 3.6            | 3.5 | 6.0 | 5.0 | 2.5  | 0K1            | 500             |
|                      | RCE5C2A5R0C0K1H03B | C0G  | 100                | 5pF     | ±0.25pF   | 3.6            | 3.5 | 6.0 | 5.0 | 2.5  | 0K1            | 500             |
|                      | RCE5C2A6R0D0K1H03B | C0G  | 100                | 6pF     | ±0.5pF    | 3.6            | 3.5 | 6.0 | 5.0 | 2.5  | 0K1            | 500             |
|                      | RCE5C2A7R0D0K1H03B | C0G  | 100                | 7pF     | ±0.5pF    | 3.6            | 3.5 | 6.0 | 5.0 | 2.5  | 0K1            | 500             |
|                      | RCE5C2A8R0D0K1H03B | C0G  | 100                | 8pF     | ±0.5pF    | 3.6            | 3.5 | 6.0 | 5.0 | 2.5  | 0K1            | 500             |
|                      | RCE5C2A9R0D0K1H03B | C0G  | 100                | 9pF     | ±0.5pF    | 3.6            | 3.5 | 6.0 | 5.0 | 2.5  | 0K1            | 500             |
|                      | RCE5C2A100J0K1H03B | C0G  | 100                | 10pF    | ±5%       | 3.6            | 3.5 | 6.0 | 5.0 | 2.5  | 0K1            | 500             |
|                      | RCE5C2A120J0K1H03B | C0G  | 100                | 12pF    | ±5%       | 3.6            | 3.5 | 6.0 | 5.0 | 2.5  | 0K1            | 500             |
|                      | RCE5C2A150J0K1H03B | C0G  | 100                | 15pF    | ±5%       | 3.6            | 3.5 | 6.0 | 5.0 | 2.5  | 0K1            | 500             |
|                      | RCE5C2A180J0K1H03B | C0G  | 100                | 18pF    | ±5%       | 3.6            | 3.5 | 6.0 | 5.0 | 2.5  | 0K1            | 500             |
|                      | RCE5C2A220J0K1H03B | C0G  | 100                | 22pF    | ±5%       | 3.6            | 3.5 | 6.0 | 5.0 | 2.5  | 0K1            | 500             |
|                      | RCE5C2A270J0K1H03B | C0G  | 100                | 27pF    | ±5%       | 3.6            | 3.5 | 6.0 | 5.0 | 2.5  | 0K1            | 500             |
|                      | RCE5C2A330J0K1H03B | C0G  | 100                | 33pF    | ±5%       | 3.6            | 3.5 | 6.0 | 5.0 | 2.5  | 0K1            | 500             |
|                      | RCE5C2A390J0K1H03B | C0G  | 100                | 39pF    | ±5%       | 3.6            | 3.5 | 6.0 | 5.0 | 2.5  | 0K1            | 500             |
|                      | RCE5C2A470J0K1H03B | C0G  | 100                | 47pF    | ±5%       | 3.6            | 3.5 | 6.0 | 5.0 | 2.5  | 0K1            | 500             |
|                      | RCE5C2A560J0K1H03B | C0G  | 100                | 56pF    | ±5%       | 3.6            | 3.5 | 6.0 | 5.0 | 2.5  | 0K1            | 500             |
|                      | RCE5C2A680J0K1H03B | C0G  | 100                | 68pF    | ±5%       | 3.6            | 3.5 | 6.0 | 5.0 | 2.5  | 0K1            | 500             |
|                      | RCE5C2A820J0K1H03B | C0G  | 100                | 82pF    | ±5%       | 3.6            | 3.5 | 6.0 | 5.0 | 2.5  | 0K1            | 500             |
|                      | RCE5C2A101J0K1H03B | C0G  | 100                | 100pF   | ±5%       | 3.6            | 3.5 | 6.0 | 5.0 | 2.5  | 0K1            | 500             |
|                      | RCE5C2A121J0K1H03B | C0G  | 100                | 120pF   | ±5%       | 3.6            | 3.5 | 6.0 | 5.0 | 2.5  | 0K1            | 500             |
|                      | RCE5C2A151J0K1H03B | C0G  | 100                | 150pF   | ±5%       | 3.6            | 3.5 | 6.0 | 5.0 | 2.5  | 0K1            | 500             |
|                      | RCE5C2A181J0K1H03B | C0G  | 100                | 180pF   | ±5%       | 3.6            | 3.5 | 6.0 | 5.0 | 2.5  | 0K1            | 500             |
|                      | RCE5C2A221J0K1H03B | C0G  | 100                | 220pF   | ±5%       | 3.6            | 3.5 | 6.0 | 5.0 | 2.5  | 0K1            | 500             |
|                      | RCE5C2A271J0K1H03B | C0G  | 100                | 270pF   | ±5%       | 3.6            | 3.5 | 6.0 | 5.0 | 2.5  | 0K1            | 500             |
|                      | RCE5C2A331J0K1H03B | C0G  | 100                | 330pF   | ±5%       | 3.6            | 3.5 | 6.0 | 5.0 | 2.5  | 0K1            | 500             |
|                      | RCE5C2A391J0K1H03B | C0G  | 100                | 390pF   | ±5%       | 3.6            | 3.5 | 6.0 | 5.0 | 2.5  | 0K1            | 500             |
|                      | RCE5C2A471J0K1H03B | C0G  | 100                | 470pF   | ±5%       | 3.6            | 3.5 | 6.0 | 5.0 | 2.5  | 0K1            | 500             |
|                      | RCE5C2A561J0K1H03B | C0G  | 100                | 560pF   | ±5%       | 3.6            | 3.5 | 6.0 | 5.0 | 2.5  | 0K1            | 500             |
|                      | RCE5C2A681J0K1H03B | C0G  | 100                | 680pF   | ±5%       | 3.6            | 3.5 | 6.0 | 5.0 | 2.5  | 0K1            | 500             |
|                      | RCE5C2A821J0K1H03B | C0G  | 100                | 820pF   | ±5%       | 3.6            | 3.5 | 6.0 | 5.0 | 2.5  | 0K1            | 500             |
|                      | RCE5C2A102J0K1H03B | C0G  | 100                | 1000pF  | ±5%       | 3.6            | 3.5 | 6.0 | 5.0 | 2.5  | 0K1            | 500             |
|                      | RCE5C2A122J0K1H03B | C0G  | 100                | 1200pF  | ±5%       | 3.6            | 3.5 | 6.0 | 5.0 | 2.5  | 0K1            | 500             |
|                      | RCE5C2A152J0K1H03B | C0G  | 100                | 1500pF  | ±5%       | 3.6            | 3.5 | 6.0 | 5.0 | 2.5  | 0K1            | 500             |
|                      | RCE5C2A182J1K1H03B | C0G  | 100                | 1800pF  | ±5%       | 4.0            | 3.5 | 5.0 | 5.0 | 2.5  | 1K1            | 500             |
|                      | RCE5C2A222J1K1H03B | C0G  | 100                | 2200pF  | ±5%       | 4.0            | 3.5 | 5.0 | 5.0 | 2.5  | 1K1            | 500             |

Reference only

• Inside Crimp  
(Lead Code:K1)

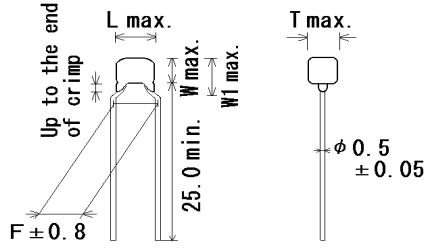

Unit : mm

| Customer Part Number | Murata Part Number | T.C. | DC Rated Volt. (V) | Cap.    | Cap. tol. | Dimension (mm) |     |     |     |      | Size Lead Code | Pack qty. (pcs) |
|----------------------|--------------------|------|--------------------|---------|-----------|----------------|-----|-----|-----|------|----------------|-----------------|
|                      |                    |      |                    |         |           | L              | W   | W1  | F   | T    |                |                 |
|                      | RCE5C2A272J1K1H03B | C0G  | 100                | 2700pF  | ±5%       | 4.0            | 3.5 | 5.0 | 5.0 | 2.5  | 1K1            | 500             |
|                      | RCE5C2A332J1K1H03B | C0G  | 100                | 3300pF  | ±5%       | 4.0            | 3.5 | 5.0 | 5.0 | 2.5  | 1K1            | 500             |
|                      | RCE5C2A392J2K1H03B | C0G  | 100                | 3900pF  | ±5%       | 5.5            | 4.0 | 6.0 | 5.0 | 3.15 | 2K1            | 500             |
|                      | RCE5C2A472J2K1H03B | C0G  | 100                | 4700pF  | ±5%       | 5.5            | 4.0 | 6.0 | 5.0 | 3.15 | 2K1            | 500             |
|                      | RCE5C2A562J2K1H03B | C0G  | 100                | 5600pF  | ±5%       | 5.5            | 4.0 | 6.0 | 5.0 | 3.15 | 2K1            | 500             |
|                      | RCE5C2A682J2K1H03B | C0G  | 100                | 6800pF  | ±5%       | 5.5            | 4.0 | 6.0 | 5.0 | 3.15 | 2K1            | 500             |
|                      | RCE5C2A822J2K1H03B | C0G  | 100                | 8200pF  | ±5%       | 5.5            | 4.0 | 6.0 | 5.0 | 3.15 | 2K1            | 500             |
|                      | RCE5C2A103J2K1H03B | C0G  | 100                | 10000pF | ±5%       | 5.5            | 4.0 | 6.0 | 5.0 | 3.15 | 2K1            | 500             |

Reference only

- Straight Taping  
(Lead Code:D\*)

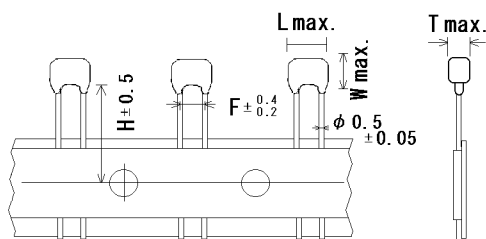

Unit : mm

| Customer Part Number | Murata Part Number | T.C. | DC Rated volt. (V) | Cap.   | Cap. tol. | Dimension (mm) |     |    |     |     |      | Size Lead Code | Pack qty. (pcs) |
|----------------------|--------------------|------|--------------------|--------|-----------|----------------|-----|----|-----|-----|------|----------------|-----------------|
|                      |                    |      |                    |        |           | L              | W   | W1 | F   | T   | H    |                |                 |
|                      | RCE5C1H1R0C0DBH03A | C0G  | 50                 | 1pF    | ±0.25pF   | 3.6            | 3.5 | -  | 2.5 | 2.5 | 16.0 | 0DB            | 2000            |
|                      | RCE5C1H2R0C0DBH03A | C0G  | 50                 | 2pF    | ±0.25pF   | 3.6            | 3.5 | -  | 2.5 | 2.5 | 16.0 | 0DB            | 2000            |
|                      | RCE5C1H3R0C0DBH03A | C0G  | 50                 | 3pF    | ±0.25pF   | 3.6            | 3.5 | -  | 2.5 | 2.5 | 16.0 | 0DB            | 2000            |
|                      | RCE5C1H4R0C0DBH03A | C0G  | 50                 | 4pF    | ±0.25pF   | 3.6            | 3.5 | -  | 2.5 | 2.5 | 16.0 | 0DB            | 2000            |
|                      | RCE5C1H5R0C0DBH03A | C0G  | 50                 | 5pF    | ±0.25pF   | 3.6            | 3.5 | -  | 2.5 | 2.5 | 16.0 | 0DB            | 2000            |
|                      | RCE5C1H6R0D0DBH03A | C0G  | 50                 | 6pF    | ±0.5pF    | 3.6            | 3.5 | -  | 2.5 | 2.5 | 16.0 | 0DB            | 2000            |
|                      | RCE5C1H7R0D0DBH03A | C0G  | 50                 | 7pF    | ±0.5pF    | 3.6            | 3.5 | -  | 2.5 | 2.5 | 16.0 | 0DB            | 2000            |
|                      | RCE5C1H8R0D0DBH03A | C0G  | 50                 | 8pF    | ±0.5pF    | 3.6            | 3.5 | -  | 2.5 | 2.5 | 16.0 | 0DB            | 2000            |
|                      | RCE5C1H9R0D0DBH03A | C0G  | 50                 | 9pF    | ±0.5pF    | 3.6            | 3.5 | -  | 2.5 | 2.5 | 16.0 | 0DB            | 2000            |
|                      | RCE5C1H100J0DBH03A | C0G  | 50                 | 10pF   | ±5%       | 3.6            | 3.5 | -  | 2.5 | 2.5 | 16.0 | 0DB            | 2000            |
|                      | RCE5C1H120J0DBH03A | C0G  | 50                 | 12pF   | ±5%       | 3.6            | 3.5 | -  | 2.5 | 2.5 | 16.0 | 0DB            | 2000            |
|                      | RCE5C1H150J0DBH03A | C0G  | 50                 | 15pF   | ±5%       | 3.6            | 3.5 | -  | 2.5 | 2.5 | 16.0 | 0DB            | 2000            |
|                      | RCE5C1H180J0DBH03A | C0G  | 50                 | 18pF   | ±5%       | 3.6            | 3.5 | -  | 2.5 | 2.5 | 16.0 | 0DB            | 2000            |
|                      | RCE5C1H220J0DBH03A | C0G  | 50                 | 22pF   | ±5%       | 3.6            | 3.5 | -  | 2.5 | 2.5 | 16.0 | 0DB            | 2000            |
|                      | RCE5C1H270J0DBH03A | C0G  | 50                 | 27pF   | ±5%       | 3.6            | 3.5 | -  | 2.5 | 2.5 | 16.0 | 0DB            | 2000            |
|                      | RCE5C1H330J0DBH03A | C0G  | 50                 | 33pF   | ±5%       | 3.6            | 3.5 | -  | 2.5 | 2.5 | 16.0 | 0DB            | 2000            |
|                      | RCE5C1H390J0DBH03A | C0G  | 50                 | 39pF   | ±5%       | 3.6            | 3.5 | -  | 2.5 | 2.5 | 16.0 | 0DB            | 2000            |
|                      | RCE5C1H470J0DBH03A | C0G  | 50                 | 47pF   | ±5%       | 3.6            | 3.5 | -  | 2.5 | 2.5 | 16.0 | 0DB            | 2000            |
|                      | RCE5C1H560J0DBH03A | C0G  | 50                 | 56pF   | ±5%       | 3.6            | 3.5 | -  | 2.5 | 2.5 | 16.0 | 0DB            | 2000            |
|                      | RCE5C1H680J0DBH03A | C0G  | 50                 | 68pF   | ±5%       | 3.6            | 3.5 | -  | 2.5 | 2.5 | 16.0 | 0DB            | 2000            |
|                      | RCE5C1H820J0DBH03A | C0G  | 50                 | 82pF   | ±5%       | 3.6            | 3.5 | -  | 2.5 | 2.5 | 16.0 | 0DB            | 2000            |
|                      | RCE5C1H101J0DBH03A | C0G  | 50                 | 100pF  | ±5%       | 3.6            | 3.5 | -  | 2.5 | 2.5 | 16.0 | 0DB            | 2000            |
|                      | RCE5C1H121J0DBH03A | C0G  | 50                 | 120pF  | ±5%       | 3.6            | 3.5 | -  | 2.5 | 2.5 | 16.0 | 0DB            | 2000            |
|                      | RCE5C1H151J0DBH03A | C0G  | 50                 | 150pF  | ±5%       | 3.6            | 3.5 | -  | 2.5 | 2.5 | 16.0 | 0DB            | 2000            |
|                      | RCE5C1H181J0DBH03A | C0G  | 50                 | 180pF  | ±5%       | 3.6            | 3.5 | -  | 2.5 | 2.5 | 16.0 | 0DB            | 2000            |
|                      | RCE5C1H221J0DBH03A | C0G  | 50                 | 220pF  | ±5%       | 3.6            | 3.5 | -  | 2.5 | 2.5 | 16.0 | 0DB            | 2000            |
|                      | RCE5C1H271J0DBH03A | C0G  | 50                 | 270pF  | ±5%       | 3.6            | 3.5 | -  | 2.5 | 2.5 | 16.0 | 0DB            | 2000            |
|                      | RCE5C1H331J0DBH03A | C0G  | 50                 | 330pF  | ±5%       | 3.6            | 3.5 | -  | 2.5 | 2.5 | 16.0 | 0DB            | 2000            |
|                      | RCE5C1H391J0DBH03A | C0G  | 50                 | 390pF  | ±5%       | 3.6            | 3.5 | -  | 2.5 | 2.5 | 16.0 | 0DB            | 2000            |
|                      | RCE5C1H471J0DBH03A | C0G  | 50                 | 470pF  | ±5%       | 3.6            | 3.5 | -  | 2.5 | 2.5 | 16.0 | 0DB            | 2000            |
|                      | RCE5C1H561J0DBH03A | C0G  | 50                 | 560pF  | ±5%       | 3.6            | 3.5 | -  | 2.5 | 2.5 | 16.0 | 0DB            | 2000            |
|                      | RCE5C1H681J0DBH03A | C0G  | 50                 | 680pF  | ±5%       | 3.6            | 3.5 | -  | 2.5 | 2.5 | 16.0 | 0DB            | 2000            |
|                      | RCE5C1H821J0DBH03A | C0G  | 50                 | 820pF  | ±5%       | 3.6            | 3.5 | -  | 2.5 | 2.5 | 16.0 | 0DB            | 2000            |
|                      | RCE5C1H102J0DBH03A | C0G  | 50                 | 1000pF | ±5%       | 3.6            | 3.5 | -  | 2.5 | 2.5 | 16.0 | 0DB            | 2000            |
|                      | RCE5C1H122J0DBH03A | C0G  | 50                 | 1200pF | ±5%       | 3.6            | 3.5 | -  | 2.5 | 2.5 | 16.0 | 0DB            | 2000            |
|                      | RCE5C1H152J0DBH03A | C0G  | 50                 | 1500pF | ±5%       | 3.6            | 3.5 | -  | 2.5 | 2.5 | 16.0 | 0DB            | 2000            |
|                      | RCE5C1H182J0DBH03A | C0G  | 50                 | 1800pF | ±5%       | 3.6            | 3.5 | -  | 2.5 | 2.5 | 16.0 | 0DB            | 2000            |
|                      | RCE5C1H222J0DBH03A | C0G  | 50                 | 2200pF | ±5%       | 3.6            | 3.5 | -  | 2.5 | 2.5 | 16.0 | 0DB            | 2000            |
|                      | RCE5C1H272J0DBH03A | C0G  | 50                 | 2700pF | ±5%       | 3.6            | 3.5 | -  | 2.5 | 2.5 | 16.0 | 0DB            | 2000            |
|                      | RCE5C1H332J0DBH03A | C0G  | 50                 | 3300pF | ±5%       | 3.6            | 3.5 | -  | 2.5 | 2.5 | 16.0 | 0DB            | 2000            |

Reference only

- Straight Taping  
(Lead Code:D\*)

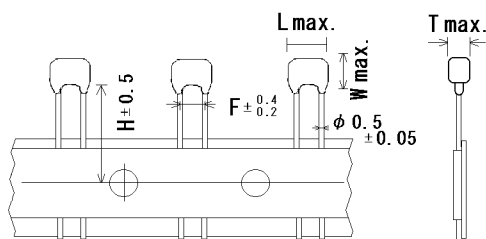

Unit : mm

| Customer Part Number | Murata Part Number | T.C. | DC Rated volt. (V) | Cap.    | Cap. tol. | Dimension (mm) |     |    |     |      |      | Size Lead Code | Pack qty. (pcs) |
|----------------------|--------------------|------|--------------------|---------|-----------|----------------|-----|----|-----|------|------|----------------|-----------------|
|                      |                    |      |                    |         |           | L              | W   | W1 | F   | T    | H    |                |                 |
|                      | RCE5C1H392J0DBH03A | C0G  | 50                 | 3900pF  | ±5%       | 3.6            | 3.5 | -  | 2.5 | 2.5  | 16.0 | 0DB            | 2000            |
|                      | RCE5C1H472J1DBH03A | C0G  | 50                 | 4700pF  | ±5%       | 4.0            | 3.5 | -  | 2.5 | 2.5  | 16.0 | 1DB            | 2000            |
|                      | RCE5C1H562J1DBH03A | C0G  | 50                 | 5600pF  | ±5%       | 4.0            | 3.5 | -  | 2.5 | 2.5  | 16.0 | 1DB            | 2000            |
|                      | RCE5C1H682J1DBH03A | C0G  | 50                 | 6800pF  | ±5%       | 4.0            | 3.5 | -  | 2.5 | 2.5  | 16.0 | 1DB            | 2000            |
|                      | RCE5C1H822J1DBH03A | C0G  | 50                 | 8200pF  | ±5%       | 4.0            | 3.5 | -  | 2.5 | 2.5  | 16.0 | 1DB            | 2000            |
|                      | RCE5C1H103J1DBH03A | C0G  | 50                 | 10000pF | ±5%       | 4.0            | 3.5 | -  | 2.5 | 2.5  | 16.0 | 1DB            | 2000            |
|                      | RCE5C1H123J1DBH03A | C0G  | 50                 | 12000pF | ±5%       | 4.0            | 3.5 | -  | 2.5 | 2.5  | 16.0 | 1DB            | 2000            |
|                      | RCE5C1H153J1DBH03A | C0G  | 50                 | 15000pF | ±5%       | 4.0            | 3.5 | -  | 2.5 | 2.5  | 16.0 | 1DB            | 2000            |
|                      | RCE5C1H183J1DBH03A | C0G  | 50                 | 18000pF | ±5%       | 4.0            | 3.5 | -  | 2.5 | 2.5  | 16.0 | 1DB            | 2000            |
|                      | RCE5C1H223J1DBH03A | C0G  | 50                 | 22000pF | ±5%       | 4.0            | 3.5 | -  | 2.5 | 2.5  | 16.0 | 1DB            | 2000            |
|                      | RCE5C1H273J2DBH03A | C0G  | 50                 | 27000pF | ±5%       | 5.5            | 4.0 | -  | 2.5 | 3.15 | 16.0 | 2DB            | 2000            |
|                      | RCE5C1H333J2DBH03A | C0G  | 50                 | 33000pF | ±5%       | 5.5            | 4.0 | -  | 2.5 | 3.15 | 16.0 | 2DB            | 2000            |
|                      | RCE5C1H393J2DBH03A | C0G  | 50                 | 39000pF | ±5%       | 5.5            | 4.0 | -  | 2.5 | 3.15 | 16.0 | 2DB            | 2000            |
|                      | RCE5C1H473J2DBH03A | C0G  | 50                 | 47000pF | ±5%       | 5.5            | 4.0 | -  | 2.5 | 3.15 | 16.0 | 2DB            | 2000            |
|                      | RCE5C1H563J2DBH03A | C0G  | 50                 | 56000pF | ±5%       | 5.5            | 4.0 | -  | 2.5 | 3.15 | 16.0 | 2DB            | 2000            |
|                      | RCE5C1H683J2DBH03A | C0G  | 50                 | 68000pF | ±5%       | 5.5            | 4.0 | -  | 2.5 | 3.15 | 16.0 | 2DB            | 2000            |
|                      | RCE5C1H823J2DBH03A | C0G  | 50                 | 82000pF | ±5%       | 5.5            | 4.0 | -  | 2.5 | 3.15 | 16.0 | 2DB            | 2000            |
|                      | RCE5C1H104J2DBH03A | C0G  | 50                 | 0.1μF   | ±5%       | 5.5            | 4.0 | -  | 2.5 | 3.15 | 16.0 | 2DB            | 2000            |
|                      | RCE5C2A1R0C0DBH03A | C0G  | 100                | 1pF     | ±0.25pF   | 3.6            | 3.5 | -  | 2.5 | 2.5  | 16.0 | 0DB            | 2000            |
|                      | RCE5C2A2R0C0DBH03A | C0G  | 100                | 2pF     | ±0.25pF   | 3.6            | 3.5 | -  | 2.5 | 2.5  | 16.0 | 0DB            | 2000            |
|                      | RCE5C2A3R0C0DBH03A | C0G  | 100                | 3pF     | ±0.25pF   | 3.6            | 3.5 | -  | 2.5 | 2.5  | 16.0 | 0DB            | 2000            |
|                      | RCE5C2A4R0C0DBH03A | C0G  | 100                | 4pF     | ±0.25pF   | 3.6            | 3.5 | -  | 2.5 | 2.5  | 16.0 | 0DB            | 2000            |
|                      | RCE5C2A5R0C0DBH03A | C0G  | 100                | 5pF     | ±0.25pF   | 3.6            | 3.5 | -  | 2.5 | 2.5  | 16.0 | 0DB            | 2000            |
|                      | RCE5C2A6R0D0DBH03A | C0G  | 100                | 6pF     | ±0.5pF    | 3.6            | 3.5 | -  | 2.5 | 2.5  | 16.0 | 0DB            | 2000            |
|                      | RCE5C2A7R0D0DBH03A | C0G  | 100                | 7pF     | ±0.5pF    | 3.6            | 3.5 | -  | 2.5 | 2.5  | 16.0 | 0DB            | 2000            |
|                      | RCE5C2A8R0D0DBH03A | C0G  | 100                | 8pF     | ±0.5pF    | 3.6            | 3.5 | -  | 2.5 | 2.5  | 16.0 | 0DB            | 2000            |
|                      | RCE5C2A9R0D0DBH03A | C0G  | 100                | 9pF     | ±0.5pF    | 3.6            | 3.5 | -  | 2.5 | 2.5  | 16.0 | 0DB            | 2000            |
|                      | RCE5C2A100J0DBH03A | C0G  | 100                | 10pF    | ±5%       | 3.6            | 3.5 | -  | 2.5 | 2.5  | 16.0 | 0DB            | 2000            |
|                      | RCE5C2A120J0DBH03A | C0G  | 100                | 12pF    | ±5%       | 3.6            | 3.5 | -  | 2.5 | 2.5  | 16.0 | 0DB            | 2000            |
|                      | RCE5C2A150J0DBH03A | C0G  | 100                | 15pF    | ±5%       | 3.6            | 3.5 | -  | 2.5 | 2.5  | 16.0 | 0DB            | 2000            |
|                      | RCE5C2A180J0DBH03A | C0G  | 100                | 18pF    | ±5%       | 3.6            | 3.5 | -  | 2.5 | 2.5  | 16.0 | 0DB            | 2000            |
|                      | RCE5C2A220J0DBH03A | C0G  | 100                | 22pF    | ±5%       | 3.6            | 3.5 | -  | 2.5 | 2.5  | 16.0 | 0DB            | 2000            |
|                      | RCE5C2A270J0DBH03A | C0G  | 100                | 27pF    | ±5%       | 3.6            | 3.5 | -  | 2.5 | 2.5  | 16.0 | 0DB            | 2000            |
|                      | RCE5C2A330J0DBH03A | C0G  | 100                | 33pF    | ±5%       | 3.6            | 3.5 | -  | 2.5 | 2.5  | 16.0 | 0DB            | 2000            |
|                      | RCE5C2A390J0DBH03A | C0G  | 100                | 39pF    | ±5%       | 3.6            | 3.5 | -  | 2.5 | 2.5  | 16.0 | 0DB            | 2000            |
|                      | RCE5C2A470J0DBH03A | C0G  | 100                | 47pF    | ±5%       | 3.6            | 3.5 | -  | 2.5 | 2.5  | 16.0 | 0DB            | 2000            |
|                      | RCE5C2A560J0DBH03A | C0G  | 100                | 56pF    | ±5%       | 3.6            | 3.5 | -  | 2.5 | 2.5  | 16.0 | 0DB            | 2000            |
|                      | RCE5C2A680J0DBH03A | C0G  | 100                | 68pF    | ±5%       | 3.6            | 3.5 | -  | 2.5 | 2.5  | 16.0 | 0DB            | 2000            |
|                      | RCE5C2A820J0DBH03A | C0G  | 100                | 82pF    | ±5%       | 3.6            | 3.5 | -  | 2.5 | 2.5  | 16.0 | 0DB            | 2000            |
|                      | RCE5C2A101J0DBH03A | C0G  | 100                | 100pF   | ±5%       | 3.6            | 3.5 | -  | 2.5 | 2.5  | 16.0 | 0DB            | 2000            |

## Reference only

• Straight Taping  
(Lead Code: D\*)

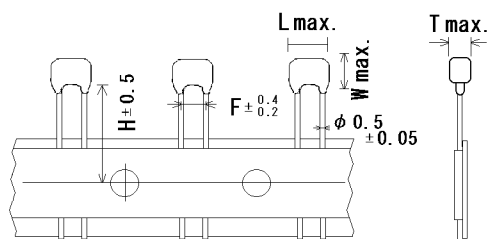

• Inside Crimp Taping  
(Lead Code: M\*)

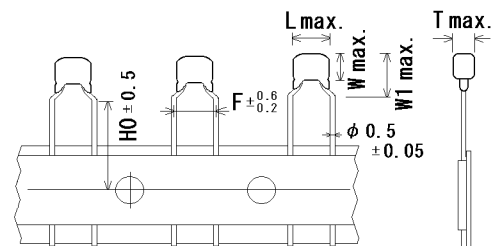

Unit : mm

| Customer Part Number | Murata Part Number | T.C. | DC Rated volt. (V) | Cap.    | Cap. tol. | Dimension (mm) |     |     |     |      |      | Size Lead Code | Pack qty. (pcs) |
|----------------------|--------------------|------|--------------------|---------|-----------|----------------|-----|-----|-----|------|------|----------------|-----------------|
|                      |                    |      |                    |         |           | L              | W   | W1  | F   | T    | H/H0 |                |                 |
|                      | RCE5C2A121J0DBH03A | COG  | 100                | 120pF   | ±5%       | 3.6            | 3.5 | -   | 2.5 | 2.5  | 16.0 | 0DB            | 2000            |
|                      | RCE5C2A151J0DBH03A | COG  | 100                | 150pF   | ±5%       | 3.6            | 3.5 | -   | 2.5 | 2.5  | 16.0 | 0DB            | 2000            |
|                      | RCE5C2A181J0DBH03A | COG  | 100                | 180pF   | ±5%       | 3.6            | 3.5 | -   | 2.5 | 2.5  | 16.0 | 0DB            | 2000            |
|                      | RCE5C2A221J0DBH03A | COG  | 100                | 220pF   | ±5%       | 3.6            | 3.5 | -   | 2.5 | 2.5  | 16.0 | 0DB            | 2000            |
|                      | RCE5C2A271J0DBH03A | COG  | 100                | 270pF   | ±5%       | 3.6            | 3.5 | -   | 2.5 | 2.5  | 16.0 | 0DB            | 2000            |
|                      | RCE5C2A331J0DBH03A | COG  | 100                | 330pF   | ±5%       | 3.6            | 3.5 | -   | 2.5 | 2.5  | 16.0 | 0DB            | 2000            |
|                      | RCE5C2A391J0DBH03A | COG  | 100                | 390pF   | ±5%       | 3.6            | 3.5 | -   | 2.5 | 2.5  | 16.0 | 0DB            | 2000            |
|                      | RCE5C2A471J0DBH03A | COG  | 100                | 470pF   | ±5%       | 3.6            | 3.5 | -   | 2.5 | 2.5  | 16.0 | 0DB            | 2000            |
|                      | RCE5C2A561J0DBH03A | COG  | 100                | 560pF   | ±5%       | 3.6            | 3.5 | -   | 2.5 | 2.5  | 16.0 | 0DB            | 2000            |
|                      | RCE5C2A681J0DBH03A | COG  | 100                | 680pF   | ±5%       | 3.6            | 3.5 | -   | 2.5 | 2.5  | 16.0 | 0DB            | 2000            |
|                      | RCE5C2A821J0DBH03A | COG  | 100                | 820pF   | ±5%       | 3.6            | 3.5 | -   | 2.5 | 2.5  | 16.0 | 0DB            | 2000            |
|                      | RCE5C2A102J0DBH03A | COG  | 100                | 1000pF  | ±5%       | 3.6            | 3.5 | -   | 2.5 | 2.5  | 16.0 | 0DB            | 2000            |
|                      | RCE5C2A122J0DBH03A | COG  | 100                | 1200pF  | ±5%       | 3.6            | 3.5 | -   | 2.5 | 2.5  | 16.0 | 0DB            | 2000            |
|                      | RCE5C2A152J0DBH03A | COG  | 100                | 1500pF  | ±5%       | 3.6            | 3.5 | -   | 2.5 | 2.5  | 16.0 | 0DB            | 2000            |
|                      | RCE5C2A182J1DBH03A | COG  | 100                | 1800pF  | ±5%       | 4.0            | 3.5 | -   | 2.5 | 2.5  | 16.0 | 1DB            | 2000            |
|                      | RCE5C2A222J1DBH03A | COG  | 100                | 2200pF  | ±5%       | 4.0            | 3.5 | -   | 2.5 | 2.5  | 16.0 | 1DB            | 2000            |
|                      | RCE5C2A272J1DBH03A | COG  | 100                | 2700pF  | ±5%       | 4.0            | 3.5 | -   | 2.5 | 2.5  | 16.0 | 1DB            | 2000            |
|                      | RCE5C2A332J1DBH03A | COG  | 100                | 3300pF  | ±5%       | 4.0            | 3.5 | -   | 2.5 | 2.5  | 16.0 | 1DB            | 2000            |
|                      | RCE5C2A392J2DBH03A | COG  | 100                | 3900pF  | ±5%       | 5.5            | 4.0 | -   | 2.5 | 3.15 | 16.0 | 2DB            | 2000            |
|                      | RCE5C2A472J2DBH03A | COG  | 100                | 4700pF  | ±5%       | 5.5            | 4.0 | -   | 2.5 | 3.15 | 16.0 | 2DB            | 2000            |
|                      | RCE5C2A562J2DBH03A | COG  | 100                | 5600pF  | ±5%       | 5.5            | 4.0 | -   | 2.5 | 3.15 | 16.0 | 2DB            | 2000            |
|                      | RCE5C2A682J2DBH03A | COG  | 100                | 6800pF  | ±5%       | 5.5            | 4.0 | -   | 2.5 | 3.15 | 16.0 | 2DB            | 2000            |
|                      | RCE5C2A822J2DBH03A | COG  | 100                | 8200pF  | ±5%       | 5.5            | 4.0 | -   | 2.5 | 3.15 | 16.0 | 2DB            | 2000            |
|                      | RCE5C2A103J2DBH03A | COG  | 100                | 10000pF | ±5%       | 5.5            | 4.0 | -   | 2.5 | 3.15 | 16.0 | 2DB            | 2000            |
|                      | RCE5C1H1R0C0M1H03A | COG  | 50                 | 1pF     | ±0.25pF   | 3.6            | 3.5 | 6.0 | 5.0 | 2.5  | 16.0 | 0M1            | 2000            |
|                      | RCE5C1H2R0C0M1H03A | COG  | 50                 | 2pF     | ±0.25pF   | 3.6            | 3.5 | 6.0 | 5.0 | 2.5  | 16.0 | 0M1            | 2000            |
|                      | RCE5C1H3R0C0M1H03A | COG  | 50                 | 3pF     | ±0.25pF   | 3.6            | 3.5 | 6.0 | 5.0 | 2.5  | 16.0 | 0M1            | 2000            |
|                      | RCE5C1H4R0C0M1H03A | COG  | 50                 | 4pF     | ±0.25pF   | 3.6            | 3.5 | 6.0 | 5.0 | 2.5  | 16.0 | 0M1            | 2000            |
|                      | RCE5C1H5R0C0M1H03A | COG  | 50                 | 5pF     | ±0.25pF   | 3.6            | 3.5 | 6.0 | 5.0 | 2.5  | 16.0 | 0M1            | 2000            |
|                      | RCE5C1H6R0D0M1H03A | COG  | 50                 | 6pF     | ±0.5pF    | 3.6            | 3.5 | 6.0 | 5.0 | 2.5  | 16.0 | 0M1            | 2000            |
|                      | RCE5C1H7R0D0M1H03A | COG  | 50                 | 7pF     | ±0.5pF    | 3.6            | 3.5 | 6.0 | 5.0 | 2.5  | 16.0 | 0M1            | 2000            |
|                      | RCE5C1H8R0D0M1H03A | COG  | 50                 | 8pF     | ±0.5pF    | 3.6            | 3.5 | 6.0 | 5.0 | 2.5  | 16.0 | 0M1            | 2000            |
|                      | RCE5C1H9R0D0M1H03A | COG  | 50                 | 9pF     | ±0.5pF    | 3.6            | 3.5 | 6.0 | 5.0 | 2.5  | 16.0 | 0M1            | 2000            |
|                      | RCE5C1H100J0M1H03A | COG  | 50                 | 10pF    | ±5%       | 3.6            | 3.5 | 6.0 | 5.0 | 2.5  | 16.0 | 0M1            | 2000            |
|                      | RCE5C1H120J0M1H03A | COG  | 50                 | 12pF    | ±5%       | 3.6            | 3.5 | 6.0 | 5.0 | 2.5  | 16.0 | 0M1            | 2000            |
|                      | RCE5C1H150J0M1H03A | COG  | 50                 | 15pF    | ±5%       | 3.6            | 3.5 | 6.0 | 5.0 | 2.5  | 16.0 | 0M1            | 2000            |
|                      | RCE5C1H180J0M1H03A | COG  | 50                 | 18pF    | ±5%       | 3.6            | 3.5 | 6.0 | 5.0 | 2.5  | 16.0 | 0M1            | 2000            |
|                      | RCE5C1H220J0M1H03A | COG  | 50                 | 22pF    | ±5%       | 3.6            | 3.5 | 6.0 | 5.0 | 2.5  | 16.0 | 0M1            | 2000            |
|                      | RCE5C1H270J0M1H03A | COG  | 50                 | 27pF    | ±5%       | 3.6            | 3.5 | 6.0 | 5.0 | 2.5  | 16.0 | 0M1            | 2000            |
|                      | RCE5C1H330J0M1H03A | COG  | 50                 | 33pF    | ±5%       | 3.6            | 3.5 | 6.0 | 5.0 | 2.5  | 16.0 | 0M1            | 2000            |

Reference only

• Inside Crimp Taping  
(Lead Code: M\*)

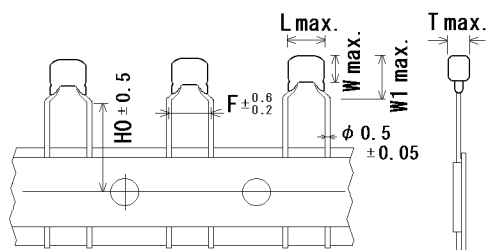

Unit : mm

| Customer Part Number | Murata Part Number | T.C. | DC Rated volt. (V) | Cap.    | Cap. tol. | Dimension (mm) |     |     |     |      |      | Size Lead Code | Pack qty. (pcs) |
|----------------------|--------------------|------|--------------------|---------|-----------|----------------|-----|-----|-----|------|------|----------------|-----------------|
|                      |                    |      |                    |         |           | L              | W   | W1  | F   | T    | H0   |                |                 |
|                      | RCE5C1H390J0M1H03A | COG  | 50                 | 39pF    | ±5%       | 3.6            | 3.5 | 6.0 | 5.0 | 2.5  | 16.0 | 0M1            | 2000            |
|                      | RCE5C1H470J0M1H03A | COG  | 50                 | 47pF    | ±5%       | 3.6            | 3.5 | 6.0 | 5.0 | 2.5  | 16.0 | 0M1            | 2000            |
|                      | RCE5C1H560J0M1H03A | COG  | 50                 | 56pF    | ±5%       | 3.6            | 3.5 | 6.0 | 5.0 | 2.5  | 16.0 | 0M1            | 2000            |
|                      | RCE5C1H680J0M1H03A | COG  | 50                 | 68pF    | ±5%       | 3.6            | 3.5 | 6.0 | 5.0 | 2.5  | 16.0 | 0M1            | 2000            |
|                      | RCE5C1H820J0M1H03A | COG  | 50                 | 82pF    | ±5%       | 3.6            | 3.5 | 6.0 | 5.0 | 2.5  | 16.0 | 0M1            | 2000            |
|                      | RCE5C1H101J0M1H03A | COG  | 50                 | 100pF   | ±5%       | 3.6            | 3.5 | 6.0 | 5.0 | 2.5  | 16.0 | 0M1            | 2000            |
|                      | RCE5C1H121J0M1H03A | COG  | 50                 | 120pF   | ±5%       | 3.6            | 3.5 | 6.0 | 5.0 | 2.5  | 16.0 | 0M1            | 2000            |
|                      | RCE5C1H151J0M1H03A | COG  | 50                 | 150pF   | ±5%       | 3.6            | 3.5 | 6.0 | 5.0 | 2.5  | 16.0 | 0M1            | 2000            |
|                      | RCE5C1H181J0M1H03A | COG  | 50                 | 180pF   | ±5%       | 3.6            | 3.5 | 6.0 | 5.0 | 2.5  | 16.0 | 0M1            | 2000            |
|                      | RCE5C1H221J0M1H03A | COG  | 50                 | 220pF   | ±5%       | 3.6            | 3.5 | 6.0 | 5.0 | 2.5  | 16.0 | 0M1            | 2000            |
|                      | RCE5C1H271J0M1H03A | COG  | 50                 | 270pF   | ±5%       | 3.6            | 3.5 | 6.0 | 5.0 | 2.5  | 16.0 | 0M1            | 2000            |
|                      | RCE5C1H331J0M1H03A | COG  | 50                 | 330pF   | ±5%       | 3.6            | 3.5 | 6.0 | 5.0 | 2.5  | 16.0 | 0M1            | 2000            |
|                      | RCE5C1H391J0M1H03A | COG  | 50                 | 390pF   | ±5%       | 3.6            | 3.5 | 6.0 | 5.0 | 2.5  | 16.0 | 0M1            | 2000            |
|                      | RCE5C1H471J0M1H03A | COG  | 50                 | 470pF   | ±5%       | 3.6            | 3.5 | 6.0 | 5.0 | 2.5  | 16.0 | 0M1            | 2000            |
|                      | RCE5C1H561J0M1H03A | COG  | 50                 | 560pF   | ±5%       | 3.6            | 3.5 | 6.0 | 5.0 | 2.5  | 16.0 | 0M1            | 2000            |
|                      | RCE5C1H681J0M1H03A | COG  | 50                 | 680pF   | ±5%       | 3.6            | 3.5 | 6.0 | 5.0 | 2.5  | 16.0 | 0M1            | 2000            |
|                      | RCE5C1H821J0M1H03A | COG  | 50                 | 820pF   | ±5%       | 3.6            | 3.5 | 6.0 | 5.0 | 2.5  | 16.0 | 0M1            | 2000            |
|                      | RCE5C1H102J0M1H03A | COG  | 50                 | 1000pF  | ±5%       | 3.6            | 3.5 | 6.0 | 5.0 | 2.5  | 16.0 | 0M1            | 2000            |
|                      | RCE5C1H122J0M1H03A | COG  | 50                 | 1200pF  | ±5%       | 3.6            | 3.5 | 6.0 | 5.0 | 2.5  | 16.0 | 0M1            | 2000            |
|                      | RCE5C1H152J0M1H03A | COG  | 50                 | 1500pF  | ±5%       | 3.6            | 3.5 | 6.0 | 5.0 | 2.5  | 16.0 | 0M1            | 2000            |
|                      | RCE5C1H182J0M1H03A | COG  | 50                 | 1800pF  | ±5%       | 3.6            | 3.5 | 6.0 | 5.0 | 2.5  | 16.0 | 0M1            | 2000            |
|                      | RCE5C1H222J0M1H03A | COG  | 50                 | 2200pF  | ±5%       | 3.6            | 3.5 | 6.0 | 5.0 | 2.5  | 16.0 | 0M1            | 2000            |
|                      | RCE5C1H272J0M1H03A | COG  | 50                 | 2700pF  | ±5%       | 3.6            | 3.5 | 6.0 | 5.0 | 2.5  | 16.0 | 0M1            | 2000            |
|                      | RCE5C1H332J0M1H03A | COG  | 50                 | 3300pF  | ±5%       | 3.6            | 3.5 | 6.0 | 5.0 | 2.5  | 16.0 | 0M1            | 2000            |
|                      | RCE5C1H392J0M1H03A | COG  | 50                 | 3900pF  | ±5%       | 3.6            | 3.5 | 6.0 | 5.0 | 2.5  | 16.0 | 0M1            | 2000            |
|                      | RCE5C1H472J1M1H03A | COG  | 50                 | 4700pF  | ±5%       | 4.0            | 3.5 | 5.0 | 5.0 | 2.5  | 16.0 | 1M1            | 2000            |
|                      | RCE5C1H562J1M1H03A | COG  | 50                 | 5600pF  | ±5%       | 4.0            | 3.5 | 5.0 | 5.0 | 2.5  | 16.0 | 1M1            | 2000            |
|                      | RCE5C1H682J1M1H03A | COG  | 50                 | 6800pF  | ±5%       | 4.0            | 3.5 | 5.0 | 5.0 | 2.5  | 16.0 | 1M1            | 2000            |
|                      | RCE5C1H822J1M1H03A | COG  | 50                 | 8200pF  | ±5%       | 4.0            | 3.5 | 5.0 | 5.0 | 2.5  | 16.0 | 1M1            | 2000            |
|                      | RCE5C1H103J1M1H03A | COG  | 50                 | 10000pF | ±5%       | 4.0            | 3.5 | 5.0 | 5.0 | 2.5  | 16.0 | 1M1            | 2000            |
|                      | RCE5C1H123J1M1H03A | COG  | 50                 | 12000pF | ±5%       | 4.0            | 3.5 | 5.0 | 5.0 | 2.5  | 16.0 | 1M1            | 2000            |
|                      | RCE5C1H153J1M1H03A | COG  | 50                 | 15000pF | ±5%       | 4.0            | 3.5 | 5.0 | 5.0 | 2.5  | 16.0 | 1M1            | 2000            |
|                      | RCE5C1H183J1M1H03A | COG  | 50                 | 18000pF | ±5%       | 4.0            | 3.5 | 5.0 | 5.0 | 2.5  | 16.0 | 1M1            | 2000            |
|                      | RCE5C1H223J1M1H03A | COG  | 50                 | 22000pF | ±5%       | 4.0            | 3.5 | 5.0 | 5.0 | 2.5  | 16.0 | 1M1            | 2000            |
|                      | RCE5C1H273J2M1H03A | COG  | 50                 | 27000pF | ±5%       | 5.5            | 4.0 | 6.0 | 5.0 | 3.15 | 16.0 | 2M1            | 2000            |
|                      | RCE5C1H333J2M1H03A | COG  | 50                 | 33000pF | ±5%       | 5.5            | 4.0 | 6.0 | 5.0 | 3.15 | 16.0 | 2M1            | 2000            |
|                      | RCE5C1H393J2M1H03A | COG  | 50                 | 39000pF | ±5%       | 5.5            | 4.0 | 6.0 | 5.0 | 3.15 | 16.0 | 2M1            | 2000            |
|                      | RCE5C1H473J2M1H03A | COG  | 50                 | 47000pF | ±5%       | 5.5            | 4.0 | 6.0 | 5.0 | 3.15 | 16.0 | 2M1            | 2000            |
|                      | RCE5C1H563J2M1H03A | COG  | 50                 | 56000pF | ±5%       | 5.5            | 4.0 | 6.0 | 5.0 | 3.15 | 16.0 | 2M1            | 2000            |
|                      | RCE5C1H683J2M1H03A | COG  | 50                 | 68000pF | ±5%       | 5.5            | 4.0 | 6.0 | 5.0 | 3.15 | 16.0 | 2M1            | 2000            |

Reference only

• Inside Crimp Taping  
(Lead Code: M\*)

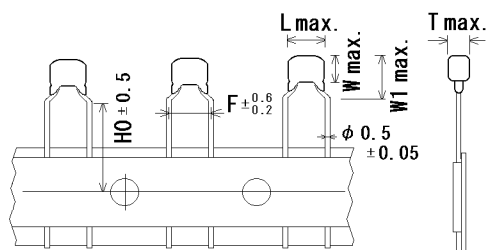

Unit : mm

| Customer Part Number | Murata Part Number | T.C. | DC Rated volt. (V) | Cap.    | Cap. tol. | Dimension (mm) |     |     |     |      |      | Size Lead Code | Pack qty. (pcs) |
|----------------------|--------------------|------|--------------------|---------|-----------|----------------|-----|-----|-----|------|------|----------------|-----------------|
|                      |                    |      |                    |         |           | L              | W   | W1  | F   | T    | H0   |                |                 |
|                      | RCE5C1H823J2M1H03A | C0G  | 50                 | 82000pF | ±5%       | 5.5            | 4.0 | 6.0 | 5.0 | 3.15 | 16.0 | 2M1            | 2000            |
|                      | RCE5C1H104J2M1H03A | C0G  | 50                 | 0.1μF   | ±5%       | 5.5            | 4.0 | 6.0 | 5.0 | 3.15 | 16.0 | 2M1            | 2000            |
|                      | RCE5C2A1R0C0M1H03A | C0G  | 100                | 1pF     | ±0.25pF   | 3.6            | 3.5 | 6.0 | 5.0 | 2.5  | 16.0 | 0M1            | 2000            |
|                      | RCE5C2A2R0C0M1H03A | C0G  | 100                | 2pF     | ±0.25pF   | 3.6            | 3.5 | 6.0 | 5.0 | 2.5  | 16.0 | 0M1            | 2000            |
|                      | RCE5C2A3R0C0M1H03A | C0G  | 100                | 3pF     | ±0.25pF   | 3.6            | 3.5 | 6.0 | 5.0 | 2.5  | 16.0 | 0M1            | 2000            |
|                      | RCE5C2A4R0C0M1H03A | C0G  | 100                | 4pF     | ±0.25pF   | 3.6            | 3.5 | 6.0 | 5.0 | 2.5  | 16.0 | 0M1            | 2000            |
|                      | RCE5C2A5R0C0M1H03A | C0G  | 100                | 5pF     | ±0.25pF   | 3.6            | 3.5 | 6.0 | 5.0 | 2.5  | 16.0 | 0M1            | 2000            |
|                      | RCE5C2A6R0D0M1H03A | C0G  | 100                | 6pF     | ±0.5pF    | 3.6            | 3.5 | 6.0 | 5.0 | 2.5  | 16.0 | 0M1            | 2000            |
|                      | RCE5C2A7R0D0M1H03A | C0G  | 100                | 7pF     | ±0.5pF    | 3.6            | 3.5 | 6.0 | 5.0 | 2.5  | 16.0 | 0M1            | 2000            |
|                      | RCE5C2A8R0D0M1H03A | C0G  | 100                | 8pF     | ±0.5pF    | 3.6            | 3.5 | 6.0 | 5.0 | 2.5  | 16.0 | 0M1            | 2000            |
|                      | RCE5C2A9R0D0M1H03A | C0G  | 100                | 9pF     | ±0.5pF    | 3.6            | 3.5 | 6.0 | 5.0 | 2.5  | 16.0 | 0M1            | 2000            |
|                      | RCE5C2A100J0M1H03A | C0G  | 100                | 10pF    | ±5%       | 3.6            | 3.5 | 6.0 | 5.0 | 2.5  | 16.0 | 0M1            | 2000            |
|                      | RCE5C2A120J0M1H03A | C0G  | 100                | 12pF    | ±5%       | 3.6            | 3.5 | 6.0 | 5.0 | 2.5  | 16.0 | 0M1            | 2000            |
|                      | RCE5C2A150J0M1H03A | C0G  | 100                | 15pF    | ±5%       | 3.6            | 3.5 | 6.0 | 5.0 | 2.5  | 16.0 | 0M1            | 2000            |
|                      | RCE5C2A180J0M1H03A | C0G  | 100                | 18pF    | ±5%       | 3.6            | 3.5 | 6.0 | 5.0 | 2.5  | 16.0 | 0M1            | 2000            |
|                      | RCE5C2A220J0M1H03A | C0G  | 100                | 22pF    | ±5%       | 3.6            | 3.5 | 6.0 | 5.0 | 2.5  | 16.0 | 0M1            | 2000            |
|                      | RCE5C2A270J0M1H03A | C0G  | 100                | 27pF    | ±5%       | 3.6            | 3.5 | 6.0 | 5.0 | 2.5  | 16.0 | 0M1            | 2000            |
|                      | RCE5C2A330J0M1H03A | C0G  | 100                | 33pF    | ±5%       | 3.6            | 3.5 | 6.0 | 5.0 | 2.5  | 16.0 | 0M1            | 2000            |
|                      | RCE5C2A390J0M1H03A | C0G  | 100                | 39pF    | ±5%       | 3.6            | 3.5 | 6.0 | 5.0 | 2.5  | 16.0 | 0M1            | 2000            |
|                      | RCE5C2A470J0M1H03A | C0G  | 100                | 47pF    | ±5%       | 3.6            | 3.5 | 6.0 | 5.0 | 2.5  | 16.0 | 0M1            | 2000            |
|                      | RCE5C2A560J0M1H03A | C0G  | 100                | 56pF    | ±5%       | 3.6            | 3.5 | 6.0 | 5.0 | 2.5  | 16.0 | 0M1            | 2000            |
|                      | RCE5C2A680J0M1H03A | C0G  | 100                | 68pF    | ±5%       | 3.6            | 3.5 | 6.0 | 5.0 | 2.5  | 16.0 | 0M1            | 2000            |
|                      | RCE5C2A820J0M1H03A | C0G  | 100                | 82pF    | ±5%       | 3.6            | 3.5 | 6.0 | 5.0 | 2.5  | 16.0 | 0M1            | 2000            |
|                      | RCE5C2A101J0M1H03A | C0G  | 100                | 100pF   | ±5%       | 3.6            | 3.5 | 6.0 | 5.0 | 2.5  | 16.0 | 0M1            | 2000            |
|                      | RCE5C2A121J0M1H03A | C0G  | 100                | 120pF   | ±5%       | 3.6            | 3.5 | 6.0 | 5.0 | 2.5  | 16.0 | 0M1            | 2000            |
|                      | RCE5C2A151J0M1H03A | C0G  | 100                | 150pF   | ±5%       | 3.6            | 3.5 | 6.0 | 5.0 | 2.5  | 16.0 | 0M1            | 2000            |
|                      | RCE5C2A181J0M1H03A | C0G  | 100                | 180pF   | ±5%       | 3.6            | 3.5 | 6.0 | 5.0 | 2.5  | 16.0 | 0M1            | 2000            |
|                      | RCE5C2A221J0M1H03A | C0G  | 100                | 220pF   | ±5%       | 3.6            | 3.5 | 6.0 | 5.0 | 2.5  | 16.0 | 0M1            | 2000            |
|                      | RCE5C2A271J0M1H03A | C0G  | 100                | 270pF   | ±5%       | 3.6            | 3.5 | 6.0 | 5.0 | 2.5  | 16.0 | 0M1            | 2000            |
|                      | RCE5C2A331J0M1H03A | C0G  | 100                | 330pF   | ±5%       | 3.6            | 3.5 | 6.0 | 5.0 | 2.5  | 16.0 | 0M1            | 2000            |
|                      | RCE5C2A391J0M1H03A | C0G  | 100                | 390pF   | ±5%       | 3.6            | 3.5 | 6.0 | 5.0 | 2.5  | 16.0 | 0M1            | 2000            |
|                      | RCE5C2A471J0M1H03A | C0G  | 100                | 470pF   | ±5%       | 3.6            | 3.5 | 6.0 | 5.0 | 2.5  | 16.0 | 0M1            | 2000            |
|                      | RCE5C2A561J0M1H03A | C0G  | 100                | 560pF   | ±5%       | 3.6            | 3.5 | 6.0 | 5.0 | 2.5  | 16.0 | 0M1            | 2000            |
|                      | RCE5C2A681J0M1H03A | C0G  | 100                | 680pF   | ±5%       | 3.6            | 3.5 | 6.0 | 5.0 | 2.5  | 16.0 | 0M1            | 2000            |
|                      | RCE5C2A821J0M1H03A | C0G  | 100                | 820pF   | ±5%       | 3.6            | 3.5 | 6.0 | 5.0 | 2.5  | 16.0 | 0M1            | 2000            |
|                      | RCE5C2A102J0M1H03A | C0G  | 100                | 1000pF  | ±5%       | 3.6            | 3.5 | 6.0 | 5.0 | 2.5  | 16.0 | 0M1            | 2000            |
|                      | RCE5C2A122J0M1H03A | C0G  | 100                | 1200pF  | ±5%       | 3.6            | 3.5 | 6.0 | 5.0 | 2.5  | 16.0 | 0M1            | 2000            |
|                      | RCE5C2A152J0M1H03A | C0G  | 100                | 1500pF  | ±5%       | 3.6            | 3.5 | 6.0 | 5.0 | 2.5  | 16.0 | 0M1            | 2000            |
|                      | RCE5C2A182J1M1H03A | C0G  | 100                | 1800pF  | ±5%       | 4.0            | 3.5 | 5.0 | 5.0 | 2.5  | 16.0 | 1M1            | 2000            |
|                      | RCE5C2A222J1M1H03A | C0G  | 100                | 2200pF  | ±5%       | 4.0            | 3.5 | 5.0 | 5.0 | 2.5  | 16.0 | 1M1            | 2000            |



Reference only

• Inside Crimp Taping  
(Lead Code: M\*)

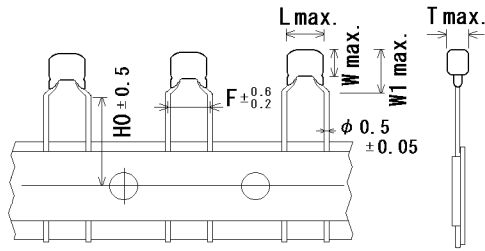

Unit : mm

| Customer Part Number | Murata Part Number | T.C. | DC Rated volt. (V) | Cap.    | Cap. tol. | Dimension (mm) |     |     |     |      |      | Size Lead Code | Pack qty. (pcs) |
|----------------------|--------------------|------|--------------------|---------|-----------|----------------|-----|-----|-----|------|------|----------------|-----------------|
|                      |                    |      |                    |         |           | L              | W   | W1  | F   | T    | H0   |                |                 |
|                      | RCE5C2A272J1M1H03A | C0G  | 100                | 2700pF  | ±5%       | 4.0            | 3.5 | 5.0 | 5.0 | 2.5  | 16.0 | 1M1            | 2000            |
|                      | RCE5C2A332J1M1H03A | C0G  | 100                | 3300pF  | ±5%       | 4.0            | 3.5 | 5.0 | 5.0 | 2.5  | 16.0 | 1M1            | 2000            |
|                      | RCE5C2A392J2M1H03A | C0G  | 100                | 3900pF  | ±5%       | 5.5            | 4.0 | 6.0 | 5.0 | 3.15 | 16.0 | 2M1            | 2000            |
|                      | RCE5C2A472J2M1H03A | C0G  | 100                | 4700pF  | ±5%       | 5.5            | 4.0 | 6.0 | 5.0 | 3.15 | 16.0 | 2M1            | 2000            |
|                      | RCE5C2A562J2M1H03A | C0G  | 100                | 5600pF  | ±5%       | 5.5            | 4.0 | 6.0 | 5.0 | 3.15 | 16.0 | 2M1            | 2000            |
|                      | RCE5C2A682J2M1H03A | C0G  | 100                | 6800pF  | ±5%       | 5.5            | 4.0 | 6.0 | 5.0 | 3.15 | 16.0 | 2M1            | 2000            |
|                      | RCE5C2A822J2M1H03A | C0G  | 100                | 8200pF  | ±5%       | 5.5            | 4.0 | 6.0 | 5.0 | 3.15 | 16.0 | 2M1            | 2000            |
|                      | RCE5C2A103J2M1H03A | C0G  | 100                | 10000pF | ±5%       | 5.5            | 4.0 | 6.0 | 5.0 | 3.15 | 16.0 | 2M1            | 2000            |

**Reference only**

| 5. AEC-Q200 Murata Standard Specifications and Test Methods |                                     |                    |   |            |   |   |   |   |                            |            |            |            |            |             |            |   |            |   |
|---|-------------------------------------|--------------------|---|------------|---|---|---|---|----------------------------|------------|------------|------------|------------|-------------|------------|---|------------|---|
| No.   | AEC-Q200 Test Item                  | Specification      | AEC-Q200 Test Method  |            |   |   |   |   |                            |            |            |            |            |             |            |   |            |   |
| 1   | Pre-and Post-Stress Electrical Test |                    | -   |            |   |   |   |   |                            |            |            |            |            |             |            |   |            |   |
| 2   | High Temperature Exposure (Storage) | Appearance         | No defects or abnormalities   |            |   |   |   |   |                            |            |            |            |            |             |            |   |            |   |
|   |                                     | Capacitance Change | Within $\pm 3\%$ or $\pm 0.3\text{pF}$ (Whichever is larger)  |            |   |   |   |   |                            |            |            |            |            |             |            |   |            |   |
|   |                                     | Q                  | $30\text{pF} \leq C : Q \geq 350$<br>$10\text{pF} \leq C < 30\text{pF} : Q \geq 275+5C/2$<br>$10\text{pF} > C : Q \geq 200+10C$<br>C : Nominal Capacitance (pF)   |            |   |   |   |   |                            |            |            |            |            |             |            |   |            |   |
|   |                                     | I.R.               | More than $1,000\text{M}\Omega$ or $50\text{M}\Omega \cdot \mu\text{F}$ (Whichever is smaller)  |            |   |   |   |   |                            |            |            |            |            |             |            |   |            |   |
|   |                                     |                    | Sit the capacitor for $1,000 \pm 12\text{h}$ at $150 \pm 3^\circ\text{C}$ . Let sit for $24 \pm 2\text{h}$ at *room condition, then measure.  |            |   |   |   |   |                            |            |            |            |            |             |            |   |            |   |
| 3   | Temperature Cycling                 | Appearance         | No defects or abnormalities   |            |   |   |   |   |                            |            |            |            |            |             |            |   |            |   |
|   |                                     | Capacitance Change | Within $\pm 5\%$ or $\pm 0.5\text{pF}$ (Whichever is larger)  |            |   |   |   |   |                            |            |            |            |            |             |            |   |            |   |
|   |                                     | Q                  | $30\text{pF} \leq C : Q \geq 350$<br>$10\text{pF} \leq C < 30\text{pF} : Q \geq 275+5C/2$<br>$10\text{pF} > C : Q \geq 200+10C$<br>C : Nominal Capacitance (pF)   |            |   |   |   |   |                            |            |            |            |            |             |            |   |            |   |
|   |                                     | I.R.               | $1,000\text{M}\Omega$ or $50\text{M}\Omega \cdot \mu\text{F}$ min. (Whichever is smaller)   |            |   |   |   |   |                            |            |            |            |            |             |            |   |            |   |
|   |                                     |                    | Perform the 1,000 cycles according to the four heat treatments listed in the following table. Let sit for $24 \pm 2\text{h}$ at *room condition, then measure.  |            |   |   |   |   |                            |            |            |            |            |             |            |   |            |   |
|   |                                     |                    | <table border="1"> <thead> <tr> <th>Step</th> <th>1</th> <th>2</th> <th>3</th> <th>4</th> </tr> </thead> <tbody> <tr> <td>Temp. (<math>^\circ\text{C}</math>)</td> <td><math>-55+0/-3</math></td> <td>Room Temp.</td> <td><math>125+3/-0</math></td> <td>Room Temp.</td> </tr> <tr> <td>Time (min.)</td> <td><math>15 \pm 3</math></td> <td>1</td> <td><math>15 \pm 3</math></td> <td>1</td> </tr> </tbody> </table>  | Step       | 1 | 2 | 3 | 4 | Temp. ( $^\circ\text{C}$ ) | $-55+0/-3$ | Room Temp. | $125+3/-0$ | Room Temp. | Time (min.) | $15 \pm 3$ | 1 | $15 \pm 3$ | 1 |
| Step  | 1                                   | 2                  | 3   | 4          |   |   |   |   |                            |            |            |            |            |             |            |   |            |   |
| Temp. ( $^\circ\text{C}$ )                                  | $-55+0/-3$                          | Room Temp.         | $125+3/-0$  | Room Temp. |   |   |   |   |                            |            |            |            |            |             |            |   |            |   |
| Time (min.)   | $15 \pm 3$                          | 1                  | $15 \pm 3$  | 1          |   |   |   |   |                            |            |            |            |            |             |            |   |            |   |
| 4   | Moisture Resistance                 | Appearance         | No defects or abnormalities   |            |   |   |   |   |                            |            |            |            |            |             |            |   |            |   |
|   |                                     | Capacitance Change | Within $\pm 5\%$ or $\pm 0.5\text{pF}$ (Whichever is larger)  |            |   |   |   |   |                            |            |            |            |            |             |            |   |            |   |
|   |                                     | Q                  | $30\text{pF} \leq C : Q \geq 200$<br>$30\text{pF} > C : Q \geq 100+10C/3$<br>C : Nominal Capacitance(pF)  |            |   |   |   |   |                            |            |            |            |            |             |            |   |            |   |
|   |                                     | I.R.               | $500\text{M}\Omega$ or $25\text{M}\Omega \cdot \mu\text{F}$ min. (Whichever is smaller)   |            |   |   |   |   |                            |            |            |            |            |             |            |   |            |   |
|   |                                     |                    | Apply the 24h heat ( $25$ to $65^\circ\text{C}$ ) and humidity (80 to 98%) treatment shown below, 10 consecutive times. Let sit for $24 \pm 2\text{h}$ at *room condition, then measure.  |            |   |   |   |   |                            |            |            |            |            |             |            |   |            |   |
|   |                                     |                    | <p>Temperature (<math>^\circ\text{C}</math>)</p> <p>Humidity 90-98%</p> <p>Humidity 80-98%</p> <p>Humidity 90-98%</p> <p>Humidity 80-98%</p> <p>Humidity 90-98%</p> <p>Temperature</p> <p>70</p> <p>65</p> <p>60</p> <p>55</p> <p>50</p> <p>45</p> <p>40</p> <p>35</p> <p>30</p> <p>25</p> <p>20</p> <p>15</p> <p>10</p> <p>5</p> <p>0</p> <p>-5</p> <p>-10</p> <p>Initial measurement</p> <p>+10</p> <p>- 2 <math>^\circ\text{C}</math></p> <p>One cycle 24 hours</p> <p>Hours</p> <p>0 1 2 3 4 5 6 7 8 9 10 11 12 13 14 15 16 17 18 19 20 21 22 23 24</p> |            |   |   |   |   |                            |            |            |            |            |             |            |   |            |   |
| 5   | Biased Humidity                     | Appearance         | No defects or abnormalities   |            |   |   |   |   |                            |            |            |            |            |             |            |   |            |   |
|   |                                     | Capacitance Change | Within $\pm 5\%$ or $\pm 0.5\text{pF}$ (Whichever is larger)  |            |   |   |   |   |                            |            |            |            |            |             |            |   |            |   |
|   |                                     | Q                  | $30\text{pF} \leq C : Q \geq 200$<br>$30\text{pF} > C : Q \geq 100+10C/3$<br>C : Nominal Capacitance(pF)  |            |   |   |   |   |                            |            |            |            |            |             |            |   |            |   |
|   |                                     | I.R.               | $500\text{M}\Omega$ or $25\text{M}\Omega \cdot \mu\text{F}$ min. (Whichever is smaller)   |            |   |   |   |   |                            |            |            |            |            |             |            |   |            |   |
|   |                                     |                    | Apply the rated voltage and DC $1.3+0.2/-0\text{V}$ (add $100\text{k}\Omega$ resistor) at $85 \pm 3^\circ\text{C}$ and 80 to 85% humidity for $1,000 \pm 12\text{h}$ . Remove and let sit for $24 \pm 2\text{h}$ at *room condition, then measure. The charge/discharge current is less than 50mA.  |            |   |   |   |   |                            |            |            |            |            |             |            |   |            |   |
| 6   | Operational Life                    | Appearance         | No defects or abnormalities   |            |   |   |   |   |                            |            |            |            |            |             |            |   |            |   |
|   |                                     | Capacitance Change | Within $\pm 3\%$ or $\pm 0.3\text{pF}$ (Whichever is larger)  |            |   |   |   |   |                            |            |            |            |            |             |            |   |            |   |
|   |                                     | Q                  | $30\text{pF} \leq C : Q \geq 350$<br>$10\text{pF} \leq C < 30\text{pF} : Q \geq 275+5C/2$<br>$10\text{pF} > C : Q \geq 200+10C$<br>C : Nominal Capacitance (pF)   |            |   |   |   |   |                            |            |            |            |            |             |            |   |            |   |
|   |                                     | I.R.               | $1,000\text{M}\Omega$ or $50\text{M}\Omega \cdot \mu\text{F}$ min. (Whichever is smaller)   |            |   |   |   |   |                            |            |            |            |            |             |            |   |            |   |
|   |                                     |                    | Apply 200% of the rated voltage for $1,000 \pm 12\text{h}$ at $125 \pm 3^\circ\text{C}$ . Let sit for $24 \pm 2\text{h}$ at *room condition, then measure. The charge/discharge current is less than 50mA.  |            |   |   |   |   |                            |            |            |            |            |             |            |   |            |   |

\* "room condition" Temperature:  $15$  to  $35^\circ\text{C}$ , Relative humidity:  $45$  to  $75\%$ , Atmosphere pressure:  $86$  to  $106\text{kPa}$

## Reference only

| No.  | AEC-Q200 Test Item                                   | Specification                           | AEC-Q200 Test Method   |
|------|--|---|--|
| 7    | External Visual                                      | No defects or abnormalities             | Visual inspection  |
| 8    | Physical Dimension                                   | Within the specified dimensions         | Using calipers and micrometers.  |
| 9    | Marking  | To be easily legible.                   | Visual inspection  |
| 10   | Resistance to Solvents                               | Appearance                              | Per MIL-STD-202 Method 215<br>Solvent 1 : 1 part (by volume) of isopropyl alcohol<br>3 parts (by volume) of mineral spirits<br>Solvent 2 : Terpene defluxer<br>Solvent 3 : 42 parts (by volume) of water<br>1part (by volume) of propylene glycol monomethyl ether<br>1 part (by volume) of monoethanolamine   |
|      |  | Capacitance                             |  |
|      |  | Q                                       |  |
|      |  | I.R.                                    |  |
| 11   | Mechanical Shock                                     | Appearance                              | Three shocks in each direction should be applied along 3 mutually perpendicular axes of the test specimen (18 shocks). The specified test pulse should be Half-sine and should have a duration :0.5ms, peak value:1,500G and velocity change: 4.7m/s.  |
|      |  | Capacitance                             |  |
|      |  | Q                                       |  |
| 12   | Vibration  | Appearance                              | The capacitor should be subjected to a simple harmonic motion having a total amplitude of 1.5mm, the frequency being varied uniformly between the approximate limits of 10 and 2,000Hz. The frequency range, from 10 to 2,000Hz and return to 10Hz, should be traversed in approximately 20 min. This motion should be applied for 12 items in each 3 mutually perpendicular directions (total of 36 times). |
|      |  | Capacitance                             |  |
|      |  | Q                                       |  |
| 13-1 | Resistance to Soldering Heat (Non-Preheat)           | Appearance                              | The lead wires should be immersed in the melted solder 1.5 to 2.0mm from the root of terminal at 260±5°C for 10±1 seconds.<br><br>• Post-treatment<br>Capacitor should be stored for 24±2 hours at *room condition.  |
|      |  | Capacitance Change                      |  |
|      |  | Dielectric Strength (Between terminals) |  |
| 13-2 | Resistance to Soldering Heat (On-Preheat)            | Appearance                              | First the capacitor should be stored at 120+0/-5°C for 60+0/-5 seconds.<br>Then, the lead wires should be immersed in the melted solder 1.5 to 2.0mm from the root of terminal at 260±5°C for 7.5+0/-1 seconds.<br><br>• Post-treatment<br>Capacitor should be stored for 24±2 hours at *room condition.   |
|      |  | Capacitance Change                      |  |
|      |  | Dielectric Strength (Between terminals) |  |
| 13-3 | Resistance to Soldering Heat (soldering iron method) | Appearance                              | Test condition<br>Temperature of iron-tip : 350±10°C<br>Soldering time : 3.5±0.5 seconds<br>Soldering position<br>Straight Lead:1.5 to 2.0mm from the root of terminal.<br>Crimp Lead:1.5 to 2.0mm from the end of lead bend.<br><br>• Post-treatment<br>Capacitor should be stored for 24±2 hours at *room condition.   |
|      |  | Capacitance Change                      |  |
|      |  | Dielectric Strength (Between terminals) |  |
| 14   | Thermal Shock  | Appearance                              | Perform the 300 cycles according to the two heat treatments listed in the following table(Maximum transfer time is 20s.). Let sit for 24±2 h at *room condition, then measure.   |
|      |  | Capacitance Change                      |  |
|      |  | Q                                       |  |
|      |  | I.R.                                    |  |

\* "room condition" Temperature:15 to 35°C, Relative humidity:45 to 75%, Atmosphere pressure:86 to 106kPa

| Step        | 1        | 2        |
|-------------|----------|----------|
| Temp. (°C)  | -55+0/-3 | 125+3/-0 |
| Time (min.) | 15±3     | 15±3     |

## Reference only

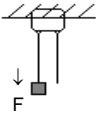
| No.  | AEC-Q200 Test Item  | Specifications   | AEC-Q200 Test Method   |  |                            |           |            |                 |                |                  |            |                |                     |   |            |
|--|---|--|--|--|----------------------------|-----------|------------|-----------------|----------------|------------------|------------|----------------|---------------------|---|------------|
| 15   | ESD   | Appearance   | No defects or abnormalities  | Per AEC-Q200-002   |                            |           |            |                 |                |                  |            |                |                     |   |            |
|  |   | Capacitance  | Within the specified tolerance   |  |                            |           |            |                 |                |                  |            |                |                     |   |            |
|  |   | Q  | $30\text{pF} \leq C : Q \geq 1,000$<br>$30\text{pF} > C : Q \geq 400+20C$<br>C : Nominal Capacitance (pF)  |  |                            |           |            |                 |                |                  |            |                |                     |   |            |
|  |   | I.R.   | More than 10,000M $\Omega$ or 500 M $\Omega$ · $\mu$ F (Whichever is smaller)  |  |                            |           |            |                 |                |                  |            |                |                     |   |            |
| 16   | Solderability   | Lead wire should be soldered with uniform coating on the axial direction over 95% of the circumferential direction.  | Should be placed into steam aging for 8h $\pm$ 15 min.<br>The terminal of capacitor is dipped into a solution of ethanol (JIS K 8101) and rosin (JIS K 5902) (25% rosin in weight proportion). Immerse in solder solution for 2 $\pm$ 0.5 seconds.<br>In both cases the depth of dipping is up to about 1.5 to 2mm from the terminal body.<br>Temp. of solder :<br>245 $\pm$ 5 $^{\circ}$ C Lead Free Solder(Sn-3.0Ag-0.5Cu)<br>235 $\pm$ 5 $^{\circ}$ C H60A or H63A Eutectic Solder  |  |                            |           |            |                 |                |                  |            |                |                     |   |            |
| 17   | Electrical Characterization   | Appearance   | No defects or abnormalities  | Visual inspection.   |                            |           |            |                 |                |                  |            |                |                     |   |            |
|  |   | Capacitance  | Within the specified tolerance   | The capacitance, Q should be measured at 25 $^{\circ}$ C at the frequency and voltage shown in the table. <table border="1" style="margin: 5px auto; border-collapse: collapse;"> <thead> <tr> <th>Nominal Cap.</th> <th>Frequency</th> <th>Voltage</th> </tr> </thead> <tbody> <tr> <td>C <math>\leq</math> 1000pF</td> <td>1<math>\pm</math>0.1MHz</td> <td>AC0.5 to 5V(rms)</td> </tr> <tr> <td>C &gt; 1000pF</td> <td>1<math>\pm</math>0.1kHz</td> <td>AC1<math>\pm</math>0.2V(rms)</td> </tr> </tbody> </table> | Nominal Cap.               | Frequency | Voltage    | C $\leq$ 1000pF | 1 $\pm$ 0.1MHz | AC0.5 to 5V(rms) | C > 1000pF | 1 $\pm$ 0.1kHz | AC1 $\pm$ 0.2V(rms) |   |            |
|  |   | Nominal Cap.   | Frequency  |  | Voltage                    |           |            |                 |                |                  |            |                |                     |   |            |
|  |   | C $\leq$ 1000pF  | 1 $\pm$ 0.1MHz   | AC0.5 to 5V(rms)   |                            |           |            |                 |                |                  |            |                |                     |   |            |
|  |   | C > 1000pF   | 1 $\pm$ 0.1kHz   | AC1 $\pm$ 0.2V(rms)  |                            |           |            |                 |                |                  |            |                |                     |   |            |
| Q  | $30\text{pF} \leq C : Q \geq 1,000$<br>$30\text{pF} > C : Q \geq 400+20C$<br>C : Nominal Capacitance (pF) |  |  |  |                            |           |            |                 |                |                  |            |                |                     |   |            |
| I.R.   | Between Terminals   | 10,000M $\Omega$ or 500M $\Omega$ · $\mu$ F min. (Whichever is smaller)  | The insulation resistance should be measured with a DC voltage not exceeding the rated voltage at 25 $^{\circ}$ C within 2 min. of charging.   |  |                            |           |            |                 |                |                  |            |                |                     |   |            |
| Dielectric Strength  | Between Terminals   | No defects or abnormalities  | The capacitor should not be damaged when DC voltage of 300% of the rated voltage is applied between the terminations for 1 to 5 seconds.<br>(Charge/Discharge current $\leq$ 50mA.)  |  |                            |           |            |                 |                |                  |            |                |                     |   |            |
|  | Body Insulation   | No defects or abnormalities  | The capacitor is placed in a container with metal balls of 1mm diameter so that each terminal, short-circuit is kept approximately 2mm from the balls, and 250% of the rated DC voltage is impressed for 1 to 5 seconds between capacitor terminals and metal balls.<br>(Charge/Discharge current $\leq$ 50mA.)  |  |                            |           |            |                 |                |                  |            |                |                     |   |            |
| 18   | Terminal Strength   | Tensile Strength   | Termination not to be broken or loosened   | As in the figure, fix the capacitor body, apply the force gradually to each lead in the radial direction of the capacitor until reaching 10N and then keep the force applied for 10 $\pm$ 1 seconds. <div style="text-align: center; margin-top: 10px;">  </div>  |                            |           |            |                 |                |                  |            |                |                     |   |            |
|  |   | Bending Strength   | Termination not to be broken or loosened   | Each lead wire should be subjected to a force of 2.5N and then be bent 90 $^{\circ}$ at the point of egress in one direction. Each wire is then returned to the original position and bent 90 $^{\circ}$ in the opposite direction at the rate of one bend per 2 to 3 seconds.   |                            |           |            |                 |                |                  |            |                |                     |   |            |
| 19   | Capacitance Temperature Characteristics   | Within the specified Tolerance.<br>$25^{\circ}\text{C} \sim 125^{\circ}\text{C} : 0 \pm 30 \text{ppm}/^{\circ}\text{C}$<br>$-55^{\circ}\text{C} \sim 25^{\circ}\text{C} : 0 + 30 / - 72 \text{ppm}/^{\circ}\text{C}$ | The capacitance change should be measured after 5min. at each specified temperature step. <table border="1" style="margin: 5px auto; border-collapse: collapse;"> <thead> <tr> <th>Step</th> <th>Temperature(<math>^{\circ}</math>C)</th> </tr> </thead> <tbody> <tr> <td>1</td> <td>25<math>\pm</math>2</td> </tr> <tr> <td>2</td> <td>-55<math>\pm</math>3</td> </tr> <tr> <td>3</td> <td>25<math>\pm</math>2</td> </tr> <tr> <td>4</td> <td>125<math>\pm</math>3</td> </tr> <tr> <td>5</td> <td>25<math>\pm</math>2</td> </tr> </tbody> </table> <p>The temperature coefficient is determined using the capacitance measured in step 3 as a reference. When cycling the temperature sequentially from step 1 through 5 (-55<math>^{\circ}</math>C to +125<math>^{\circ}</math>C) the capacitance should be within the specified tolerance for the temperature coefficient and capacitance change as Table A. The capacitance drift is calculated by dividing the differences between the maximum and minimum measured values in the step 1, 3 and 5 by the capacitance value in step 3.</p> | Step   | Temperature( $^{\circ}$ C) | 1         | 25 $\pm$ 2 | 2               | -55 $\pm$ 3    | 3                | 25 $\pm$ 2 | 4              | 125 $\pm$ 3         | 5 | 25 $\pm$ 2 |
| Step   | Temperature( $^{\circ}$ C)  |  |  |  |                            |           |            |                 |                |                  |            |                |                     |   |            |
| 1  | 25 $\pm$ 2  |  |  |  |                            |           |            |                 |                |                  |            |                |                     |   |            |
| 2  | -55 $\pm$ 3   |  |  |  |                            |           |            |                 |                |                  |            |                |                     |   |            |
| 3  | 25 $\pm$ 2  |  |  |  |                            |           |            |                 |                |                  |            |                |                     |   |            |
| 4  | 125 $\pm$ 3   |  |  |  |                            |           |            |                 |                |                  |            |                |                     |   |            |
| 5  | 25 $\pm$ 2  |  |  |  |                            |           |            |                 |                |                  |            |                |                     |   |            |
| * "room condition" Temperature: 15 to 35 $^{\circ}$ C, Relative humidity: 45 to 75%, Atmosphere pressure: 86 to 106kPa |   |  |  |  |                            |           |            |                 |                |                  |            |                |                     |   |            |

Reference only

6. Packing specification

- Bulk type (Packing style code : B)

The number of packing =  $\frac{\text{Packing quantity}}{\text{Packing quantity}} \times n$

The size of packing case and packing way

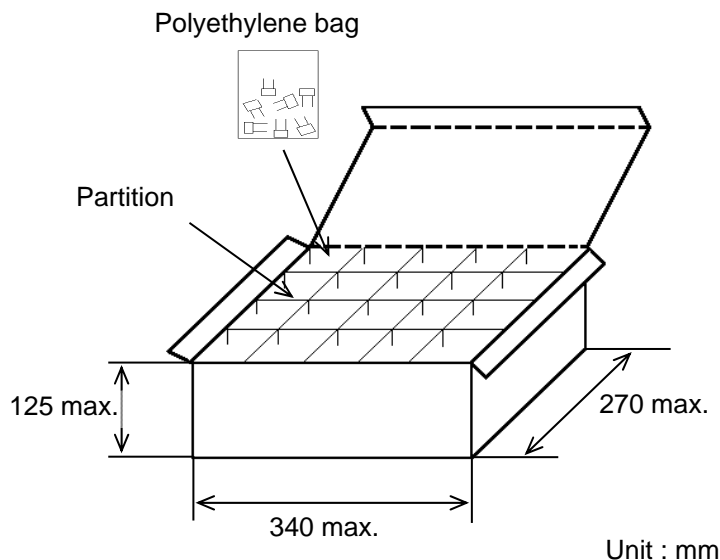

- \*1 : Please refer to [Part number list].
- \*2 : Standard n = 20 (bag)

Note)  
The outer package and the number of outer packing be changed by the order getting amount.

- Ammo pack taping type (Packing style code : A)

- A crease is made every 25 pitches, and the tape with capacitors is packed zigzag into a case.
- When body of the capacitor is piled on other body under it.

The size of packing case and packing way

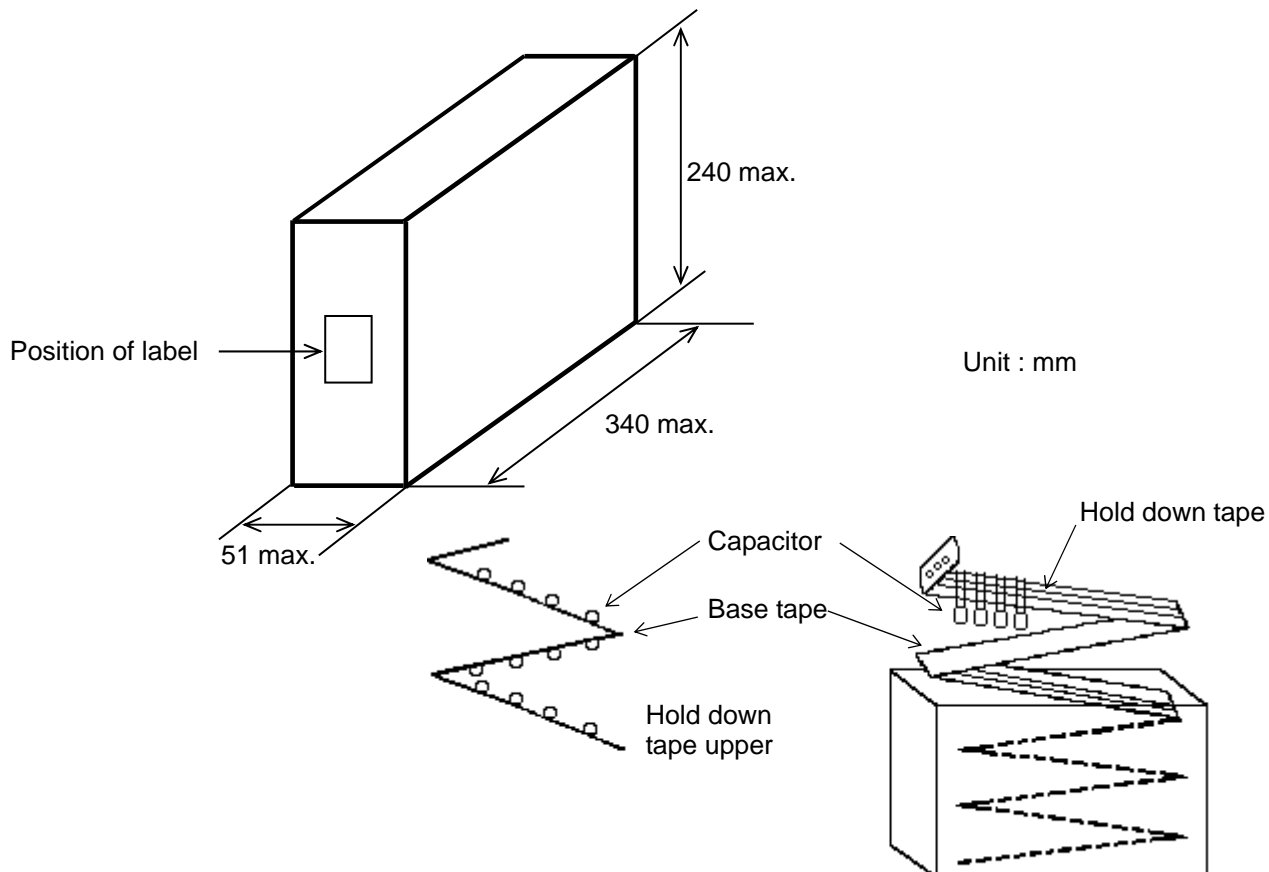

## Reference only

### 7. Taping specification

#### 7-1. Dimension of capacitors on tape

Inside crimp taping type < Lead code : M1 >

Pitch of component 12.7mm / Lead spacing 5.0mm

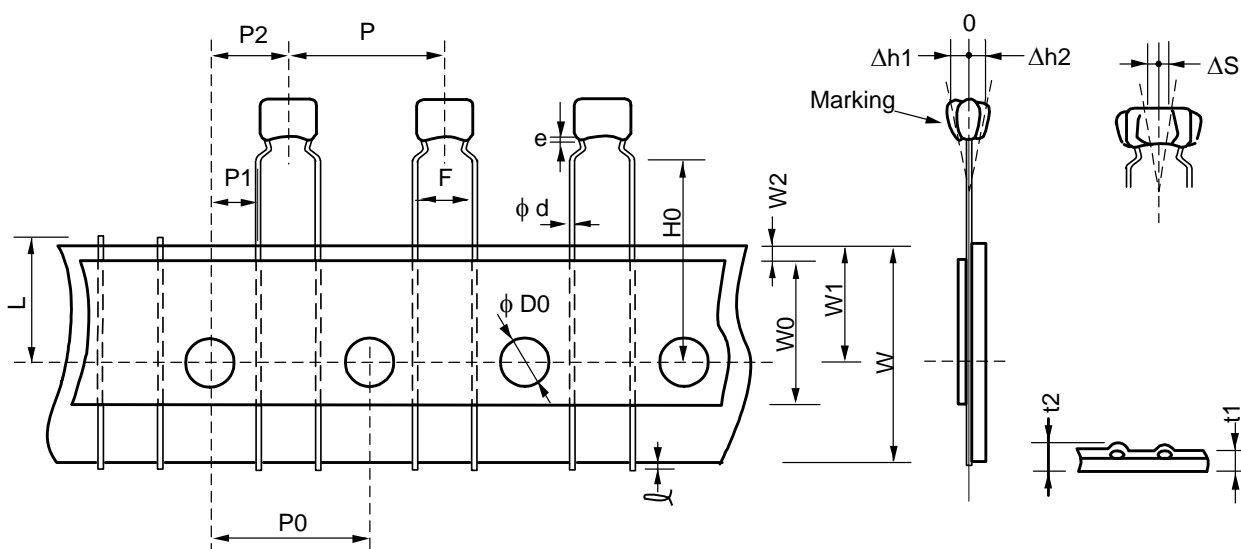

Unit : mm

| Item   | Code | Dimensions                    | Remarks                                |
|--|------|-------------------------------|--|
| Pitch of component                               | P    | 12.7+/-1.0                    |  |
| Pitch of sprocket hole                           | P0   | 12.7+/-0.2                    |  |
| Lead spacing                                     | F    | 5.0+0.6/-0.2                  |  |
| Length from hole center to component center      | P2   | 6.35+/-1.3                    | Deviation of progress direction        |
| Length from hole center to lead                  | P1   | 3.85+/-0.7                    |  |
| Deviation along tape, left or right defect       | ΔS   | 0+/-2.0                       | They include deviation by lead bend .  |
| Carrier tape width                               | W    | 18.0+/-0.5                    |  |
| Position of sprocket hole                        | W1   | 9.0+0/-0.5                    | Deviation of tape width direction      |
| Lead distance between reference and bottom plane | H0   | 16.0+/-0.5                    |  |
| Protrusion length                                | ℓ    | 0.5 max.                      |  |
| Diameter of sprocket hole                        | D0   | 4.0+/-0.1                     |  |
| Lead diameter                                    | φd   | 0.50+/-0.05                   |  |
| Total tape thickness                             | t1   | 0.6+/-0.3                     | They include hold down tape thickness. |
| Total thickness of tape and lead wire            | t2   | 1.5 max.                      |  |
| Deviation across tape                            | Δh1  | 2.0 max. (Dimension code : W) |  |
|  | Δh2  | 1.0 max. (except as above)    |  |
| Portion to cut in case of defect                 | L    | 11.0+0/-1.0                   |  |
| Hold down tape width                             | W0   | 9.5 min.                      |  |
| Hold down tape position                          | W2   | 1.5+/-1.5                     |  |
| Coating extension on lead                        | e    | Up to the end of crimp        |  |

Reference only

Straight taping type < Lead code : DG >  
Pitch of component 12.7mm / Lead spacing 2.5mm

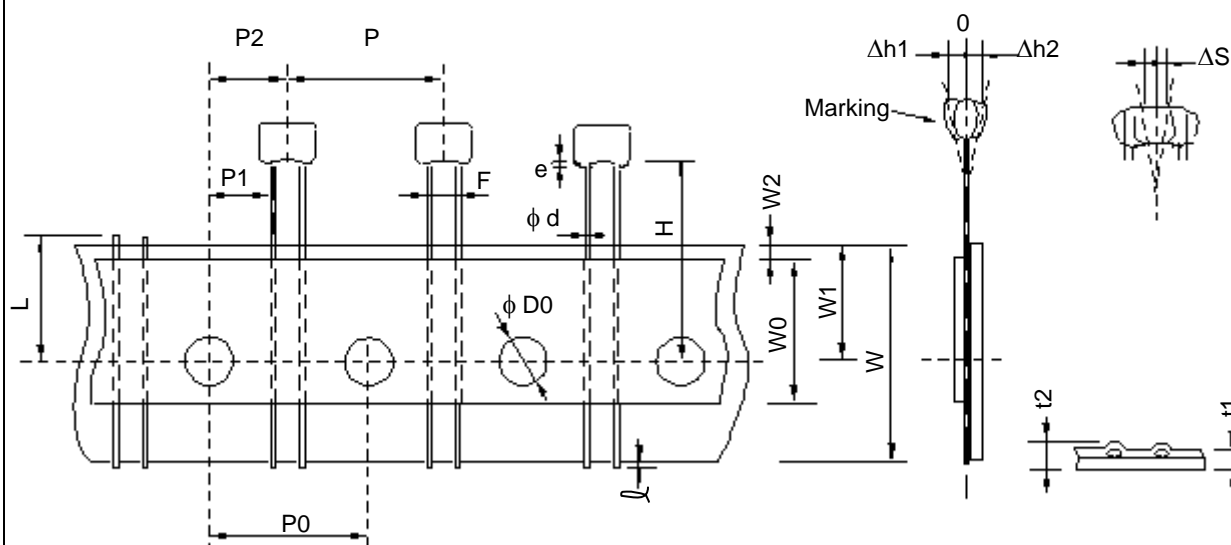

Unit : mm

| Item   | Code | Dimensions   | Remarks                                |
|--|------|--------------|--|
| Pitch of component                               | P    | 12.7+/-1.0   |  |
| Pitch of sprocket hole                           | P0   | 12.7+/-0.2   |  |
| Lead spacing                                     | F    | 2.5+0.4/-0.2 |  |
| Length from hole center to component center      | P2   | 6.35+/-1.3   | Deviation of progress direction        |
| Length from hole center to lead                  | P1   | 5.1+/-0.7    |  |
| Deviation along tape, left or right defect       | ΔS   | 0+/-2.0      | They include deviation by lead bend .  |
| Carrier tape width                               | W    | 18.0+/-0.5   |  |
| Position of sprocket hole                        | W1   | 9.0+0/-0.5   | Deviation of tape width direction      |
| Lead distance between reference and bottom plane | H    | 20.0+/-0.5   |  |
| Protrusion length                                | ℓ    | 0.5 max.     |  |
| Diameter of sprocket hole                        | D0   | 4.0+/-0.1    |  |
| Lead diameter                                    | d    | 0.50+/-0.05  |  |
| Total tape thickness                             | t1   | 0.6+/-0.3    | They include hold down tape thickness. |
| Total thickness of tape and lead wire            | t2   | 1.5 max.     |  |
| Deviation across tape                            | Δh1  | 1.0 max.     |  |
|  | Δh2  |              |  |
| Portion to cut in case of defect                 | L    | 11.0+0/-1.0  |  |
| Hold down tape width                             | W0   | 9.5 min.     |  |
| Hold down tape position                          | W2   | 1.5+/-1.5    |  |
| Coating extension on lead                        | e    | 1.5 max.     |  |

## Reference only

### 7-2. Splicing way of tape

- 1) Adhesive force of tape is over 3N at test condition as below.

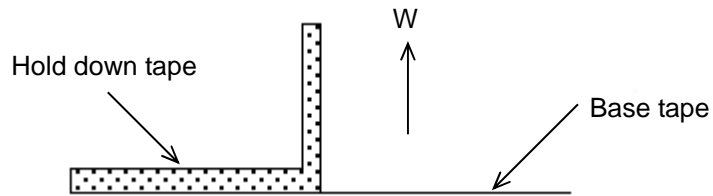

### 2) Splicing of tape

- a) When base tape is spliced

- Base tape shall be spliced by cellophane tape.  
(Total tape thickness shall be less than 1.05mm.)

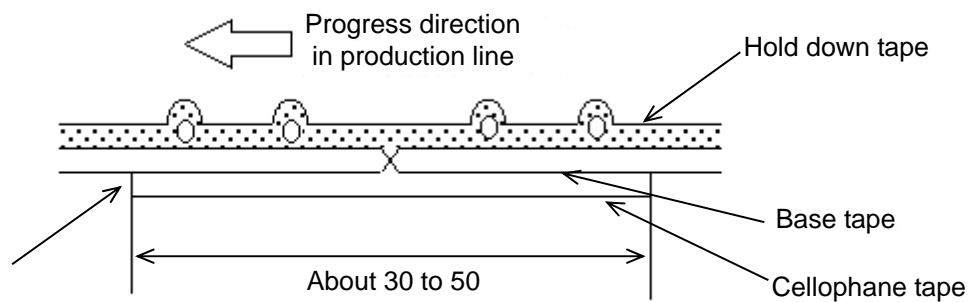

No lifting for the direction of progressing

Unit : mm

- b) When hold down tape is spliced

- Hold down tape shall be spliced with overlapping.  
(Total tape thickness shall be less than 1.05mm.)

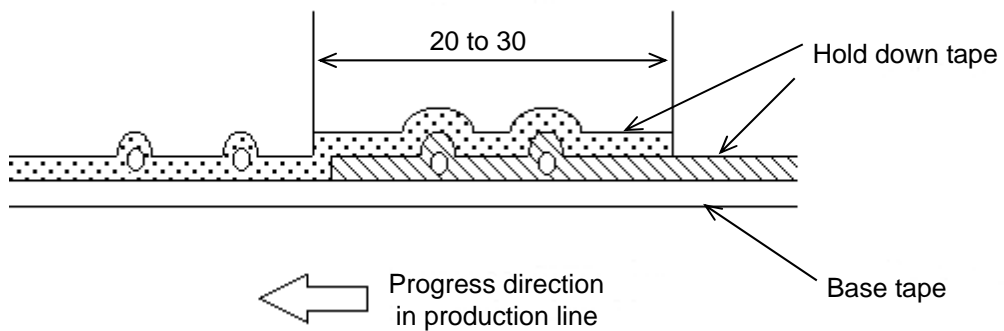

Unit : mm

- c) When both tape are spliced

- Base tape and hold down tape shall be spliced with splicing tape.



## EU RoHS and Halogen Free

This products of the following crresponds to EU RoHS and Halogen Free

### (1) RoHS

EU RoHs 2011/65/EC compliance

maximum concentration values tolerated by weight in homogeneous materials

- 1000 ppm maximum Lead
- 1000 ppm maximum Mercury
- 100 ppm maximum Cadmium
- 1000 ppm maximum Hexavalent chromium
- 1000 ppm maximum Polybrominated biphenyls (PBB)
- 1000 ppm maximum Polybrominated diphenyl ethers (PBDE)

### (2) Halogen-Free

The International Electrochemical Commission's (IEC) Definition of Halogen-Free (IEC 61249-2-21) compliance

- 900 ppm maximum chlorine
- 900 ppm maximum bromine
- 1500 ppm maximum total chlorine and bromine

## X-ON Electronics

Largest Supplier of Electrical and Electronic Components

*Click to view similar products for [Multilayer Ceramic Capacitors MLCC - Leaded](#) category:*

*Click to view products by [Murata](#) manufacturer:*

Other Similar products are found below :

[010-007220-002REV A](#) [M39014/011207](#) [M39014/011225](#) [M39014/011267](#) [M39014/011277](#) [M39014/01-1281V](#) [M39014/01-1284V](#)  
[M39014/01-1293](#) [M39014/011299](#) [M39014/011327](#) [M39014/011332](#) [M39014/01-1333V](#) [M39014/011335](#) [M39014/01-1339V](#)  
[M39014/011443](#) [M39014/01-1443V](#) [M39014/01-1467](#) [M39014/011489](#) [M39014/01-1489V](#) [M39014/011514](#) [M39014/011572](#) [M39014/01-](#)  
[1581V](#) [M39014/01-1593](#) [M39014/021218](#) [M39014/021223](#) [M39014/021225](#) [M39014/02-1240V](#) [M39014/02-1241V](#) [M39014/02-1262V](#)  
[M39014/02-1300V](#) [M39014/021303](#) [M39014/02-1315V](#) [M39014/02-1338](#) [M39014/02-1354V](#) [M39014/021411](#) [M39014/02-1418V](#)  
[M39014/05-2103](#) [M39014/05-2127](#) [M39014/220697](#) [M39014/221162](#) [M39014/230073](#) [M39014/230319](#) [M39014/230355](#) [Q52-DK](#)  
[NCD332M1KVZ5UF](#) [C410C201J1G5TATR](#) [C410C221K1G5TATR](#) [C420C102J1G5TATR](#) [C430C104M1U5TATR](#) [SL217C103KAB](#)