

# SAW FILTER FOR GPS/GLONASS

Murata part number :SAFEA1G58KA0F00

## Package Dimensions

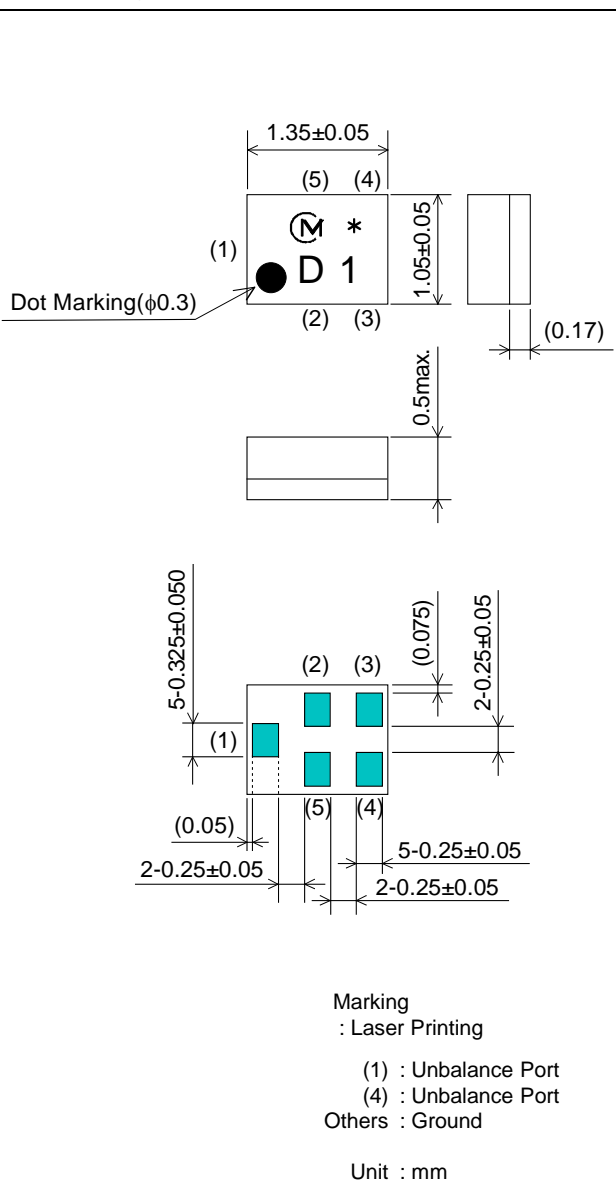

## Specification

Item	Specification		
	-30 to 85°C	25±2°C	typ.
Nominal Center Frequency(fc)	1575.42/1602MHz		
Insertion Loss			
1) 1565.42 to 1585.42MHz	1.8 dB max.	1.5 dB max.	1.3 dB
2) 1574.42 to 1576.42MHz	1.3 dB max.	1.1 dB max.	0.9 dB
3) 1597.55 to 1605.89MHz	1.7 dB max.	1.5 dB max.	1.3 dB
Absolute Attenuation			
1) 1 to 925 MHz	32 dB min.	32 dB min.	35 dB
2) 925 to 960 MHz	32 dB min.	32 dB min.	35 dB
3) 1427 to 1453 MHz	40 dB min.	40 dB min.	47 dB
4) 1453 to 1501 MHz	40 dB min.	40 dB min.	46 dB
5) 1501 to 1525 MHz	35 dB min.	35 dB min.	43 dB
6) 1626 to 1660 MHz	1.5 dB min.	4 dB min.	7 dB
7) 1710 to 1785 MHz	38 dB min.	38 dB min.	42 dB
8) 1850 to 1910 MHz	40 dB min.	40 dB min.	43 dB
9) 1920 to 1980 MHz	40 dB min.	40 dB min.	44 dB
10) 2110 to 2170 MHz	40 dB min.	40 dB min.	47 dB
11) 2400 to 2500 MHz	42 dB min.	42 dB min.	50 dB
12) 2500 to 2570 MHz	40 dB min.	40 dB min.	49 dB
GDT Ripple Deviation (1597.55 to 1605.89MHz)	6.0 ns max.	5.0 ns max.	2.0 ns
Ripple Deviation (1565.42 to 1605.89MHz)	1.5 dB max.	1.0 dB max.	0.5 dB
VSWR			
1) 1565.42 to 1585.42MHz	2.1 max.	2.0 max.	1.6
2) 1597.55 to 1605.89MHz	2.1 max.	2.0 max.	1.6
Unbalance Port Matching Impedance (nominal)	50Ω		
Input Signal Level	20mW (+13dBm), 2000 hours		

# SAW FILTER FOR GPS/GLONASS

Murata part number :SAFEA1G58KA0F00

## ■ Frequency Performance

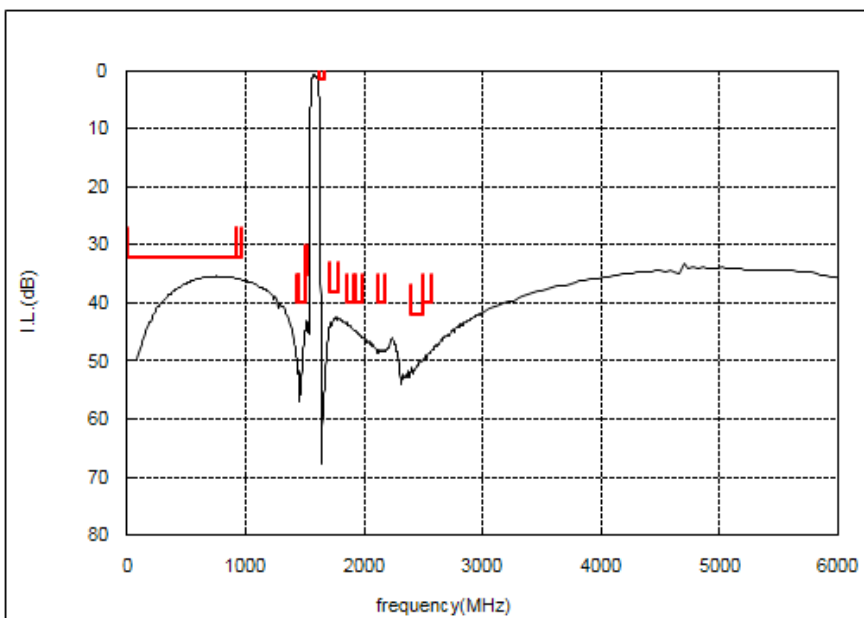
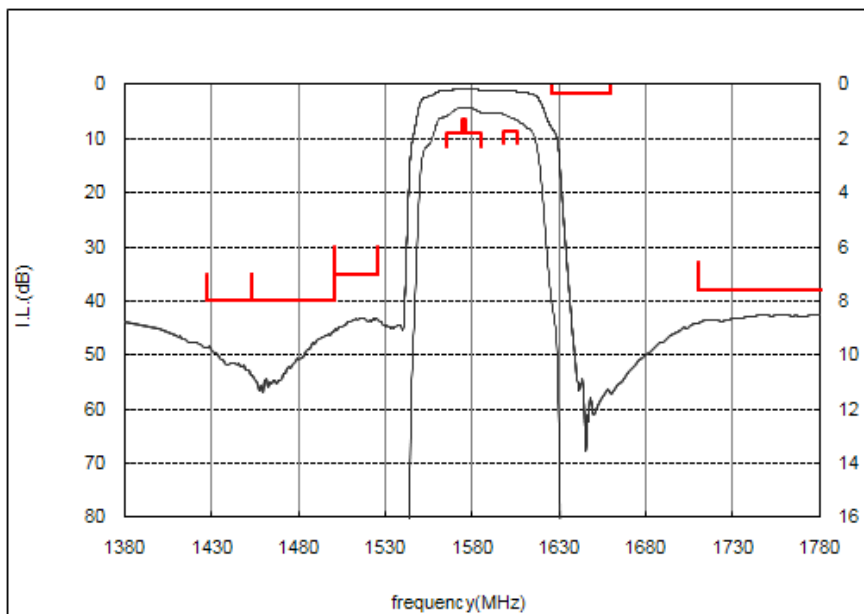

# SAW FILTER FOR GPS/GLONASS

Murata part number :SAFEA1G58KA0F00

## Dimensions of Carrier Tape

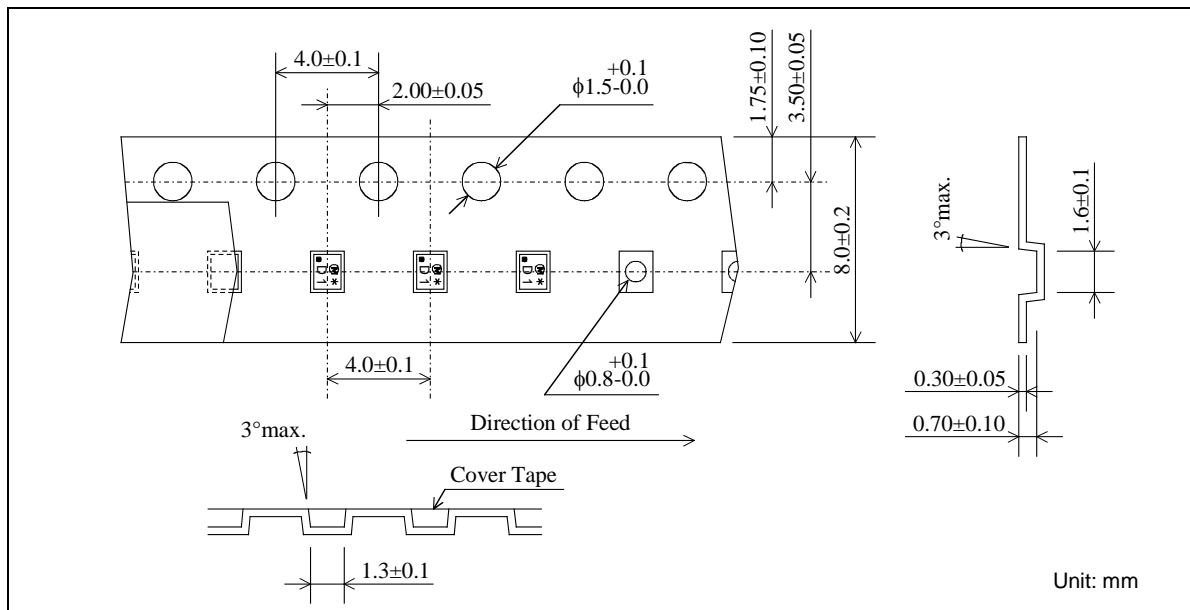

## Dimensions of Tape

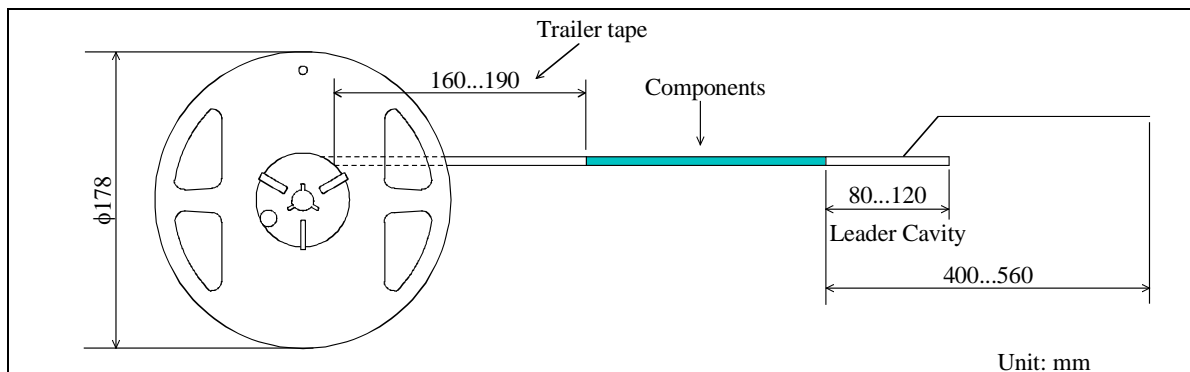

## Dimensions of Reel

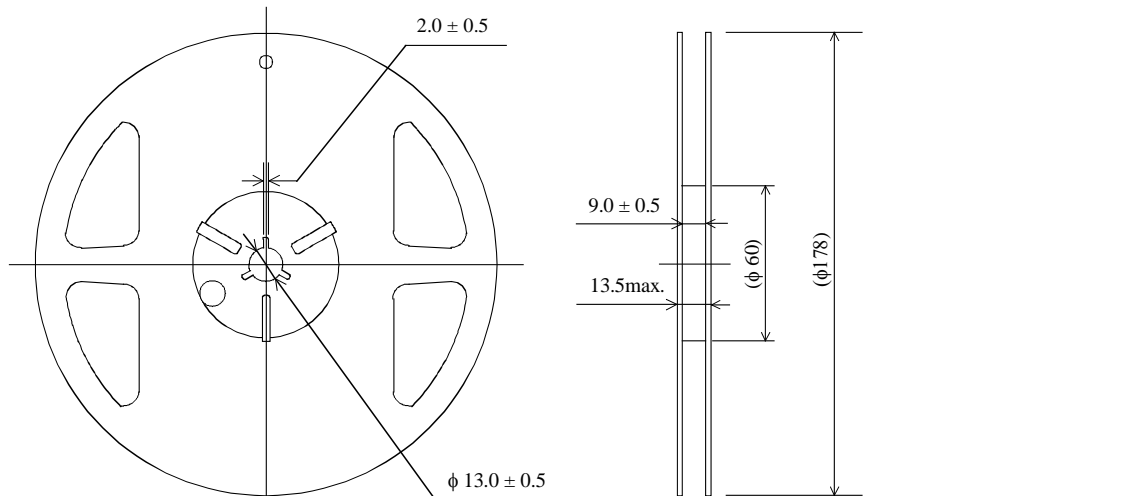

SAFEA1G58KA0F00R14 ... 4000pcs/reel  
SAFEA1G58KA0F00R12 ... 2000pcs/reel

# SAW FILTER FOR GPS/GLONASS

Murata part number :SAFEA1G58KA0F00

## Recommended Land Pattern

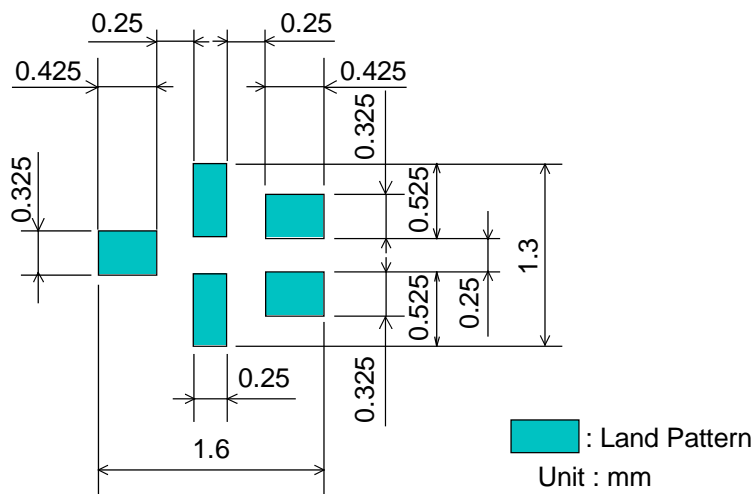

## Test Circuit

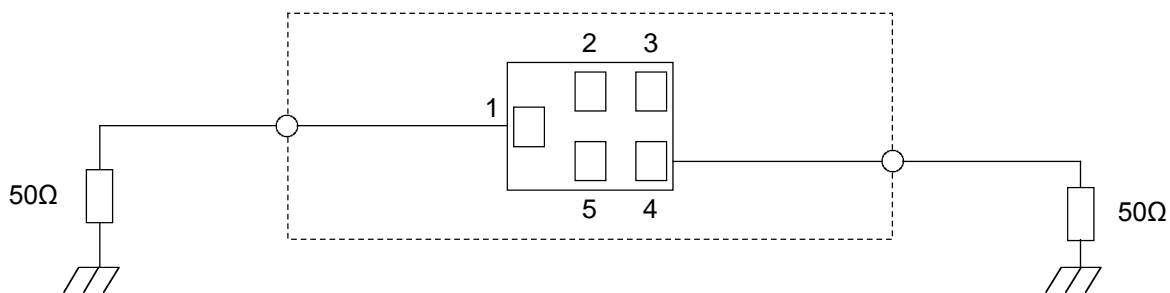

# SAW FILTER FOR GPS/GLONASS

Murata part number :SAFEA1G58KA0F00

## ■ RoHS Compliance

This component is compliant with RoHS directive.

This component was always RoHS compliant from the first date of manufacture.

### • Caution - Limitation of Applications

Please contact us before using our products for the applications listed below which require especially for the prevention of defects which might directly cause damage to the third party's life, body or property.

- a. Aircraft equipment
- b. Aerospace equipment
- c. Undersea equipment
- d. Nuclear control equipment
- e. Medical equipment
- f. Transportation equipment (vehicles, trains, ships, etc.)
- g. Traffic signal equipment
- h. Disaster prevention / crime prevention equipment
- i. Data - processing equipment
- j. Application of similar complexity and / or reliability requirements to the applications listed in the above

• This PDF Datasheet is downloaded from the website of Murata Manufacturing Co., Ltd. Therefore, it's specifications are subject to change or our products in it may be discontinued without advance notice. Please check with our sales representatives or product engineers before ordering.

• This PDF Datasheet has only typical specifications because there is no space for detailed specifications. Therefore, please approve our product specifications or transact the approval sheet for product specifications before ordering.

## X-ON Electronics

Largest Supplier of Electrical and Electronic Components

*Click to view similar products for [Signal Conditioning](#) category:*

*Click to view products by [Murata](#) manufacturer:*

Other Similar products are found below :

[MAPDCC0001](#) [MAPDCC0004](#) [PD0409J5050S2HF](#) [HHS-109-PIN](#) [AFS14A30-2185.00-T3](#) [AFS14A35-1591.50-T3](#) [DS-323-PIN](#) [DSS-313-PIN](#) [B39321R801H210](#) [1A0220-3](#) [JP510S](#) [LFB212G45SG8C341](#) [LFB322G45SN1A504](#) [LFL182G45TC3B746](#) [SF2159E](#) [30057](#)  
[AFS1575.42S4-T](#) [FM-104-PIN](#) [CER0813B](#) [MAPDCC0005](#) [3A325](#) [40287](#) [41180](#) [ATB3225-75032NCT](#) [BD0810N50100AHF](#) [JHS-115-PIN](#)  
[DC0710J5005AHF](#) [DC2327J5005AHF](#) [43020](#) [LFB2H2G60BB1C106](#) [LFL15869MTC1B787](#) [X3C19F1-20S](#) [XC3500P-20S](#) [10013-20](#)  
[SF2194E](#) [CDBLB455KCAX39-B0](#) [TGL2208-SM, EVAL](#) [RF1353C](#) [051157-0000](#) [PD0922J5050D2HF](#) [1E1305-3](#) [1F1304-3S](#) [1G1304-30](#)  
[B0922J7575AHF](#) [10017-3](#) [TP-103-PIN](#) [BD1222J50200AHF](#) [BD1722J50100AHF](#) [2450DP39K5400E](#) [BD0810J50150AHF](#)