

MARK	DATE	EXPLANATION	REVISER
▽	20140805	Modified electroplating numbe	JACKY LIU
▽	20190123	Add "Nextron" LOGO and Nut post height	JACKY LIU

### SPECIFICATIONS:

Current rating:3.0A AC/DC  
Voltage rating:250V AC/DC  
Contact resistance:30m ohm MAX  
Insulation resistance:1000M ohm MIN  
Withstanding voltage:1000V AC for one minute  
Operating temperature range:-40°C~+85°C  
Thread specification of nut:#4-40UN

### MATERIAL AND FINISH

Insulator:PBT+30%G.F(UL94V-0)  
Contact:Copper Alloy Nickel Undercoated  
Selective Gold Plated  
Finish:Metal Iron With Tin Plated

## Ordering Information

Number of contacts		Housing Type	Mounting Options	Nut post height	Contacts Material	Contact Plated	Insulator material	Insulator color	Mark						
Code	Definition	Code	Definition	Code	Definition	Code	Contact Area	Code	Definition	Code	Definition	Code	Definition		
A	9 PIN	M	Male	0	H=5,8mm	2	Brass	1	Full Gold 1u"	0	PBT	0	Black	0	NONE
B	15 PIN			1	H=4,8mm	7	Phosphor bronze	2	Gold 3u"	2	NYLON	6	Blue	2	Nextron
C	25 PIN	F	Female					3	Gold 5u"			9	White		
E	37 PIN							4	Gold 10u"						
								5	Gold 15u"						
								6	Gold 30u"						

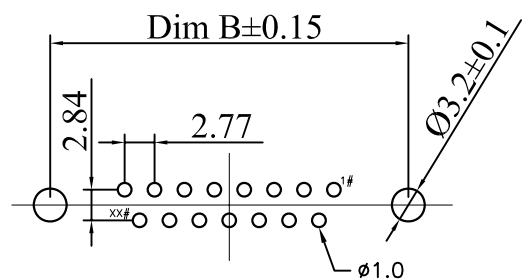
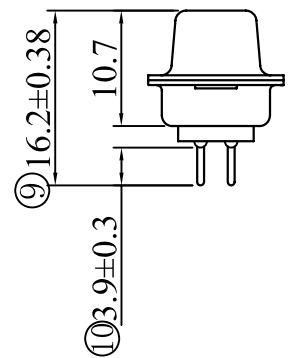
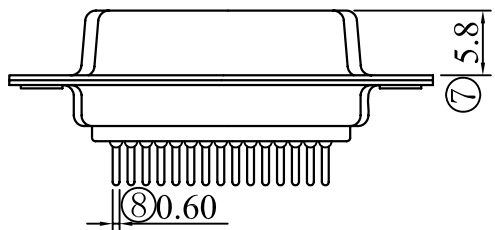
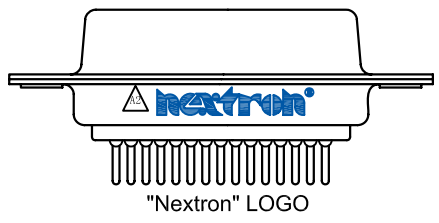
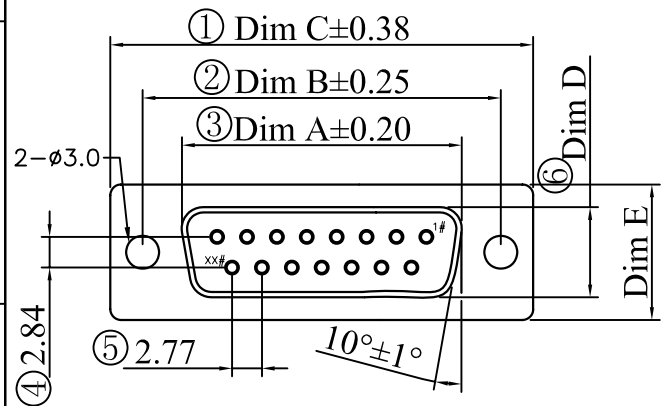

POS. NO.	A	B	C	D	E
37P	54.84	63.50	69.32	7.90	12.50
25P	38.38	47.04	53.04	7.90	12.50
15P	24.66	33.32	39.14	7.90	12.50
9P	16.33	24.99	30.81	7.90	12.50

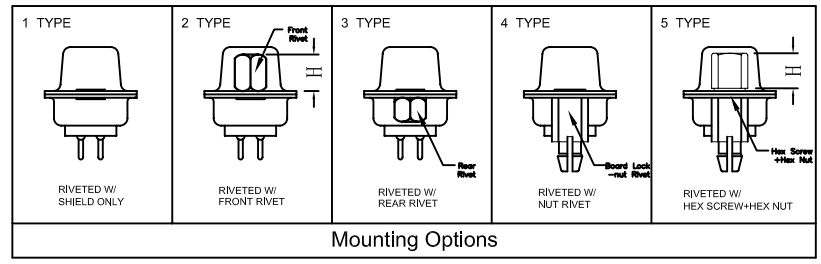

**nextron** 正凌精密工业股份有限公司  
NEXTRONICS ENGINEERING CORP

PART. NAME: D型XX芯直插式PCB焊接插座 (孔) TITLE: D-SUB/DP/xxP/FEMALE/  
PART. NO.: SEE TABLE DWG NAME: C-SUB-DP0F-0001

APPROVED BY: Jonnson CHECKED BY: Jeff DESIGNED BY: allan DRAWN BY: Jacky  
2019.01.23

CUSTOM NO.: Tolerance: x. ±0.50, x.xx ±0.30, x.xx ±0.20, xx° ±1°

UNITS: mm SCALE: REVISION:A2

## X-ON Electronics

Largest Supplier of Electrical and Electronic Components

*Click to view similar products for [HDMI, Displayport & DVI Connectors](#) category:*

*Click to view products by [Nextronics](#) manufacturer:*

Other Similar products are found below :

[30-528](#) [30-504](#) [33DVIR-24S1B](#) [47648-2000](#) [TC142X](#) [1932649-1](#) [HAGBH](#) [AABII](#) [ABIBG](#) [AAIBH](#) [52355](#) [XHLJQ-00026](#) [HDMI-019R](#)  
[G46M2013201AWEU](#) [ST-0277D00-052-142](#) [HC-PJ-320A-3P-D](#) [HC-PJ-3133-5P-D](#) [PJ-342](#) [141](#) [PJ-320A-4P](#) [DIP](#) [HC-PJ-325C-5P](#) [HC-PJ-](#)  
[320D-4P-S](#) [HC-PJ-3133-6P-S](#) [D-SUB-DR-9PCM-CB](#) [ST-0275S00-082-182](#) [HC-PJ-320A-4P-D](#) [HC-PJ-325A-5P](#) [HC-PJ-3134-6P-D](#) [HDR-](#)  
[HX-102DIP](#) [HDMI-GD-121PWB](#) [C2939191](#) [C2939584](#) [PJ-208](#) [PJ-2040](#) [PJ-3580A-6A](#) [PJ-399M](#) [PJ-3200A-3A](#) [PJ-328B-4B](#) [PJ-3930-7A](#)  
[PJ-615-5A](#) [PJ-332-6A](#) [KH-HDMI-0001](#) [KH-PJ-209-SMT](#) [KH-HDMI-0035-XK](#) [KH-PJ-328A-5P](#) [KH-PJ-322](#) [KH-PJ-327E-SMT](#) [KH-PJ-](#)  
[320A-5.6](#) [KH-HDR15P-F3.08](#) [KH-HDMI-0005A-SMT](#) [KH-HDMI-0021-JBS](#)