

1 2 3 4 5 6 7 8

A  
B  
C  
D  
E

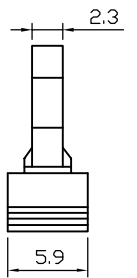
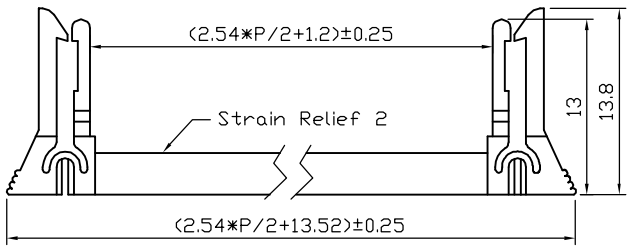
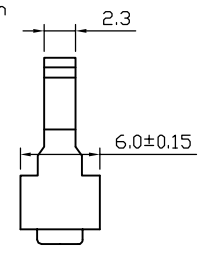
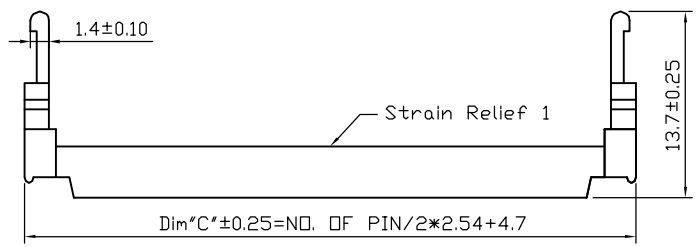
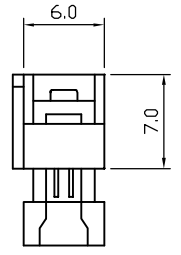
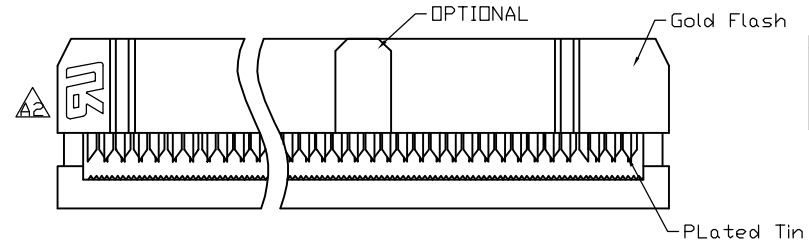
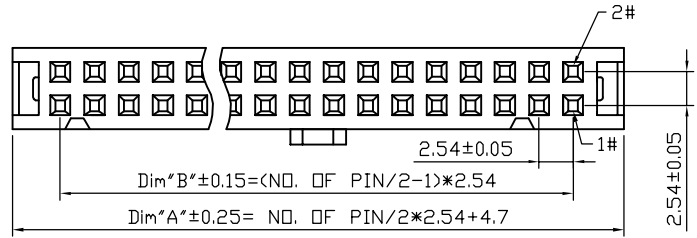

**SPECIFICATIONS**  
 CURRENT RATING: 1.0A AC,DC  
 VOLTAGE RATING: 250V AC,DC  
 CONTACT RESISTANCE: 20mΩ MAX  
 INSULATION RESISTANCE: 500MΩ MIN  
 WITHSTANDING VOLTAGE: 500V AC/MINUTE  
 TEMPERATURE RANGE: -25°C TO +105°C  
 MATERIAL  
 INSULATOR: PBT UL94V-0  
 CONTACT: BRASS  
 FINISH: GOLD FLASH

**PART NO.**  
 Z-810 \*\* 1001 \* \*000  
 NO OF POSITION 10~64=10P~64P  
 RELIEF TYPE  
 1=W/D STRAIN RELIEF  
 2=W/STRAIN RELIEF 1  
 3=W/STRAIN RELIEF 2  
 LOGO  
 0=N LOGO  
 INSULATOR COLOR  
 1=BLACK  
 2=BLUE  
 3=WHITE  
 4=GREY

PIN	A±0.25	B±0.15	C±0.25
6	12.32	5.08	12.32
8	14.86	7.62	14.86
10	17.40	10.16	17.40
14	22.48	15.24	22.48
16	25.02	17.78	25.02
18	27.56	20.32	27.56
20	30.10	22.86	30.10
24	35.18	27.94	35.18
26	37.72	30.48	37.72
30	42.80	35.56	42.80
34	47.88	40.64	47.88
40	55.50	48.26	55.50
50	68.20	60.96	68.20
60	80.90	73.66	80.90
64	85.98	78.74	85.98

正凌精密工业(广东)有限公司  
 2016/3/25  
 内部资料请勿复印

REV.	DESCRIPTION	DATE
A2	UL MARK POSITION CHANGE	3/23'16
A1	DIMENSION MODIFY	3/15'16
A	NEW RELEASED	6/05'12

UNITS ■mm □INCH		NAME: 2.54 IDC CONNECTOR	 NEXTRONICS ENGINEERING CORP.	
GENERAL TOLERANCES: (UNLESS SPECIFIED)		PART NO: Z-810**1001**000	TITLE: CUSTOMER DWG	
4 PLACE	± **	APPD: 楊海文 2016/3/24	DWG NO: 010-0000-574	
3 PLACE	± 0.08	CHKD: 廖小瓊 2016/3/24	C	
2 PLACE	± 0.25	DRAWN: 陳惠枝 2016/3/23	SCALE: 1/1	SHEET: 1/1
1 PLACE	± 0.38		REV.:	A2
ANGULAR:	X°± 2°			

## X-ON Electronics

Largest Supplier of Electrical and Electronic Components

*Click to view similar products for [Headers & Wire Housings](#) category:*

*Click to view products by [Nextronics](#) manufacturer:*

Other Similar products are found below :

[57102-F02-18ULF](#) [58102-G61-06LF](#) [0009485154](#) [009176003701906](#) [0050291907](#) [02.125.8002.8](#) [609-3404](#) [61062-3](#) [622-0430](#) [622-3653LF](#)  
[63453-116](#) [636-1030](#) [636-1427](#) [636-3427](#) [636-4007](#) [641938-9](#) [644827-2](#) [65495-038](#) [65692-001LF](#) [65781-018](#) [65781-047](#) [65817-010LF](#)  
[65817-015LF](#) [66207-023LF](#) [67016-026LF](#) [67095-007LF](#) [68631-112](#) [68645-018](#) [68648-049](#) [699319-000](#) [70.362.1628.0](#) [70-4210](#) [70-4226B](#)  
[70-4853B](#) [707-5020](#) [707-5028](#) [71.350.2428.0](#) [71961-016LF](#) [733-134](#) [754199-000](#) [760-3052](#) [787-8014-00](#) [FCN-367T-T012/H](#) [80.063.4001.1](#)  
[800-90-001-10-001000](#) [800-90-010-10-002000](#) [801-43-002-10-013000](#) [801-43-006-10-002000](#) [803-41-018-10-001000](#) [803-43-014-20-](#)  
[001000](#)