

NOTES:
 Current Rating:1.5AMP
 Contact Resistance:20mΩ max
 Withstand Voltage:500V AC/DC
 Insulation Resistance:1000MΩ min
 Operation Temperature:-40℃ to +105℃

Contact Material:Brass
 Contact plating:Au or Sn Over Ni
 Insulator Material:PA9T+30%GF(UL94V-0)

PART NO.

Z-S973111 ** R * * K * 1

No. of Pins
 10P, 14P, 16P,
 20P, 24P, 26P,
 30P, 34P, 40P,
 44P, 50P, 60P,
 Packing
 A=Tray
 T=Tube

PLATING
 0=TIN
 1=GOLD FLASH
 2=GOLD 3U"
 3=GOLD 5U"
 4=GOLD 10U"
 5=GOLD 15U"
 6=GOLD 30U"
 7=GOLD FLASH/TIN
 8=GOLD 3U"/TIN
 9=GOLD 5U"/TIN
 A=GOLD 10U"/TIN
 B=GOLD 15U"/TIN
 C=GOLD 30U"/TIN

Color Insulator
 B=Black
 U=Blue
 W=White

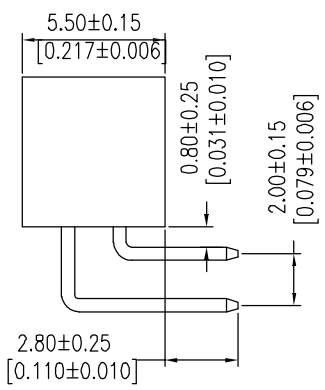
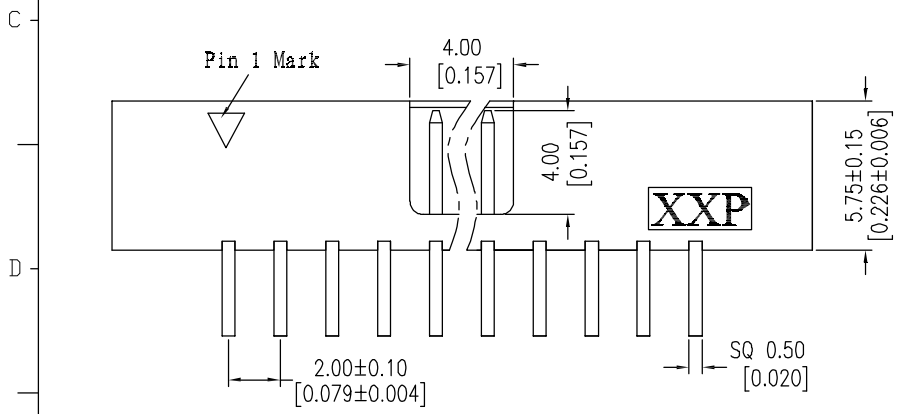

Recommended P.C.B Layout(Top Side)
 (PCB BOARD TOLERANCE±0.05)

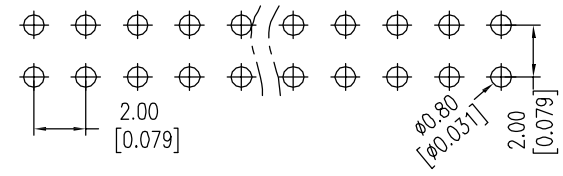

A	NEW RELEASED	1/8'16	
REV.	DESCRIPTION	DATE	APPD

UNITS <input checked="" type="checkbox"/> mm <input type="checkbox"/> INCH	NAME: 2.00 BOX HEADER 90° H=5.7	NEXTRONICS ENGINEERING CORP.	
GENERAL TOLERANCES: (UNLESS SPECIFIED)	PART NO: Z-S973111**R**K*1	TITLE: CUSTOMER DWG	
	APPD:	DWG NO:	C
	CHKD:	****	
	DRAWN: 陳惠枝 1/8'16	SCALE: 4 / 1	SHEET: 1 / 1
	ANGULAR: X°±3° X'±**	REV.:	A

X-ON Electronics

Largest Supplier of Electrical and Electronic Components

Click to view similar products for [Headers & Wire Housings](#) category:

Click to view products by [Nextronics](#) manufacturer:

Other Similar products are found below :

[57102-F02-18ULF](#) [58102-G61-06LF](#) [0009485154](#) [009176003701906](#) [0050291907](#) [02.125.8002.8](#) [609-3404](#) [61062-3](#) [622-0430](#) [622-3653LF](#)
[63453-116](#) [636-1030](#) [636-1427](#) [636-3427](#) [636-4007](#) [641938-9](#) [644827-2](#) [65495-038](#) [65692-001LF](#) [65781-018](#) [65781-047](#) [65817-010LF](#)
[65817-015LF](#) [66207-023LF](#) [67016-026LF](#) [67095-007LF](#) [68631-112](#) [68645-018](#) [68648-049](#) [699319-000](#) [70.362.1628.0](#) [70-4210](#) [70-4226B](#)
[70-4853B](#) [707-5020](#) [707-5028](#) [71.350.2428.0](#) [71961-016LF](#) [733-134](#) [754199-000](#) [760-3052](#) [787-8014-00](#) [FCN-367T-T012/H](#) [80.063.4001.1](#)
[800-90-001-10-001000](#) [800-90-010-10-002000](#) [801-43-002-10-013000](#) [801-43-006-10-002000](#) [803-41-018-10-001000](#) [803-43-014-20-](#)
[001000](#)