

NOTES:
 Current Rating: 2.0AMP
 Contact Resistance: 20mΩ Max
 Withstand Voltage: 1000V AC/DC
 Insulation Resistance: 1000MΩ Min
 Operation Temperature: -40°C to +105°C

Contact Material: Brass
 Contact plating: Au Or Sn over Ni
 Insulator Material: LCP+30%G.F UL94V-0

PART NO.

Z-S973221 ** S * * S * 1

No. of Pins
 06P, 08P, 10P, 14P,
 16P, 20P, 24P, 26P,
 30P, 34P, 40P, 44P,
 50P, 60P, 64P,
 Packing
 A=Tray
 T=Tube

PLATING

0=TIN
 1=GOLD FLASH
 2=GOLD 10U"
 3=GOLD 15U"
 4=GOLD 30U"
 A=GOLD FLASH/TIN
 B=GOLD 10U"/TIN
 C=GOLD 15U"/TIN
 D=GOLD 30U"/TIN

Insulator Color
 B=Black
 U=Blue
 G=Grey(427C)
 E=Grey(413C)

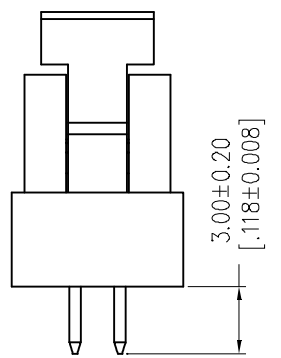
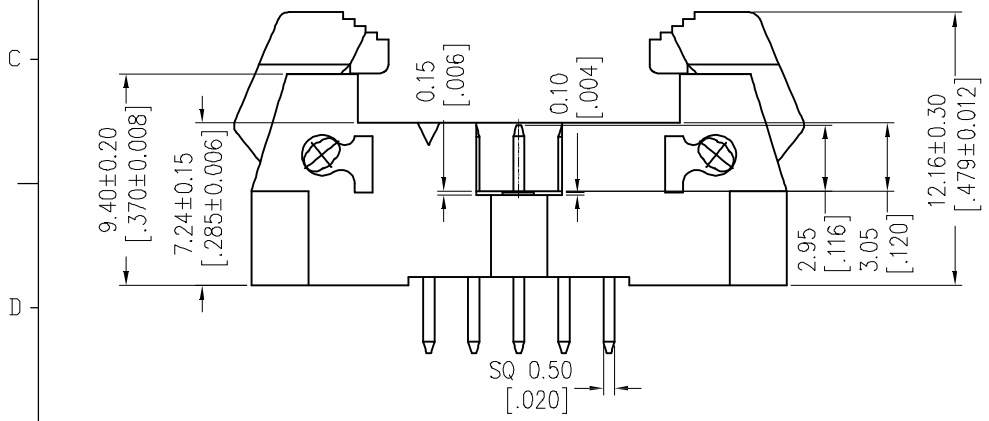

Recommended P.C.B Layout(Top Side)
 (PCB BOARD TOLERANCE±0.05)

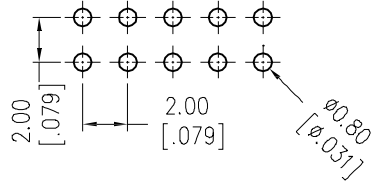

UNITS <input checked="" type="checkbox"/> mm <input type="checkbox"/> INCH		NAME: 2.00 Ejector HEADER "S" Type 180°		 NEXTRONICS ENGINEERING CORP.	
GENERAL TOLERANCES: (UNLESS SPECIFIED)		PART NO: Z-S973221**S**S*1		TITLE: CUSTOMER DWG	
	mm	INCH	APPD:		DWG NO: ****
4 PLACE	± **	±. **	CHKD:		C
3 PLACE	± 0.15	±. **	DRAWN:		
2 PLACE	± 0.25	±. **			
1 PLACE	± 0.40	±. **			
ANGULAR:	X°± 3°	X°± **			SCALE: SHEET: REV.: 4 / 1 1 / 1 A

A	NEW RELEASED	8/21'14	
REV.	DESCRIPTION	DATE	APPD

X-ON Electronics

Largest Supplier of Electrical and Electronic Components

Click to view similar products for [Headers & Wire Housings](#) category:

Click to view products by [Nextronics](#) manufacturer:

Other Similar products are found below :

[57102-F02-18ULF](#) [58102-G61-06LF](#) [0009485154](#) [009176003701906](#) [0050291907](#) [02.125.8002.8](#) [609-3404](#) [61062-3](#) [622-0430](#) [622-3653LF](#)
[63453-116](#) [636-1030](#) [636-1427](#) [636-3427](#) [636-4007](#) [641938-9](#) [644827-2](#) [65495-038](#) [65692-001LF](#) [65781-018](#) [65781-047](#) [65817-010LF](#)
[65817-015LF](#) [66207-023LF](#) [67016-026LF](#) [67095-007LF](#) [68631-112](#) [68645-018](#) [68648-049](#) [699319-000](#) [70.362.1628.0](#) [70-4210](#) [70-4226B](#)
[70-4853B](#) [707-5020](#) [707-5028](#) [71.350.2428.0](#) [71961-016LF](#) [733-134](#) [754199-000](#) [760-3052](#) [787-8014-00](#) [FCN-367T-T012/H](#) [80.063.4001.1](#)
[800-90-001-10-001000](#) [800-90-010-10-002000](#) [801-43-002-10-013000](#) [801-43-006-10-002000](#) [803-41-018-10-001000](#) [803-43-014-20-](#)
[001000](#)