

ITEM	1
TYCO PART NO.	1879009-1
OHMIC VALUE	4.7 OHMS +/- 5%

SEE DATA SHEET 1773442
ALL DETAILS AS PER SQB30 WITH EXCEPTION OF TERMINALS

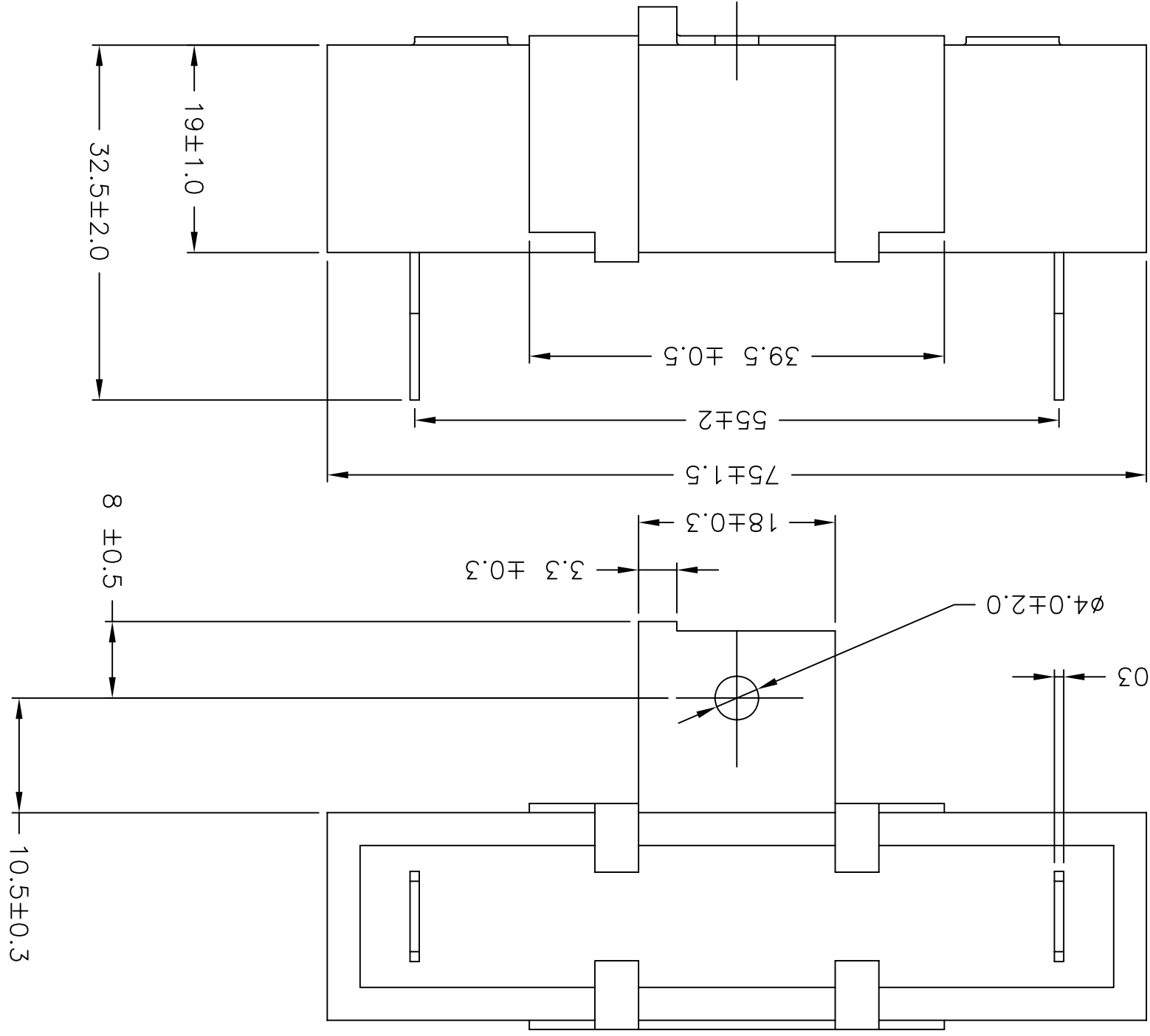
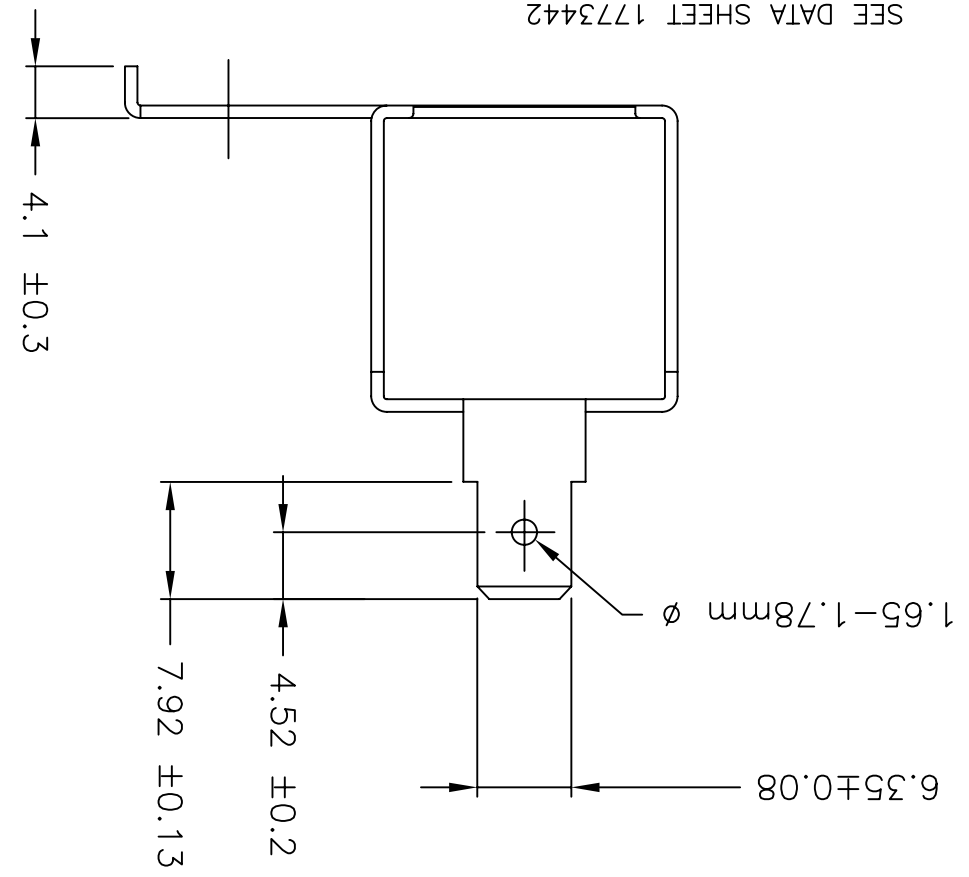

THIS DRAWING IS A CONTROLLED DOCUMENT.		DWN 03JAN07		DAVE KENNEDY		CHK 03JAN07		C MELBOURNE		APVD 03JAN07		C MELBOURNE		PRODUCT SPEC		APPLICATION SPEC		WEIGHT		MATERIAL		FINISH	
TOLERANCES UNLESS OTHERWISE SPECIFIED:		±0.2		±0.1		±0.1		±0.1		±0.1		±0.1		±0.1		±0.1		±0.5		0 PLC		4 PLG ANGLES	
DIMENSIONS:		MM		-		-		-		-		-		-		-		-		-		-	
CUSTOMER DRAWING		SCALE 2:1		SHEET 1 OF 1		REV A		RESTRICTED TO		DRAWING NO		CAGE CODE		SIZE		A3		00779		G=1879009		-	
TYCO Electronics Corporation		Dorcan, Swindon, SN3 5HH		NAME		Tyco Electronics Corporation		HIGH POWER RESISTOR		SQB30 6.35mm FASTON		-		-		-		-		-		-	

THIS DRAWING IS UNPUBLISHED.		RELEASED FOR PUBLICATION		JAN. 2007.		COPYRIGHT 2007 BY TYCO ELECTRONICS CORPORATION.		ALL RIGHTS RESERVED.			
LOC	E	DIST	B	P	LTR	A	FIRST TYCO REVISION		03JAN07	DK	CM
REVISIONS											
DESCRIPTION											
DATE											
DWN											
APVD											

A
B
C
D

A
B
C
D

X-ON Electronics

Largest Supplier of Electrical and Electronic Components

Click to view similar products for [Wirewound Resistors - Through Hole](#) category:

Click to view products by [TE Connectivity](#) manufacturer:

Other Similar products are found below :

[75822-2K4](#) [90J56R](#) [AC03000001208JAC00](#) [EP3WS47RJ](#) [C1010KJL](#) [C1015RJL](#) [C3A10KJT](#) [27J1K0](#) [ES3W47RJ](#) [AC04000001500JAC00](#)
[AC10000002208JAB00](#) [AC10000004708JAB00](#) [SQMW5R39J](#) [SQPW5R22J](#) [SQPW5R33J](#) [1879927-3](#) [FCB2100RJ](#) [T505](#) [FSQ5WR47J](#)
[FW10A33R0JA](#) [C1010RJL](#) [C10220RJL](#) [C10R47JL](#) [C141K0JL](#) [C144R7JL](#) [ES05W100RJ](#) [SQMW1047RJ](#) [SQMW210RJ](#) [ULW5-39R0JT075](#)
[W31-R47JA1](#) [ULW5-68RJT075](#) [SQBW401K0JFASTON](#) [SPH1001JLF](#) [65888-3R3](#) [SQP500JB-400R](#) [SQBW403R3JFASTON](#) [280-PRM7-](#)
[4.7-RC](#) [CW02B9R100JE73](#) [FW70A1000JA](#) [AC05000005608JAC00](#) [SQPW547RJ](#) [SQMW10R68J](#) [C102K2JL](#) [SQPW510RJ](#) [PW103001KLF](#)
[SQPW522RJ](#) [SQPW568RJ](#) [FCB4560RJ](#) [FCB2R47J](#) [SQPW2R047J](#)