

REV.	DESCRIPTION	DRAWN	CHECKED	APPROVED
A	NEW RELEASE	LJH 03/30/06'	~	LJC 09/20/05'
B	整理图面	YCH 07/27/07'	~	

NOTES:

- MATERIAL
  - INSULATOR:THERMOPLASTIC(UL 94V-0).
  - CONTACT: COPPER ALLOY.
  - CONTACT PLATED: SEE ORDERING INFORMATION.
- SPECIFICATION
  - TEMPERATURE: -20~+105°C.
  - CONTACT RESISTANCE: 20mΩ max.
  - INSULATION RESISTANCE: 1000MΩ min.
  - DIELECTRIC WITHSTANDING VOLTAGE: AC 500V PER MINUTE.

- PART NUMBER: DS1010
- PRODUCT NUMBER CODE:

DS1010 - X X X X  
 Central support  
 S: W/ central support  
 X: W/O central support  
 Width dim.D  
 N: 10.16mm  
 W: 15.24mm  
 D: 19.05mm  
 Contact plating  
 T1: Tin  
 No.OF CONTACTS  
 24 28 30 32 40  
 42 48 52 56 64  
 Series No.  
 DS1010

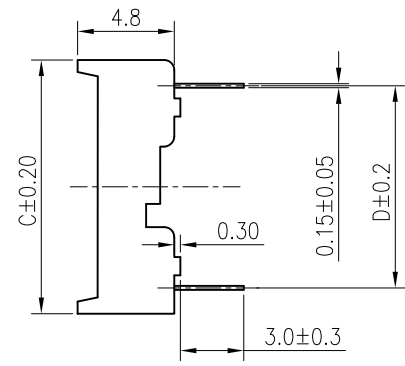
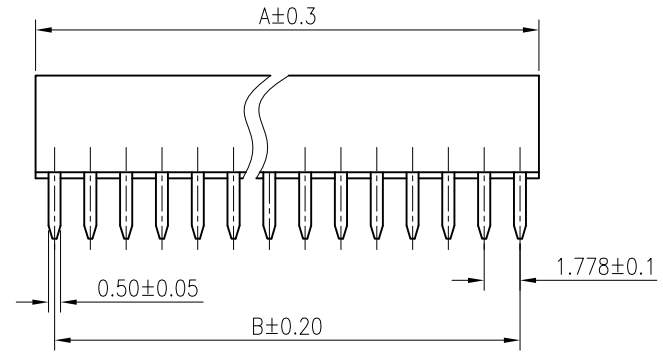
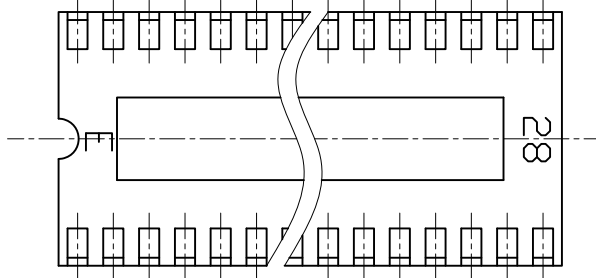

Table A:

Position	Dimension			
	A	B	C	D
24	21.34	19.56	12.65	10.16
28	24.89	23.11	12.65	10.16
30	26.67	24.89	12.65	10.16
32	27.45	26.67	12.65	10.16
40	35.56	33.78	17.73	15.24
42	37.34	35.56	17.73	15.24
48	42.67	40.89	17.73	15.24
52	46.23	44.45	17.73	15.24
56	49.78	48.01	17.73	15.24
64	56.90	55.12	21.54	19.05



GENERAL TOLERANCE		ANGLE TOLERANCE	
X.	±0.60	X.	±5'
.X	±0.38	.X	±3'
.XX	±0.25	.XX	±2'

DRAWING TYPE	CUSTOMER		
SCALE	1:1	SHEET	1 OF 1
DRAWING NO.	C-DS1010-XXXX		

PROJECTION		TITLE	IC SOCKET PITCH 1.778mm(0.070)
UNITS	mm	SHEET SIZE	A4
SHEET SIZE	A4	SERIES	DS1010 SERIES

晨翔电子有限公司  
**CONNFLY CONNFLY ELECTRONIC CO. LTD**

## X-ON Electronics

Largest Supplier of Electrical and Electronic Components

*Click to view similar products for [IC & Component Sockets](#) category:*

*Click to view products by [Connfly](#) manufacturer:*

Other Similar products are found below :

[714-43-102-31-012000](#) [0066-3-17-15-30-14-02-0](#) [0134-0-15-15-32-27-04-0](#) [614-DG5](#) [6527-0-00-15-00-00-03-0](#) [670](#) [672](#) [673](#) [712-93-120-41-001000](#) [714-93-104-31-018000](#) [8059-4G1-LF](#) [807-22-001-10-001101](#) [807-22-001-10-003101](#) [807-22-001-10-004101](#) [807-22-001-10-006101](#) [807-22-001-30-011101](#) [807-22-001-30-012101](#) [807-22-001-30-013101](#) [807-22-001-30-014101](#) [8-1437531-4](#) [8150-6P10](#) [833-93-034-10-001000](#) [835-43-014-10-001000](#) [851-41-006-10-001000](#) [851-43-008-20-001000](#) [851-43-014-20-001000](#) [851-93-006-20-001000](#) [851-93-010-20-001000](#) [852-10-026-10-001000](#) [853-43-020-10-001000](#) [86.010.0053.0](#) [116-43-306-41-003000](#) [116-43-308-41-007000](#) [116-87-308-41-007101](#) [PX-68LCC](#) [PX-84LCC](#) [121-13-318-41-001000](#) [121-13-320-41-001000](#) [121-13-308-41-001000](#) [123-43-314-41-801000](#) [123-43-420-41-001000](#) [123-43-636-41-001000](#) [122-13-316-41-001000](#) [123-13-624-41-001000](#) [123-43-306-41-001000](#) [123-43-322-41-801000](#) [123-43-428-41-001000](#) [123-43-624-41-001000](#) [123-91-320-41-001000](#) [126-43-310-41-002000](#)