

REV.	DESCRIPTION	DRAWN	CHECKED	APPROVED
A	NEW RELEASE	LJH 04/27/05'	~~~~~	LJH 04/22/06'
B	ADD SCREW TYPE	DMJ 06/27/07'	~~~~~	LJC 06/27/07'
C	整理图面	YCH 05/21/08'	~~~~~	LJC 05/21/08'
F	ADD Pos TYPE	JLZ 03/29/16'	~~~~~	

NOTES:

1. ELECTRICAL CHARACTERISTICS:

- 1.1 CONTACT RESISTANCE: 20mΩ Max. INITIAL.
- 1.2 DIELECTRIC WITHSTANDING VOLTAGE: 500V AC(rms) FOR 1 MINUTE.
- 1.3 INSULATION RESISTANCE: 1000MΩ Min.

2. ENVIRONMENT CHARACTERISTICS:

- TEMPERATURE RANGE: -40°C~+105°C.

3. PART NUMBER: DS1034

4. PRODUCT NUMBER CODE:

DS1034- X X X X X X X X

SCREW DIM. A

S: Standard(W/O nut)

1: 5.00 2: 3.00 3: 5.20

4: 4.80 5: 5.80 6: 4.00

7: 4.80mm(Inside thread M2.6*0.45p, outside thread unc#4-40)

8: 4.80mm(Inside thread M3.0*0.5p, outside thread unc#4-40)

SCREW TYPE

S: Standard(W/O nut)

1: CC TYPE 2: CS TYPE

3: BR TYPE 4: BRJ TYPE DIM. B:6.00 C: 3~4mm

5: BRJ TYPE DIM. B:6.00 C: 5~6mm

6: BRJ TYPE DIM. B:6.00 C: 3~4mm (Inside thread M2.6*0.45P,outside thread unc#4-40)

7: BRJ TYPE DIM. B:6.00 C: 3~4mm (Inside thread M3.0*0.50P,outside thread unc#4-40)

CONTACT PLATING

Si: FULL GOLD FLASH

0: SELECTIVE GOLD FLASH

SHELL PLATING

T: FORNT & BACK SHELL TIN

N: FORNT SHELL NICKEL,BACK SHELL TIN

HOUSING COLOR

B: BLACK W: WHITE

U: BLUE

CONNECTOR TYPE

M: MALE F: FEMALE

No.OF CONTACTS

09: 9pos. 15: 15pos. 25: 25pos.

37: 37pos. 50: 50pos.

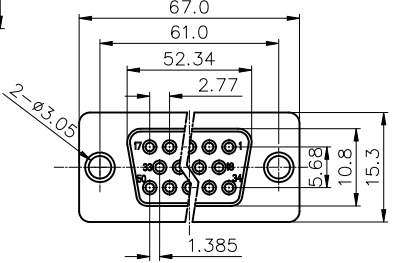
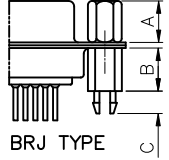
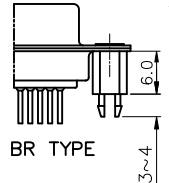
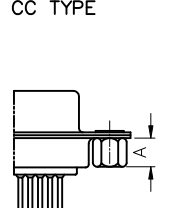
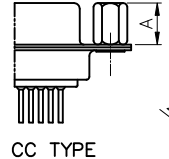
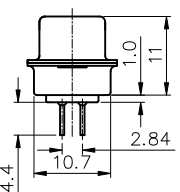
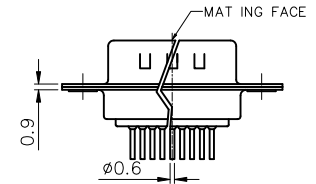
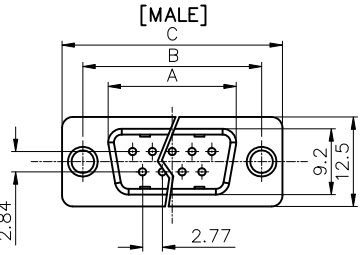
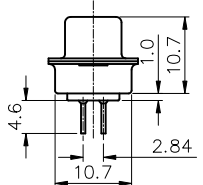
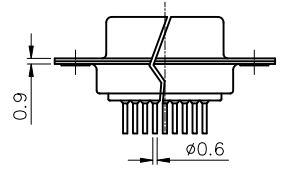
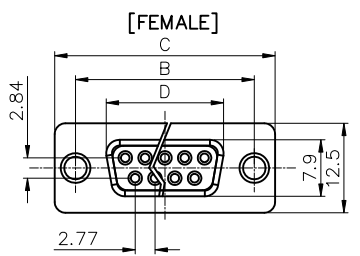

50pin Female Figure

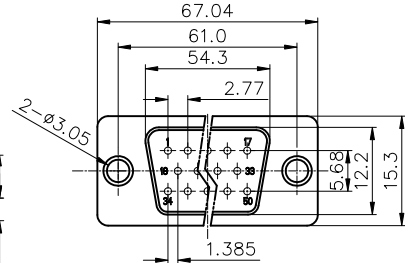

50pin Male Figure

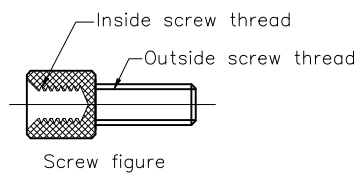

Screw figure

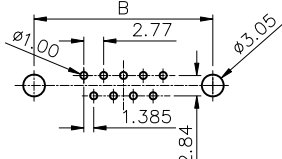

RECOMMEND PCB LAYOUT (TOLERANCE ±0.05)

Dimension

Position	A±0.2	B±0.2	C±0.3	D
9	17.90	24.99	30.80	16.33
15	26.50	33.32	39.14	24.66
25	40.00	47.04	53.04	38.38
37	56.50	63.50	69.32	54.84

GENERAL TOLERANCE		ANGLE TOLERANCE	
X.	±0.60	X.	±5°
.X	±0.38	.X	±3°
.XX	±0.25	.XX	±2°

DRAWING TYPE	CUSTOMER		
SCALE	1:1	SHEET	1 OF 1
DRAWING NO.	C-DS1034-XXXXXXX-F		

PROJECTION	TITLE	D-SUB DIP STRAIGHT TYPE	
UNITS	mm	SERIES	DS1034 SERIES

晨翔电子有限公司
CONNFLY CONNFLY ELECTRONIC CO. LTD

X-ON Electronics

Largest Supplier of Electrical and Electronic Components

Click to view similar products for [ninigi manufacturer](#):

Other Similar products are found below :

[AWP-14](#) [AWP-20](#) [AWP-40](#) [AC142R-03P-5.08-GRAY](#) [AWP-08](#) [AWP-14K](#) [AWP-14ZZ](#) [AWP-20ZZ](#) [AWP-34](#) [BNC-006-L](#) [BNC-101](#)
[ZL265-16SG](#) [DS1018-10SIBX](#) [DS1018-16SIBX](#) [DS1018-20SIBX](#) [DS1018-34SIBX](#) [DS1011-20SBSIB7](#) [DS1011-26SBSIB7](#) [DS1011-](#)
[34RBSIB7](#) [DS1011-40RBSIB7](#) [DS1018-14SIBX](#) [DS1018-26SIBX](#) [DS1011-26RBSIB7](#) [DS1011-40SBSIB7](#) [ZL264-8DG](#) [N42G-10](#) [TUL-NI-](#)
[04012](#) [DS25P](#) [IND16-12G-C](#) [NSLG-3X5](#) [JUMPER-H/B](#) [ZL265-20SG](#) [TACT-2BRRD](#) [ZDIN-CF-96K](#) [ST-ASS-TTAP50SET-R](#) [IND10P-](#)
[24R-C](#) [ST-ASS-36-HSBC](#) [N42W-20](#) [ST-ASS-30-HST3-1](#) [ZL306-10](#) [NCDW-08](#) [N42G-04](#) [ST-0902/1](#) [IND10P-230G-W](#) [ST-ASS-90-HST2-](#)
[1](#) [IND22-12R-C](#) [TB-7.5-P-3P/GY](#) [IND22-12G-S](#) [ST-ASS-QSY](#) [ZL262-24DG](#)