

TSM102A1

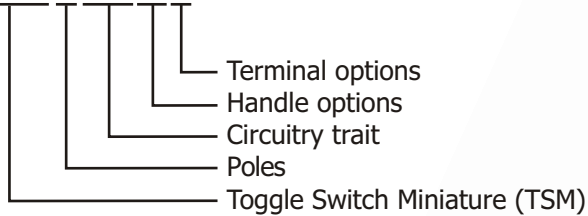

Specification:

- 1) Rating: 6 A 125 VAC; 3 A 250 VAC
- 2) Contact Resistance: 20 mW max.
- 3) Insulation Resistance: 500 VDC 1000 MW min.
- 4) Dielectric strength: 1500 VAC, 1 minute
- 5) Operating Temperature: -25°C ~ +85°C
- 6) Electrical Life: 20000 cycles

CIRCUITRY TRAIT

Model No			Terminals
101	ON	-	2P
102	ON	-	3P
112	ON	-	(ON) 3P
103	ON	OFF	3P
113	ON	OFF	(ON) 3P
123	(ON)	OFF	(ON) 3P
201	ON	-	4P
202	ON	-	6P
212	ON	-	(ON) 6P
203	ON	OFF	6P
213	ON	OFF	(ON) 6P
223	(ON)	OFF	(ON) 6P

TOGGLE CAP (D)

omitted when without toggle cap

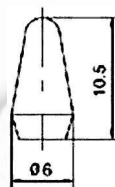

- BK black
- WH white
- RD red
- YL yellow
- GN green
- BL blue

BASE COLOUR

- BK black
- RD red
- GN green
- omitted when standard colour (blue)

PROTECTIV CAP

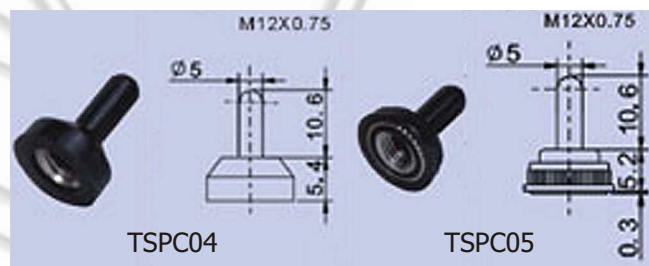

HANDLE OPTIONS

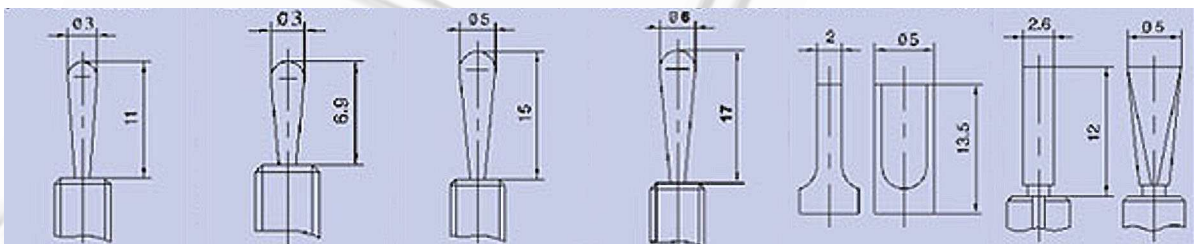

Standard (A) Short (C) Grand (G) Large cap (L) Plastic Flat (E) Metal Flat (F)

TERMINAL OPTIONS

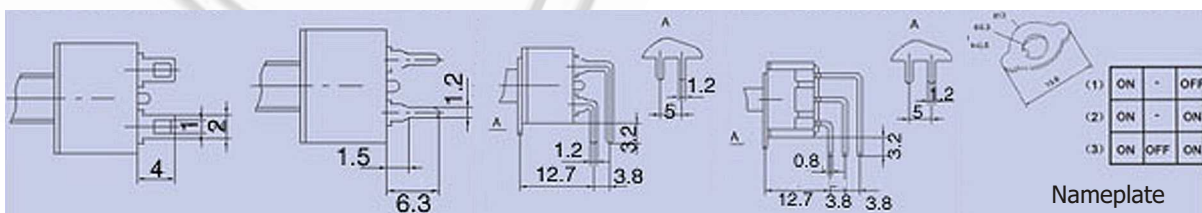

Solder terminal (1) PC terminal (2) PC-H terminal (3) PC-V terminal (4)

Ninigi



TSM101 ON-OFF
SPST 2P

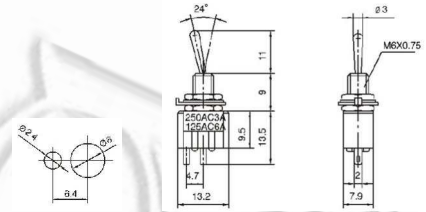

TSM102 ON-ON
TSM112 ON-(ON)
TSM103 ON-OFF-ON
TSM113 ON-OFF-(ON)
TSM123 (ON)-OFF-(ON)
TSM1033 ON-ON-ON
SPDT 3P

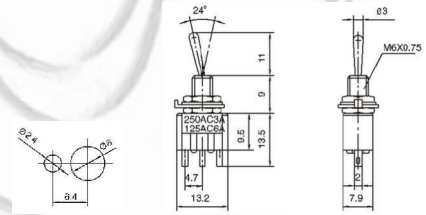

TSM201 ON-OFF
DPST 4P

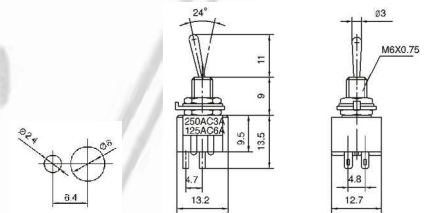

TSM202 ON-ON
TSM212 ON-(ON)
TSM203 ON-OFF-ON
TSM213 ON-OFF-(ON)
TSM223 (ON)-OFF-(ON)
TSM2033 ON-ON-ON
DPDT 6P

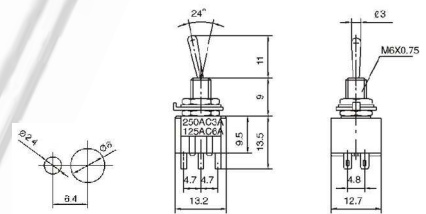

TSM302 ON-ON
TSM303 ON-OFF-ON
3PST 2P

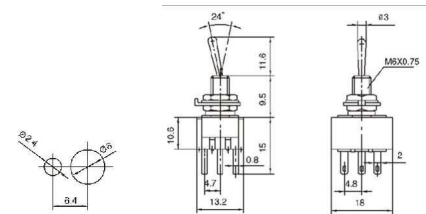

TSM101A2 ON-OFF
SPST 2P

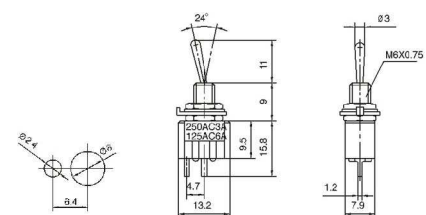

Ninigi



TSM102A2 ON-ON
TSM112A2 ON-(ON)
TSM103A2 ON-OFF-ON
TSM113A2 ON-OFF-(ON)
TSM123A2 (ON)-OFF-(ON)
 SPDT 3P

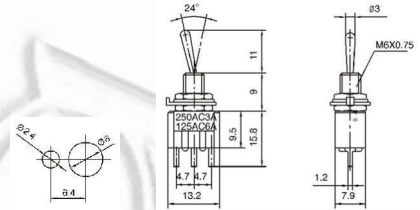

TSM201A2 ON-OFF
 DPST 4P

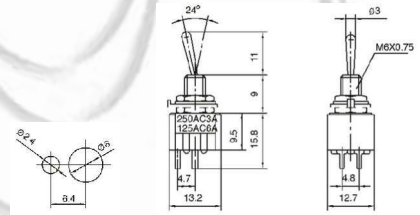

TSM202A2 ON-ON
TSM212A2 ON-(ON)
TSM203A2 ON-OFF-ON
TSM213A2 ON-OFF-(ON)
TSM223A2 (ON)-OFF-(ON)
 SPDT 3P

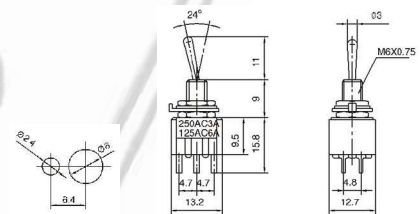

TSM302A2 ON-ON
TSM303A2 ON-OFF-ON
 3PST 9P

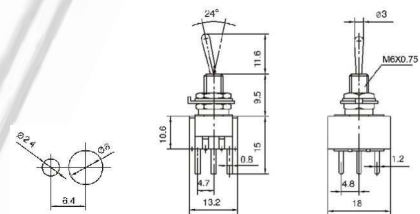

TSM102A2T ON-ON
TSM112A2T ON-(ON)
TSM103A2T ON-OFF-ON
TSM113A2T ON-OFF-(ON)
TSM123A2T (ON)-OFF-(ON)
 SPDT 3P

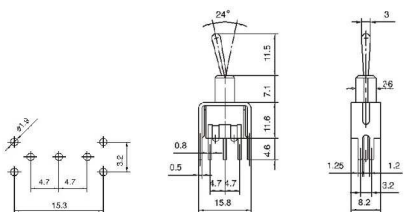

TSM202A2T ON-ON
TSM212A2T ON-(ON)
TSM203A2T ON-OFF-ON
TSM213A2T ON-OFF-(ON)
TSM223A2T (ON)-OFF-(ON)
 DPDT 6P

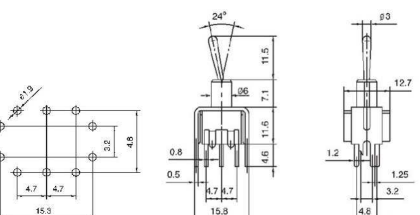

Ninigi



TSM102C3 ON-ON
TSM112C3 ON-(ON)
TSM103C3 ON-OFF-ON
TSM113C3 ON-OFF-(ON)
TSM123C3 (ON)-OFF-(ON)
 SPDT 3P

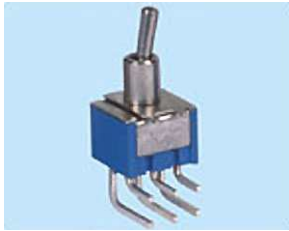
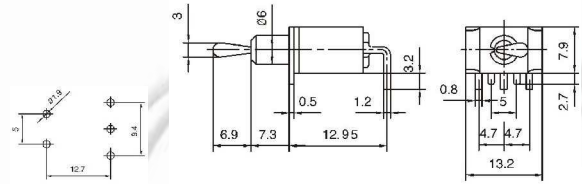

TSM202C3 ON-ON
TSM212C3 ON-(ON)
TSM203C3 ON-OFF-ON
TSM213C3 ON-OFF-(ON)
TSM223C3 (ON)-OFF-(ON)
 DPDT 3P

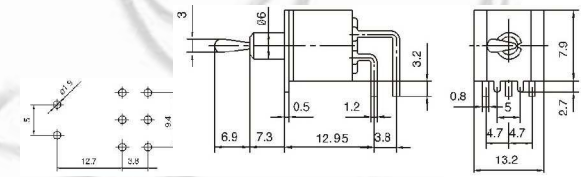

TSM102C4 ON-ON
TSM112C4 ON-(ON)
TSM103C4 ON-OFF-ON
TSM113C4 ON-OFF-(ON)
TSM123C4 (ON)-OFF-(ON)
 SPDT 3P

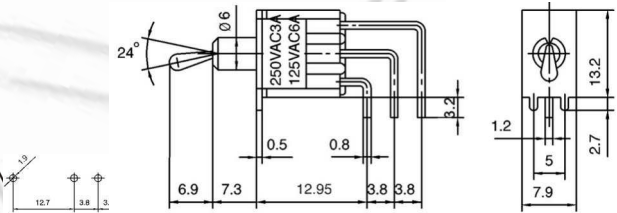

TSM202C4 ON-ON
TSM212C4 ON-(ON)
TSM203C4 ON-OFF-ON
TSM213C4 ON-OFF-(ON)
TSM223C4 (ON)-OFF-(ON)
 DPDT 6P

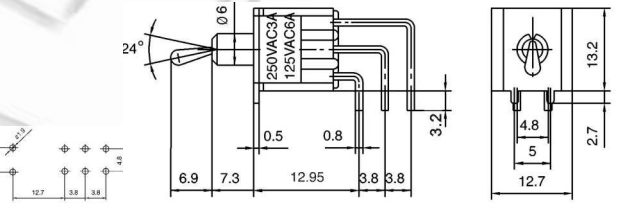

TSM101E1 ON-OFF
 SPST 2P
 (PLASTIC FLAT LEVER)

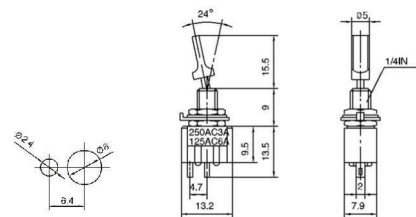

TSM102E1 ON-ON
TSM112E1 ON-(ON)
TSM103E1 ON-OFF-ON
TSM113E1 ON-OFF-(ON)
TSM123E1 (ON)-OFF-(ON)
 SPDT 3P
 (PLASTIC FLAT LEVER)

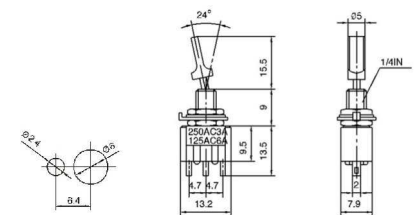

Ninigi



TSM202E1 ON-ON
TSM212E1 ON-(ON)
TSM203E1 ON-OFF-ON
TSM213E1 ON-OFF-(ON)
TSM223E1 (ON)-OFF-(ON)
 DPDT 6P
 (PLASTIC FLAT LEVER)

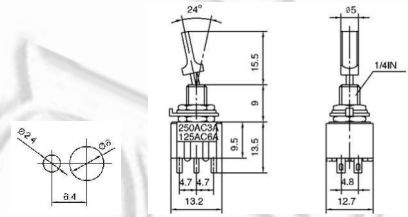

TSM101F1 ON-OFF
 SPST 2P
 (METAL FLAT LEVER)

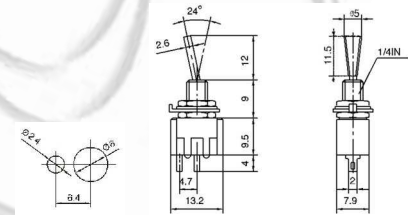

TSM102F1 ON-ON
TSM112F1 ON-(ON)
TSM103F1 ON-OFF-ON
TSM113F1 ON-OFF-(ON)
TSM123F1 (ON)-OFF-(ON)
 SPDT 3P
 (METAL FLAT LEVER)

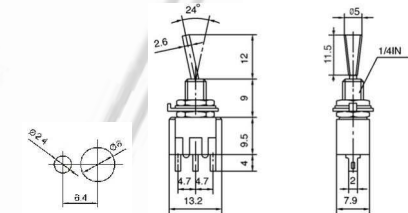

TSM202F1 ON-ON
TSM212F1 ON-(ON)
TSM203F1 ON-OFF-ON
TSM213F1 ON-OFF-(ON)
TSM223F1 (ON)-OFF-(ON)
 DPDT 6P
 (METAL FLAT LEVER)

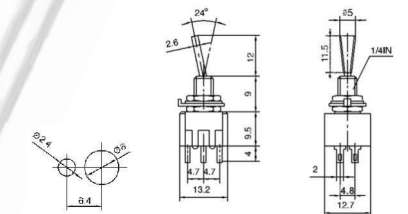

X-ON Electronics

Largest Supplier of Electrical and Electronic Components

Click to view similar products for [Toggle Switches](#) category:

Click to view products by [Ninigi](#) manufacturer:

Other Similar products are found below :

[8928K478](#) [8A1-C-222](#) [020017-13](#) [60012L](#) [6006L](#) [CS115W](#) [CS120W](#) [6663](#) [7101SPDV30BE](#) [7103SDV30BE](#) [7105D](#) [7108P3YAV2BE](#)
[71YY50282](#) [7300K36](#) [7301K38](#) [7306K36](#) [7310K36](#) [7506K4](#) [7592K6](#) [7660K12](#) [7691K14](#) [7700K1](#) [8391K108](#) [8396K108](#) [8812K14](#)
[8824K14](#) [8828K13](#) [8835K3](#) [8858K44](#) [PS83-121G](#) [1-1825192-0](#) [A201SCWZB04](#) [A207SYCB04](#) [A208J61ZQ0004](#) [A221T1TCQ](#)
[A232M1YCQ](#) [A323S1CWZQ](#) [A423S1CWZG-M8](#) [1201W](#) [12149A-3V](#) [12156AX408](#) [12147AGKX679](#) [12246X778](#) [12TW49-3D](#) [130312](#)
[13037L](#) [13001X](#) [AE101MD1W4B04](#) [AE208SD1W4B04](#) [MS24659-22D](#)