

TYPICAL INDICATOR ORDERING EXAMPLE

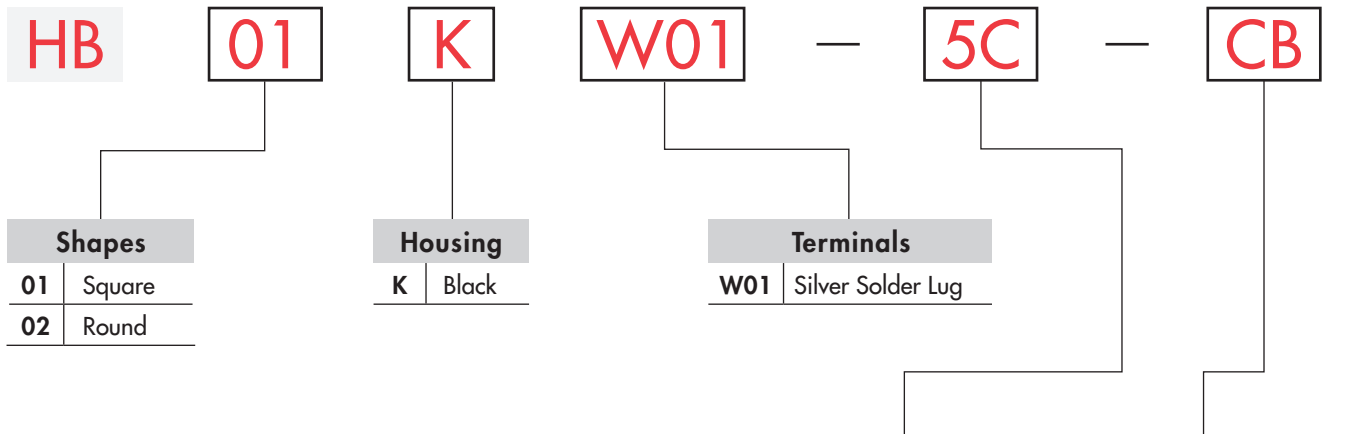

DESCRIPTION FOR TYPICAL ORDERING EXAMPLE

HB01KW01-5C-CB

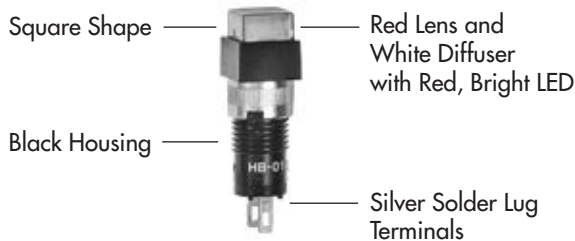

LEDs		Cap Types & Colors	
Bright		LED Cap: Lens/Diffuser Color	
5C	Red	CB	Red/White
5D	Amber	DB	Amber/White
5F	Green	FB	Green/White
		JB	Clear/White
Super Bright		LED Cap: Lens/Diffuser Color	
6B	White	JB	Clear/White
6F	Green		
6G	Blue		

LED COLORS & SPECIFICATIONS

The electrical specifications shown are determined at a basic temperature of 25°C.
 LED circuit is isolated and requires external power source. Single element LED is colored in OFF state.
 If the source voltage exceeds the rated voltage, a ballast resistor is required.
 The resistor value can be calculated by using the formula in the Supplement section.

Bright AT633	Note for Super Bright:	Color	Bright			Super Bright			Unit	
			5C	5D	5F	6B	6F	6G		
Super Bright AT624G Blue		Red	Amber	Green	White	Green	Blue	mA		
AT629B White		Maximum Forward Current	I_{FM}	30	30	30	30	30	30	mA
AT630F Green		Typical Forward Current	I_F	20	20	20	20	20	mA	
		Forward Voltage	V_F	1.95	2.0	2.1	3.3	3.3	3.3	V
		Maximum Reverse Voltage	V_{RM}	5	5	5	7	7	7	V
		Current Reduction Rate Above 25°C	ΔI_F	0.42	0.42	0.42	0.40	0.40	0.40	mA/°C
T-1 Bi-pin		Ambient Temperature Range		-25° ~ +50°C			-25° ~ +50°C			

Toggles
 Rockers
 Pushbuttons
 Illuminated PB
 Programmable
 Keylocks
 Rotaries
 Slides
 Tactiles
 Tilt
 Touch
 Indicators
 Accessories
 Supplement

CAP TYPES & COLORS

Colored Cap for Bright LEDs

Lens/Diffuser
Colors Available:

- CB** Red/White
- DB** Amber/White
- FB** Green/White

AT4168
Square

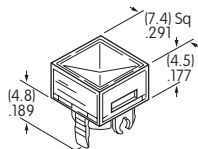

AT4169
Round

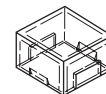
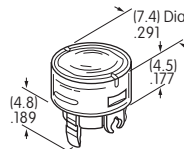

Transparent Colored Lens



Translucent White Diffuser



Colored LED AT633

Material: Polycarbonate Finish: Glossy

White Cap for Bright & Super Bright LEDs

JB Clear Lens/
White Diffuser

Material: Polycarbonate
Finish: Glossy

AT4033
Square

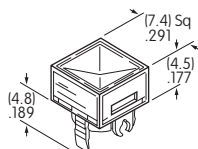

AT4034
Round

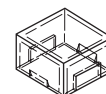
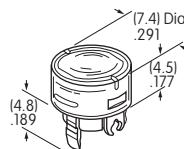

Transparent Clear Lens



Translucent White Diffuser



Colored LEDs AT624, AT629, AT630, or AT633

TYPICAL INDICATOR DIMENSIONS

Square

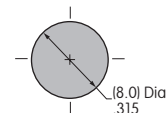
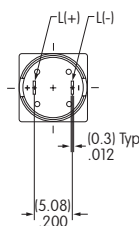
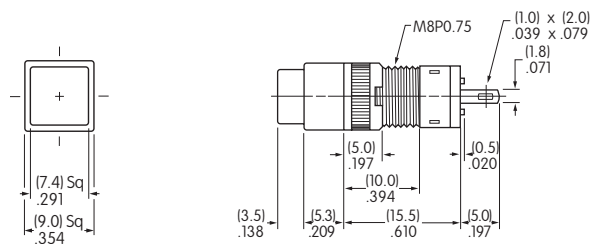

Recommended Panel Thickness: .020" ~ .197" (0.5 ~ 5.0mm)



HB01KW01-5C-CB

Round

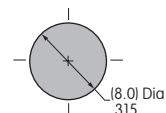
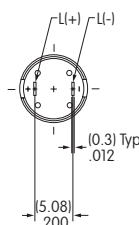
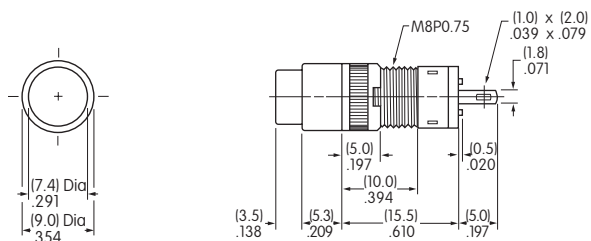

Recommended Panel Thickness: .020" ~ .197" (0.5 ~ 5.0mm)



HB02KW01-5C-CB

X-ON Electronics

Largest Supplier of Electrical and Electronic Components

Click to view similar products for [Industrial Panel Mount Indicators / Switch Indicators](#) category:

Click to view products by [NKK Switches](#) manufacturer:

Other Similar products are found below :

[LW1A-P1-GD](#) [LW1A-P1-W](#) [01-931.3](#) [01-152.025](#) [73.362.4028.0](#) [750-1520](#) [9001OA120](#) [A0142N5](#) [A3DT-500Y](#) [AL6M-LK3-R](#) [AL6M-P7P-A](#) [AOLQW-2B0600](#) [AP1M255-A](#) [APD106LN-G](#) [APD106LN-S](#) [APN1126-G](#) [APS122DN-W](#) [ASLWLD-G](#) [ASLWLD-R](#) [ATN2100](#) [AYLW4L-A](#) [18-237.035](#) [18-945](#) [HW1A-L1-GD](#) [HW1A-P2-GL](#) [HW1X-BM411-R](#) [HW2A-L1-GL](#) [HW2A-P1-GD](#) [HWAZ1N-OB](#) [PA2100/2](#) [PA2200/1](#) [PA2SHIELD](#) [PAMR25](#) [LA3P-1C03V-Y](#) [96-923.5](#) [A0244J2](#) [LSPD-120A](#) [LSPD-1Y](#) [LSPD-6A](#) [LSPD-6DA](#) [LSPD-6DW](#) [LSPD-6DY](#) [LSPD-6R](#) [LSPD-6W](#) [18-946](#) [AL6H-LK3-A](#) [AL6H-P4-JW](#) [AL6M-LK1-MG](#) [AP8M155-G](#) [APD106LN-W](#)