

MB2065VA001

Bushing Mount • Single Pole • Solder Lug

Dimensions in mm/inch

PANEL CUTOUT

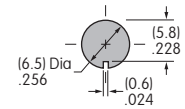
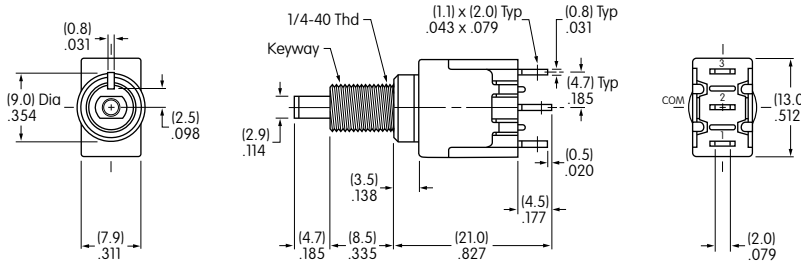

Panel Thickness:  
.134" (3.4mm) Maximum

BASE SWITCH

SPLASHPROOF BOOT

AT4042H  
Splashproof Boot



Part Number  
MB2065SS1W01/CUL

Color: Black  
Material: Silicone rubber  
Operating life:  
30,000 operations  
Sealing: IP65 rated

Installation Instructions

1. Insert switch bushing from back of panel into the cutout hole and adjust height of bushing above the panel to a minimum of .098" (2.5mm) and a maximum of .138" (3.5mm).
2. Screw the boot onto the bushing. Tighten the hexagon nut on the back of panel to complete.

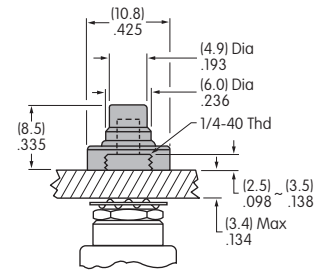

STANDARD HARDWARE

AT513H Hexagon Nut

1 included with each switch

Material:  
Brass with Nickel plating

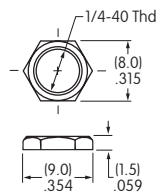

AT509 Lockwasher

1 included with each switch

Material:  
Steel with Zinc/Chromate

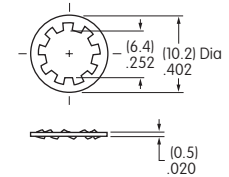

POLES & CIRCUITS

| Pole | Model  | Plunger Position |      | Connected Terminals |      | Throw & Switch Schematics                                  |
|------|--------|------------------|------|---------------------|------|--|
|      |        | Normal           | Down | Normal              | Down |  |
| SP   | MB2065 | ON               | ON   | 2-3                 | 2-1  | Note: Terminal numbers are not actually on the switch.<br> |

On alternate action models, after transferring circuit, the plunger returns to its original position and does not latch down.

CONTACT MATERIALS & RATINGS

Silver over Silver

Power Level

6A @ 125V AC & 3A @ 250V AC

# Base Switch Specifications

## Electrical Capacity (Resistive Load)

**Power Level (silver):** 6A @ 125V AC & 3A @ 250V AC

## Other Ratings

**Contact Resistance:** 10 milliohms maximum  
**Insulation Resistance:** 1,000 megohms minimum @ 500V DC  
**Dielectric Strength:** 1,000V AC minimum between contacts for 1 minute minimum;  
 1,500V AC minimum between contacts & case for 1 minute minimum  
**Mechanical Life:** 100,000 operations minimum  
**Electrical Life:** 25,000 operations minimum  
**Nominal Operating Force:** 4.41N  
**Contact Timing:** Slow make, slow break  
**Plunger Travel:** Pretravel .110" (2.80mm)  
 Overtravel .043" (1.09mm)  
 Total Travel .153" (3.90mm)

## Materials & Finishes

**Plunger:** Brass with nickel plating  
**Bushing:** Brass with nickel plating  
**Frame:** Stainless steel  
**Case:** Diallyl phthalate resin (UL94V-0)  
**Movable Contactor:** Phosphor bronze with silver plating  
**Movable Contacts:** Silver alloy  
**Stationary Contacts:** Silver with silver plating  
**Terminals:** Copper or brass with silver plating

## Environmental Data

**Operating Temperature Range:** -30°C through +85°C (-22°F through +185°F)  
**Humidity:** 90 ~ 95% humidity for 96 hours @ 40°C (104°F)  
**Vibration:** 10 ~ 55Hz with peak-to-peak amplitude of 1.5mm traversing the frequency range and returning in 1 minute; 3 right angled directions for 2 hours  
**Shock:** 50G (490m/s<sup>2</sup>) acceleration (tested in 6 right angled directions, with 5 shocks in each direction)  
**RoHS Compliant:** 

## Installation

**Mounting Torque:** 0.7Nm (6.0 lb·in)  
**Soldering Time & Temperature:** Manual Soldering: 390°C for 4 seconds maximum, 2 cycles  
**Process Seal:** These devices are not process sealed. Hand clean locally using alcohol based solution.

## Standards & Certifications

**Flammability Standards:** UL94V-0 case  
**UL:** **File No. E44145**  
 "/CUL" at end of part number for UL recognized switch.  
 Models recognized at 6A @ 125V AC or 3A @ 250V AC.

## X-ON Electronics

Largest Supplier of Electrical and Electronic Components

*Click to view similar products for [Pushbutton Switches](#) category:*

*Click to view products by [NKK Switches](#) manufacturer:*

Other Similar products are found below :

[8940K2012](#) [LW1L-M1C10V-A](#) [LW1L-M1C70-A](#) [LW2L-A1C20M-GD](#) [LW2L-M1C20M-A](#) [60324L](#) [M22-D-R-GB0/K11](#) [M7E-HRN2](#)  
[67021K512](#) [67081K512X](#) [701PB580](#) [7199K101](#) [810K12910](#) [810KSV30B](#) [MML21EA2ADK](#) [MML21KA3ABK](#) [MML23KA3AC05K-001](#)  
[MML23KW3AA01W](#) [8418K2](#) [8442K3](#) [8450K1](#) [860K11911T01A](#) [861901](#) [861K11911T01A07](#) [861K13810T00A14](#) [861K13911](#)  
[8646AB6X718UL](#) [8646ABUL](#) [9001KXRK](#) [907AYY100](#) [PMHD155A1](#) [9533CD4+U574+U4922](#) [95-414.000](#) [99-450.837](#) [99-453.837](#)  
[PV3H2B0NN-341](#) [1203MRA](#) [A22NZBGANGA](#) [A22NZBMMNGA](#) [A22NZBNANGA](#) [A22NZMPATRA](#) [A2PMA1X03EC56](#) [A3A-5123-02](#)  
[A3A-7140](#) [A3A-7310](#) [A3A-7340](#) [A3U-TMW-A2C-5M](#) [A595](#) [12037A2ULCSA](#) [ABD122N-B](#)