

DESCRIPTION: 2MM RECEPTACLES - TR/TC

UNITS = INCHES [MM]

MATERIAL:

HOUSING: NYLON 6T, UL 94V-0, BLACK
 CONTACT: PHOSPHOR BRONZE
 PLATING: GOLD FLASH ENTIRE CONTACT

ELECTRICAL:

CURRENT RATING: 2 AMPS
 CONTACT RESISTANCE: 20mOHMS Max.
 INSULATOR RESISTANCE: 5,000MOHMS Min.
 DIELECTRIC WITHSTANDING: 500VAC
 OPERATING TEMPERATURE: -40° TO +105° C
 PROCESS TEMPERATURE: 260° C FOR 10 SECONDS

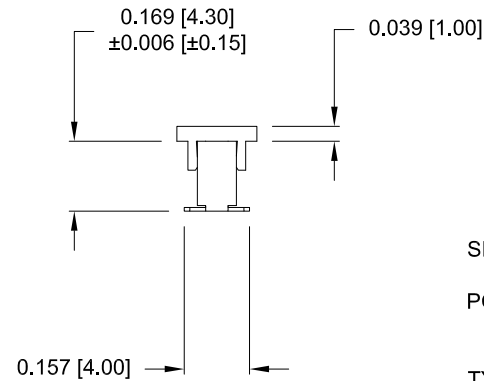
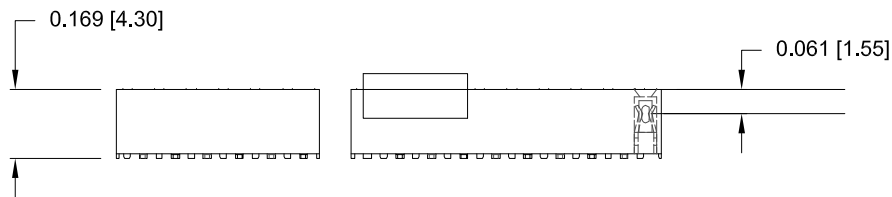
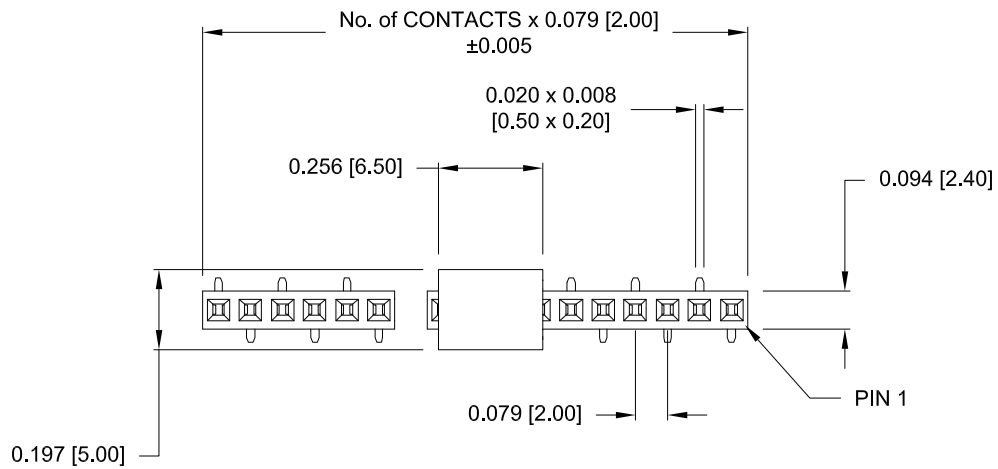

2863 YY 06 R P2 YY

SERIES _____
 2863 = SINGLE ROW
 POSITIONS _____
 SINGLE - INCREMENTS OF 1
 (3 TO 40)
 TYPE _____
 06 = SURFACE MOUNT
 RoHS COMPLIANT _____
 HIGH TEMP.
 PLATING _____
 P2 = GOLD FLASH
 PACKAGING _____
 TR = TAPE AND REEL
 TC = TUBE PACK WITH PP CAP

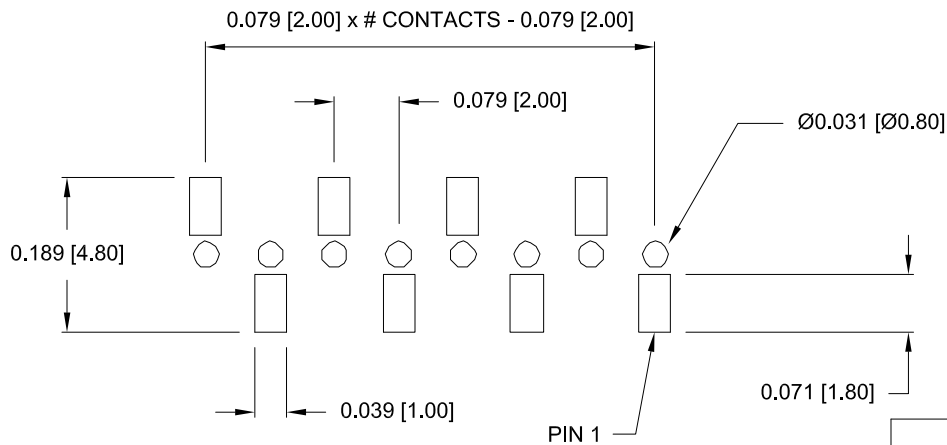

PCB LAYOUT

GENERAL TOLERANCE = $\pm 0.008 [\pm 0.20]$

DO NOT SCALE FROM DRAWING



THESE DRAWINGS AND SPECIFICATIONS ARE THE PROPERTY OF NorComp AND SHALL NOT BE REPRODUCED, COPIED OR USED AS THE BASIS FOR THE MANUFACTURE OR SALE OF APPARATUS WITHOUT WRITTEN PERMISSION.

DRAWN: J. KADEL		DATE: 01/11/2019	
SCALE: NTS	SHEET 1	OF 1	REV 0
DWG NO. 2863YY06RP2YY			

RoHS COMPLIANT

NorComp

X-ON Electronics

Largest Supplier of Electrical and Electronic Components

Click to view similar products for [Headers & Wire Housings](#) category:

Click to view products by [NorComp](#) manufacturer:

Other Similar products are found below :

[892-18-020-10-001101](#) [58102-G61-06LF](#) [582553-1](#) [0009485154](#) [009176003701906](#) [0050291907](#) [LY20-4P-DT1-P1E-BR](#) [02.125.8002.8](#)
[609-3404](#) [61062-3](#) [622-0430](#) [622-3653LF](#) [63453-116](#) [636-1030](#) [636-1427](#) [636-3427](#) [636-4007](#) [641938-9](#) [641991-4](#) [644827-2](#) [65817-010LF](#)
[65817-015LF](#) [65863-015LF](#) [66207-023LF](#) [67095-007LF](#) [67601157](#) [68648-049](#) [70.362.1628.0](#) [70-4210](#) [70-4226B](#) [70-4853B](#) [707-5020](#) [707-](#)
[5028](#) [71.350.2428.0](#) [71918-208LF](#) [71961-016LF](#) [733-134](#) [733-162](#) [754199-000](#) [760-3052](#) [787-8014-00](#) [79531-3000](#) [FCN-360C032-B](#) [FCN-](#)
[367T-T012/H](#) [FCN-723D010/2](#) [80.063.4001.1](#) [800-90-001-10-001000](#) [800-90-010-10-002000](#) [801-43-002-10-013000](#) [801-43-006-10-002000](#)