

DESCRIPTION: 2MM RECEPTACLES - TR/TC

UNITS = INCHES [MM]

**MATERIAL:**

HOUSING: NYLON 6T, UL 94V-0, BLACK  
 CONTACT: PHOSPHOR BRONZE  
 PLATING: GOLD FLASH ENTIRE CONTACT

**ELECTRICAL:**

CURRENT RATING: 2 AMPS  
 CONTACT RESISTANCE: 20mOHMS Max.  
 INSULATOR RESISTANCE: 5,000MOHMS Min.  
 DIELECTRIC WITHSTANDING: 500VAC  
 OPERATING TEMPERATURE: -40° TO +105° C  
 PROCESS TEMPERATURE: 260° C FOR 10 SECONDS

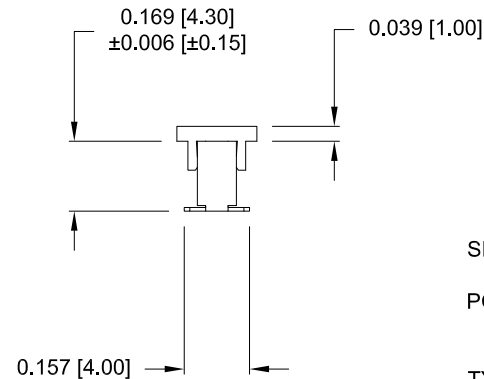
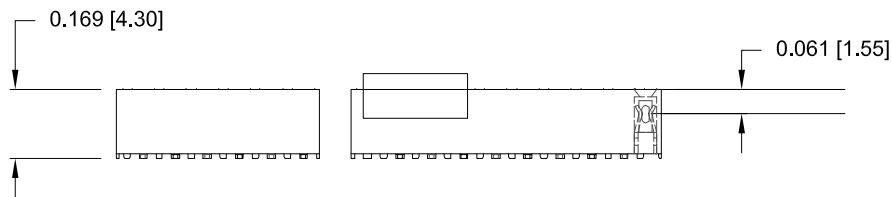
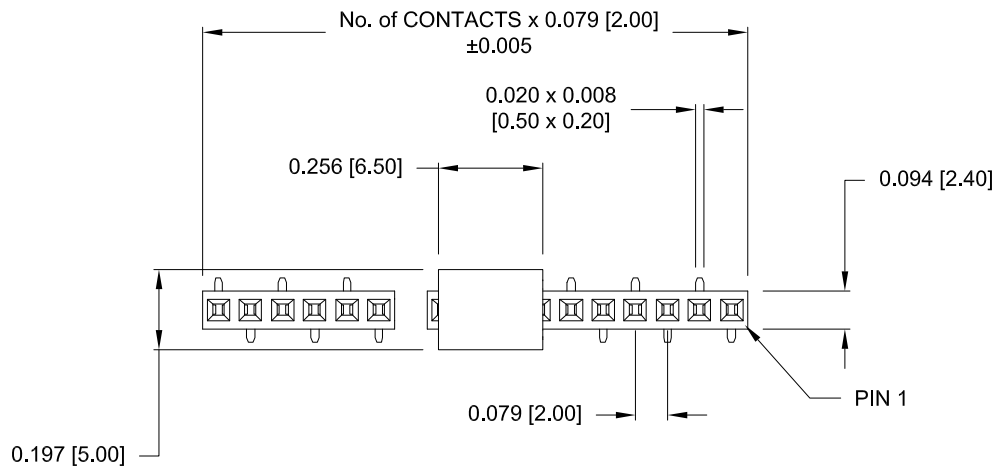

**2863 YY 06 R P2 YY**

SERIES \_\_\_\_\_  
 2863 = SINGLE ROW  
 POSITIONS \_\_\_\_\_  
 SINGLE - INCREMENTS OF 1  
 (3 TO 40)  
 TYPE \_\_\_\_\_  
 06 = SURFACE MOUNT  
 RoHS COMPLIANT \_\_\_\_\_  
 HIGH TEMP.  
 PLATING \_\_\_\_\_  
 P2 = GOLD FLASH  
 PACKAGING \_\_\_\_\_  
 TR = TAPE AND REEL  
 TC = TUBE PACK WITH PP CAP

GENERAL TOLERANCE = ±0.008 [±0.20]

**DO NOT SCALE FROM DRAWING**

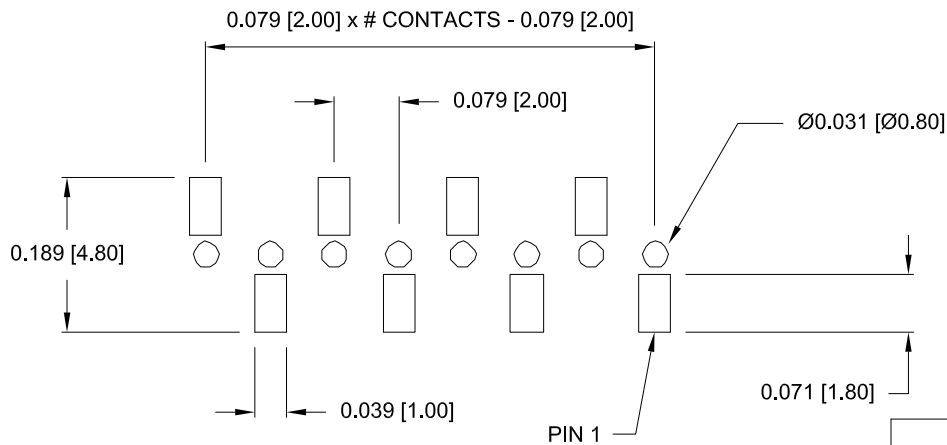

PCB LAYOUT

**RoHS COMPLIANT**



THESE DRAWINGS AND SPECIFICATIONS ARE THE PROPERTY OF NorComp AND SHALL NOT BE REPRODUCED, COPIED OR USED AS THE BASIS FOR THE MANUFACTURE OR SALE OF APPARATUS WITHOUT WRITTEN PERMISSION.

DRAWN: J. KADEL		DATE: 01/11/2019	
SCALE: NTS	SHEET 1	OF 1	REV 0
DWG NO. 2863YY06RP2YY			

**NorComp**

## X-ON Electronics

Largest Supplier of Electrical and Electronic Components

*Click to view similar products for [Headers & Wire Housings](#) category:*

*Click to view products by [NorComp](#) manufacturer:*

Other Similar products are found below :

[892-18-020-10-001101](#) [58102-G61-06LF](#) [582553-1](#) [0009485154](#) [009176003701906](#) [0050291907](#) [LY20-4P-DT1-P1E-BR](#) [02.125.8002.8](#)  
[609-3404](#) [61062-3](#) [61082-181009](#) [622-3653LF](#) [63453-116](#) [636-1030](#) [636-1427](#) [636-3427](#) [636-4007](#) [641938-9](#) [641991-4](#) [644827-2](#) [65817-](#)  
[010LF](#) [65817-015LF](#) [65863-015LF](#) [66207-023LF](#) [67095-007LF](#) [67601157](#) [68648-049](#) [70.362.1628.0](#) [70-4210](#) [70-4226B](#) [70-4853B](#) [707-](#)  
[5020](#) [707-5028](#) [71.350.2428.0](#) [71918-208LF](#) [71961-016LF](#) [733-134](#) [733-162](#) [754199-000](#) [760-3052](#) [787-8014-00](#) [79531-3000](#) [FCN-](#)  
[360C032-B](#) [FCN-367T-T012/H](#) [FCN-723D010/2](#) [80.063.4001.1](#) [800-90-001-10-001000](#) [800-90-010-10-002000](#) [801-43-002-10-013000](#)  
[801-43-006-10-002000](#)