

NTE2517 (NPN) & NTE2518 (PNP) Silicon Complementary Transistors High Current Switch

Features:

- Low Saturation Voltage
- High Current Capacity and Wide ASO

Applications:

- Voltage Regulators
- Relay Drivers
- Lamp Drivers

Absolute Maximum Ratings: ($T_A = +25^\circ\text{C}$ unless otherwise specified)

Collector to Base Voltage, V_{CBO}	60V
Collector to Emitter Voltage, V_{CEO}	50V
Emitter to Base Voltage, V_{EBO}	6V
Collector Current, I_C	
Continuous	2.5A
Peak	5A
Collector Dissipation, P_C	
$T_A = +25^\circ\text{C}$	1.5W
$T_C = +25^\circ\text{C}$	10W
Operating Junction Temperature, T_J	$+150^\circ\text{C}$
Storage Temperature Range, T_{stg}	-55° to $+150^\circ\text{C}$

Electrical Characteristics: ($T_A = +25^\circ\text{C}$ unless otherwise specified)

Parameter	Symbol	Test Conditions	Min	Typ	Max	Unit
Collector Cutoff Current	I_{CBO}	$V_{CB} = 50\text{V}, I_E = 0$	–	–	100	nA
Emitter Cutoff Current	I_{EBO}	$V_{EB} = 4\text{V}, I_C = 0$	–	–	100	nA
DC Current Gain	h _{FE}	$V_{CE} = 2\text{V}, I_C = 100\text{mA}$	140	–	400	
		$V_{CE} = 2\text{V}, I_C = 2\text{A}$	35	–	–	
Gain Bandwidth Product	f _T	$V_{CE} = 10\text{V}, I_C = 50\text{mA}$	–	140	–	MHz

Electrical Characteristics (Cont'd): ($T_A = +25^\circ\text{C}$ unless otherwise specified)

Parameter	Symbol	Test Conditions	Min	Typ	Max	Unit
Output Capacitance NTE2517	C_{ob}	$V_{CB} = 10\text{V}, f = 1\text{MHz}$	-	10	-	pF
NTE2518			-	25	-	pF
Collector to Emitter Saturation Voltage NTE2517	$V_{CE(sat)}$	$I_C = 1\text{A}, I_B = 50\text{mA}$	-	110	300	mV
NTE2518			-	250	500	mV
Base to Emitter Saturation Voltage	$V_{BE(sat)}$	$I_C = 1\text{A}, I_B = 50\text{mA}$	-	0.85	1.2	V
Collector to Base Breakdown Voltage	$V_{(BR)CBO}$	$I_C = 10\mu\text{A}, I_E = 0$	60	-	-	V
Collector to Emitter Breakdown Voltage	$V_{(BR)CEO}$	$I_C = 1\text{mA}, R_{BE} = \infty$	50	-	-	V
Emitter to Base Breakdown Voltage	$V_{(BR)EBO}$	$I_E = 10\mu\text{A}, I_C = 0$	6	-	-	V
Turn-On Time	t_{on}	$I_C = 10\text{A}, I_{B1} = 10\text{A}, I_{B2} = 1\text{A}$	-	35	-	ns
Storage Time NTE2517	t_{stg}		-	550	-	ns
NTE2518			-	350	-	ns
Fall Time	t_f		-	30	-	ns

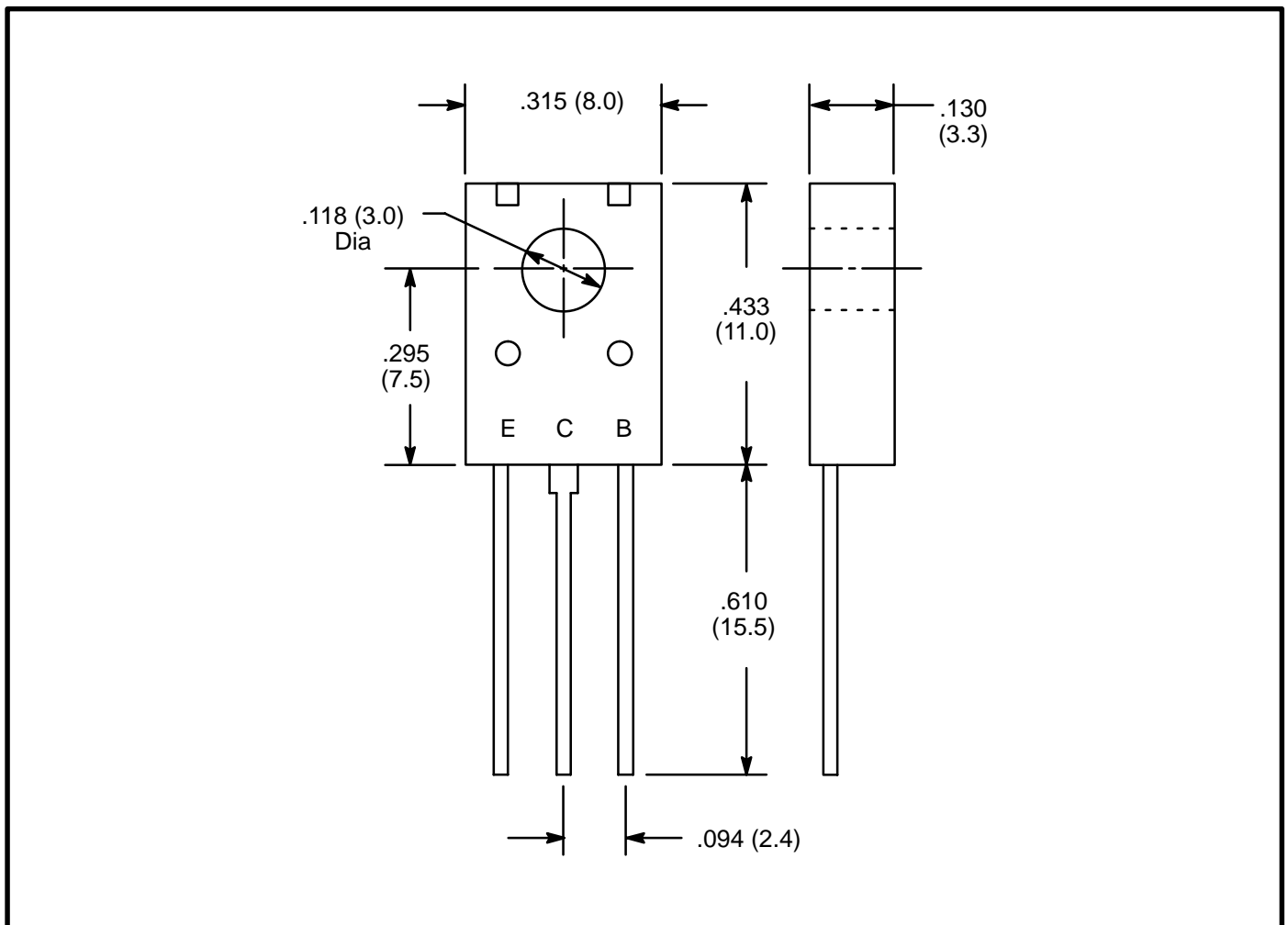

X-ON Electronics

Largest Supplier of Electrical and Electronic Components

Click to view similar products for [Bipolar Transistors - BJT category](#):

Click to view products by [NTE manufacturer](#):

Other Similar products are found below :

[619691C](#) [MCH4017-TL-H](#) [MJ15024/WS](#) [MJ15025/WS](#) [BC546/116](#) [BC556/FSC](#) [BC557/116](#) [BSW67A](#) [HN7G01FU-A\(T5L,F,T](#)
[NJVMJD148T4G](#) [NSVMMBT6520LT1G](#) [NTE187A](#) [NTE195A](#) [NTE2302](#) [NTE2330](#) [NTE2353](#) [NTE316](#) [IMX9T110](#) [NTE63](#) [NTE65](#)
[C4460](#) [SBC846BLT3G](#) [2SA1419T-TD-H](#) [2SA1721-O\(TE85L,F\)](#) [2SA1727TLP](#) [2SA2126-E](#) [2SB1202T-TL-E](#) [2SB1204S-TL-E](#) [2SC5488A-](#)
[TL-H](#) [2SD2150T100R](#) [SP000011176](#) [FMC5AT148](#) [2N2369ADCSM](#) [2SB1202S-TL-E](#) [2SC2412KT146S](#) [2SC4618TLN](#) [2SC5490A-TL-H](#)
[2SD1816S-TL-E](#) [2SD1816T-TL-E](#) [CMXT2207 TR](#) [CPH6501-TL-E](#) [MCH4021-TL-E](#) [BC557B](#) [TTC012\(Q\)](#) [BULD128DT4](#) [JANTX2N3810](#)
[Jantx2N5416](#) [US6T6TR](#) [KSF350](#) [068071B](#)