



ELECTRONICS, INC.  
 44 FARRAND STREET  
 BLOOMFIELD, NJ 07003  
 (973) 748-5089  
<http://www.nteinc.com>

## NTE2652 (PNP) & NTE2653 (NPN) Silicon Complementary Transistors High Current Driver

### Features:

- Low Saturation Voltage
- Large Current Capacity and Wide ASO

### Applications:

- Power Supplies
- Relay Drivers
- Lamp Drivers
- Electrical Equipment

### Absolute Maximum Ratings: ( $T_A = +25^\circ\text{C}$ unless otherwise specified)

Collector-Base Voltage, $V_{CBO}$ .....	60V
Collector-Emitter Voltage, $V_{CEO}$ .....	50V
Emitter-Base Voltage, $V_{EBO}$ .....	6V
Collector Current, $I_C$	
Continuous .....	3A
Pulsed .....	6A
Collector Dissipation, $P_C$ .....	1W
Junction Temperature, $T_J$ .....	+150°C
Storage Temperature Range, $T_{stg}$ .....	-55° to +150°C

### Electrical Characteristics: ( $T_A = +25^\circ\text{C}$ unless otherwise specified)

Parameter	Symbol	Test Conditions	Min	Typ	Max	Unit
Collector Cutoff Current	$V_{CBO}$	$V_{CB} = 40V, I_E = 0$	-	-	1.0	$\mu\text{A}$
Emitter Cutoff Current	$V_{EBO}$	$V_{EB} = 4V, I_C = 0$	-	-	1.0	$\mu\text{A}$
DC Current Gain	$h_{FE}$	$V_{CE} = 2V, I_C = 100\text{mA}$	140	-	560	
		$V_{CE} = 2V, I_C = 3A$	-	40	-	
Gain-Bandwidth Product	$f_T$	$V_{CE} = 10V, I_C = 50\text{mA}$	-	150	-	MHz
Output Capacitance	$C_{ob}$	$V_{CB} = 10V, f = 1\text{MHz}$	-	25	-	pF
Collector to Emitter Saturation Voltage NTE2652	$V_{CE(sat)}$	$I_C = 2A, I_B = 100\text{mA}$	-	0.19	0.5	V
			-	0.35	0.7	V
NTE2653						
Base to Emitter Saturation Voltage	$V_{BE(sat)}$	$I_C = 2A, I_B = 100\text{mA}$	-	0.94	1.2	V
Collector to Base Breakdown Voltage	$V_{(BR)CBO}$	$I_C = 10\mu\text{A}, I_E = 0$	60	-	-	V
Collector to Emitter Breakdown Voltage	$V_{(BR)CEO}$	$I_C = 1\text{mA}, R_{BE} = \infty$	50	-	-	V
Emitter to Base Breakdown Voltage	$V_{(BR)EBO}$	$I_E = 10\mu\text{A}, I_C = 0$	6	-	-	V

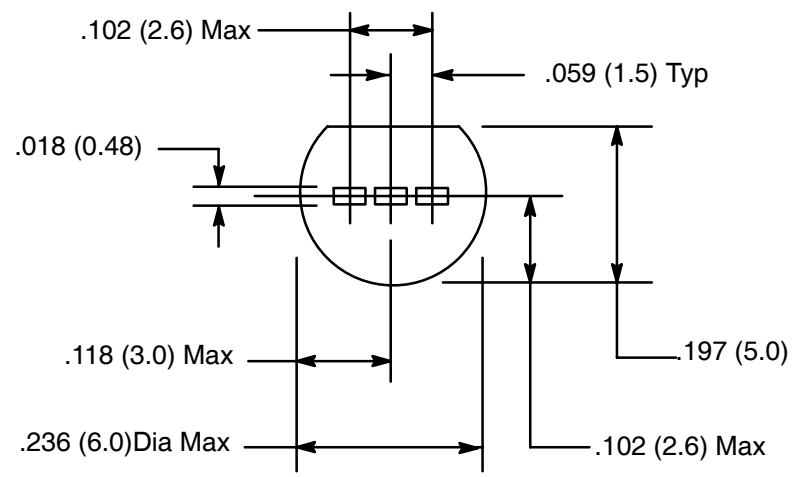
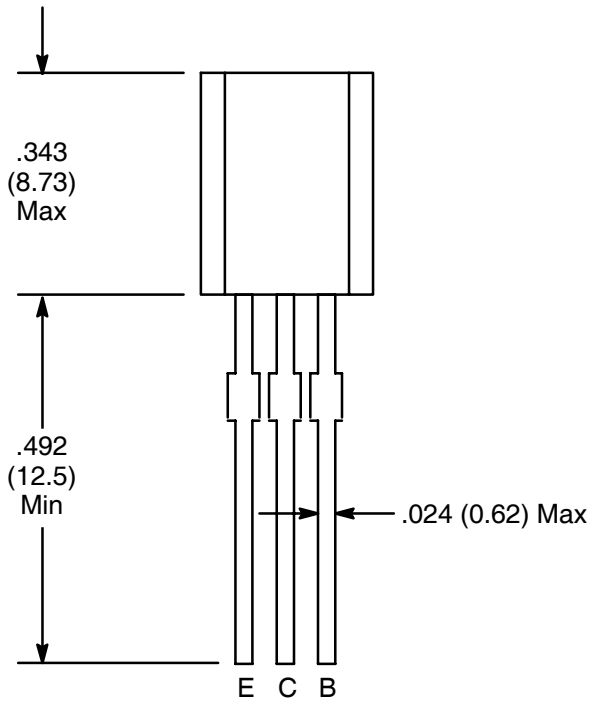

## X-ON Electronics

Largest Supplier of Electrical and Electronic Components

*Click to view similar products for [Bipolar Transistors - BJT category](#):*

*Click to view products by [NTE manufacturer](#):*

Other Similar products are found below :

[619691C](#) [MCH4017-TL-H](#) [MJ15024/WS](#) [MJ15025/WS](#) [BC546/116](#) [BC556/FSC](#) [BC557/116](#) [BSW67A](#) [HN7G01FU-A\(T5L,F,T](#)  
[NJVMJD148T4G](#) [NSVMMBT6520LT1G](#) [NTE187A](#) [NTE195A](#) [NTE2302](#) [NTE2330](#) [NTE2353](#) [NTE316](#) [IMX9T110](#) [NTE63](#) [NTE65](#)  
[C4460](#) [SBC846BLT3G](#) [2SA1419T-TD-H](#) [2SA1721-O\(TE85L,F\)](#) [2SA1727TLP](#) [2SA2126-E](#) [2SB1202T-TL-E](#) [2SB1204S-TL-E](#) [2SC5488A-](#)  
[TL-H](#) [2SD2150T100R](#) [SP000011176](#) [FMC5AT148](#) [2N2369ADCSM](#) [2SB1202S-TL-E](#) [2SC2412KT146S](#) [2SC4618TLN](#) [2SC5490A-TL-H](#)  
[2SD1816S-TL-E](#) [2SD1816T-TL-E](#) [CMXT2207 TR](#) [CPH6501-TL-E](#) [MCH4021-TL-E](#) [BC557B](#) [TTC012\(Q\)](#) [BULD128DT4](#) [JANTX2N3810](#)  
[Jantx2N5416](#) [US6T6TR](#) [KSF350](#) [068071B](#)