



ELECTRONICS, INC.
 44 FARRAND STREET
 BLOOMFIELD, NJ 07003
 (973) 748-5089

NTE289 (NPN) & NTE290 (PNP) Silicon Complementary Transistors Audio Power Amplifier, Switch

Applications:

- 1W Audio Power Amplifier Applications
- Switching Applications

Absolute Maximum Ratings: ($T_A = +25^\circ\text{C}$ unless otherwise specified)

Collector–Base Voltage, V_{CBO}	35V
Collector–Emitter Voltage, V_{CEO}	30V
Emitter–Base Voltage, V_{EBO}	5V
Collector Current, I_C	800mA
Emitter Current, I_E	800mA
Collector Power Dissipation, P_C	600mW
Operating Junction Temperature, T_J	+150°C
Storage Temperature Range, T_{stg}	–55° to +150°C

Electrical Characteristics: ($T_A = +25^\circ\text{C}$ unless otherwise specified)

Parameter	Symbol	Test Conditions	Min	Typ	Max	Unit
Collector–Emitter Breakdown Voltage	$V_{(BR)CEO}$	$I_C = 10\text{mA}, I_B = 0$	30	–	–	V
Collector Cutoff Current	I_{CBO}	$V_{CB} = 35\text{V}, I_E = 0$	–	–	0.1	μA
Emitter Cutoff Current	I_{EBO}	$V_{EB} = 5\text{V}, I_C = 0$	–	–	0.1	μA
DC Current Gain	$h_{FE(1)}$	$V_{CE} = 2\text{V}, I_C = 50\text{mA}, \text{Note 2}$	120	–	240	
	$h_{FE(2)}$	$V_{CE} = 2\text{V}, I_C = 500\text{mA}, \text{Note 2}$	35	–	–	
Collector–Emitter Saturation Voltage	$V_{CE(sat)}$	$I_C = 500\text{mA}, I_B = 20\text{mA}, \text{Note 2}$	–	–	0.8	V
Base–Emitter Voltage	V_{BE}	$V_{CE} = 2\text{V}, I_C = 500\text{mA}, \text{Note 2}$	–	–	1.1	V
Current–Gain Bandwidth Product	f_T	$V_{CE} = 10\text{V}, I_C = 10\text{mA}$	–	140	–	MHz
Output Capacitance	C_{ob}	$V_{CB} = 10\text{V}, I_E = 0, f = 1\text{MHz}$	–	22	30	pF
Switching Time		$V_{CC} = 10\text{V}, V_{BB} = 3\text{V}, \text{Duty Cycle} \leq 2\%$				
Turn–On	t_{on}		–	50	–	ns
Storage	t_{stg}		–	400	–	ns
Fall	t_f	–	40	–	ns	

Note 1. NTE289MP is a matched pair of NTE289 with their DC Current Gain (h_{FE}) matched to within 10% of each other.

Note 2. Pulse Test: Pulse Width $\leq 300\mu\text{s}$, Duty Cycle $\leq 2\%$.

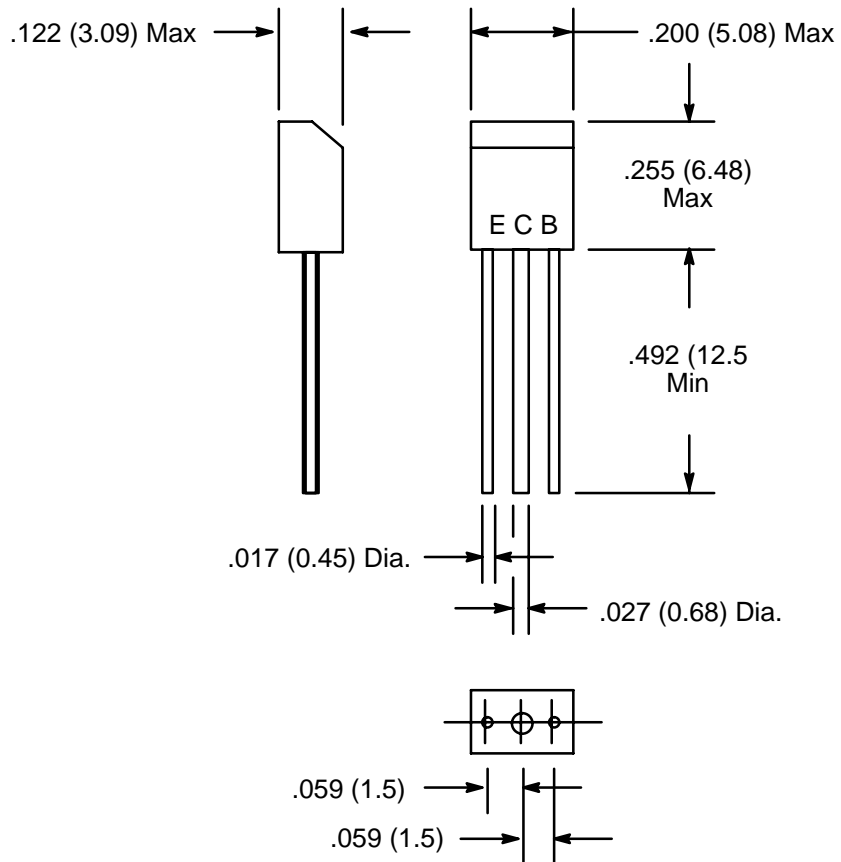
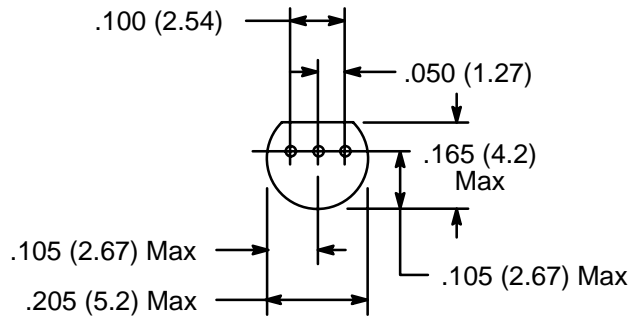
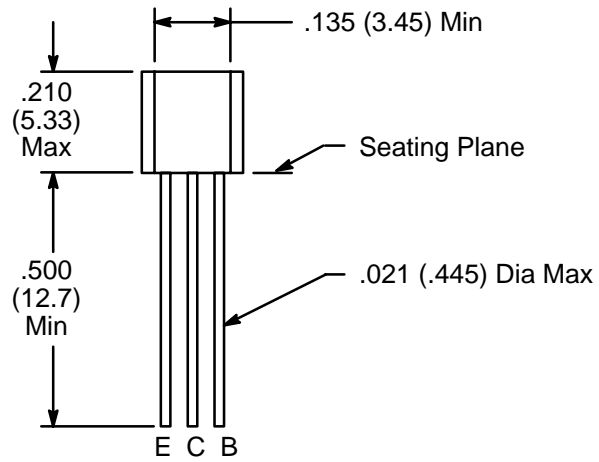

X-ON Electronics

Largest Supplier of Electrical and Electronic Components

Click to view similar products for [Bipolar Transistors - BJT category](#):

Click to view products by [NTE manufacturer](#):

Other Similar products are found below :

[619691C](#) [MCH4017-TL-H](#) [MJ15024/WS](#) [MJ15025/WS](#) [BC546/116](#) [BC556/FSC](#) [BC557/116](#) [BSW67A](#) [HN7G01FU-A\(T5L,F,T](#)
[NJVMJD148T4G](#) [NSVMMBT6520LT1G](#) [NTE187A](#) [NTE195A](#) [NTE2302](#) [NTE2330](#) [NTE2353](#) [NTE316](#) [IMX9T110](#) [NTE63](#) [NTE65](#)
[C4460](#) [SBC846BLT3G](#) [2SA1419T-TD-H](#) [2SA1721-O\(TE85L,F\)](#) [2SA1727TLP](#) [2SA2126-E](#) [2SB1202T-TL-E](#) [2SB1204S-TL-E](#) [2SC5488A-](#)
[TL-H](#) [2SD2150T100R](#) [SP000011176](#) [FMC5AT148](#) [2N2369ADCSM](#) [2SB1202S-TL-E](#) [2SC2412KT146S](#) [2SC4618TLN](#) [2SC5490A-TL-H](#)
[2SD1816S-TL-E](#) [2SD1816T-TL-E](#) [CMXT2207 TR](#) [CPH6501-TL-E](#) [MCH4021-TL-E](#) [BC557B](#) [TTC012\(Q\)](#) [BULD128DT4](#) [JANTX2N3810](#)
[Jantx2N5416](#) [US6T6TR](#) [KSF350](#) [068071B](#)