

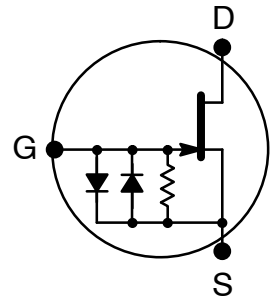

ELECTRONICS, INC.  
 44 FARRAND STREET  
 BLOOMFIELD, NJ 07003  
 (973) 748-5089  
<http://www.nteinc.com>

**NTE2917**  
**MOSFET**  
**Silicon N-Channel JFET Transistor**  
**w/Internal Diode for ECM Impedance**  
**Converter Applications**  
**TO92S Type Package**



**Features:**

- Compact Package
- High Forward Transfer Admittance
- Low Capacitance
- Includes Diode and High Resistance at G – S

**Absolute Maximum Ratings:**

Drain-to-Source Voltage ( $V_{GS} = -1.0V$ ), $V_{DSX}$ .....	20V
Gate-to-Drain Voltage, $V_{GDO}$ .....	-20V
Drain Current, $I_D$ .....	10mA
Gate Current, $I_G$ .....	10mA
Total Power Dissipation, $P_T$ .....	100mW
Operating Junction Temperature, $T_J$ .....	+125°C
Storage Temperature Range, $T_{stg}$ .....	-55° to +125°C

**Electrical Characteristics:** ( $T_A = +25^\circ C$  unless otherwise specified)

Parameter	Symbol	Test Conditions	Min	Typ	Max	Unit
Zero Gate Voltage Drain Cutoff Current	$I_{DSS}$	$V_{DS} = 5V, V_{GS} = 0V$	60	-	500	$\mu A$
Gate Cutoff Voltage	$V_{GS(off)}$	$V_{GS} = 5V, I_D = 1.0\mu A$	-	-	-1.0	V
Forward Transfer Admittance	$ y_{fs} $	$V_{DS} = 5V, I_D = 30\mu A, f = 1kHz$	150	-	-	$\mu s$
		$V_{DS} = 5V, V_{GS} = 0V, f = 1kHz$	150	1200	-	$\mu s$
Input Capacitance	$C_{iss}$	$V_{GS} = 0V, V_{DS} = 5V, f = 1MHz$	-	4.5	6.0	pF
Output Capacitance	$C_{oss}$		-	1.5	3.0	pF
Reverse Transfer Capacitance	$C_{rss}$		-	1.2	3.0	pF
Noise Voltage	NV		-	1.0	3.0	$\mu V$

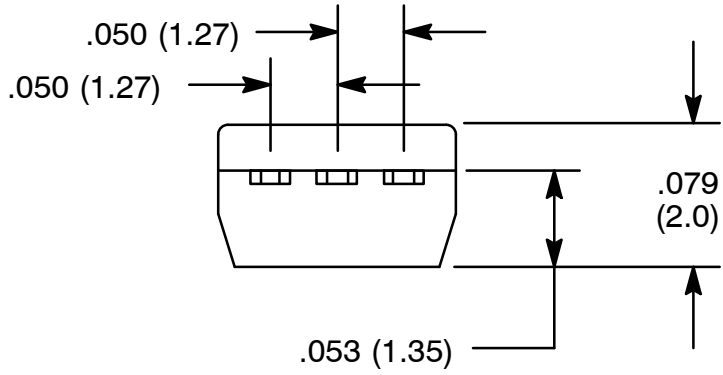
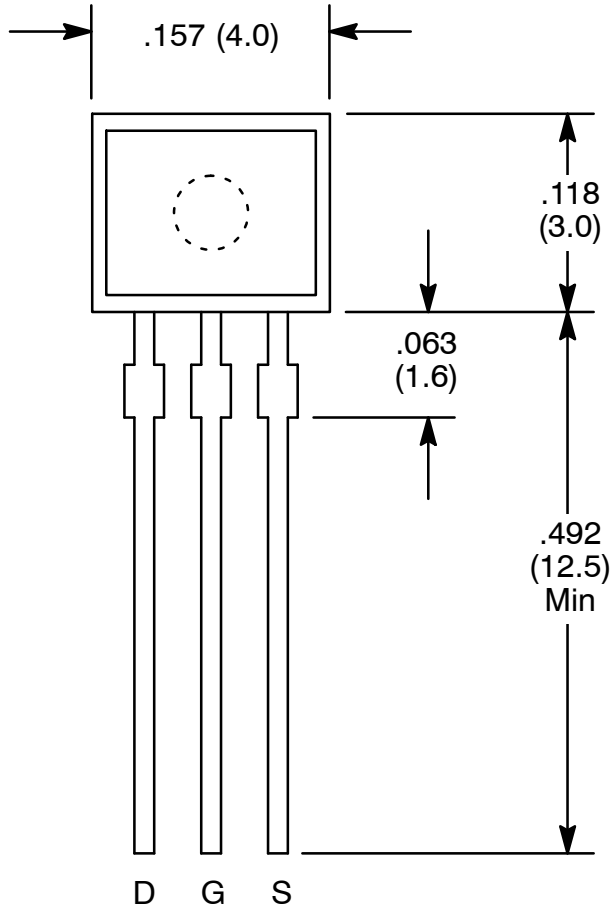

## X-ON Electronics

Largest Supplier of Electrical and Electronic Components

*Click to view similar products for [MOSFET](#) category:*

*Click to view products by [NTE](#) manufacturer:*

Other Similar products are found below :

[614233C](#) [648584F](#) [MCH3443-TL-E](#) [MCH6422-TL-E](#) [FDPF9N50NZ](#) [FW216A-TL-2W](#) [FW231A-TL-E](#) [APT5010JVR](#) [NTNS3A92PZT5G](#)  
[IRF100S201](#) [JANTX2N5237](#) [2SK2464-TL-E](#) [2SK3818-DL-E](#) [FCA20N60\\_F109](#) [FDZ595PZ](#) [STD6600NT4G](#) [FSS804-TL-E](#) [2SJ277-DL-E](#)  
[2SK1691-DL-E](#) [2SK2545\(Q,T\)](#) [405094E](#) [423220D](#) [MCH6646-TL-E](#) [TPCC8103,L1Q\(CM](#) [367-8430-0972-503](#) [VN1206L](#) [424134F](#)  
[026935X](#) [051075F](#) [SBVS138LT1G](#) [614234A](#) [715780A](#) [NTNS3166NZT5G](#) [751625C](#) [873612G](#) [IRF7380TRHR](#) [IPS70R2K0CEAKMA1](#)  
[RJK60S3DPP-E0#T2](#) [RJK60S5DPK-M0#T0](#) [APT5010JVFR](#) [APT12031JFLL](#) [APT12040JVR](#) [DMN3404LQ-7](#) [NTE6400](#) [JANTX2N6796U](#)  
[JANTX2N6784U](#) [JANTXV2N5416U4](#) [SQM110N05-06L-GE3](#) [SIHF35N60E-GE3](#) [2SK2614\(TE16L1,Q\)](#)