



**ELECTRONICS, INC.**  
 44 FARRAND STREET  
 BLOOMFIELD, NJ 07003  
 (973) 748-5089

## NTE315 Silicon NPN Transistor, Medium Power Amp

**Features:**

- AF – HF Medium Power Amplifier

**Absolute Maximum Ratings:** ( $T_A = +25^\circ\text{C}$  unless otherwise specified)

Collector-to-Base Voltage, $V_{CBO}$ .....	100V
Collector-to-Emitter Voltage, $V_{CEO}$ .....	50V
Emitter-to-Base Voltage, $V_{EBO}$ .....	6V
Collector Current, $I_C$ .....	1A
Base Current, $I_B$ .....	0.5A
Collector Power Dissipation, $P_C$ .....	750mW
Junction Temperature, $T_J$ .....	+120°C
Storage Temperature Range, $T_{stg}$ .....	-50° to +150°C
Thermal Resistance, Junction-to-Ambient, $R_{thJA}$ .....	126°C/W

**Electrical Characteristics:** ( $T_A = +25^\circ\text{C}$  unless otherwise specified)

Parameter	Symbol	Test Conditions	Min	Typ	Max	Unit
Collector Cutoff Current	$I_{CBO}$	$V_{CB} = 25V, I_E = 0$	–	–	0.2	$\mu\text{A}$
Emitter Cutoff Current	$I_{EBO}$	$V_{EB} = 6V, I_C = 0$	–	–	0.2	$\mu\text{A}$
Base to Emitter Voltage	$V_{BE}$	$V_{CE} = 6V, I_C = 5\text{mA}$	–	–	0.7	V
Collector-Emitter Sustaining Voltage	$V_{CEO(sus)}$	$I_C = 2\text{mA}$	50	–	–	V
Collector-Emitter Saturation Voltage	$V_{CE(sat)}$	$I_C = 1A, I_B = 50\text{mA}$	–	–	0.3	V
Base-Emitter Saturation Voltage	$V_{BE(sat)}$	$I_C = 1A, I_B = 50\text{mA}$	–	–	1.0	V
DC Current Gain	$h_{FE1}$	$V_{CE} = 2V, I_C = 100\text{mA}$	199	–	649	
	$h_{FE2}$	$V_{CE} = 1V, I_C = 1A$	70	–	–	
Small Signal Current Gain	$ h_{fe} $	$V_{CB} = 2V, I_E = -10\text{mA},$ $f = 10\text{MHz}$	–	18	–	dB
Collector Output Capacitance	$C_C$	$V_{CB} = 10V, I_E = 0, f = 1\text{MHz}$	–	16	40	pf

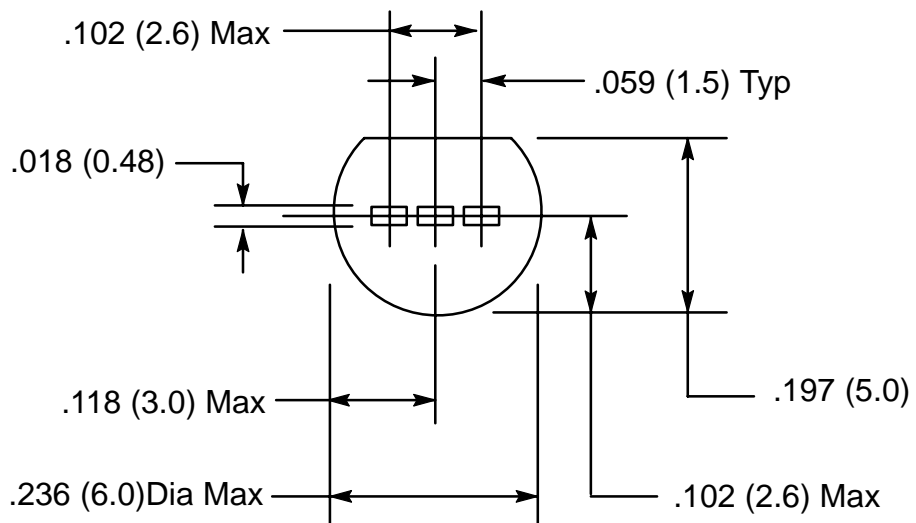
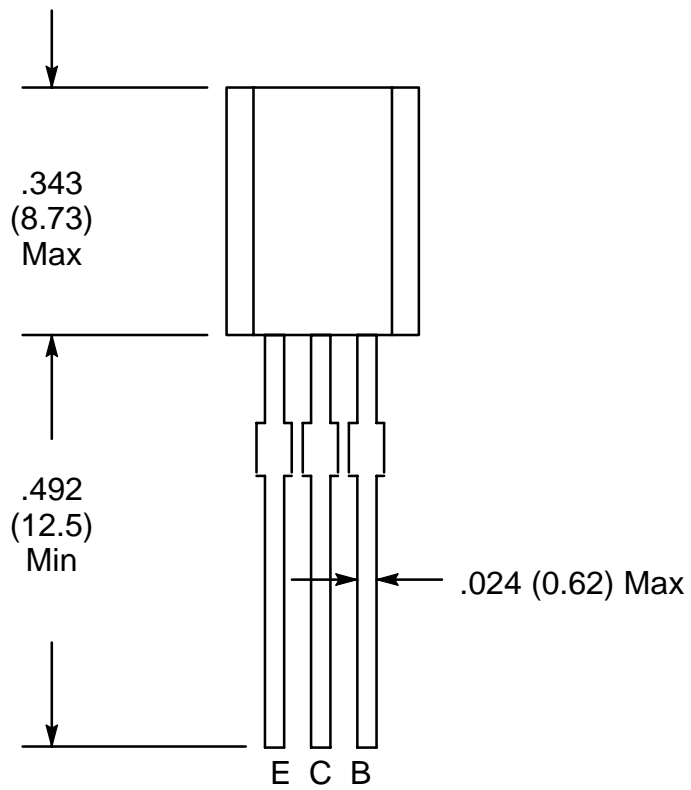

## X-ON Electronics

Largest Supplier of Electrical and Electronic Components

*Click to view similar products for [Bipolar Transistors - BJT category](#):*

*Click to view products by [NTE manufacturer](#):*

Other Similar products are found below :

[619691C](#) [MCH4017-TL-H](#) [MJ15024/WS](#) [MJ15025/WS](#) [BC546/116](#) [BC556/FSC](#) [BC557/116](#) [BSW67A](#) [HN7G01FU-A\(T5L,F,T](#)  
[NJVMJD148T4G](#) [NSVMMBT6520LT1G](#) [NTE187A](#) [NTE195A](#) [NTE2302](#) [NTE2330](#) [NTE2353](#) [NTE316](#) [IMX9T110](#) [NTE63](#) [NTE65](#)  
[C4460](#) [SBC846BLT3G](#) [2SA1419T-TD-H](#) [2SA1721-O\(TE85L,F\)](#) [2SA1727TLP](#) [2SA2126-E](#) [2SB1202T-TL-E](#) [2SB1204S-TL-E](#) [2SC5488A-](#)  
[TL-H](#) [2SD2150T100R](#) [SP000011176](#) [FMC5AT148](#) [2N2369ADCSM](#) [2SB1202S-TL-E](#) [2SC2412KT146S](#) [2SC4618TLN](#) [2SC5490A-TL-H](#)  
[2SD1816S-TL-E](#) [2SD1816T-TL-E](#) [CMXT2207 TR](#) [CPH6501-TL-E](#) [MCH4021-TL-E](#) [BC557B](#) [TTC012\(Q\)](#) [BULD128DT4](#) [JANTX2N3810](#)  
[Jantx2N5416](#) [US6T6TR](#) [KSF350](#) [068071B](#)