



ELECTRONICS, INC.  
 44 FARRAND STREET  
 BLOOMFIELD, NJ 07003  
 (973) 748-5089  
<http://www.nteinc.com>

## NTE452

### Silicon N-Channel JFET Transistor VHF Amplifier, Mixer TO72 Type Package

**Description:**

The NTE452 is a silicon, N-channel junction field effect transistor (JFET) in a TO72 type package designed to be used in the depletion mode in VHF/UHF amplifiers.

**Absolute Maximum Ratings:**

Drain-Source Voltage, $V_{DS}$ .....	30V
Drain-Gate Voltage, $V_{DG}$ .....	35V
Gate-Source Voltage, $V_{GS}$ .....	30V
Gate Current, $I_G$ .....	10mA
Total Device Dissipation ( $T_A = +25^\circ\text{C}$ ), $P_D$ .....	300mW
Derate Above $25^\circ\text{C}$ .....	1.71mW/ $^\circ\text{C}$
Operating Junction Temperature Range, $T_J$ .....	$-65^\circ$ to $+175^\circ\text{C}$
Storage Temperature Range, $T_{stg}$ .....	$-65^\circ$ to $+175^\circ\text{C}$

**Electrical Characteristics:** ( $T_A = +25^\circ\text{C}$  unless otherwise specified)

Parameter	Symbol	Test Conditions	Min	Typ	Max	Unit
<b>OFF Characteristics</b>						
Gate-Source Breakdown Voltage	$V_{(BR)GSS}$	$I_G = 1^\circ\text{s}, V_{DS} = 0$	30	-	-	V
Gate Reverse Current	$I_{GSS}$	$V_{GS} = 20\text{V}, V_{DS} = 0$	-	-	100	pA
		$V_{GS} = 20\text{V}, V_{DS} = 0, T_A = +150^\circ\text{C}$	-	-	200	pA
Gate-Source Cutoff Voltage	$V_{GS(off)}$	$I_D = 1\text{nA}, V_{DS} = 15\text{V}$	-	-	6	V
Gate-Source Voltage	$V_{GS}$	$I_D = 0.5\text{mA}, V_{DS} = 15\text{V}$	1.0	-	5.5	V
Gate-Source Forward Voltage	$V_{GS(f)}$	$I_G = 1\text{mA}, V_{DS} = 0$	-	-	1.0	V
<b>ON Characteristics (Note 1)</b>						
Zero-Gate Voltage Drain Current	$I_{DSS}$	$V_{DS} = 15\text{V}, V_{GS} = 0$	5	-	15	mA
<b>Small-Signal Characteristics</b>						
Forward Transfer Admittance	$ Y_{fs} $	$V_{DS} = 15\text{V}, V_{GS} = 0, f = 1\text{kHz}, \text{Note 1}$	4500	-	7500	$^\circ\text{mhos}$
Real Part of Forward Transfer Admittance	$Y_{fs(real)}$	$V_{DS} = 15\text{V}, V_{GS} = 0, f = 400\text{MHz}$	4000	-	-	$^\circ\text{mhos}$

Note 1. Pulse Test: Pulse Width  $\leq 300^\circ\text{s}$ , Duty Cycle  $\leq 1\%$ .

**Electrical Characteristics (Cont'd):** ( $T_A = +25^\circ\text{C}$  unless otherwise specified)

Parameter	Symbol	Test Conditions	Min	Typ	Max	Unit
<b>Small-Signal Characteristics (Cont'd)</b>						
Real Part of Input Admittance	$Y_{is(\text{real})}$	$V_{DS} = 15\text{V}, V_{GS} = 0, f = 100\text{MHz}$	-	-	100	$^\circ\text{mhos}$
		$V_{DS} = 15\text{V}, V_{GS} = 0, f = 400\text{MHz}$	-	-	1000	$^\circ\text{mhos}$
Output Admittance	$ Y_{os} $	$V_{DS} = 15\text{V}, V_{GS} = 0, f = 1\text{kHz}$	-	-	50	$^\circ\text{mhos}$
Real Part of Output Admittance	$Y_{os(\text{real})}$	$V_{DS} = 15\text{V}, V_{GS} = 0, f = 100\text{MHz}$	-	-	75	$^\circ\text{mhos}$
		$V_{DS} = 15\text{V}, V_{GS} = 0, f = 400\text{MHz}$	-	-	100	$^\circ\text{mhos}$
Imaginary Part of Input Admittance	$Y_{is(\text{imag})}$	$V_{DS} = 15\text{V}, V_{GS} = 0, f = 100\text{MHz}$	-	-	2500	$^\circ\text{mhos}$
		$V_{DS} = 15\text{V}, V_{GS} = 0, f = 400\text{MHz}$	-	-	10k	$^\circ\text{mhos}$
Imaginary Part of Output Admittance	$Y_{os(\text{imag})}$	$V_{DS} = 15\text{V}, V_{GS} = 0, f = 100\text{MHz}$	-	-	1000	$^\circ\text{mhos}$
		$V_{DS} = 15\text{V}, V_{GS} = 0, f = 400\text{MHz}$	-	-	4000	$^\circ\text{mhos}$
Input Capacitance	$C_{iss}$	$V_{DS} = 15\text{V}, V_{GS} = 0, f = 1\text{MHz}$	-	-	4.0	pF
Reverse Transfer Capacitance	$C_{rss}$	$V_{DS} = 15\text{V}, V_{GS} = 0, f = 1\text{MHz}$	-	-	0.8	pF
Common-Source Output Capacitance	$C_{oss}$	$V_{DS} = 15\text{V}, V_{GS} = 0, f = 1\text{MHz}$	-	-	2.0	pF
<b>Functional Characteristics</b>						
Noise Figure	NF	$V_{DS} = 15\text{V}, I_D = 5\text{mA}, R_g \leq 1000\Omega, f = 100\text{MHz}$	-	-	2.0	dB
		$V_{DS} = 15\text{V}, I_D = 5\text{mA}, R_g \leq 1000\Omega, f = 400\text{MHz}$	-	-	4.0	dB
Small-Signal Power Gain Common-Source	$G_{ps}$	$V_{DS} = 15\text{V}, I_D = 5\text{mA}, f = 100\text{MHz}$	18	-	-	dB
		$V_{DS} = 15\text{V}, I_D = 5\text{mA}, f = 400\text{MHz}$	10	-	-	dB

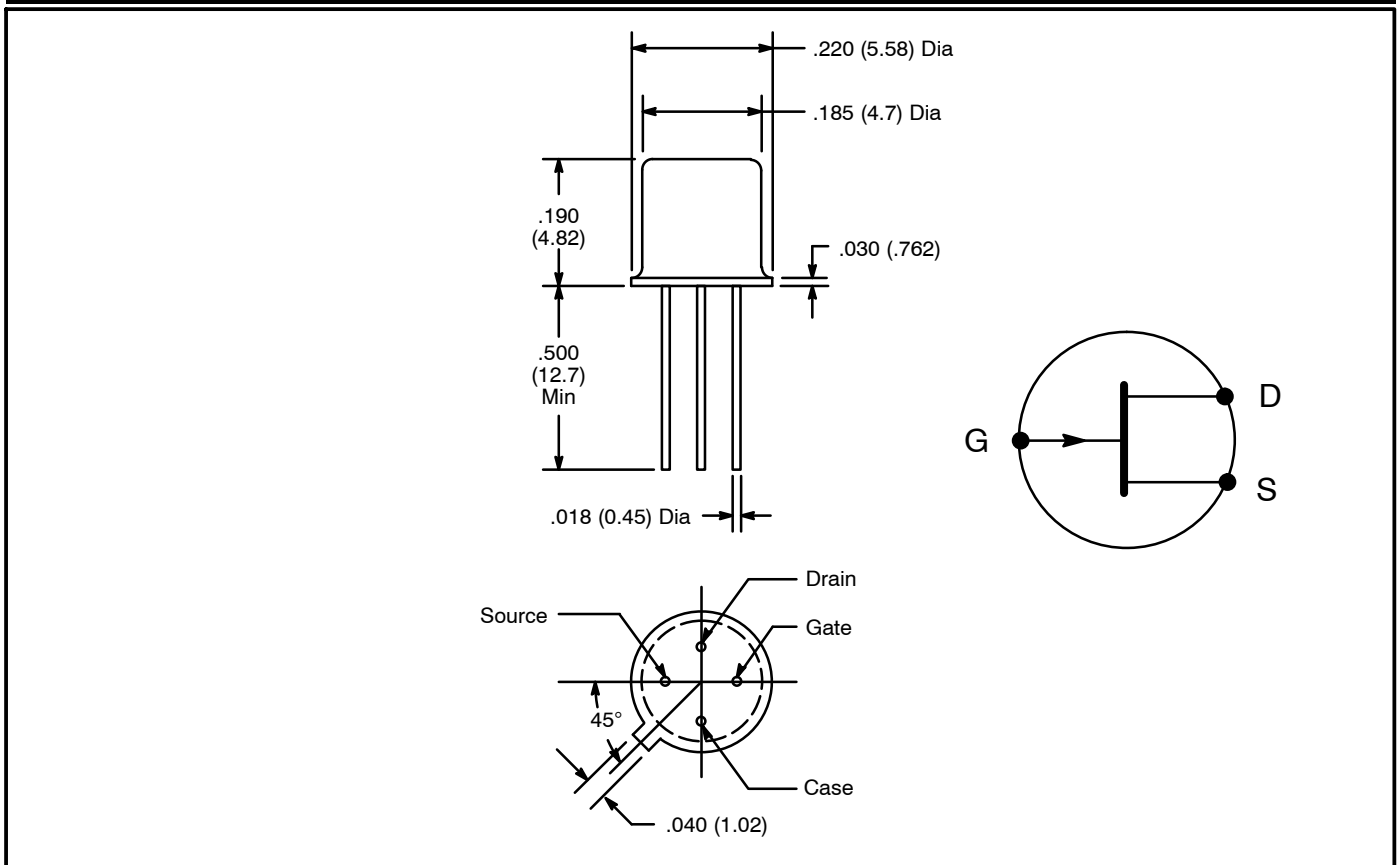

## X-ON Electronics

Largest Supplier of Electrical and Electronic Components

*Click to view similar products for [MOSFET](#) category:*

*Click to view products by [NTE](#) manufacturer:*

Other Similar products are found below :

[614233C](#) [648584F](#) [MCH3443-TL-E](#) [MCH6422-TL-E](#) [FDPF9N50NZ](#) [FW216A-TL-2W](#) [FW231A-TL-E](#) [APT5010JVR](#) [NTNS3A92PZT5G](#)  
[IRF100S201](#) [JANTX2N5237](#) [2SK2464-TL-E](#) [2SK3818-DL-E](#) [FCA20N60\\_F109](#) [FDZ595PZ](#) [STD6600NT4G](#) [FSS804-TL-E](#) [2SJ277-DL-E](#)  
[2SK1691-DL-E](#) [2SK2545\(Q,T\)](#) [405094E](#) [423220D](#) [MCH6646-TL-E](#) [TPCC8103,L1Q\(CM](#) [367-8430-0972-503](#) [VN1206L](#) [424134F](#)  
[026935X](#) [051075F](#) [SBVS138LT1G](#) [614234A](#) [715780A](#) [NTNS3166NZT5G](#) [751625C](#) [873612G](#) [IRF7380TRHR](#) [IPS70R2K0CEAKMA1](#)  
[RJK60S3DPP-E0#T2](#) [RJK60S5DPK-M0#T0](#) [APT5010JVFR](#) [APT12031JFLL](#) [APT12040JVR](#) [DMN3404LQ-7](#) [NTE6400](#) [JANTX2N6796U](#)  
[JANTX2N6784U](#) [JANTXV2N5416U4](#) [SQM110N05-06L-GE3](#) [SIHF35N60E-GE3](#) [2SK2614\(TE16L1,Q\)](#)