



ELECTRONICS, INC.
 44 FARRAND STREET
 BLOOMFIELD, NJ 07003
 (973) 748-5089
<http://www.nteinc.com>

NTE456 N-Channel Silicon JFET General Purpose Amp, Switch TO72 Type Package

Description:

The NTE456 is an N-Channel junction silicon field-effect transistor in a TO72 type package designed for general purpose amplifier and switching applications.

Absolute Maximum Ratings:

Drain-Source Voltage, V_{DS}	30V
Drain-Gate Voltage, V_{DG}	30V
Gate-Source Voltage, V_{GS}	-30V
Drain Current, I_D	15mA
Total Device Dissipation ($T_A = +25^\circ\text{C}$), P_D	300mW
Derate Above 25°C	2mW/ $^\circ\text{C}$
Operating Junction Temperature, T_J	+150 $^\circ\text{C}$
Storage Temperature Range, T_{stg}	-65 $^\circ\text{C}$ to +200 $^\circ\text{C}$

Electrical Characteristics: ($T_A = +25^\circ\text{C}$ unless otherwise specified)

Parameter	Symbol	Test Conditions	Min	Typ	Max	Unit
OFF Characteristics						
Gate-Source Breakdown Voltage	$V_{(BR)GSS}$	$V_{DS} = 0, I_G = -10 \text{ A}$	-30	-	-	V
Gate Reverse Current	I_{GSS}	$V_{GS} = -15\text{V}, V_{DS} = 0$	-	-	-0.1	nA
		$V_{GS} = -15\text{V}, V_{DS} = 0, T_A = +150^\circ\text{C}$	-	-	-100	nA
Gate-Source Cutoff Voltage	$V_{GS(off)}$	$V_{DS} = 15\text{V}, I_D = 0.1\text{nA}$	-	-	-6	V
Gate-Source Voltage	V_{GS}	$V_{DS} = 15\text{V}, I_D = 200 \text{ A}$	-1.0	-	-5.0	V
ON Characteristics						
Zero-Gate-Voltage Drain Current	I_{DSS}	$V_{DS} = 15\text{V}, V_{GS} = 0$	2.0	-	6.0	mA
Static Drain-Source On Resistance	$r_{DS(on)}$	$V_{DS} = 0, V_{GS} = 0$	-	400	-	$^\circ$

Electrical Characteristics (Cont'd): ($T_A = +25^\circ\text{C}$ unless otherwise specified)

Parameter	Symbol	Test Conditions	Min	Typ	Max	Unit
Small-Signal Characteristics						
Forward Transfer Admittance Common Source	$ y_{fs} $	$V_{DS} = 15\text{V}, V_{GS} = 0, f = 1\text{kHz}$, Note 1	2000	-	5000	mhos
Output Admittance Common Source	$ y_{os} $	$V_{DS} = 15\text{V}, V_{GS} = 0, f = 1\text{kHz}$	-	-	20	mhos
Input Capacitance	C_{iss}	$V_{DS} = 15\text{V}, V_{GS} = 0, f = 1\text{kHz}$	-	4.5	6.0	pF
Reverse Transfer Capacitance	C_{rss}	$V_{DS} = 15\text{V}, V_{GS} = 0, f = 1\text{kHz}$	-	1.2	2.0	pF
Common-Source Output Capacitance	C_{osp}	$V_{DS} = 15\text{V}, V_{GS} = 0, f = 30\text{MHz}$	-	1.5	-	pF
Functional Characteristics						
Noise Figure	NF	$V_{DS} = 15\text{V}, V_{GS} = 0, R_S = 1\text{M}^\circ, f = 100\text{Hz}$	-	-	2.5	dB

Note 1. Pulse test: Pulse Width = 630ms, Duty Cycle = 10%.

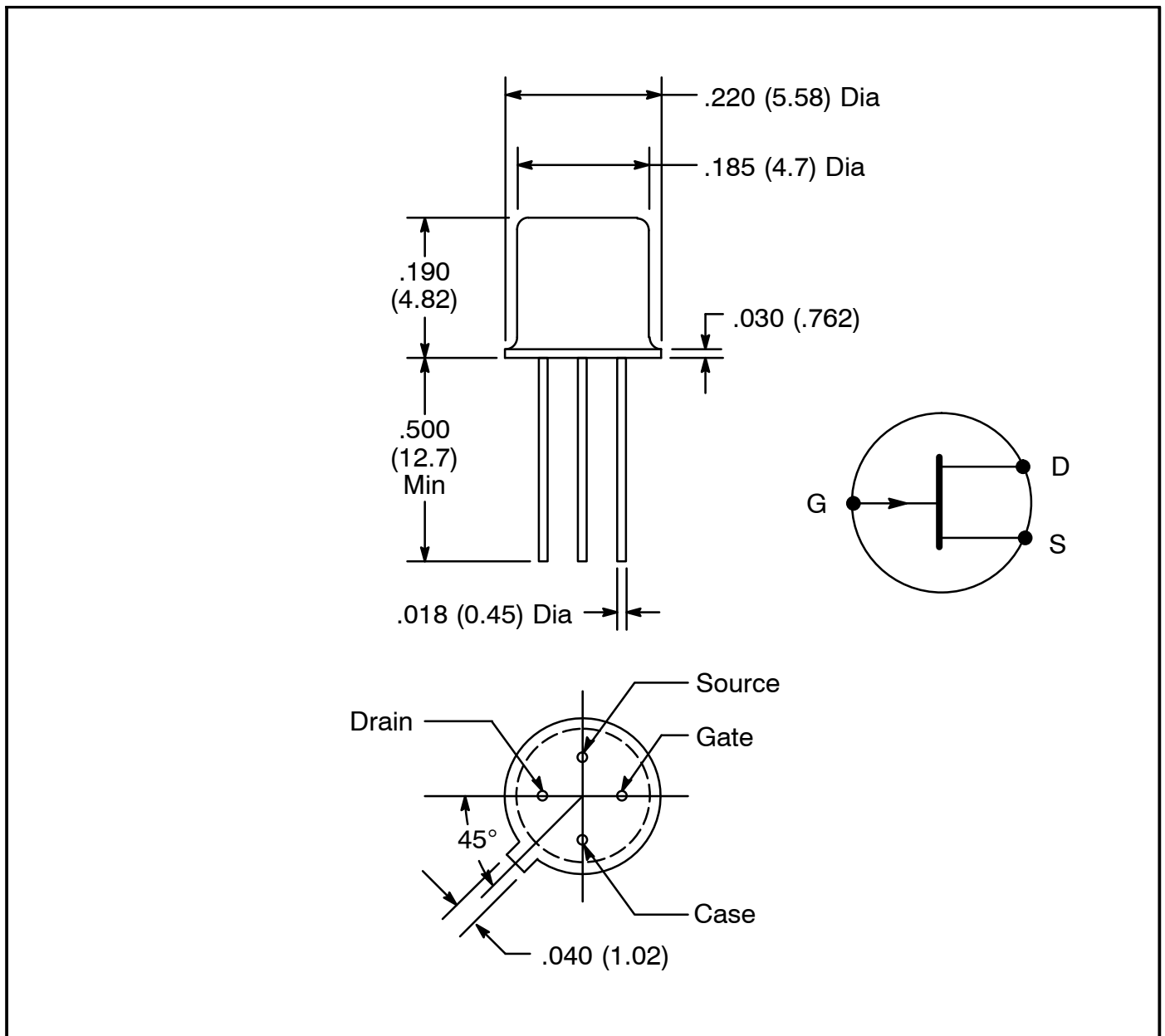

X-ON Electronics

Largest Supplier of Electrical and Electronic Components

Click to view similar products for [MOSFET](#) category:

Click to view products by [NTE](#) manufacturer:

Other Similar products are found below :

[614233C](#) [648584F](#) [MCH3443-TL-E](#) [MCH6422-TL-E](#) [FDPF9N50NZ](#) [FW216A-TL-2W](#) [FW231A-TL-E](#) [APT5010JVR](#) [NTNS3A92PZT5G](#)
[IRF100S201](#) [JANTX2N5237](#) [2SK2464-TL-E](#) [2SK3818-DL-E](#) [FCA20N60_F109](#) [FDZ595PZ](#) [STD6600NT4G](#) [FSS804-TL-E](#) [2SJ277-DL-E](#)
[2SK1691-DL-E](#) [2SK2545\(Q,T\)](#) [405094E](#) [423220D](#) [MCH6646-TL-E](#) [TPCC8103,L1Q\(CM](#) [367-8430-0972-503](#) [VN1206L](#) [424134F](#)
[026935X](#) [051075F](#) [SBVS138LT1G](#) [614234A](#) [715780A](#) [NTNS3166NZT5G](#) [751625C](#) [873612G](#) [IRF7380TRHR](#) [IPS70R2K0CEAKMA1](#)
[RJK60S3DPP-E0#T2](#) [RJK60S5DPK-M0#T0](#) [APT5010JVFR](#) [APT12031JFLL](#) [APT12040JVR](#) [DMN3404LQ-7](#) [NTE6400](#) [JANTX2N6796U](#)
[JANTX2N6784U](#) [JANTXV2N5416U4](#) [SQM110N05-06L-GE3](#) [SIHF35N60E-GE3](#) [2SK2614\(TE16L1,Q\)](#)