

Technical data sheet

Flat cable threaded connection, metric thread M20,
stone grey
Item no. 2013002



Flat-cable entry, choke-nipple design with metric connecting thread to IEC 432, protection rating IP 31, with pre-mounted support sealing ring 107/F.



PE Polyethylene

Master data

Item no.	2013002
Type	106 FL M20 8 19
Description 1	Flat cable threaded connection
Dimension	M20
Colour	Stone grey
RAL number	7030
Material	Polyethylene
Material symbol	PE
Smallest sales unit (VG)	50,00 Piece
Weight	0,91 kg/100 pc.

Technical data sheet

Flat cable threaded connection, metric thread M20,
stone grey
Item no. 2013002



Technical data

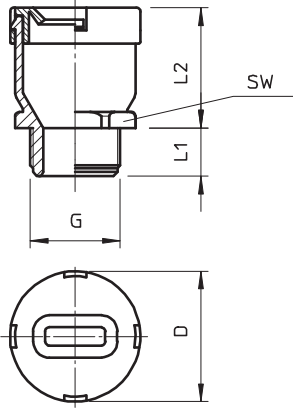

Flat cable/width	17,00 - 19,00 mm
Dimension D	32,50 mm
Dimension G	M20 mm
Dimension L	42,00 mm
Dimension L1	12,00 mm
Dimension L2	30,00 mm
WAF	27,00 mm
Version	Straight
Type of seal	Sealing ring
Bend protection	<input type="checkbox"/>
explosion-proof	<input type="checkbox"/>
Flat cable/thickness	6,00 - 8,00 mm
Flat cable threaded connection	<input checked="" type="checkbox"/>
For Ex zone	Without
Thread	M20
Thread type	Metric
Fibre-glass reinforced	<input type="checkbox"/>
Multiple sealing insert	<input type="checkbox"/>
With locknut	<input type="checkbox"/>
Impact-resistant	<input type="checkbox"/>
Protection rating	IP31
Strain relief option	<input type="checkbox"/>

X-ON Electronics

Largest Supplier of Electrical and Electronic Components

Click to view similar products for [Cable Glands, Strain Reliefs & Cord Grips](#) category:

Click to view products by [OBO BETTERMANN](#) manufacturer:

Other Similar products are found below :

[1300980012](#) [DBZM-6828](#) [1498](#) [15190-103 R2](#) [1.587.3400.71](#) [300623](#) [07402002](#) [CD21NS-01](#) [VC-M-KV-PG16 1X3/1X8](#) [35935](#) [35882](#)
[M4340GAE](#) [4597](#) [NG-9516 Gasket](#) [52006157](#) [52006176](#) [BM4963L](#) [53629556](#) [53629570](#) [53629675](#) [52025230](#) [52024853](#) [52103160](#)
[52115810](#) [53017640](#) [53019051](#) [53019071](#) [53112270](#) [53112330](#) [53112840](#) [53112879](#) [53112929](#) [53111470](#) [53015270](#) [53015090](#) [53018090](#)
[PG-29](#) [36681](#) [36550](#) [36310](#) [35880](#) [1300990004](#) [Z5.507.2321.0](#) [CGB295-SG](#) [5320816](#) [1.089.1399.19](#) [1.089.2106.19](#) [1.089.2905.19](#)
[1.089.3699.19](#) [1.089.4801.19](#)