

# Delta robot 3 axes + 1 rot

## The fastest picking system integrated in the Sysmac Platform

- Robot control integrated in the NJ robotics controller
- Control of up to 8 robots by one controller
- Degrees of freedom: 3 + 1 (rotational axis optional)
- Up to 200 cycle per minute
- Models from 500 to 1,600 mm working range
- Payload range: 1 to 8 kg
- Different types of Delta robot arms
- IP class range: IP65, IP67, IP69K
- Anti-collision detection option



## System configuration

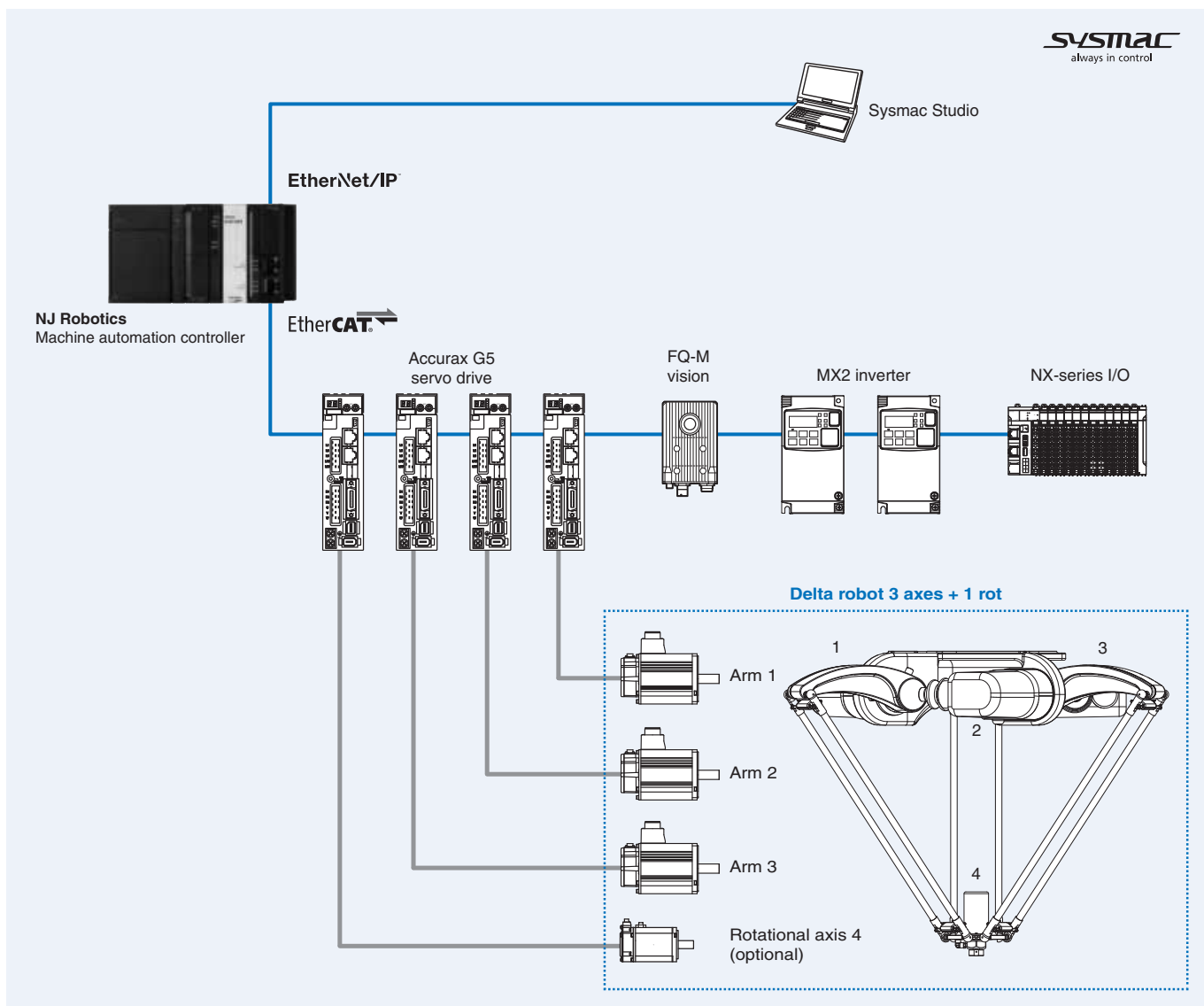

Note: Servo motors included in the Delta robot.

## Specifications

### Delta robot 3 axes + 1 rot series

#### IP69K protection class models

Model		CR_UGD4_XL_HD□		CR_UGD4_HD□		CR_UGD4_XS_HD□		
		With rotational axis	Without rotational axis	With rotational axis	Without rotational axis	With rotational axis	Without rotational axis	
Working volume	X, Y axis (stroke)	Ø 1,300 mm		Ø 1,100 mm		Ø 650 mm		
	Z axis (stroke) <sup>1</sup>	250 mm (maximum Ø 1,300 mm) 400 mm (center Ø 870 mm)		250 mm (maximum Ø 1,100 mm) 400 mm (center Ø 670 mm)		200 mm (maximum Ø 650 mm) 270 mm (center Ø 407.5 mm)		
	θ axis (rotation angle)	±180 deg (default setting, it can be changed)	-	±180 deg (default setting, it can be changed)	-	±180 deg (default setting, it can be changed)	-	
Servo motor	Arm 1, 2, 3	Model	R88M-K1K030T-BS2-V2					
		Capacity	1,000 W					
	Rotational axis 4	Model	R88M-K75030T-BS2	-	R88M-K75030T-BS2	-	R88M-K75030T-BS2	-
		Capacity	750 W	-	750 W	-	750 W	-
Repeatability <sup>2</sup>	X, Y, Z axis	±0.2 mm		±0.2 mm		±0.2 mm		
	θ axis	±0.3 deg	-	±0.3 deg	-	±0.3 deg	-	
Maximum payload		2 kg		2 kg		2 kg		
Maximum through-put <sup>3</sup>		120 CPM <sup>4</sup>		150 CPM <sup>4</sup>		170 CPM <sup>4</sup>		
Gear box ratio	X, Y, Z axis	1:31		1:31		1:31		
	θ axis	1:10	-	1:10	-	1:10	-	
θ axis torque limitation		16 Nm		16 Nm		16 Nm		
Travel limit		1. Soft limit, 2. Mechanical stopper (X, Y, Z axis)						
Noise level		< 68 dB (A)						
Ambient temperature		Operating: 5°C to 45°C Storage: -25°C to 60°C						
Relative humidity		Max. 90%						
Protection class		IP69K						
Weight		100 kg						

<sup>1</sup>. For further details please check the dimensional drawing in the next section.

<sup>2</sup>. This is the value at a constant ambient temperature.

<sup>3</sup>. With 0.1 kg payload. When reciprocating 305 mm in horizontal and 25 mm in vertical directions.

<sup>4</sup>. CPM: Cycle per minutes. Check the note 3 for the cycle definition.

#### IP67 protection class models

Model		R6Y3□110□03067NJ5			R6Y3□065□02067NJ5			
		With high inertia rotational axis	With low inertia rotational axis	Without rotational axis	With high inertia rotational axis	With low inertia rotational axis	Without rotational axis	
Working volume	X, Y axis (stroke)	Ø 1,100 mm			Ø 650 mm			
	Z axis (stroke) <sup>1</sup>	300 mm (maximum Ø 1,100 mm) 450 mm (center Ø 580 mm)			150 mm (maximum Ø 650 mm) 250 mm (center Ø 480 mm)			
	θ axis (rotation angle)	±180 deg (default setting, it can be changed)		-	±180 deg (default setting, it can be changed)		-	
Servo motor	Arm 1, 2, 3	Model	R88M-K1K030T-BS2					
		Capacity	1,000 W					
	Rotational axis 4	Model	R88M-K10030T-S2	R88M-K05030T-S2	-	R88M-K10030T-S2	R88M-K05030T-S2	-
		Capacity	100 W	50 W	-	100 W	50 W	-
Repeatability <sup>2</sup>	X, Y, Z axis	±0.2 mm		-	±0.1 mm		-	
	θ axis	±0.1 deg	-	-	±0.1 deg	-	-	
Maximum payload		3 kg			2 kg			
Maximum through-put <sup>3</sup>		150 CPM <sup>4</sup>			200 CPM <sup>4</sup>			
θ axis tolerable moment of inertia <sup>5</sup>		0.035 kgm <sup>2</sup>	0.01 kgm <sup>2</sup>	-	0.035 kgm <sup>2</sup>	0.01 kgm <sup>2</sup>	-	
User tubing (outer diameter)		Ø 6						
Travel limit		1. Soft limit, 2. Mechanical stopper (X, Y, Z axis)						
Noise level		< 73.7 dB (A)			< 64.5 dB (A)			
Ambient temperature		0°C to 45°C						
Relative humidity		Max. 85%						
Protection class		IP67						
Weight		75 kg			32 kg			

<sup>1</sup>. For further details please check the dimensional drawing in the next section.

<sup>2</sup>. This is the value at a constant ambient temperature.

<sup>3</sup>. With 0.1 kg payload. When reciprocating 305 mm in horizontal and 25 mm in vertical directions.

<sup>4</sup>. CPM: Cycle per minutes. Check the note 3 for the cycle definition.

<sup>5</sup>. There are limits to acceleration coefficient settings.

IP65 protection class models

Model		CR_UGD4_XXLH		CR_UGD4_XXL1300H		
		With rotational axis	Without rotational axis	With rotational axis	Without rotational axis	
Working volume	X, Y axis (stroke)	Ø 1,600 mm		Ø 1,300 mm		
	Z axis (stroke) <sup>*1</sup>	350 mm (maximum Ø 1,600 mm) 550 mm (center Ø 814 mm)		300 mm (maximum Ø 1,300 mm) 450 mm (center Ø 780 mm)		
	θ axis (rotation angle)	±180 deg (default setting, it can be changed)	-	±180 deg (default setting, it can be changed)	-	
Servo motor	Arm 1, 2, 3	Model	R88M-K3K030C-BS2			
		Capacity	3,000 W			
	Rotational axis 4	Model	R88M-K1K030C-BS2	-	R88M-K1K030C-BS2	-
		Capacity	1,000 W	-	1,000 W	-
Repeatability <sup>*2</sup>	X, Y, Z axis	±1 mm				
	θ axis	±0.3 deg	-	±0.3 deg	-	
Maximum payload		8 kg				
Maximum through-put <sup>*3</sup>		80 CPM <sup>*4</sup>		90 CPM <sup>*4</sup>		
Gear box ratio	X, Y, Z axis	1:38,5				
	θ axis	1:20	-	1:20	-	
θ axis torque limitation		60 Nm		26 Nm		
User tubing (outer diameter)		Ø 8 <sup>*5</sup>				
Travel limit		1. Soft limit, 2. Mechanical stopper (X, Y, Z axis)				
Noise level		< 70 dB (A)		< 68 dB (A)		
Ambient temperature		5°C to 45°C				
Relative humidity		Max. 90%				
Protection class		IP65				
Weight		115 kg		90 kg		

\*1. For further details please check the dimensional drawing in the next section.

\*2. This is the value at a constant ambient temperature.

\*3. With 0.1 kg payload. When reciprocating 305 mm in horizontal and 25 mm in vertical directions.

\*4. CPM: Cycle per minutes. Check the note 3 for the cycle definition.

\*5. Only for the air suctioning. The air injection is not allowed.

Model		CR_UGD4_XL		CR_UGD4		
		With rotational axis	Without rotational axis	With rotational axis	Without rotational axis	
Working volume	X, Y axis (stroke)	Ø 1,300 mm		Ø 1,100 mm		
	Z axis (stroke) <sup>*1</sup>	250 mm (maximum Ø 1,300 mm) 400 mm (center Ø 870 mm)		250 mm (maximum Ø 1,100 mm) 400 mm (center Ø 670 mm)		
	θ axis (rotation angle)	±180 deg (default setting, it can be changed)	-	±180 deg (default setting, it can be changed)	-	
Servo motor	Arm 1, 2, 3	Model	R88M-K1K030T-BS2			
		Capacity	1,000 W			
	Rotational axis 4	Model	R88M-K1K030T-BS2	-	R88M-K1K030T-BS2	-
		Capacity	1,000 W	-	1,000 W	-
Repeatability <sup>*2</sup>	X, Y, Z axis	±0.2 mm		±0.3 mm		
	θ axis	±0.3 deg	-	±0.4 deg	-	
Maximum payload		2 kg				
Maximum through-put <sup>*3</sup>		120 CPM <sup>*4</sup>		150 CPM <sup>*4</sup>		
Gear box ratio	X, Y, Z axis	1:31				
	θ axis	1:10	-	1:10	-	
θ axis torque limitation		16 Nm		16 Nm		
User tubing (outer diameter)		Ø 8 <sup>*5</sup>				
Travel limit		1. Soft limit, 2. Mechanical stopper (X, Y, Z axis)				
Noise level		< 68 dB (A)				
Ambient temperature		5°C to 45°C				
Relative humidity		Max. 90%				
Protection class		IP65				
Weight		65 kg				

\*1. For further details please check the dimensional drawing in the next section.

\*2. This is the value at a constant ambient temperature.

\*3. With 0.1 kg payload. When reciprocating 305 mm in horizontal and 25 mm in vertical directions.

\*4. CPM: Cycle per minutes. Check the note 3 for the cycle definition.

\*5. Only for the air suctioning. The air injection is not allowed.

Model		CR_UGD4MINI		
		With rotational axis	Without rotational axis	
Working volume	X, Y axis (stroke)	Ø 500 mm		
	Z axis (stroke) <sup>*1</sup>	130 mm (maximum Ø 500 mm)	155 mm (maximum Ø 500 mm)	
	θ axis (rotation angle)	±180 deg (default setting, it can be changed)		
Servo motor	Arm 1, 2, 3	Model	R88M-K40030T-BS2	
		Capacity	400 W	
	Rotational axis 4	Model	R88M-K40030T-BS2	-
		Capacity	400 W	-
Repeatability <sup>*2</sup>	X, Y, Z axis	±0.2 mm		
	θ axis	±0.3 deg	-	
Maximum payload		1 kg		
Maximum through-put <sup>*3</sup>		200 CPM <sup>*4</sup>		
Gear box ratio	X, Y, Z axis	1:25		
	θ axis	1:1	-	
θ axis torque limitation		16 Nm	-	
User tubing (outer diameter)		Ø 8 <sup>*5</sup>		
Travel limit		1. Soft limit, 2. Mechanical stopper (X, Y, Z axis)		
Noise level		< 68 dB (A)		
Ambient temperature		5°C to 45°C		
Relative humidity		Max. 90%		
Protection class		IP65 <sup>*6</sup>		
Weight		25 kg		

\*1. For further details please check the dimensional drawing in the next section.

\*2. This is the value at a constant ambient temperature.

\*3. With 0.1 kg payload. When reciprocating 305 mm in horizontal and 25 mm in vertical directions.

\*4. CPM: Cycle per minutes. Check the note 3 for the cycle definition.

\*5. Only for the air suctioning. The air injection is not allowed.

\*6. The CR\_UGD4MINI\_□\_TS models are delivered standard with stainless steel + titanium secondary arms.

Dimensions

IP69K protection class models

CR\_UGD4\_XL □ R\_HD □

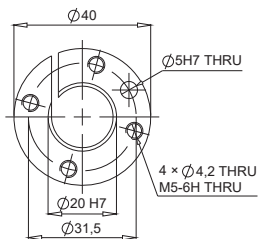
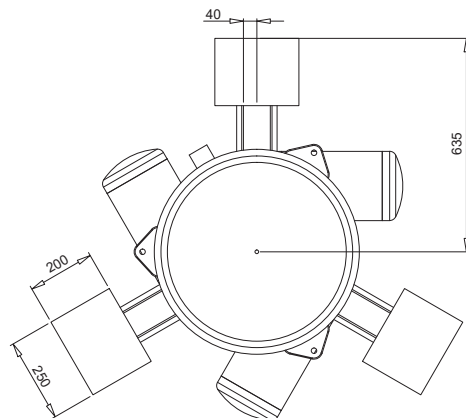
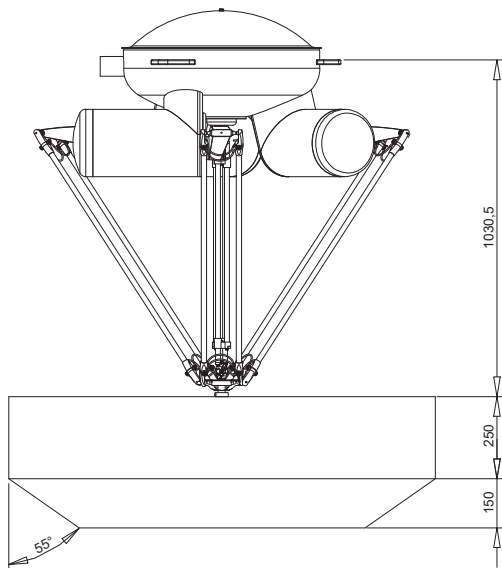
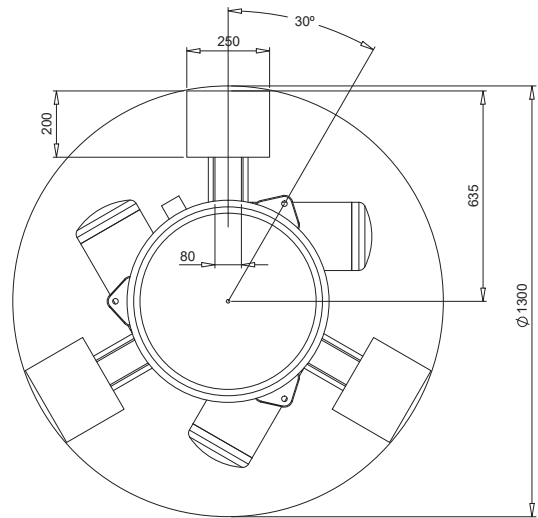
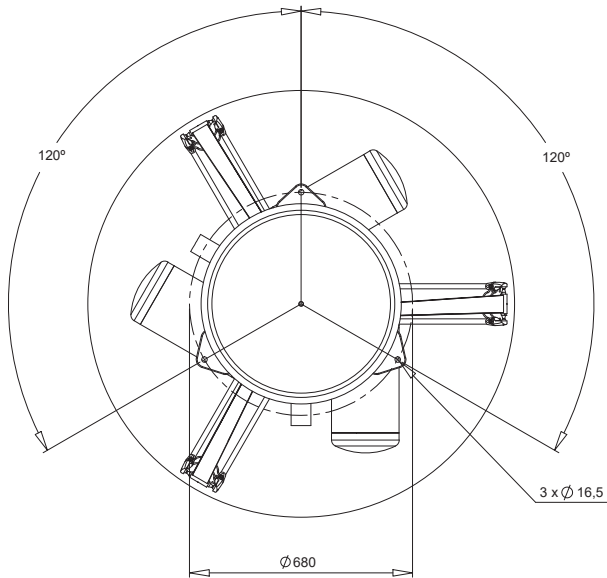

Gripper dimensions

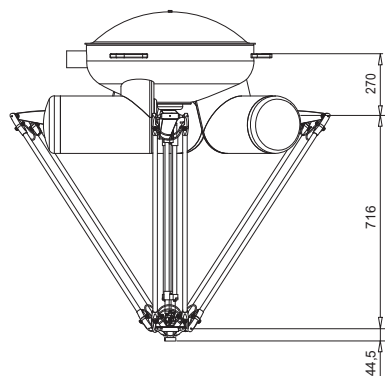

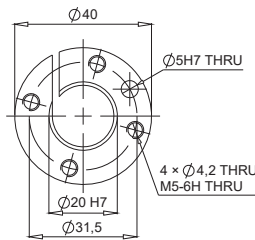
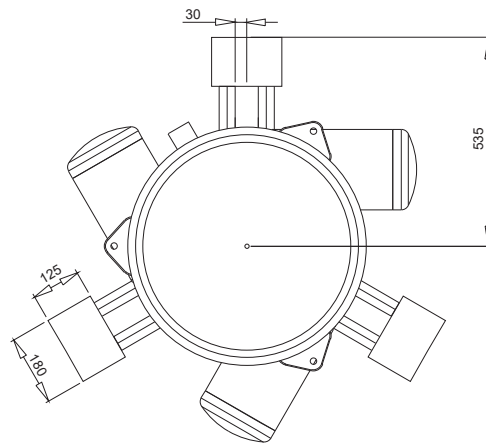
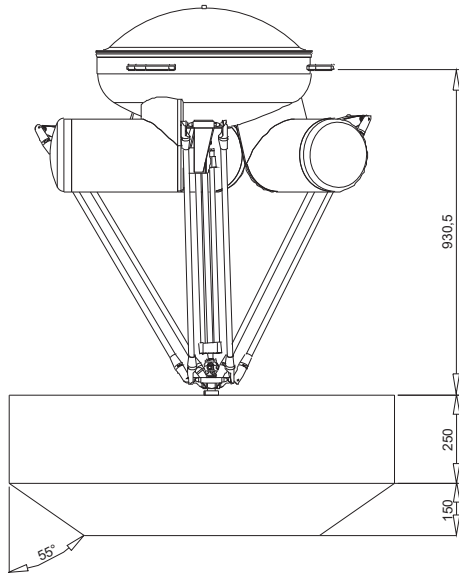
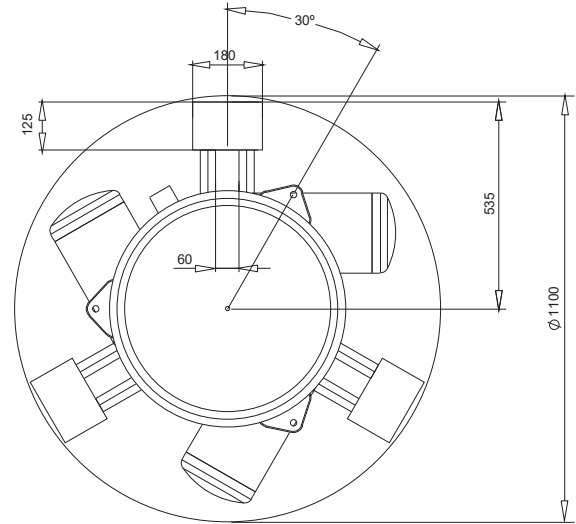
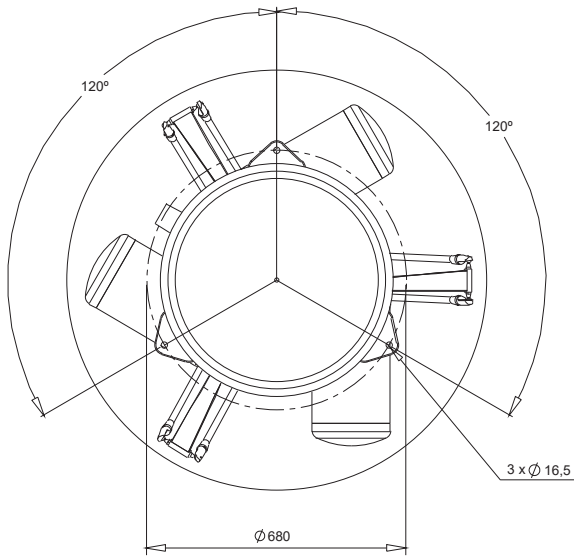

Gripper dimensions

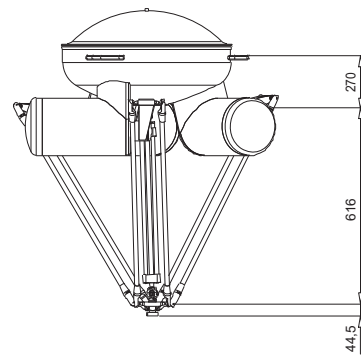

CR\_UGD4\_XS\_□R\_HD□

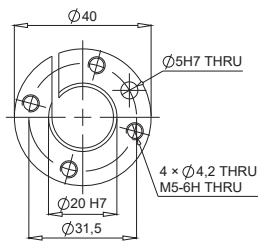
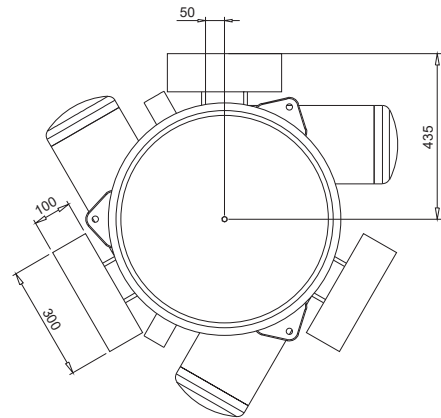
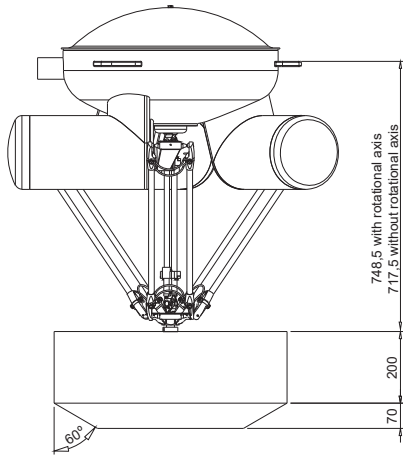
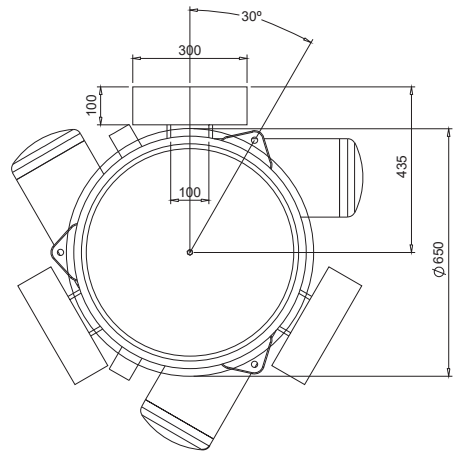
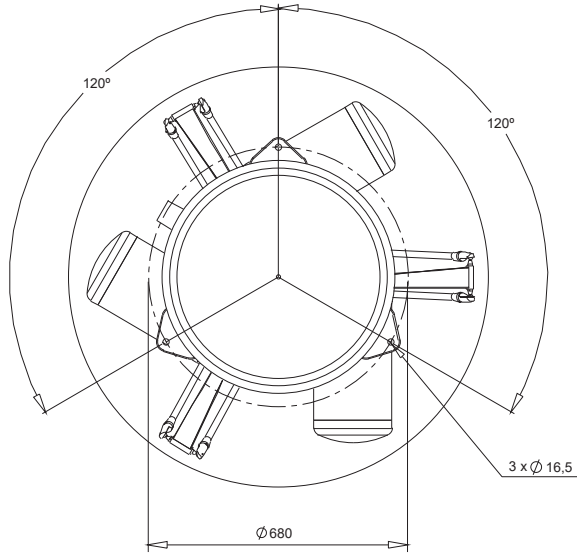

Gripper dimensions

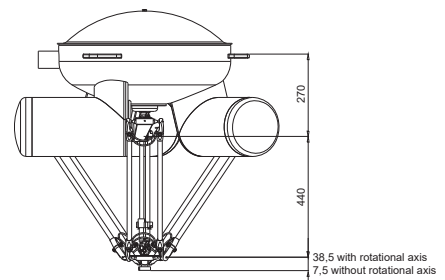

## IP67 protection class models

R6Y3□110□03067NJ5

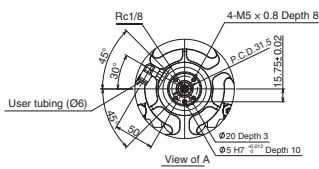
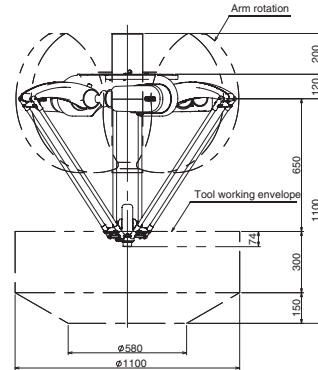
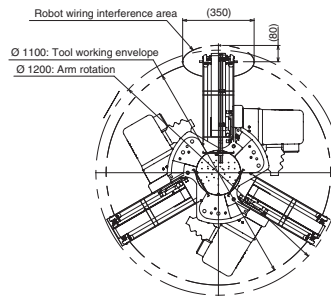
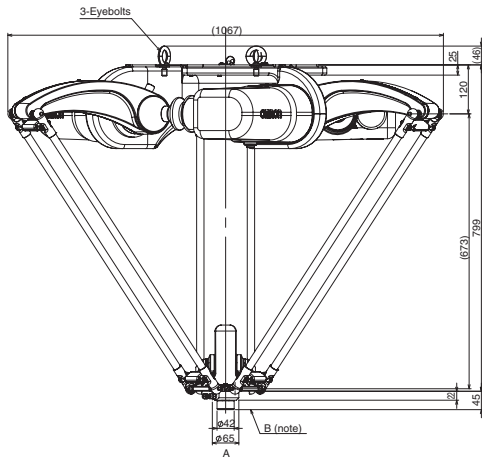
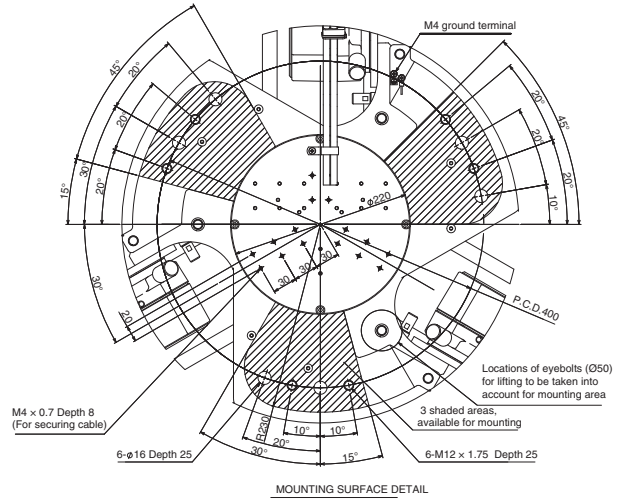
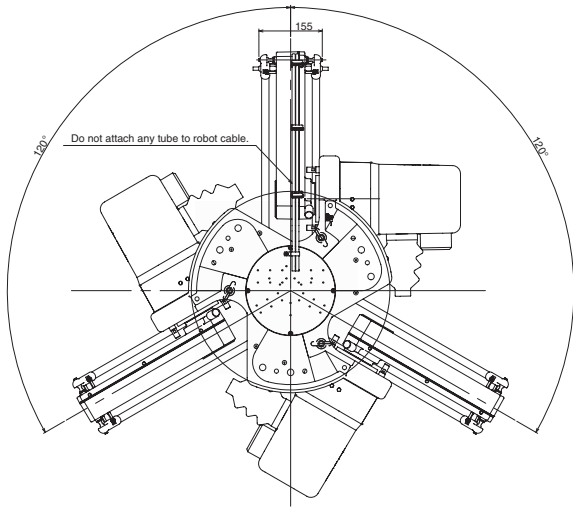

**Note:** The three areas of the robot base are available for mounting. Leave other area unoccupied for other needs (e.g. wiring). Also note the locations of the eyebolts when designing a mounting frame. Any part of end-effector should not stick out above the surface of B.



R6Y3□065□02067NJ5

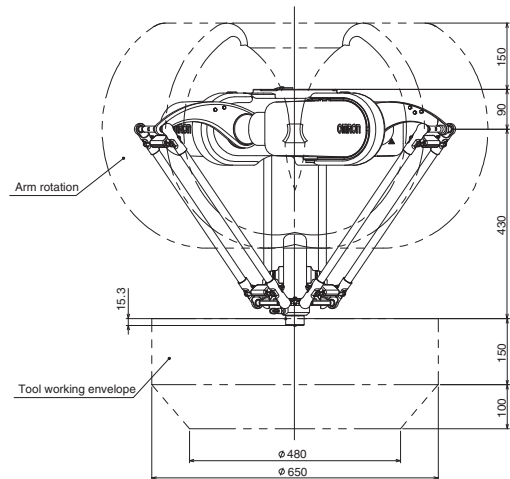
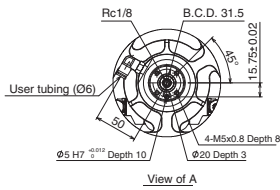
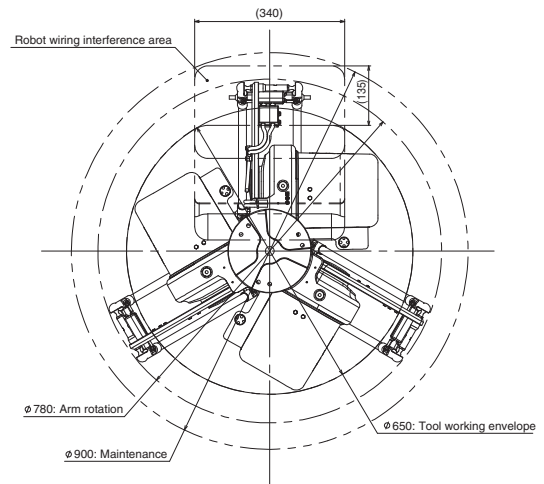
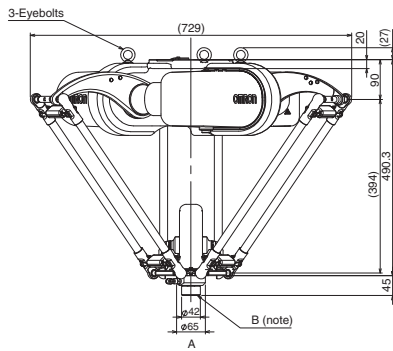
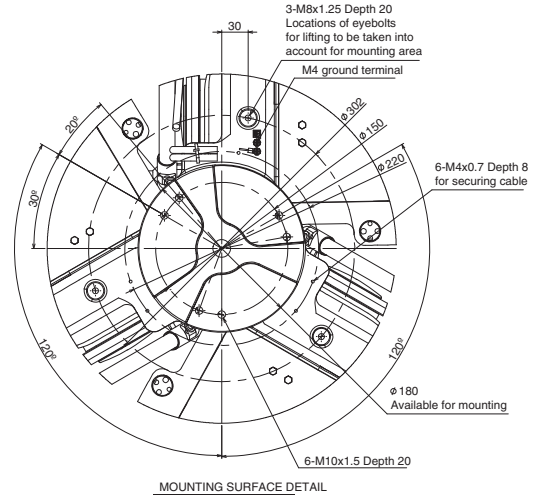
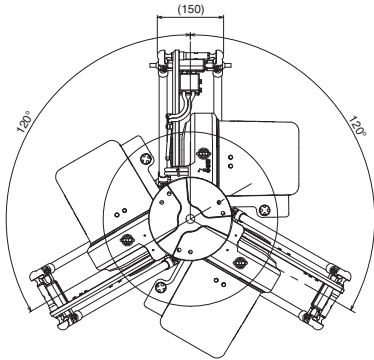

**Note:** Mounting area should be smaller than 180 mm diameter to avoid collision with robot cable. Frame of base should not be in the arm moving area. Any part of end-effector should not stick out above the surface of B.

## IP65 protection class models

CR\_UGD4\_XXLH\_□R

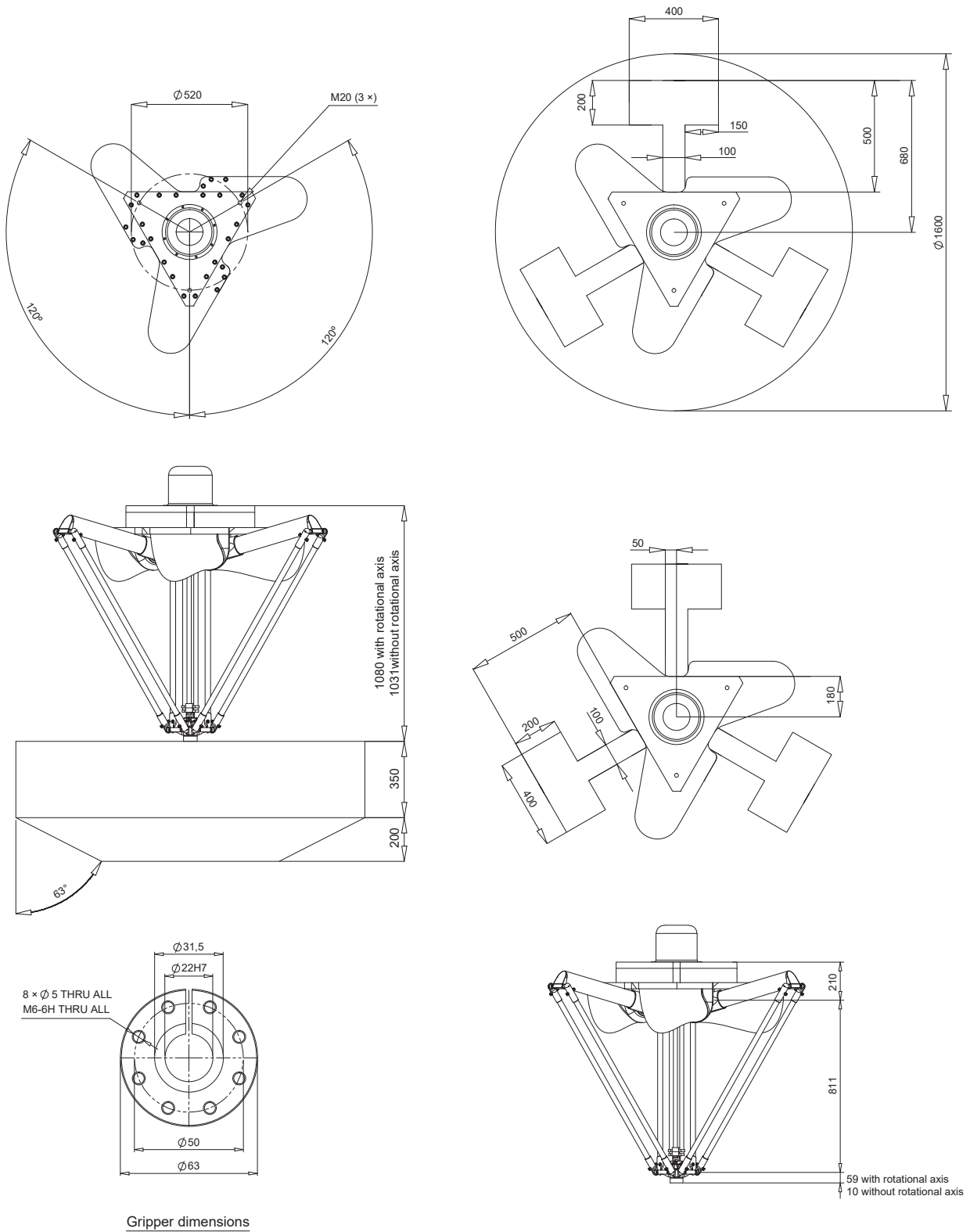

Gripper dimensions

CR\_UGD4\_XXL1300H\_□R

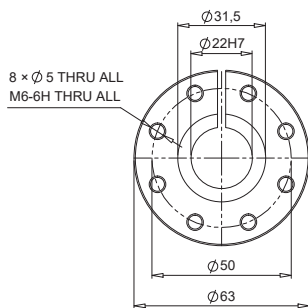
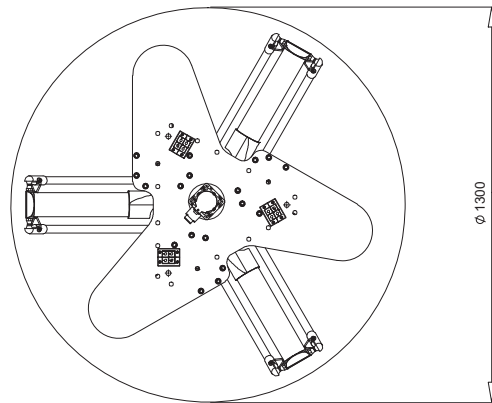
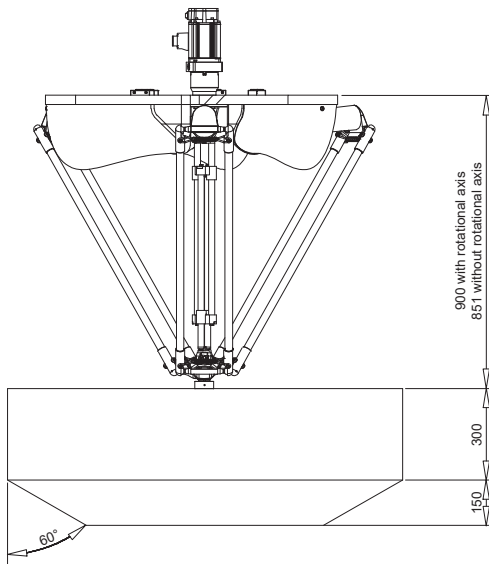
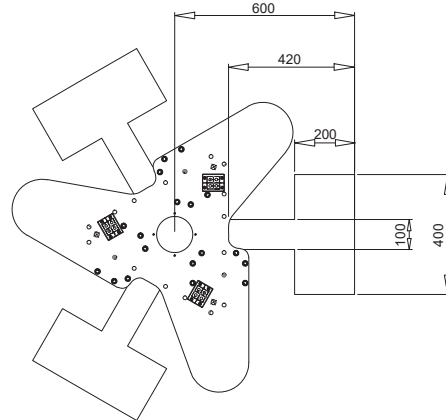
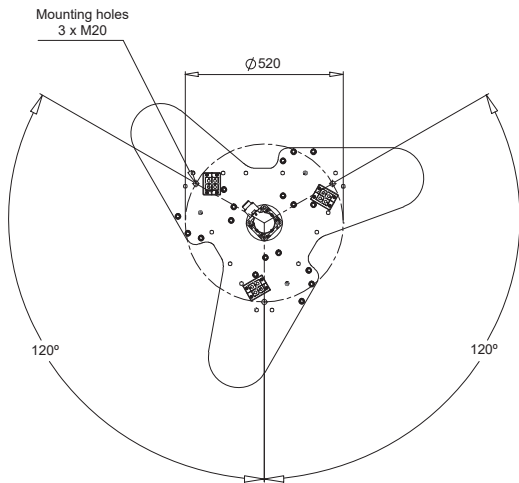

Gripper dimensions

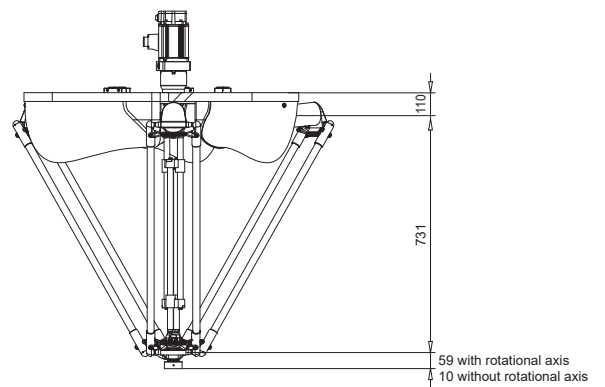

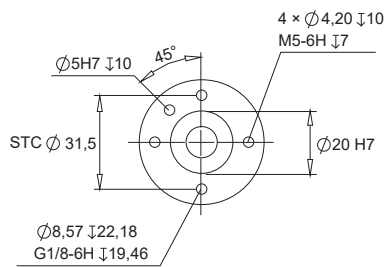
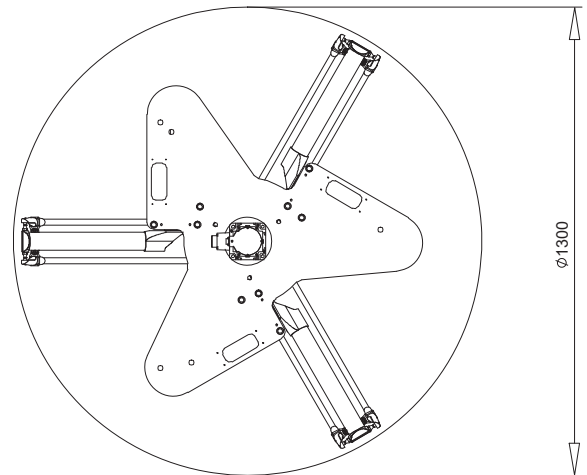
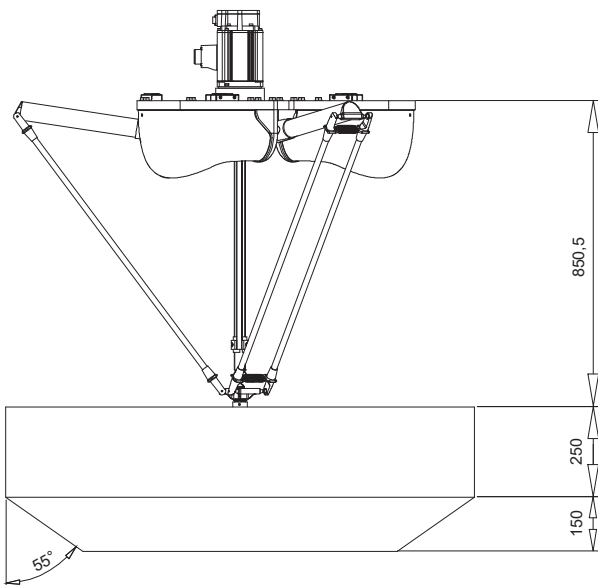
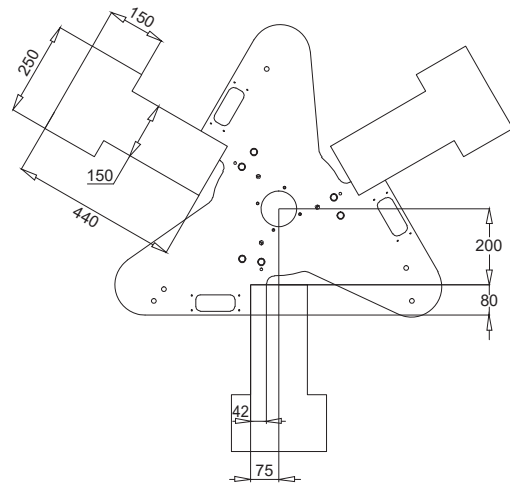
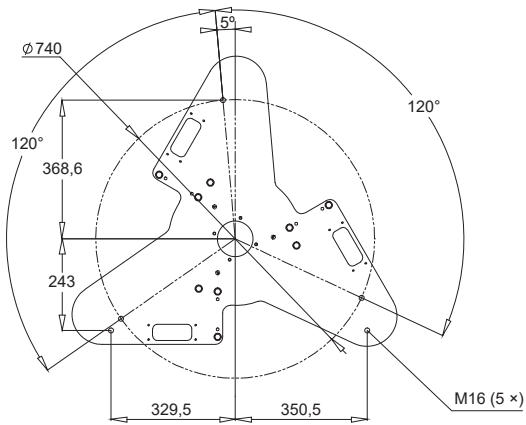

Gripper dimensions

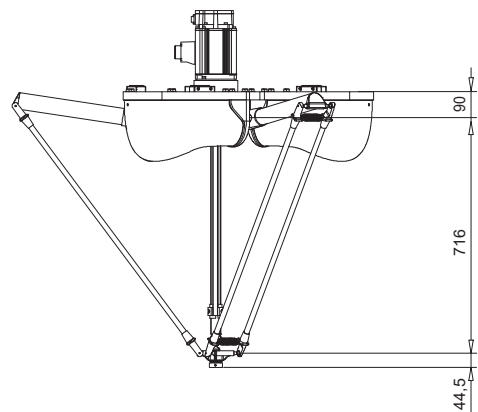

CR\_UGD4\_□R

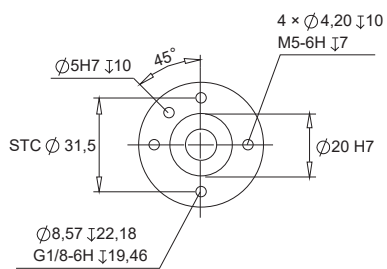
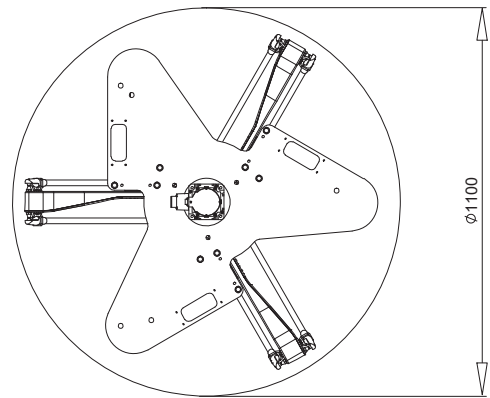
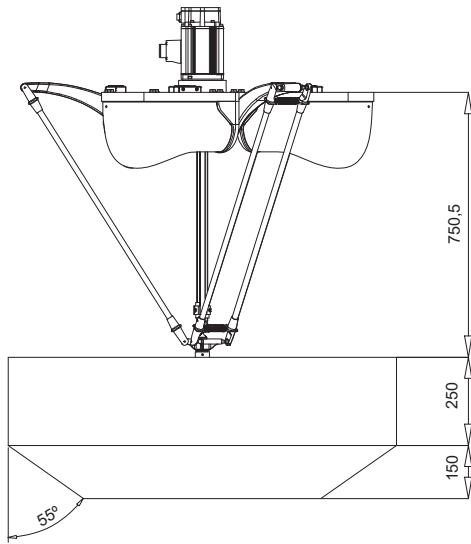
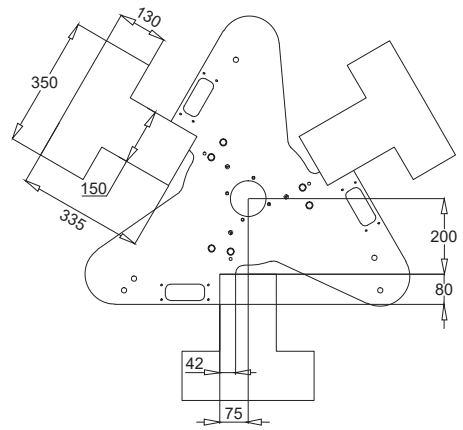
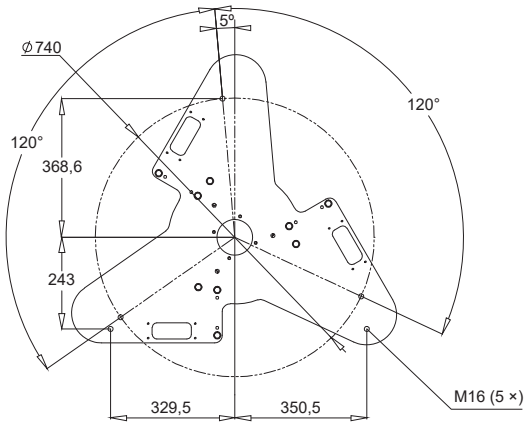

Gripper dimensions

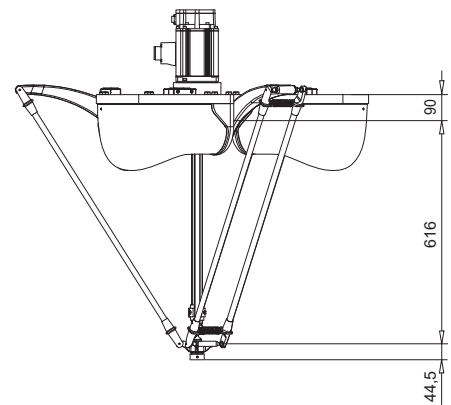

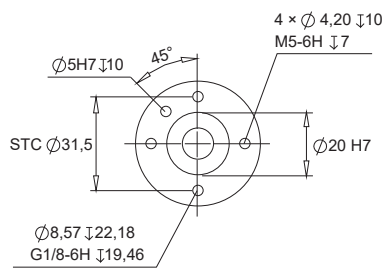
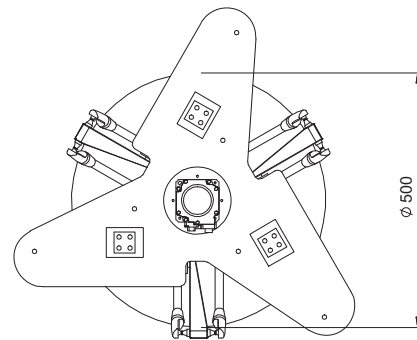
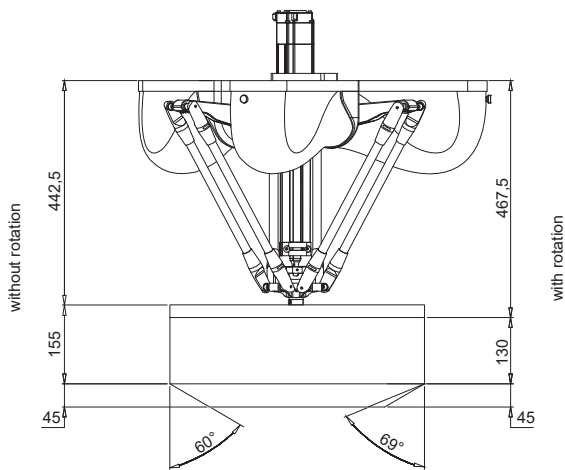
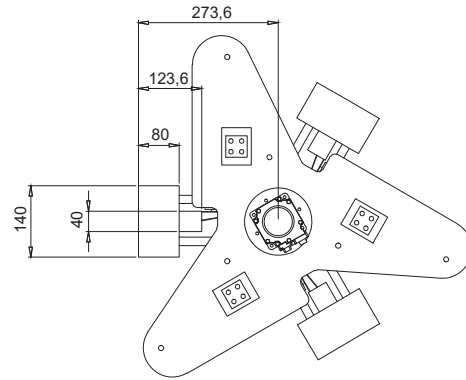
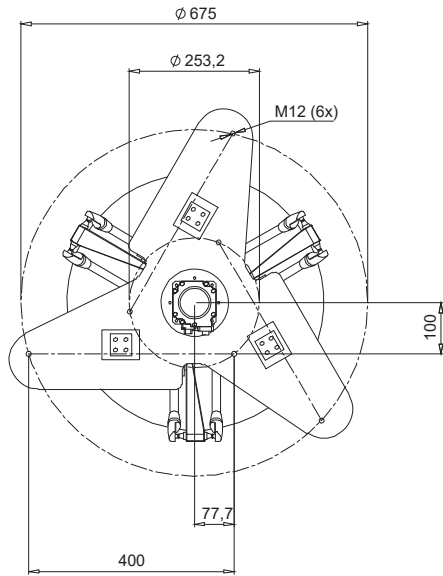

Gripper dimensions

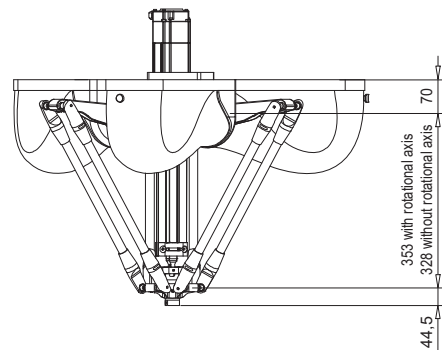

Selection table

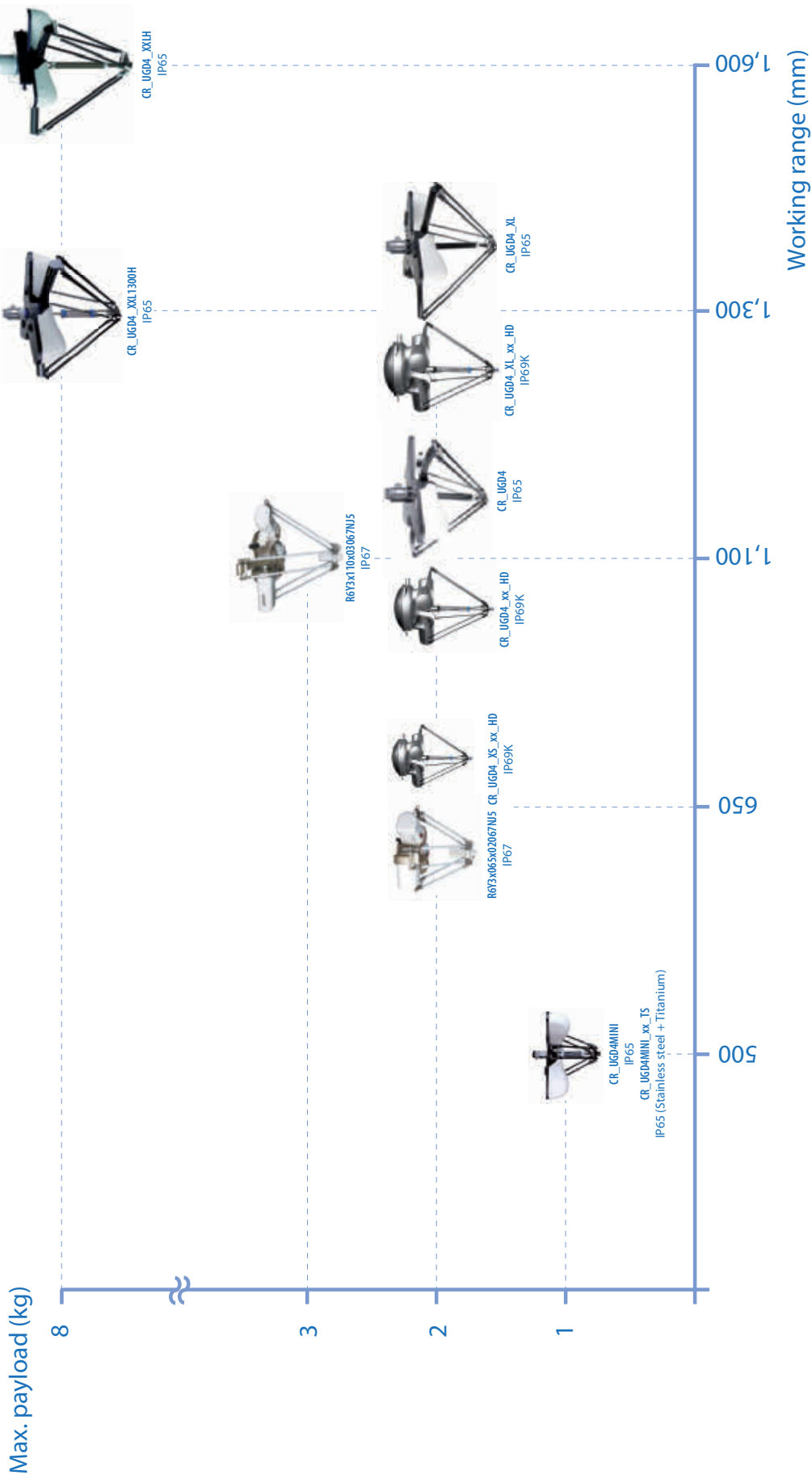

## Ordering information

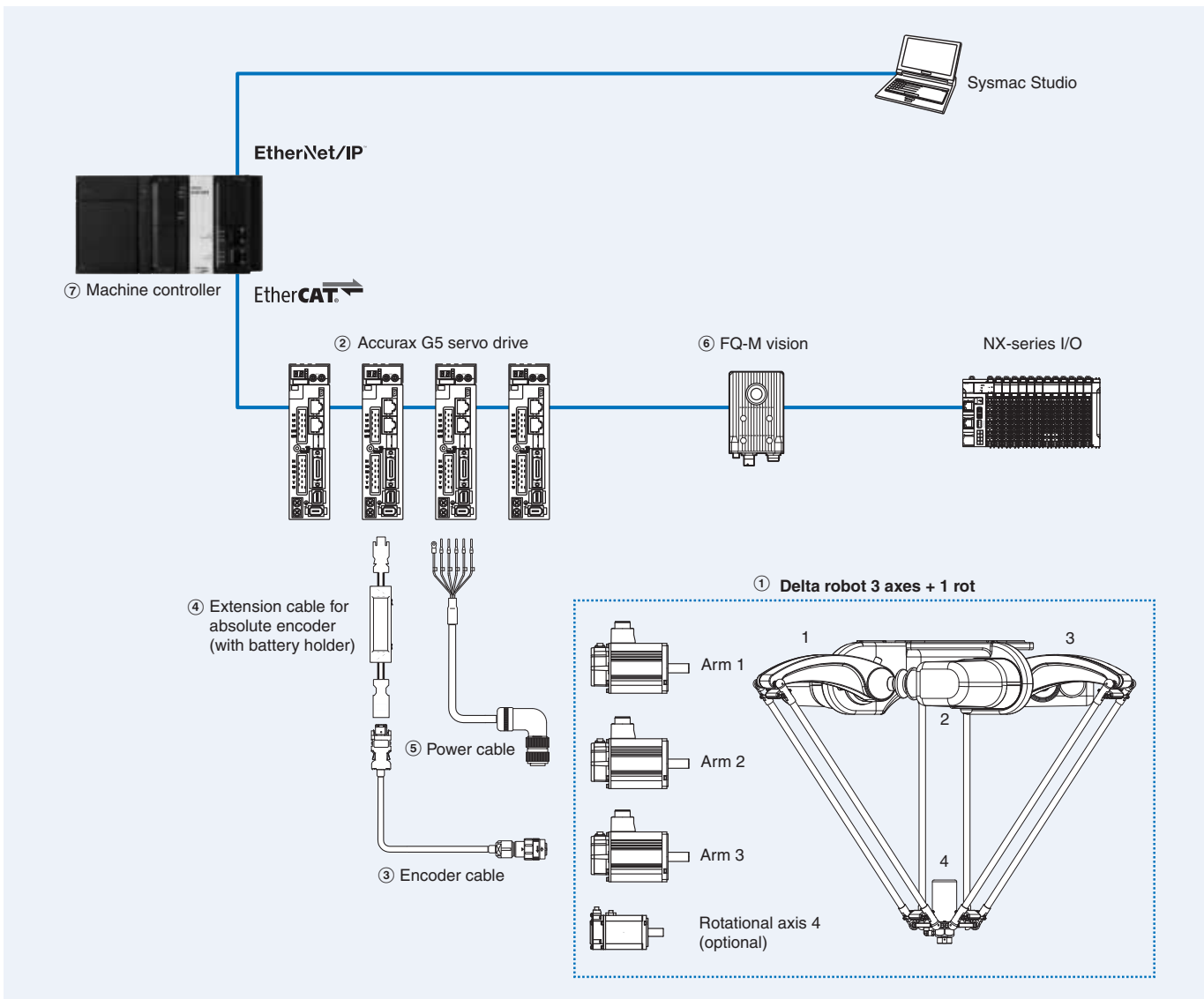

**Note:** Servo motors included in the Delta robot.



Delta robot 3 axes + 1 rot series

IP69K protection class models

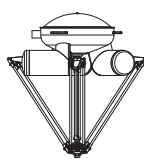
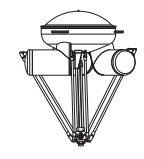
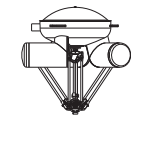

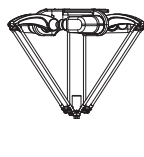
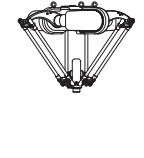

Symbol	Model	Cable length	Max. payload	Working range	Description <sup>1</sup>	Axis	②Applicable servo drive		
① 	CR_UGD4_XL_R_HD3	3 m	2 kg	Ø 1,300 x 250 mm (Max. 400)	3 + 1 axes Hygienic Design	Arm 1	R88D-KN15H-ECT		
	CR_UGD4_XL_R_HD5	5 m				Arm 2	R88D-KN15H-ECT		
	CR_UGD4_XL_R_HD10	10 m				Arm 3	R88D-KN15H-ECT		
	CR_UGD4_XL_R_HD15	15 m				Rotational 4	R88D-KN08H-ECT		
	CR_UGD4_XL_R_HD20	20 m							
	CR_UGD4_XL_NR_HD3	3 m			3 axes Hygienic Design	Arm 1	R88D-KN15H-ECT		
	CR_UGD4_XL_NR_HD5	5 m				Arm 2	R88D-KN15H-ECT		
	CR_UGD4_XL_NR_HD10	10 m				Arm 3	R88D-KN15H-ECT		
	CR_UGD4_XL_NR_HD15	15 m							
	CR_UGD4_XL_NR_HD20	20 m							
	CR_UGD4_XL_NR_HD20	20 m							
	① 	CR_UGD4_R_HD3			3 m	2 kg	Ø 1,100 x 250 mm (Max. 400)	3 + 1 axes Hygienic Design	Arm 1
CR_UGD4_R_HD5		5 m	Arm 2	R88D-KN15H-ECT					
CR_UGD4_R_HD10		10 m	Arm 3	R88D-KN15H-ECT					
CR_UGD4_R_HD15		15 m	Rotational 4	R88D-KN08H-ECT					
CR_UGD4_R_HD20		20 m							
CR_UGD4_NR_HD3		3 m	3 axes Hygienic Design	Arm 1	R88D-KN15H-ECT				
CR_UGD4_NR_HD5		5 m		Arm 2	R88D-KN15H-ECT				
CR_UGD4_NR_HD10		10 m		Arm 3	R88D-KN15H-ECT				
CR_UGD4_NR_HD15		15 m							
CR_UGD4_NR_HD20		20 m							
CR_UGD4_NR_HD20		20 m							
① 		CR_UGD4_XS_R_HD3	3 m	2 kg	Ø 650 x 200 mm (Max. 270)			3 + 1 axes Hygienic Design	Arm 1
	CR_UGD4_XS_R_HD5	5 m	Arm 2			R88D-KN15H-ECT			
	CR_UGD4_XS_R_HD10	10 m	Arm 3			R88D-KN15H-ECT			
	CR_UGD4_XS_R_HD15	15 m	Rotational 4			R88D-KN08H-ECT			
	CR_UGD4_XS_R_HD20	20 m							
	CR_UGD4_XS_NR_HD3	3 m	3 axes Hygienic Design			Arm 1	R88D-KN15H-ECT		
	CR_UGD4_XS_NR_HD5	5 m				Arm 2	R88D-KN15H-ECT		
	CR_UGD4_XS_NR_HD10	10 m				Arm 3	R88D-KN15H-ECT		
	CR_UGD4_XS_NR_HD15	15 m							
	CR_UGD4_XS_NR_HD20	20 m							
	CR_UGD4_XS_NR_HD20	20 m							

<sup>1</sup>The models with IP69K protection class include the encoder, power and brake cables.

IP67 protection class models

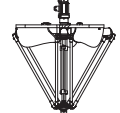
Symbol	Model	Max. payload	Working range	Description	Axis	②Applicable servo drive			
① 	R6Y31110H03067NJ5	3 kg	Ø 1,100 x 300 mm (Max. 450)	3 + 1 axes (high inertia rotational axis)	Arm 1	R88D-KN15H-ECT			
	R6Y31110L03067NJ5				Arm 2	R88D-KN15H-ECT			
					Arm 3	R88D-KN15H-ECT			
					Rotational 4	R88D-KN01H-ECT			
	R6Y30110S03067NJ5			3 + 1 axes (low inertia rotational axis)	Arm 1	R88D-KN15H-ECT			
				Arm 2	R88D-KN15H-ECT				
				Arm 3	R88D-KN15H-ECT				
	① 			R6Y31065H02067NJ5	2 kg	Ø 650 x 150 mm (Max. 250)	3 + 1 axes (high inertia rotational axis)	Arm 1	R88D-KN04H-ECT
				R6Y31065L02067NJ5				Arm 2	R88D-KN04H-ECT
Arm 3		R88D-KN04H-ECT							
Rotational 4		R88D-KN01H-ECT							
R6Y30065S02067NJ5		3 + 1 axes (low inertia rotational axis)	Arm 1	R88D-KN04H-ECT					
		Arm 2	R88D-KN04H-ECT						
R6Y30065S02067NJ5	3 axes	Arm 3	R88D-KN04H-ECT						
	Arm 1	R88D-KN04H-ECT							
	Arm 2	R88D-KN04H-ECT							

## IP65 protection class models

Symbol	Model	Max. payload	Working range	Description	Axis	②Applicable servo drive
① 	CR_UGD4_XXLH_R	8 kg	Ø 1,600 x 350 mm (Max. 550)	3 + 1 axes	Arm 1	R88D-KN30F-ECT
	CR_UGD4_XXLH_NR				Arm 2	R88D-KN30F-ECT
① 	CR_UGD4_XXL1300H_R		Ø 1,300 x 300 mm (Max. 450)	3 + 1 axes	Arm 3	R88D-KN30F-ECT
	CR_UGD4_XXL1300H_NR				Rotational 4	R88D-KN15F-ECT
① 	CR_UGD4_XL_R	2 kg	Ø 1,300 x 250 mm (Max. 400)	3 + 1 axes	Arm 1	R88D-KN15H-ECT
	CR_UGD4_XL_NR				Arm 2	R88D-KN15H-ECT
① 	CR_UGD4_R	2 kg	Ø 1,100 x 250 mm (Max. 400)	3 + 1 axes	Arm 3	R88D-KN15H-ECT
	CR_UGD4_NR				Rotational 4	R88D-KN15H-ECT
① 	CR_UGD4MINI_R	1 kg	Ø 500 x 130 mm (Max. 175)	3 + 1 axes	Arm 1	R88D-KN04H-ECT
	CR_UGD4MINI_R_TS <sup>*1</sup>				Arm 2	R88D-KN04H-ECT
	CR_UGD4MINI_NR		Ø 500 x 155 mm (Max. 200)	3 axes	Arm 3	R88D-KN04H-ECT
	CR_UGD4MINI_NR_TS <sup>*1</sup>				Rotational 4	R88D-KN04H-ECT



\*1: The CR\_UGD4MINI\_□\_TS models are delivered standard with stainless steel + titanium secondary arms.

## Encoder cables

Symbol	Applicable Delta robots	Model	Appearance
③	CR_UGD4_XL_□_HD□ (Arm 1, 2, 3) <sup>*1</sup>	1.5 m R88A-CRKC001-5NR-E	
	CR_UGD4_□_HD□ (Arm 1, 2, 3) <sup>*1</sup>	3 m R88A-CRKC003NR-E	
	CR_UGD4_XS_□_HD□ (Arm 1, 2, 3) <sup>*1</sup>	5 m R88A-CRKC005NR-E	
	R6Y3□110□03067NJ5	10 m R88A-CRKC010NR-E	
	CR_UGD4_XXLH	15 m R88A-CRKC015NR-E	
	CR_UGD4_XXL1300H	20 m R88A-CRKC020NR-E	
	CR_UGD4_XL		
	CR_UGD4		
	R6Y3□065□02067NJ5 (Rotational axis 4)		
	CR_UGD4_XL_□_HD□ (Rotational axis 4) <sup>*1</sup>	1.5 m R88A-CRKA001-5CR-E	
CR_UGD4_□_HD□ (Rotational axis 4) <sup>*1</sup>	3 m R88A-CRKA003CR-E		
CR_UGD4_XS_□_HD□ (Rotational axis 4) <sup>*1</sup>	5 m R88A-CRKA005CR-E		
R6Y3□065□02067NJ5 (Arm 1, 2, 3)	10 m R88A-CRKA010CR-E		
CR_UGD4MINI_□_TS	15 m R88A-CRKA015CR-E		
CR_UGD4MINI	20 m R88A-CRKA020CR-E		

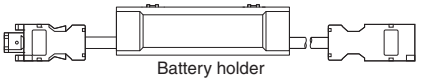

\*1: The models with IP69K protection class include the encoder cables.

## Absolute encoder battery cable (encoder extension cable only)

Symbol	Specifications	Model	Appearance
④	Absolute encoder battery cable	Battery not included 0.3 m R88A-CRGD0R3C-E	 Battery holder
		Battery included 0.3 m R88A-CRGD0R3C-BS-E	
	Absolute encoder backup battery	2,000 mA, 3.6 V - R88A-BAT01G	

Power and brake cables

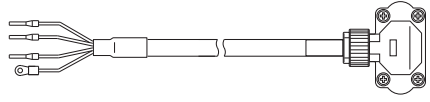
Symbol	Applicable Delta robots			Model	Appearance	
⑤	CR_UGD4_XL□_HD□ <sup>1</sup> CR_UGD4□_HD□ CR_UGD4_XS□_HD□	Arm 1, 2, 3	Power cable with brake	1.5 m	R88A-CAGB001-5BR-E	
				3 m	R88A-CAGB003BR-E	
				5 m	R88A-CAGB005BR-E	
				10 m	R88A-CAGB010BR-E	
				15 m	R88A-CAGB015BR-E	
				20 m	R88A-CAGB020BR-E	
		Rotational axis 4	Power cable without brake	1.5 m	R88A-CAKA001-5SR-E	
				3 m	R88A-CAKA003SR-E	
				5 m	R88A-CAKA005SR-E	
				10 m	R88A-CAKA010SR-E	
				15 m	R88A-CAKA015SR-E	
				20 m	R88A-CAKA020SR-E	
	Rotational axis 4	Brake cable	1.5 m	R88A-CAKA001-5BR-E		
			3 m	R88A-CAKA003BR-E		
			5 m	R88A-CAKA005BR-E		
			10 m	R88A-CAKA010BR-E		
			15 m	R88A-CAKA015BR-E		
			20 m	R88A-CAKA020BR-E		
	R6Y3□110□03067NJ5	Arm 1, 2, 3	Power cable with brake	1.5 m	R88A-CAGB001-5BR-E	
				3 m	R88A-CAGB003BR-E	
				5 m	R88A-CAGB005BR-E	
				10 m	R88A-CAGB010BR-E	
				15 m	R88A-CAGB015BR-E	
				20 m	R88A-CAGB020BR-E	
Rotational axis 4		Power cable without brake	1.5 m	R88A-CAGB001-5SR-E		
			3 m	R88A-CAGB003SR-E		
			5 m	R88A-CAGB005SR-E		
			10 m	R88A-CAGB010SR-E		
			15 m	R88A-CAGB015SR-E		
			20 m	R88A-CAGB020SR-E		
CR_UGD4_XXLH CR_UGD4_XXL1300H	Arm 1, 2, 3	Power cable with brake	1.5 m	R88A-CAGD001-5BR-E		
			3 m	R88A-CAGD003BR-E		
			5 m	R88A-CAGD005BR-E		
			10 m	R88A-CAGD010BR-E		
			15 m	R88A-CAGD015BR-E		
			20 m	R88A-CAGD020BR-E		
	Rotational axis 4	Power cable with brake	1.5 m	R88A-CAKF001-5BR-E		
			3 m	R88A-CAKF003BR-E		
			5 m	R88A-CAKF005BR-E		
			10 m	R88A-CAKF010BR-E		
			15 m	R88A-CAKF015BR-E		
			20 m	R88A-CAKF020BR-E		
CR_UGD4_XL CR_UGD4	Arm 1, 2, 3 and rotational axis 4	Power cable with brake	1.5 m	R88A-CAGB001-5BR-E		
			3 m	R88A-CAGB003BR-E		
			5 m	R88A-CAGB005BR-E		
			10 m	R88A-CAGB010BR-E		
			15 m	R88A-CAGB015BR-E		
			20 m	R88A-CAGB020BR-E		
R6Y3□065□02067NJ5	Arm 1, 2, 3	Power cable without brake	1.5 m	R88A-CAKA001-5SR-E		
			3 m	R88A-CAKA003SR-E		
			5 m	R88A-CAKA005SR-E		
			10 m	R88A-CAKA010SR-E		
			15 m	R88A-CAKA015SR-E		
			20 m	R88A-CAKA020SR-E		
		Rotational axis 4	Brake cable	1.5 m	R88A-CAKA001-5BR-E	
				3 m	R88A-CAKA003BR-E	
				5 m	R88A-CAKA005BR-E	
				10 m	R88A-CAKA010BR-E	
				15 m	R88A-CAKA015BR-E	
				20 m	R88A-CAKA020BR-E	
	Rotational axis 4	Power cable without brake	1.5 m	R88A-CAGB001-5SR-E		
			3 m	R88A-CAGB003SR-E		
			5 m	R88A-CAGB005SR-E		
			10 m	R88A-CAGB010SR-E		
			15 m	R88A-CAGB015SR-E		
			20 m	R88A-CAGB020SR-E		

Symbol	Applicable Delta robots				Model	Appearance	
⑤	CR_UGD4MINI□_TS CR_UGD4MINI	Arm 1, 2, 3 and rotational axis 4	Power cable without brake	1.5 m	R88A-CAKA001-5SR-E		
				3 m	R88A-CAKA003SR-E		
				5 m	R88A-CAKA005SR-E		
				10 m	R88A-CAKA010SR-E		
				15 m	R88A-CAKA015SR-E		
			20 m	R88A-CAKA020SR-E			
			Brake cable	1.5 m	R88A-CAKA001-5BR-E		
				3 m	R88A-CAKA003BR-E		
				5 m	R88A-CAKA005BR-E		
				10 m	R88A-CAKA010BR-E		
15 m	R88A-CAKA015BR-E						
20 m	R88A-CAKA020BR-E						

\*1: The models with IP69K protection class include the power and brake cables.

## Vision

Name	Type		Model
⑥ FQ-M series	Color	NPN	FQ-MS120-ECT
		PNP	FQ-MS125-ECT
	Monochrome	NPN	FQ-MS120-M-ECT
		PNP	FQ-MS125-M-ECT

## Machine controller

Name		Functions	Delta robot control	Axes	Model
⑦ NJ Robotics	CPU unit	Logic sequence, motion, robotics and database connection	Control of up to 8 Delta robot depending on the number of axes supported by the CPU	16	NJ501-4320
				64	NJ501-4500
				32	NJ501-4400
				16	NJ501-4300
				16	NJ501-4310
	Power supply unit				

## Accessories

Name	Applicable Delta robots	Specifications	Model
Anti-collision detection option	R6Y3□110□03067NJ5 R6Y3□065□02067NJ5	Connectors mounted between the TCP flange and the arms	R6YACAD01

## Computer software

Specifications	Model
Sysmac Studio version 1.03 or higher	SYSMAC-SE2□□□

ALL DIMENSIONS SHOWN ARE IN MILLIMETERS.  
To convert millimeters into inches, multiply by 0.03937. To convert grams into ounces, multiply by 0.03527.

## X-ON Electronics

Largest Supplier of Electrical and Electronic Components

*Click to view similar products for [Specialised Cables category](#):*

*Click to view products by [Omron manufacturer](#):*

Other Similar products are found below :

[GP-IE515546DS-002](#) [7810SB-010-1000](#) [96CB-L2020PIB2](#) [1200740161](#) [R88ACAKA0015SRE](#) [R88ACAWL005SDE](#) [R88ACRGD0R3C](#)  
[1300660042](#) [1300660201](#) [1971465-2](#) [22733-8](#) [2R7004A20F060](#) [SSL009PC2DC012N](#) [FC2A-KC6C](#) [CCSFCBF2](#) [R7ACAB005S](#)  
[XS2WM12PUR4SA10M](#) [XS2WM12PVC4SA10M](#) [05AU05](#) [UCABLE](#) [10114734-2010LF](#) [XW2Z010H3](#) [XW2Z010H1](#) [5-1589827-8](#) [5-](#)  
[1589827-4](#) [861084-1](#) [XW2Z200JB24](#) [5-1589956-8](#) [CR4000A76M020](#) [1201140211](#) [1300140039](#) [CR4000A76M005](#) [CR4006A76M005](#)  
[10077488-N0550FDLF](#) [XW2ZRY150C](#) [I4JPBJLUXX100](#) [I4JPBJLUXX50](#) [CM06](#) [CM06W](#) [POE004](#) [0243 009 05](#) [0243 009 20](#) [0243 009 36](#)  
[0243 009 26](#) [0243 009 33](#) [0243 009 23](#) [0243 009 01](#) [0243 009 30](#) [0243 008 05](#) [0243 008 20](#)